

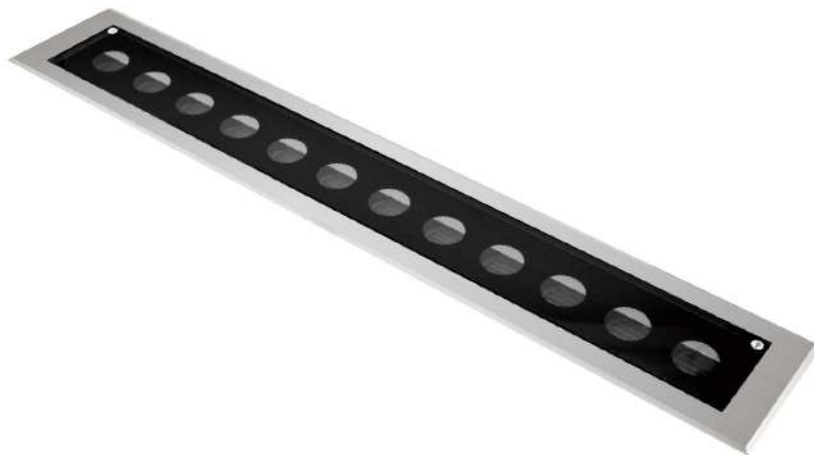

Frameless version



Frame version

Anti-glare recessed ground lights with frame and frameless options;
The light direction is moderately tilted towards the illuminated surface;
Equipped with a built-in anti-glare grille that tilts towards the illuminated surface;
single-color light or RGBW;
Seamless splicing, and the wires can be hide in the installation box;
Static load: 1000kg, powered by 24V, IP67 protection ;
Control:ON/OFF, DMX512, 0~10V, etc;
Work temperature: -20 °C to 50 °C.

In-ground Linear Light



Frameless version



Frame version

Mock up effect

Different optics design

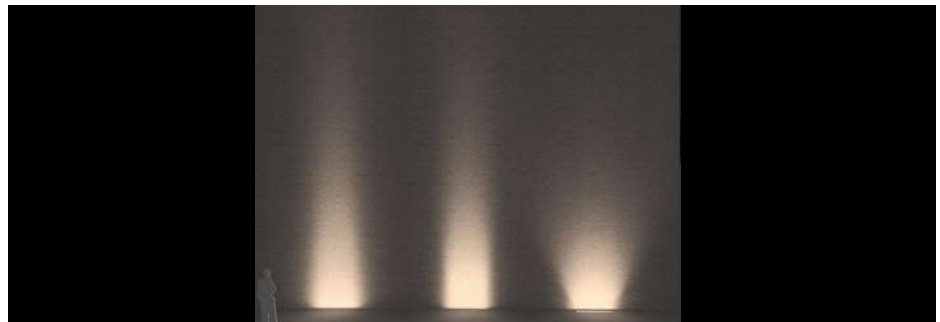

12°

10x22°

17x57°

Light effect

Perfect lighting uniformity and color consistency

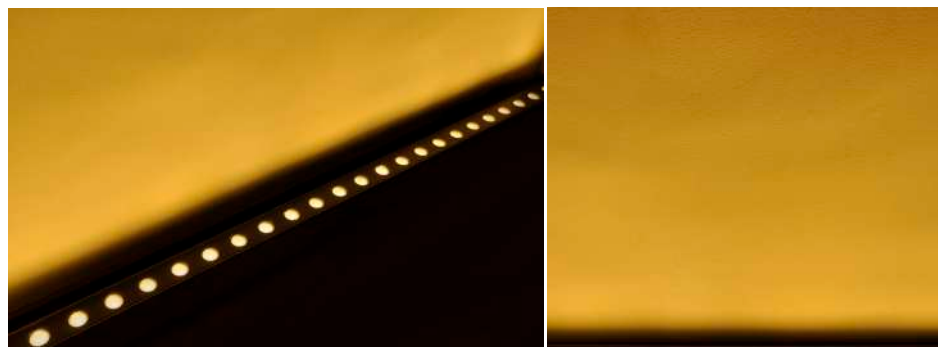

Anti-Glare

Inner anti-glare design to make sure the comfortable effect

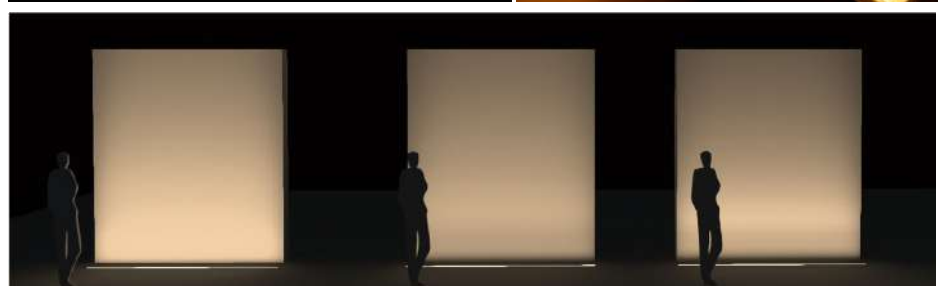
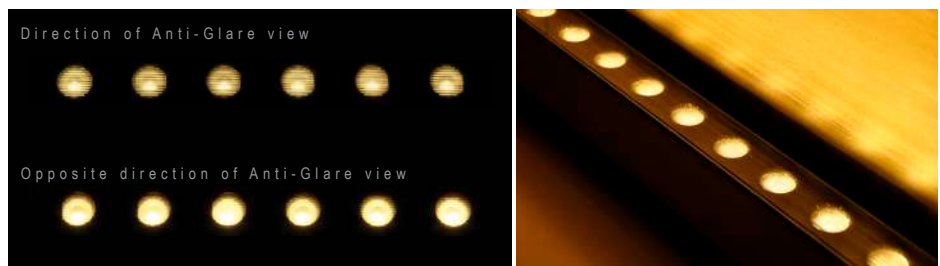

Without anti-glare

With Asymmetric 5° anti-glare accessory

With Asymmetric 15° anti-glare accessory

Flexibility and performance



L=500mm



L=1000mm

Multiple lengths are available. Glare accessories can be customized according to requirements. With different light distribution angles and corresponding glare control grilles, high efficiency can be maintained.

Mock up effect

Diffrent optics available

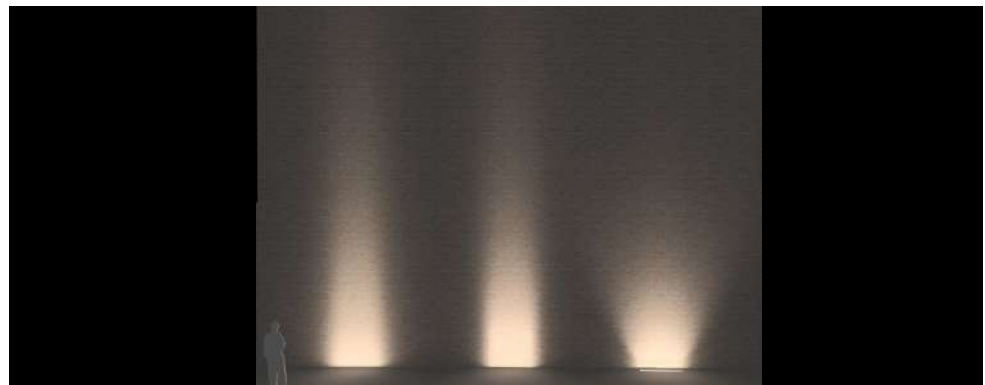

12°

10x22°

17x57°

Real effect



Anti-glare performance



Anti-glare accessory: Asymmetric 5°



Anti-glare accessory: Asymmetric 15°

Mock up effect

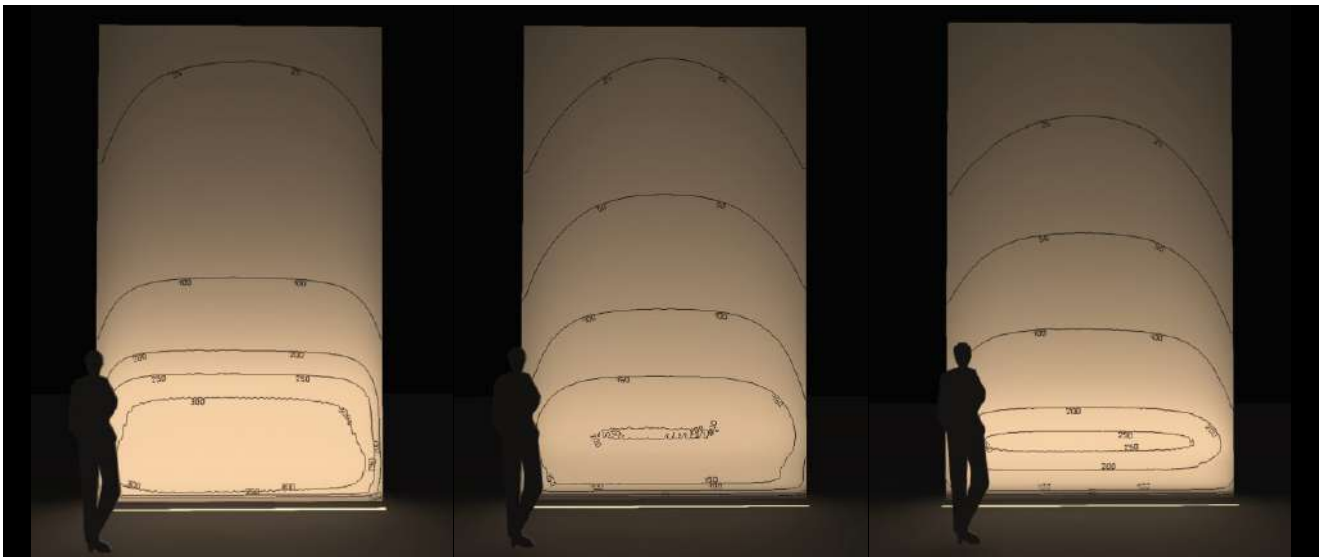

Without anti-glare

With Asymmetric 5°
anti-glare accessory

With Asymmetric 15°
anti-glare accessory

Code: LDW44-36WA1022
Height of the wall: 5m
Distance to the wall: 0.2m
Continue installation

Code: LDW44-36WA1022-P05
Height of the wall: 5m
Distance to the wall: 0.2m
Continue installation

Code: LDW44-36WA1022-P15
Height of the wall: 5m
Distance to the wall: 0.2m
Continue installation

Mock up of the glare for the people



Without anti-glare

With Asymmetric 5°
anti-glare accessory

With Asymmetric 15°
anti-glare accessory

In-ground linear light with frame

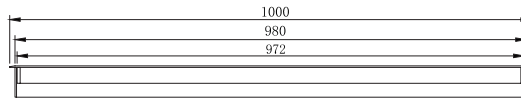
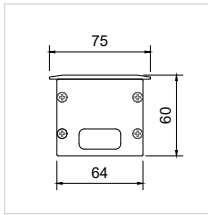

CODE	WATT (W)	Intensity (cd)	FWHM (°)	FA (°)	Without LOUVER (lm)	With LOUVER (lm)
LBW75-36WA12-P05	36	9842	12	31	2385	1412
LBW75-36WA12-P15	36	7364	12	31	2385	1057
LBW75-36WA1022-P05	36	8928	12*26	32*46	2520	1450
LBW75-36WA1022-P15	36	6618	12*26	32*46	2520	1096
LBW75-36WA1560-P05	36	3248	15*57	41*85	2362	992
LBW75-36WA1560-P15	36					
LBW75-45WA12-P05-RGBW	45	7254	12*26	32*46	2047	1178
LBW75-45WA12-P15-RGBW	45	5377	12*26	32*46	2047	890
LBW75-45WA1022-P05-RGBW	45	7141	12*26	32*46	2024	1160
LBW75-45WA1022-P15-RGBW	45	5295	12*26	32*46	2040	877
LBW75-45WA1560-P05-RGBW	45	2584	15*57	41*85	2047	794

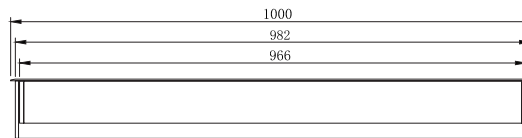
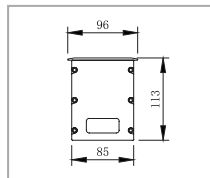

CODE	WATT (W)	Intensity (cd)	FWHM (°)	FA (°)	Without LOUVER (lm)	With LOUVER (lm)
LBW96-72WA05	72	249658	5	10	3329	3329
LBW96-72WA05-P05	72	157074	5	10	3329	2244
LBW96-72WA0520	72	69179	5*20	9*30	3329	3329
LBW96-72WA0520-P05	72	64336	5*20	9*30	3329	3110
LBW96-72WA0520-P15	72	59438	5*20	9*30	3336	2229
LBW96-72WA05-RGBW	72	162278	5	10	2164	2164
LBW96-72W05-P05-RGBW	72	102098	5	10	2164	1459
LBW96-72WA0520-RGBW	72	44966	5*20	9*30	2164	2164
LBW96-72WA0520-P05-RGBW	72	41818	5*20	9*30	2164	2022
LBW96-72WA0520-P15-RGBW	72	38635	5*20	9*30	2168	1449
LBW96-96WP15W	96	4656	44*72:P15	88*140:P15	4704	4704

The 24V power supply needs to be ordered separately. Place an order according to the color temperature requirements.

60: 6000K 40: 4000K 30: 3000K 27: 2700K

For the luminaires equipped with anti-glare accessories, there will be a flux loss of 40%-60% from 60° to 10°. The light loss within the full light spot angle is approximately 25%-30%.

In-ground linear light without frame

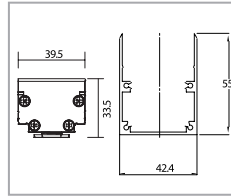

CODE	WATT (W)	Idensity (cd)	FWHM (°)	FA (°)	Without LOUVER (lm)	With LOUVER (lm)
LDW44-24WA12-P05	24	6561	12	31	1587	960
LDW44-24WA12-P15	24	4909	12	31	1587	735
LDW44-24WA1022-P05	24	5952	12*26	32*46	1680	967
LDW44-24WA1022-P15	24	4412	12*26	32*46	1680	730
LDW44-24WA1560-P05	24	2165	15*57	41*85	1596	661
LDW44-24WA1560-P15	24					

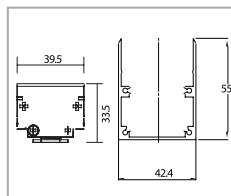

CODE	WATT (W)	Idensity (cd)	FWHM (°)	FA (°)	Without LOUVER (lm)	With LOUVER (lm)
LDW44-36WA12-P05	36	9842	12	31	2385	1412
LDW44-36WA12-P15	36	7364	12	31	2385	1057
LDW44-36WA1022-P05	36	8928	12*26	32*46	2520	1450
LDW44-36WA1022-P15	36	6618	12*26	32*46	2520	1096
LDW44-36WA1560-P05	36	3248	15*57	41*85	2362	992
LDW44-36WA1560-P15	36					

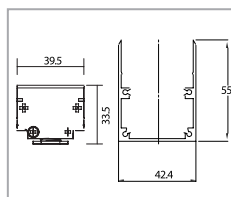

CODE	WATT (W)	Idensity (cd)	FWHM (°)	FA (°)	Without LOUVER (lm)	With LOUVER (lm)
LDW44-45WA12-P05-RGBW	45	7254	12*26	32*46	2047	1178
LDW44-45WA12-P15-RGBW	45	5377	12*26	32*46	2047	890
LDW44-45WA1022-P05-RGBW	45	7141	12*26	32*46	2040	1160
LDW44-45WA1022-P15-RGBW	45	5295	12*26	32*46	2040	877
LDW44-45WA1560-P05-RGBW	45	2584	15*57	41*85	2047	794

The 24V power supply needs to be ordered separately. Place an order according to the color temperature requirements.

60: 6000K 40: 4000K 30: 3000K 27: 2700K

For the luminaires equipped with anti-glare accessories, there will be a flux loss of 40%-60% from 60° to 10°. The light loss within the full light spot angle is approximately 25%-30%.