

# Aluminum Cylinder(Big bore)

## Character:

- Shorter 1/5 than ISO cylinder.
- Seal with long life ,low friction.
- Magnet in piston,whole series can be attached with sensor.



## Specification:

Mode	50	63	70	80
Motion	double acting			
Fluid	air			
Operating pressure range (Mpa)	0.1~1			
Ambient temperature(°C)	-10~70°C			
port size	1/4"			

## How to order:

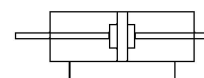
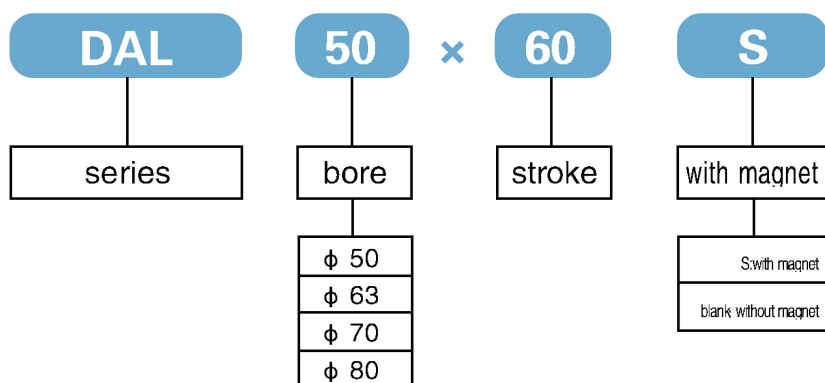

## Dimension:

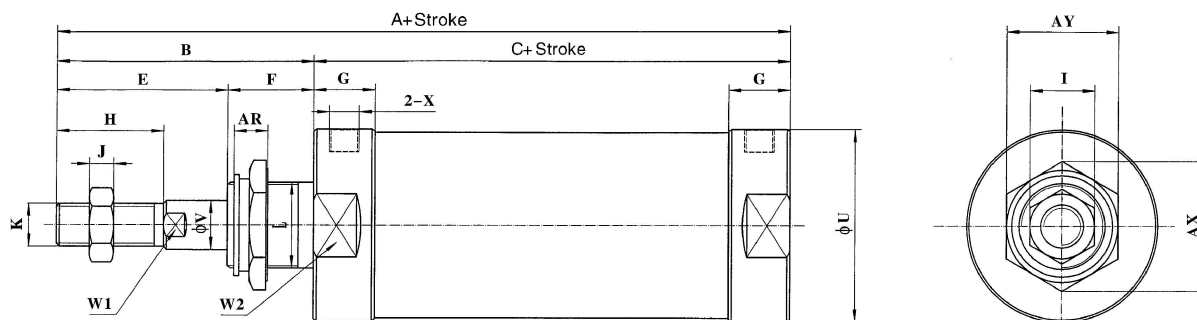

symbol/bore	A	B	C	E	F	G	H	I	J	K	V	X	W1	W2	AR	AX	AY
50	141	56	85	34	22	15	25	16	6	M10 × 1.25	12	G1/8"	10	52	7	53	46
63	145	63	82	38	25	16	30	22	8	M14 × 1.5	16	G1/8"	14	68	7	60	52
70	152	70	82	42	28	16	30	22	8	M14 × 1.5	16	G1/8"	14	74	8	60	52
80	185	80	105	52	28	20	35	22	8	M14 × 1.5	16	G1/8"	14	84	9	60	52