

STIEBEL ELTRON

High Quality

WATER FILTER

by Stiebel Eltron / Germany

USER MANUAL | STIEBEL HOUSE ACTIVATED CARBON BLOCK (ACB) PRE FILTER



STIEBEL HOUSE ACB PRE FILTER

USER MANUAL STIEBEL HOUSE ACTIVATED CARBON BLOCK (ACB) PRE FILTER

1. STIEBEL HOUSE FEATURES.

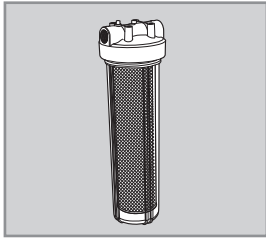

2 filter medias in 1 filter

The high quality of filter media allows for an extraordinary clean, healthy and safe pre filter.

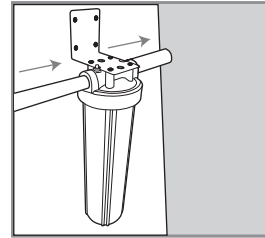

Easy installation

The Stiebel House ACB comes with full set of accessories for both installation and cartridge changing, depends on the size of water inlet pipe in your place, just connect it with your water inlet pipe via adapters* and it is ready to use.

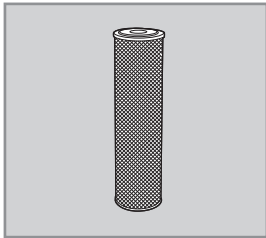

Activated carbon block

Made from high quality coconut charcoal carbon, Stiebel House ACB will efficiently trap harmful contaminants such as chlorine, VOCs, TTHMS, unpleasant taste and odors to provide extra clean and healthy quality to your fresh water.

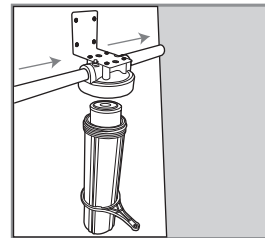

Filter replacement

The Stiebel Eltron Stiebel House ACB cartridge is very easy to change. No plumber or expert is needed.

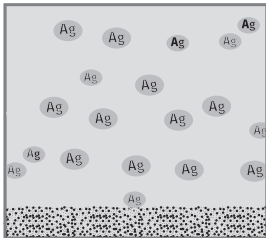

Anti bacteria silver ions

Silver ions impregnated added inside the filter prevents the growth of bacteria inside filter housing and keeps it always fresh.

USER MANUAL STIEBEL HOUSE ACTIVATED CARBON BLOCK (ACB) PRE FILTER

CONTENT.

1. Stiebel House ACB features _____	02
2. Stiebel House ACB components _____	04
3. Operating instruction technical data _____	05
4. Filter media functions _____	06
5. Installation precautions _____	07
6. Installation guidelines (wall mounting only) _____	08-12
7. Filter replacement _____	13-14
8. Trouble shooting _____	15

USER MANUAL STIEBEL HOUSE ACTIVATED CARBON BLOCK (ACB) PRE FILTER

2. STIEBEL HOUSE COMPONENTS.

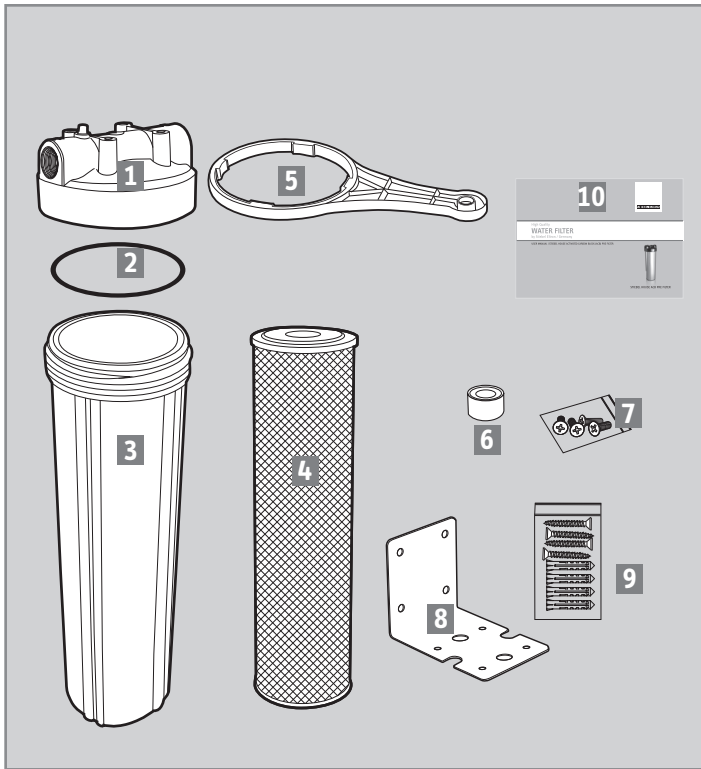

2.1 Accessories provided with the package:

- 1 Head (cap)- 1 pc
- 2 O-Ring - 1 pc
- 3 Housing - 1 pc
- 4 Cartridge ACB - 1 pc
- 5 Wrench - 1 pc
- 6 Watertight seal tape - 1 pc
- 7 Head screw M8 - 4 pcs
- 8 Bracket - 1 pc
- 9 Bracket screw M10 - 4 pcs and wall plug M10 - 4 pcs
- 10 Manual

2.2 Accessories provided by end-user:*

- 1 Pipe adapters - 2 pcs
- 2 Water valve - 4 pcs
- 3 Three-way PVC - 3 pcs
- 4 90° pipe adapter - 2 pcs
- 5 Plastic pipe

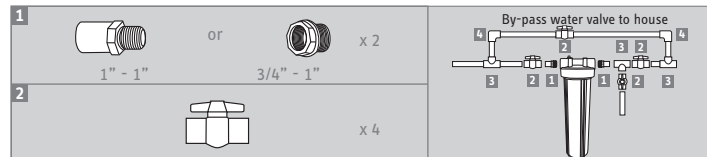

*Size of pipe and accessories will be depended on the existing pipe size at end-user's house.

** It is recommended to install unions at every water valve (4 points) for easier service purposes (in case of valve leakage).

USER MANUAL STIEBEL HOUSE ACTIVATED CARBON BLOCK (ACB) PRE FILTER

3. OPERATING INSTRUCTIONS.

Technical data

Type of Filter	POE (Point Of Entry) Pre Filter	
Model name	STIEBEL HOUSE ACB	
Part number	236621	
Installation type	Wall mounted	
Filter cartridge	Activated carbon block with silver ions	
Housing material	ABS (constructed of durable, high impact plastic)	
Micron rating	5 micron	
Operating pressure (MIN-MAX)	1.5 - 5 bar	
Operating temperature (MIN - MAX)	5 - 35 degree C	
Water source	Fresh water source for daily use (metropolitan, city, rain and ground water sources...) *	
Rated Capacity (at 1.8 bar)	15.0 L per min (when at new cartridge)	
Installation position	After the pump (recommended) and must be after the storage tank	
Unit dimension (with bracket)	61 cm x 18.5 cm x 21 cm (L x W x D)	
Weight (filled with water)	12 kg	
Lifetime **	6 months	
Minimum length required to install the pre filter	with union	110 cm
	without union	80 cm

*: this item is just a pre filter, water after passing this pre filter can not be drunk directly without further water treatment such as a drinking water filter

** : depends on water quality, tested with tap water conditions.

USER MANUAL STIEBEL HOUSE ACTIVATED CARBON BLOCK (ACB) PRE FILTER

4. FILTER MEDIA FUNCTIONS.

Filter step	Removal function
Activated carbon block	Chlorine, VOCs, TTHMs, unpleasant taste, odors, particles bigger than 5 micron, bacteria and heavy metals*
Silver ions impregnated	Prohibits the growth of bacteria inside the filter housing and keeps it always fresh

USER MANUAL STIEBEL HOUSE ACTIVATED CARBON BLOCK (ACB) PRE FILTER

5. INSTALLATION PRECAUTIONS.

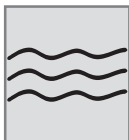

This Stiebel House ACB can only be used with fresh water sources such as metropolitan water, city, rain or ground water supplies via village or town pump. This item is just a pre filter for fresh water uses. Water after passing this pre filter can not be drunk directly without further water treatment such as a drinking water filter.

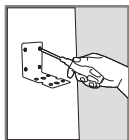

The Stiebel House ACB can only be installed as wall mounted securely via provided bracket and screws. It can not stand alone without securing the screw and the bracket into the wall or well structured frame that can handle its heavy weight under pressure.



To reach an optimized and satisfying pre filter result, the Stiebel House ACB should only be installed after the storage tank with a pipe pressure between 1.5 and 5 bar. Installed before the storage tank is not recommended as there might be not enough chlorine inside the tank to kill bacteria and virus while water is stored

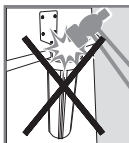

The Stiebel House ACB should not be exposed to force or shock.



The Stiebel House ACB must be installed in a far distance to inflammable materials and heating sources to avoid deformation.



The Stiebel House ACB can be installed both at the Point Of Entry or Point of Use both outside or inside the house.

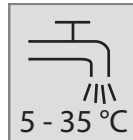

The Stiebel House ACB can only be installed to the cold water supply with a water temperature between 5 and 35°C.



Do not open the filter during water flow.



Do not clean the filter cartridge. Doing so may contaminate or damage the filter unit.

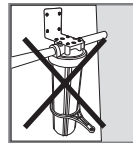

Do not twist the body housing into the head adapter or turn the pipe adapters into threads too tight as the O-ring or the threads of the pre filter can be damaged and it might cause leak in this case.

Please follow installing instruction of the Stiebel House ACB pre filter only as described in this instruction manual. Please consult with the company for any arising installation question before the installation

USER MANUAL STIEBEL HOUSE ACTIVATED CARBON BLOCK (ACB) PRE FILTER

6. INSTALLATION GUIDELINES (WALL MOUNTING ONLY)

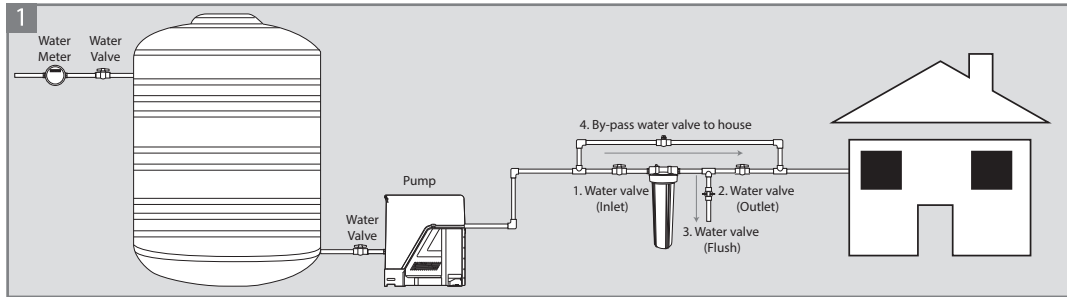

Before the installation, make sure the Stiebel House ACB must be installed after the water storage tank. Install before the pump is possible but not recommended. It is recommended to install the Stiebel House ACB after the pump.

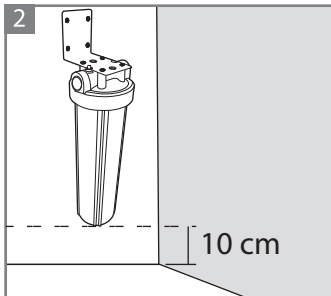

Measure the length of the Stiebel House ACB together with the bracket on. Leave at least 10 cm distance from the ground to the bottom of the pre filter for the service purposes.

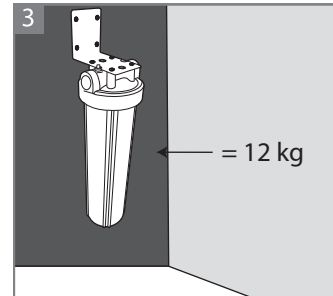

Make sure the wall or frame to install is able to carry the weight of 12 kg when the pre filter is filled with water.

USER MANUAL STIEBEL HOUSE ACTIVATED CARBON BLOCK (ACB) PRE FILTER

6. INSTALLATION GUIDELINES (WALL MOUNTING ONLY)

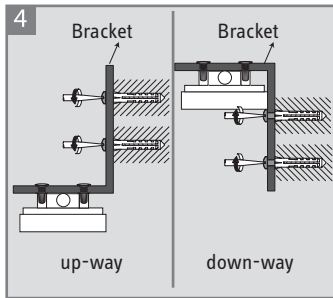

Use the provided bracket to determine the suitable positions to drill the holes to hang the pre filter. Drill the holes carefully. Insert the wall plugs (ensure screw insertion depth is correct). Connect the bracket to the wall and screw in the screws tightly. It is possible to install the bracket both up-way or down-way

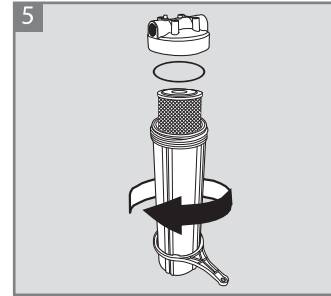

Separate the head (cap) from the housing and its cartridge by using the wrench to turn the housing slowly clockwise until the head is disconnected from the housing. Be ware of the O-ring on the top of the housing and the body housing not falling down.

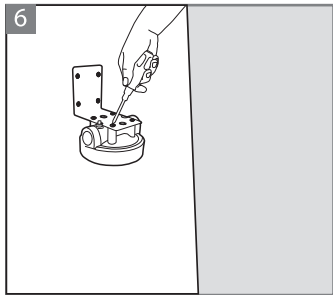

Connect the head part to the bracket . Securely with 4 provided screws.

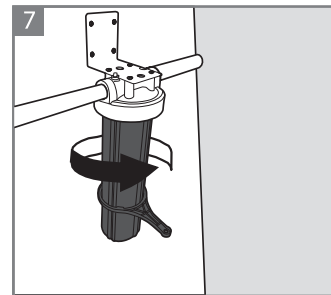

Connect the housing with the cartridge into the head (beware of the O-ring) by using the wrench to turn the housing counter clockwise slowly until it is fit securely into the head part. Do not twist too tight.

USER MANUAL STIEBEL HOUSE ACTIVATED CARBON BLOCK (ACB) PRE FILTER

6. INSTALLATION GUIDELINES (WALL MOUNTING ONLY)

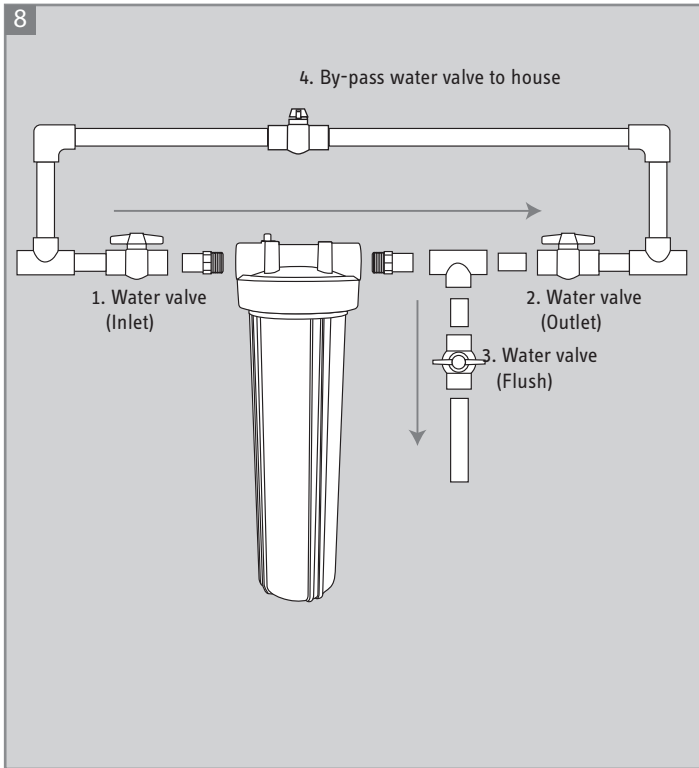

The pre filter Inlet/Outlet size is 1" (female).

Connect the Inlet and Outlet of the pre filter with the existing water pipe together with accessories provided on items 2.1 and 2.2.

Follow the direction as in the left picture.

USER MANUAL STIEBEL HOUSE ACTIVATED CARBON BLOCK (ACB) PRE FILTER

6. INSTALLATION GUIDELINES (WALL MOUNTING ONLY)

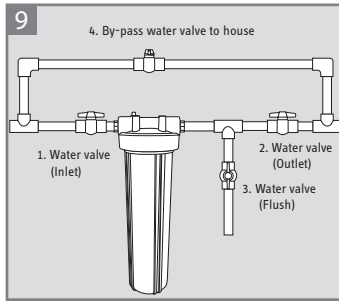

The water valve (3) will be used to flush the new filter cartridge later. Keep the By-pass water valve (4) at the close position all the time.

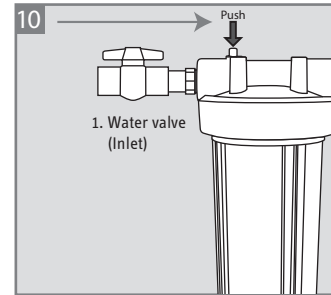

Open water supply into the pre filter, open water valve (1) at the Inlet. Check all connections for leakage. Press the Red button on the head for air releasing after installation. Hold the Red button until all air comes out and when there is water come out together, the air releasing is done.

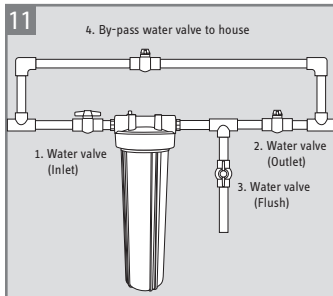

Flush the cartridge. Close the water valve (2), open the water valve at the Inlet (1), open the water valve (3) to flush the possible residual of black carbon powder away until there is no black carbon powder to be seen, close the water valve (3), open the water valve at the Outlet (2) to supply water normally into the house. The Stiebel House ACB is now ready to use.



Fill in "Start Using Date" and "Estimated Cartridge Changing date" into the Lifetime sticker on the pre filter housing. If you are unsure about the lifetime of the cartridge, please consult with the company.

USER MANUAL STIEBEL HOUSE ACTIVATED CARBON BLOCK (ACB) PRE FILTER

6. INSTALLATION GUIDELINES (WALL MOUNTING ONLY)

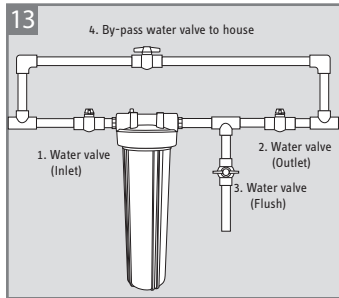

When there is trouble with the pre filter system (leaking, clog), please use the by-pass system by opening by-pass water valve (4). Close water valve (1) and (2) to use tap water directly (without passing the ACB pre filter). Call for Stiebel Eltron or our nearest service team for checking.

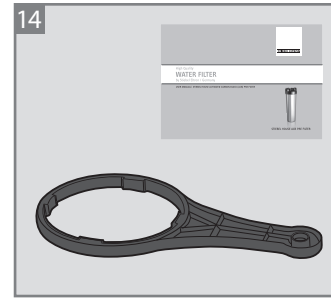

Keep the manual and wrench carefully for the next cartridge changing.

Note.

The Red button on the head of the pre filter is used to release air inside the filter housing should air happened inside the water pipe system. When the water flow is slow, try to press this Red button to release possible air inside the filter housing to let water run normally. It should be done right after the water supply is cut off and when water is supplied again, Tap water carries along many air inside the system. These air might affect the flow out smoothly of the pre filter. Or Press the Red button any time you think there is air inside the filter housing. There will be a little amount of water coming out together with air when you press this button, it is normal in this case.

USER MANUAL STIEBEL HOUSE ACTIVATED CARBON BLOCK (ACB) PRE FILTER

7. FILTER REPLACEMENT

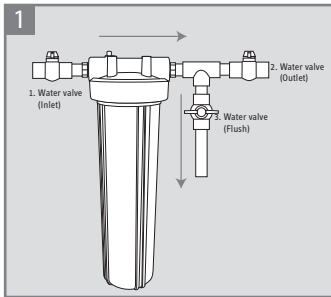

Close the water valve (1) at the Inlet and the water valve (2) at the Outlet.

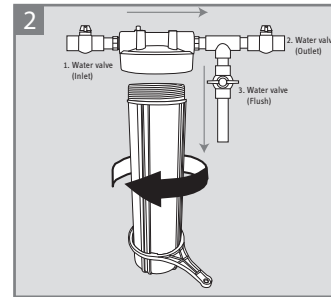

Using the wrench to turn the filter housing clockwise until it looses out from the head.

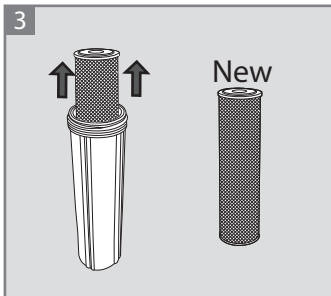

Take out the old filter cartridge. Pour out left water from the housing, clean it with water (only) if needed. Insert the new Stiebel House ACB cartridge into the housing.

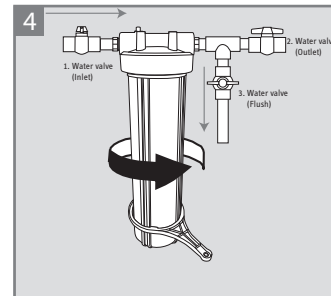

Using the wrench to close the filter housing to the head by turning it counter clockwise slowly until it is tightly enough. Do not twist the filter housing too tight to avoid the damage of the threads or the O-ring.

USER MANUAL STIEBEL HOUSE ACTIVATED CARBON BLOCK (ACB) PRE FILTER

7. FILTER REPLACEMENT

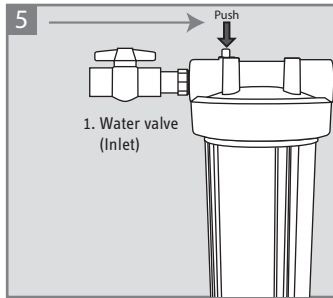

Open water supply into the pre filter by open water valve (1) at the Inlet. Check all connections for leakage. Press the Red button on the head for air releasing after installation. Hold the Red button until all air comes out and when there is water come out together, the air releasing is done.

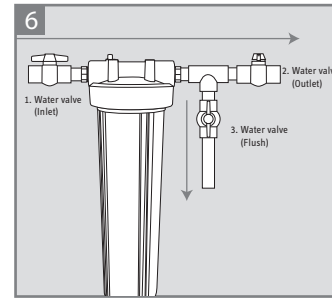

Close the water valve (2) at the Outlet, open the water valve (1) at the Inlet, open the water valve (3) to flush the possible residual of black carbon powder away until there is no black carbon powder to be seen.

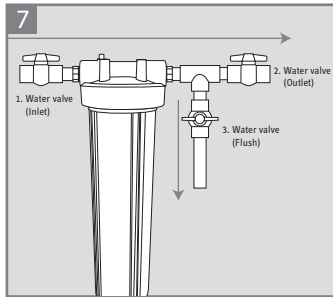

Close the water valve (3), open the water valve (2) at the Outlet to supply water normally into the house.

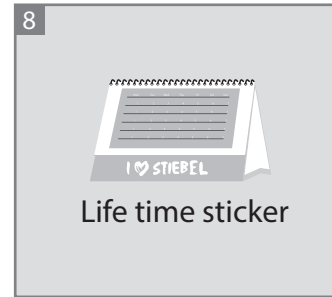

Replace the Lifetime sticker with the new one on the pre filter housing. Fill in "Start Using Date" and "Estimated Cartridge Changing date". If you are unsure about the lifetime of the cartridge, please consult with the company. The Stiebel House ACB is now ready to use.

USER MANUAL STIEBEL HOUSE ACTIVATED CARBON BLOCK (ACB) PRE FILTER

8. TROUBLE SHOOTING.

Problems	Possible cause	Trouble shooting
Water not flow or flow slowly into the tank or into the house	Air block because water comes in with air	Press "Red" button on the Head to release air from the filter housing if any.
	Clog	Change filter cartridge.
	Low pressure	Check inlet pressure min 1.5 bar needed.
Found smell at fresh water or strange taste/smell at water outlet	Lifetime finish	Change the filter cartridge.

GERMANY

STIEBEL ELTRON INTERNATIONAL GMBH | DR.-STIEBEL-STRASSE | 37603 HOLZMINDEN
PHONE +49 5531 7020 | E-MAIL INFO@STIEBEL-ELTRON.COM | WWW.STIEBEL-ELTRON.COM

THAILAND

STIEBEL ELTRON ASIA CO.,LTD | 469, MOO 2, TAMBOL KLONG-JIK, AMPHUR BANGPA-IN,
AYUTTHAYA, 13160
CUSTOMER CONTACT CENTER PHONE: +66 2021 9300
E-MAIL: INFO@STIEBELELTRONASIA.COM | WWW.STIEBELELTRONASIA.COM

Size:A5

Material: White paper 80 g.

Plastic bag : 7 x 11 INCH

Product code : STIEBEL HOUSE ACB : 236621

Part name : OPERATING INSTRUCTION STIEBEL HOUSE ACB

Rev.02

Part no. 327958



STIEBEL ELTRON