

MANUAL INSTRUCTION

Switch Remote Controller for Pool Light

(V2.1-EN)



Thank you for choosing our company's SWITCH REMOTE CONTROLLER. Before installing and using this product, please carefully read this manual to ensure complete understanding and avoid damage and additional costs. Before unpacking and using, please verify if the product has been damaged during transportation. If any damage occurs, please notify our company immediately and stop using the damaged product.

1.WIRING DIAGRAM

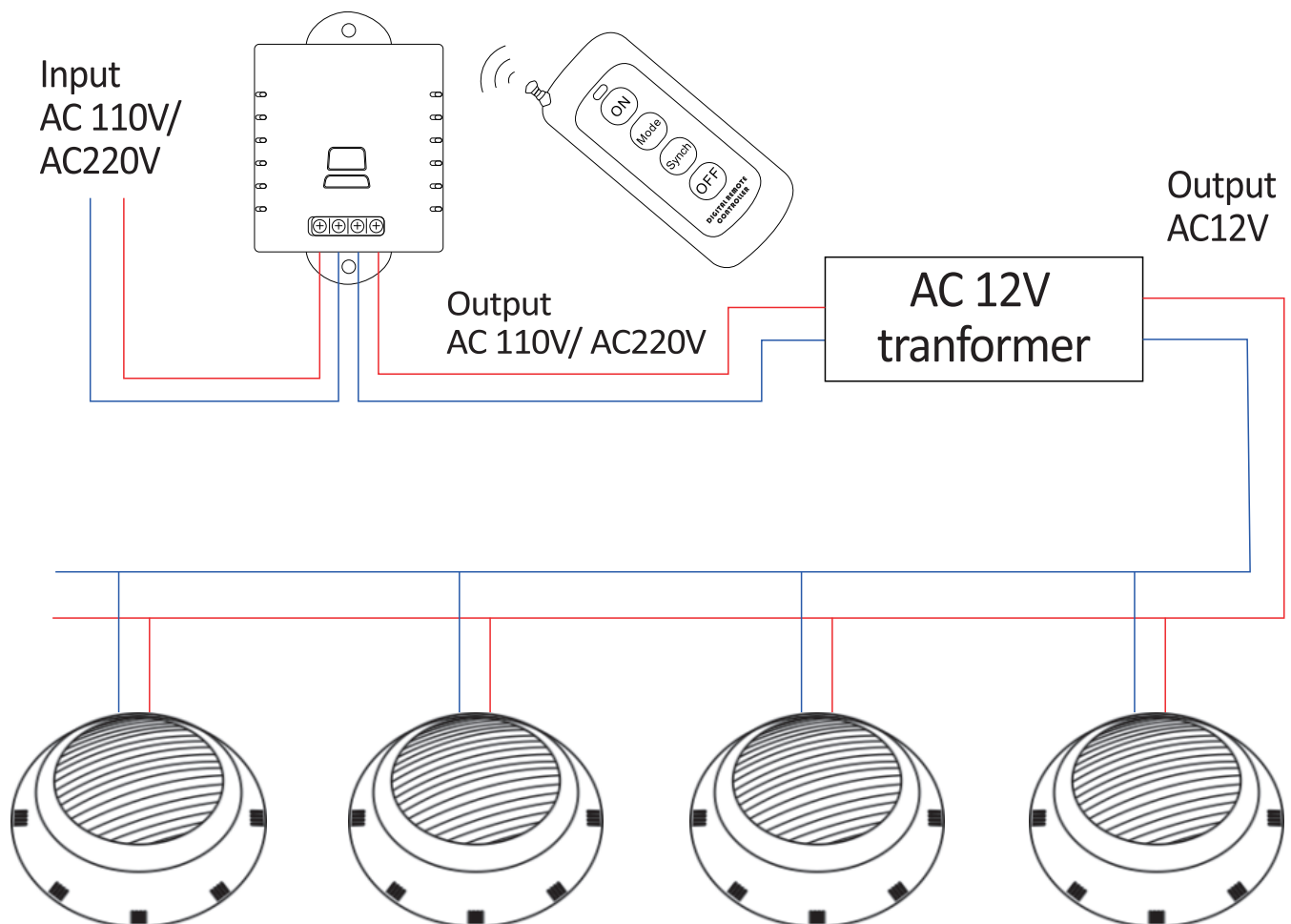

WARNINGS:

- The transformer's output must be **Voltage 12V AC. Don't use electronic transformers which may damage the light.** You should use industrial frequency transformer, such as toroidal transformer and square transformer .
- The persons who are in charge of installation should have the required qualifications for this type of work.
- Avoid making contact with the electric voltage.
- Replacement must be performed with the lamp disconnected from the electric power system .
- Do not handle any electrical components with wet feet.

2.PROGRAMS OPERATING MANUAL

2.1 Remote control Pairing & Unpairing with the controller

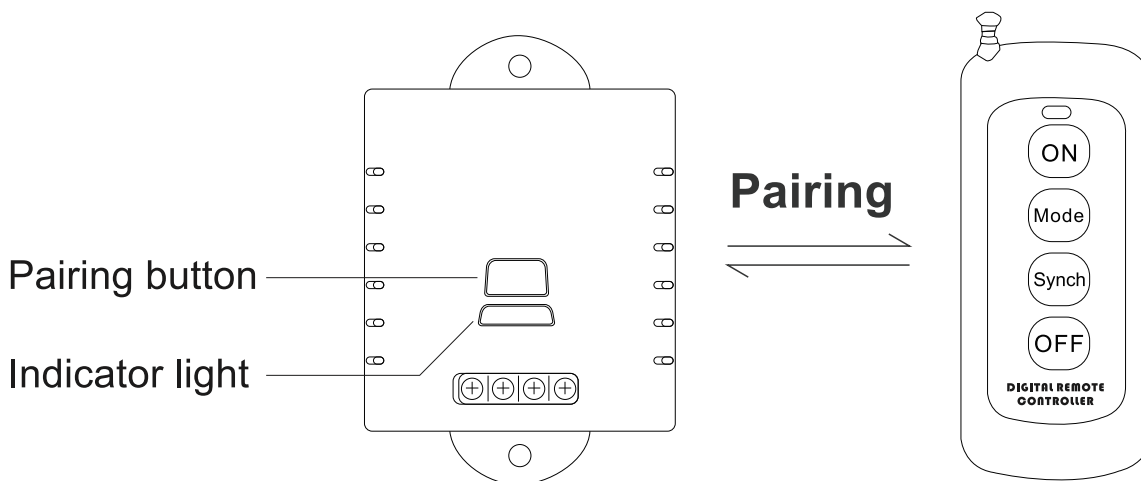

Pairing ▼

- Short press: Turns the device on/off.
- Long press (3 seconds): Enters learning mode , indicated by the light slowly flashing while waiting for pairing.
- Press any button on the remote control to complete pairing.

Unpairing ▼

- Long press (8 seconds): Enters pairing reset mode, indicated by the light quickly flashing when the reset is successful.

2.2 Remote control function

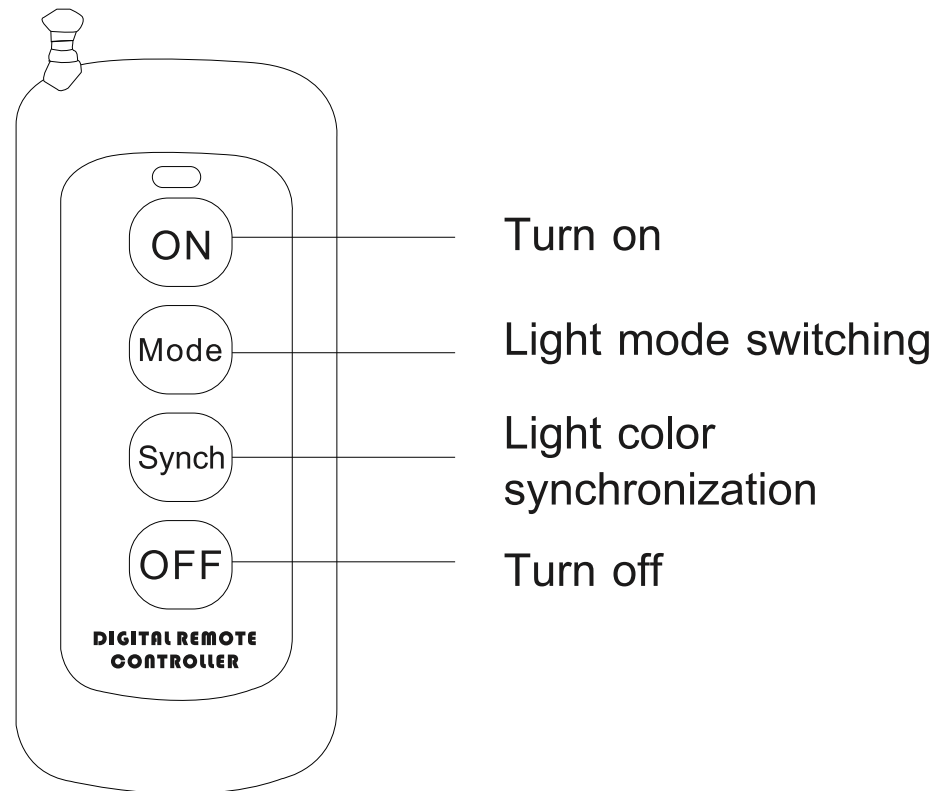

3.MAINTENANCE & REPLACEMENT:

There is no maintenance required – it is designed to be used only once, meaning that replacement is not necessary if it becomes defective (repairing is impossible). Before any handling, ensure there is NO voltage supplied.



4. THE OPERATION METHOD OF SWITCH REMOTE CONTROL MODEL HT-N3E (4 BOTTONS)

1. Because our swimming pool lights all have a memory function, there will be a memory mode every time you turn it on, and the color you turned off last time will appear. Turn off the power, and then turn on the power again within 1 to 3 seconds. The LED light will enter the next mode.

2. The mode sequence is $R \rightarrow G \rightarrow B \rightarrow RB \rightarrow GB \rightarrow RG \rightarrow W \rightarrow$
 $RGBW \text{ jump} \rightarrow \text{Multi-color jump} \rightarrow RGBW \text{ gradient mode} \rightarrow$
 $\text{Multi-color gradient mode} \rightarrow \text{All effect cycle mode switching}.$

RGBW Jump: $R \rightarrow G \rightarrow B \rightarrow W$ Jump

Multi-color jump: $R \rightarrow G \rightarrow B \rightarrow RG \rightarrow GB \rightarrow RB \rightarrow W \rightarrow RB \rightarrow GB$
 $\rightarrow RG \rightarrow B \rightarrow G \rightarrow R \rightarrow G \rightarrow R \rightarrow G \rightarrow R \rightarrow B \rightarrow R \rightarrow B \rightarrow G \rightarrow B \rightarrow$
 $G \rightarrow B$

RGBW gradient mode: $R \rightarrow G \rightarrow B \rightarrow W$ slowly changes

Multi-color gradient mode: $RG \rightarrow GB \rightarrow RB \rightarrow RGB \rightarrow R \rightarrow G \rightarrow B$
 $\rightarrow RGB \rightarrow RB \rightarrow B \rightarrow GB \rightarrow G \rightarrow RG \rightarrow G \rightarrow GB \rightarrow B \rightarrow RB$

All effect cycle mode switching: All of the above lighting effects change in a loop!

——It is worth noting that:

If the first color that appears after you turn it on is not red, please do not doubt it, because for some lights, we changed the mode during the test, so the first color after turning it on may not be red, but the above order must be consistent!

For example:

When I turn on this light, the first color that appears is G, then when I press the mode button again, its next color must be B!

3.If the lights are out of sync, how do you synchronize them?

— Click the sync button and wait for the lights to jump 8 times, then the color of GB will appear and the lights will be synchronized!