

CHASING Hydro6 UV

EN User Manual

CHASING

www.poolmatebot.com

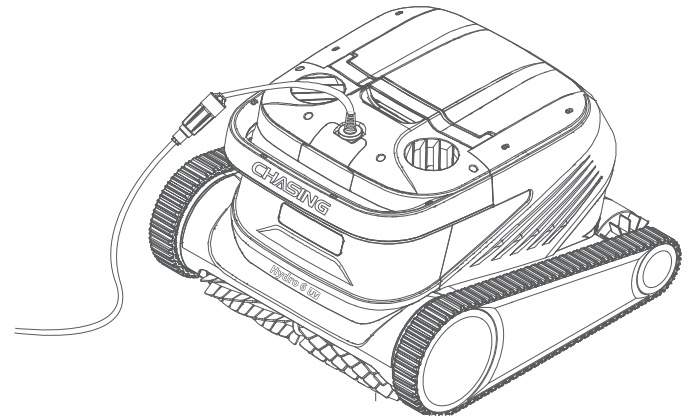

CHASING

V1.1

Table of Contents

EN

Disclaimer	02
Main Components.....	03
Cleaner	03
Power supply	04
Nylon mesh filter board.....	04
Notices	04
Connection and Operation	05
Preparation before cleaning	05
Power supply	07
Cleaner indicator light.....	07
After cleaning.....	08
APP	09
Download the CHASING GO3 APP.....	09
Bluetooth Connection	09
Remote control	10
Homepage	11
Appointment	12
UV sterilization function	12
Manual	14
Mine	14
Daily Maintenance	15
Clean the filter basket	15
Disassemble and replace the filter board	16
Storage	17
Fault Information	17
Product Parameters	18
After-sales	18

! Disclaimer

Please read this Disclaimer carefully before using CHASING Hydro6 UV. Once this product is used, it shall be deemed that the user recognizes and accepts all contents of this disclaimer.

EN

For personal injury, property loss, etc. (including direct or indirect loss) from using this product due to the following reasons, CHASING shall assume no compensation liability:

1. Damage from use by the operator in poor physical or mental condition.
2. Personal injury, property loss, etc. caused by subject intent of the operator.
3. Compensation for any related damage caused by accidents.
4. This product is not properly assembled or operated as instructed in this manual.
5. Other damages caused by poor running of the whole cleaner due to arbitrary modification or replacement of non-CHASING accessories or parts.
6. Damages caused by use of products not produced by CHASING or simulating products of CHASING.
7. Compensation for damages caused by operation error or false subjective judgement of the operator.
8. Poor running of the cleaner due to its natural wear and tear, corrosion, line aging, etc.
9. Other losses beyond liability scope of CHASING.

Main Components

EN

Cleaner

CHASING Hydro6 UV, an automatic pool cleaner specially developed for pool cleaning, substitutes the traditional cleaning method to free our hands and clean the floor, walls and lane lines of the swimming pool automatically. With the design of UV bactericidal lamp that can sterilize the filter basket efficiently and CHASING-Clean technology, CHASING Hydro6 UV is applicable to swimming pools of various shapes and capable to realize high coverage and time efficiency of cleaning areas. Its double precision filter screens can accurately filter various dirt and pollutants in the pool. CHASING GO3 App, a new developed application program, is also provided for the cleaner to bring users a more intelligent, convenient and economic method to clean the swimming pools.

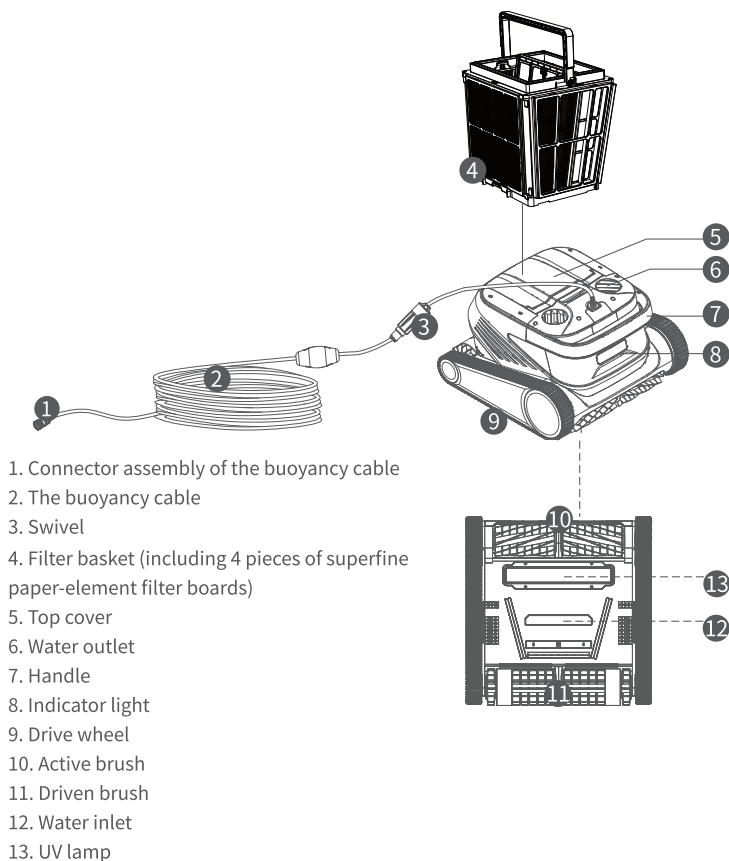

Power Supply

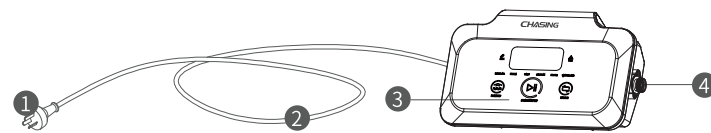

Nylon Net Filter Board (1F&2B&3L&4R&5M)

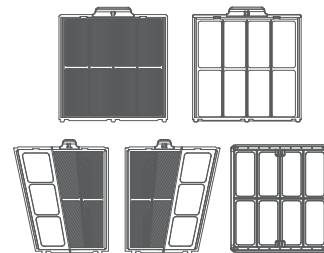

Notices

- ⚠ Warning: Please read the Instruction for Use carefully, and use this product according to the Instruction for Use. Our company is free of liability for any loss or injury from improper use.
- ⚠ Warning: Unless supervised by parents on site, children are forbidden from getting close to and using this product.
- ⚠ Warning: Protection grade of the power supply is IP54, and the power supply shall be used in dry and shade place more than 3m away from the pool edge and more than 0.1m above the ground, away from direct sunshine. In addition, the power supply shall be reliably grounded, and must be connected to circuit with Ground Fault Circuit Interrupter for use, and before use, GFCI shall be tested for normal work.
- ⚠ Warning: Only professional personnel of distributors with authorization and training is allowed to disassemble, replace and repair parts of this product, otherwise, this product may loss warrant right, and may cause personal injury.
- ⚠ Notice: The cleaner can be used in swimming pool water only, not in other working environment; when the cleaner is working, personnel is forbidden from entering the swimming pool.
- ⚠ Note: Do not direct the eyes when switching on the UV lamp to avoid injury.

- ⚠ Notice: When the cleaner is working, please do not touch the rotating components with hands directly.

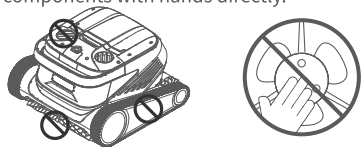

- ⚠ Notice: Hold the handle when placing the cleaner into water or taking it out of water, and it is forbidden from pulling the buoyancy cable directly.
- ⚠ Notice: Do not use this product in the swimming pool water added with liquid flocculating agent or other clarifying agents, otherwise, it may block or damage filter components of the cleaner.

- ⚠ Notice: Please use the cleaner in the following specified environment:

Working Depth	0.8-5m
pH	7-7.8
Chloride	Maximum 2 ppm

Working temperature	10-35°C
Salt	Maximum 5000 ppm

- ⚠ Notice: The cleaner and the power supply may power off automatically due to triggering of high-temperature protection if used in working temperature beyond stipulation or subject to high-strength and long-time sunshine, which may cause damage to the product in severe condition.

Connection and Operation

① Preparation before Cleaning

1.1. The power supply should be placed at least 3m away from the pool edge in a cool and dry place, and kept away from direct sunlight.

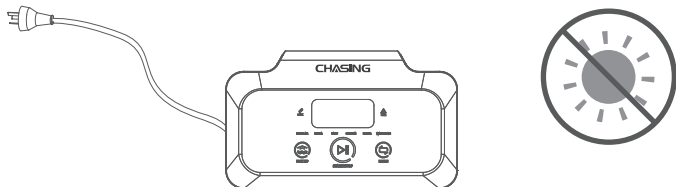

1.2. Lay out the cleaner's buoyancy cable in order, and then insert one end of the buoyancy cable into right interface of the power supply, and tighten the nuts.

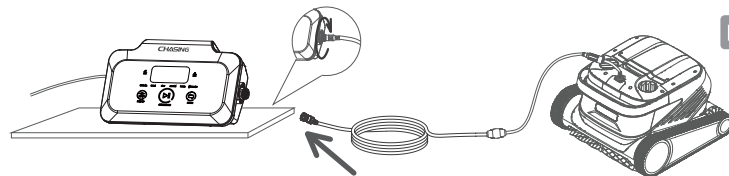

- ⚠ Notice: The power supply shall be placed on a table or other platform.

1.3. Hold handle of the cleaner and place it in water slowly, wait until the cleaner is fully immersed in water and discharges no air, and confirm that the buoyancy cable is neither knotted nor wound by any obstacle.

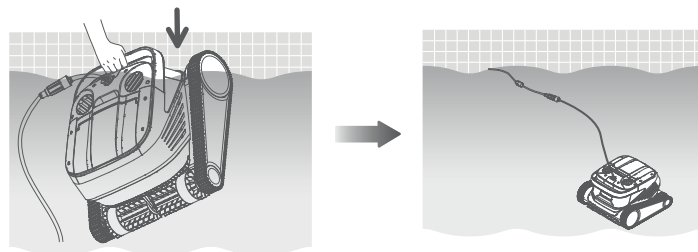

- ⚠ Notice: It needs to place the buoyancy cable in water appropriately, to guarantee that the cleaner can clean various areas of the pool, and the cleaner will tilt its head or fail to perform cleaning if the buoyancy cable is not long enough.

Note: The robot has a water detection sensor. If not entering water, the robot will not be started.

1.4. ① Insert power cable on the left of the power supply into the socket (AC 100-240 V). ② At this time, START/STOP button of the power supply will be always yellow, and the cleaner enters standby status.

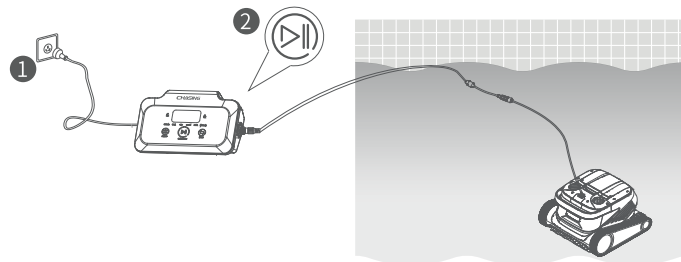

2 Power Supply

2.1. Some basic functional operations of the cleaner can be performed via the power supply (by using app), after selecting corresponding mode, the cleaner can start automatic cleaning of the swimming pool immediately by clicking START/STOP.

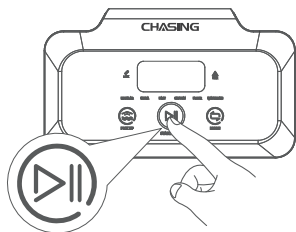

2.2. Function and indicator light on the interface

Icon	Description	Description	Features
Button		START/STOP	Short Press: Start/Suspend; Long Press: Stop
		Pick-Up	Short Press: enter the pick-up mode
		Mode Switching	Short Press: Switch the cleaning mode (custom mode shall be set in APP)
Indicator light		LINK	Connection status of the power supply and LINK
		Error	The cleaner and the power supply prompt error
	REGULAR	Standard Mode	2h; pool bottom, pool wall and waterline
	ULTRA	Enhancement Mode	3h; pool bottom, pool wall and waterline
	FAST	Rapid Mode	1h; pool bottom, pool wall and waterline
	CUSTOM	Custom Mode	Set in APP
	FLOOR	Pool Bottom Mode	2h; pool bottom
	WATERLINE	Waterline Mode	2h; pool wall and waterline
Count-down display		Cleaning Count-down	Display the remaining cleaning time
Control box fault codes	E:00	Abnormal communication between the power supply and the robot	E:01
	E:02	Accelerometer failed	E:15
	E:35	All drive motors failed or rotor blocked	E:16
	E:36	All pump motors failed or rotor blocked	E:25
			E:26

* After the power supply is not operated for 3 minutes, the light indicator will enter sleep state (only the ON and OFF buttons will light up). Click on any button at random to wake up the light indicator when it is off (the corresponding function of the button will not be triggered before waking up the light indicator).

3 Indicator Light of the Cleaner

Light status	Description
White light on	Self-inspecting
Yellow Light Steady On	Standby in water
Orange constantly on	Not placed in water
Green light flickers	Cleaning Suspended
Green light on in a circular way	Cleaning (UV not switched on)
Blue Light Flow	Cleaning (UV switched on)
Yellow light is on in a circular way	Prompt for blocked motor rotor
Red light flickers	Abnormal errors of the cleaner
Cyan Light Flowing	Remind the filter blockage

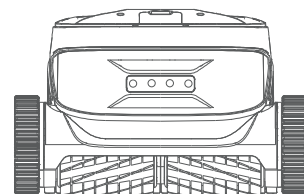

4 After Cleaning

Method 1:

1. Click “Pick-Up” button in the power supply or the App.

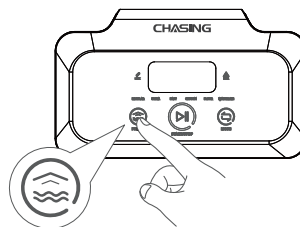

Power Supply

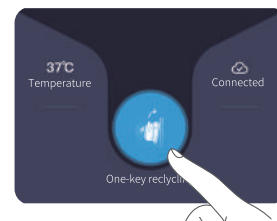

App

2. Wait for the cleaner to get close to waterline position of the swimming pool automatically.
3. Hold the handle of the cleaner to pull it out of the water surface, and hang it above the water surface for 10-20s to empty the water inside it.

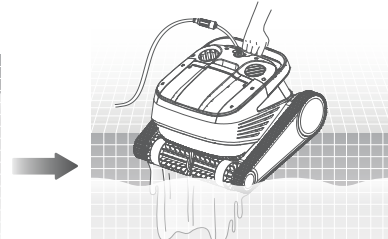
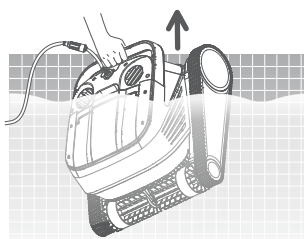

Method 2:

1. Stop the cleaner.
2. Pull the buoyancy cable slightly to enable the cleaner in water to move to water side slowly.
3. Hold the handle of the cleaner to pull it out of the water surface, and hang it above the water surface for 10-20s to empty the water inside it.

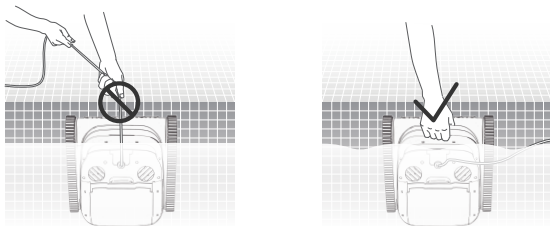

⚠ Note: It is forbidden from pulling the buoyancy cable directly on water surface, so as to avoid fracture and damage.

APP

① Download the CHASING GO3 APP

CHASING GO3 APP: (applicable to iOS 11.0/Android 7.0 and above versions)
Scan the QR to download or visit iOS App Store/ Google Play/Official Website of CHASING for downloading.



② Bluetooth Connection

1. Click “CHASING Hydro 6” on the “Device Selection” page.
2. Click “Go to Connect” .



3. When finding a new device, click on it to connect, and then enter the “Home” page after successful connection.

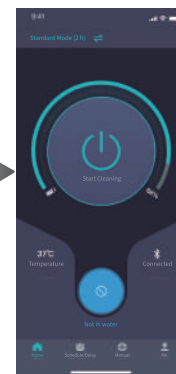

③ Remote Control

1. It is required to log in to your CHASING account before enabling “Remote Control”.

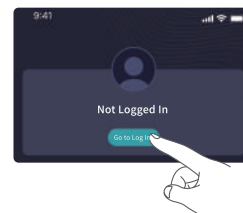

2. In the "Cloud Service" interface, follow the prompts to connect the robot to the network, and then apply the remote control function.

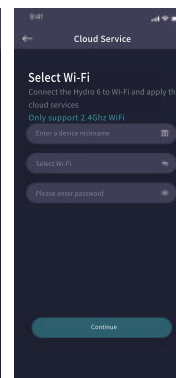
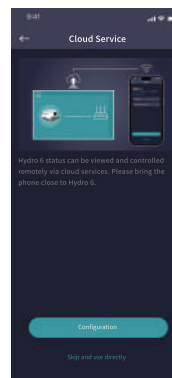
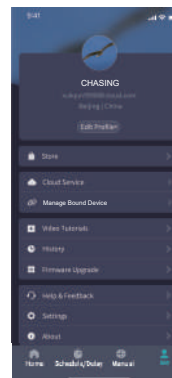

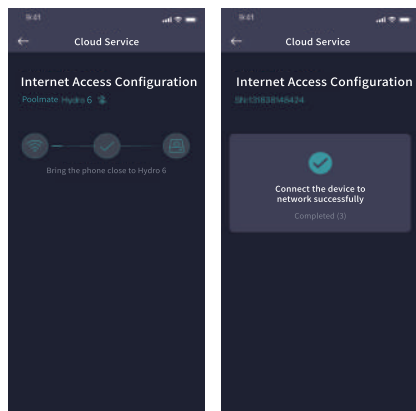

You can unbind the devices and add new devices via “Manage Bound Devices”.

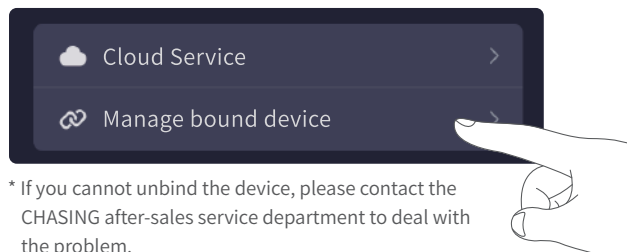

④ Homepage

When the cleaner is in a holding state and is placed into the swimming pool, Create Appoint Cleaning can be performed to complete unattended operation.

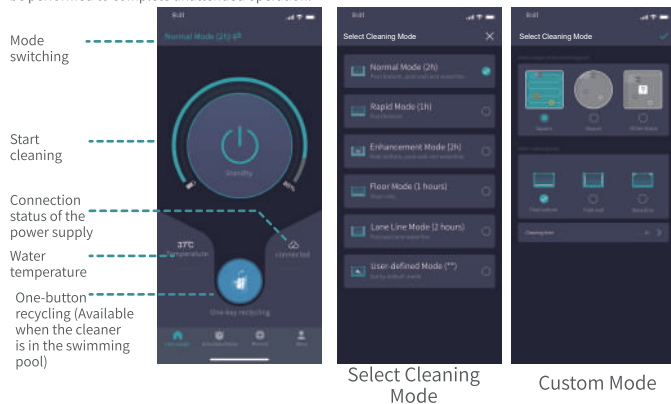

⑤ Appointment

When the cleaner is in a holding state and is placed in the swimming pool, Create Appoint Cleaning can be performed to complete unattended operation.

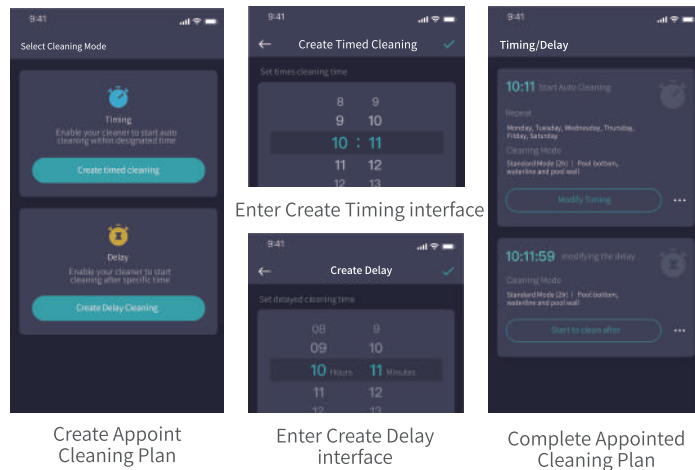

⑥ UV sterilization function

1. Switch-on method

- Connect the cleaner successfully, and click on the UV icon in the upper right corner on the Homepage
 - A warning message is displayed. Click on “Open”.
- Note: It can be switched on only after it is put in water or set in cleaning mode; otherwise it may cause damage to skin and eyes. Please use it in a safe way and prevent against direct exposure.

2. Switch-off method

- Switch off automatically at the end of cleaning mode
- Manually click on the UV icon in the upper right corner to close

Operation and Use of UV Lamp

EN

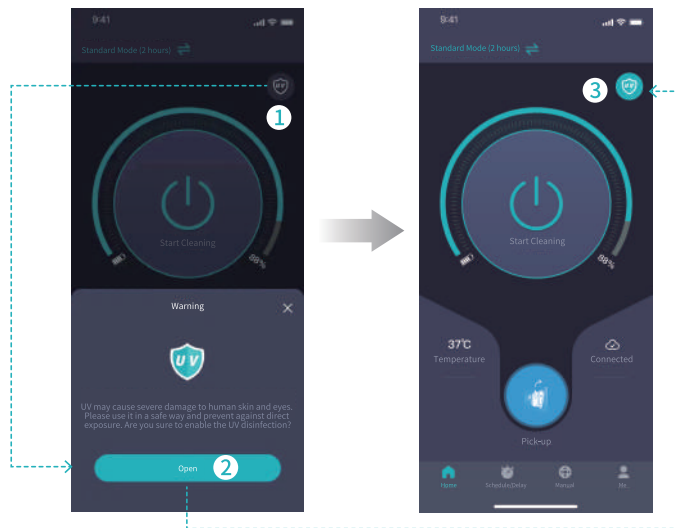

ON



OFF

Short press UV button: On / OFF

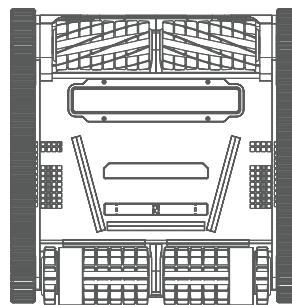

OFF

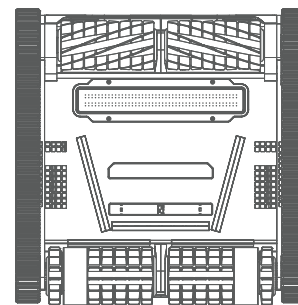

ON

*UV may cause severe damage to human skin and eyes. Please use it in a safe way and prevent against direct exposure.

7 Manual Mode



Manual switch

Control movement of the cleaner via a remote-control lever

8 Me

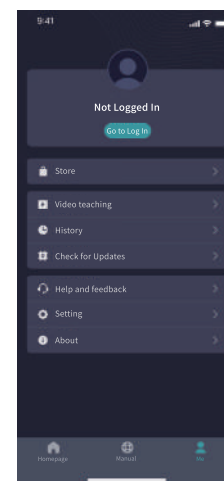

EN

Daily Maintenance

EN

① Clean the Filter Basket

1.1. Open the top cover of the robot, and take out the filter basket.

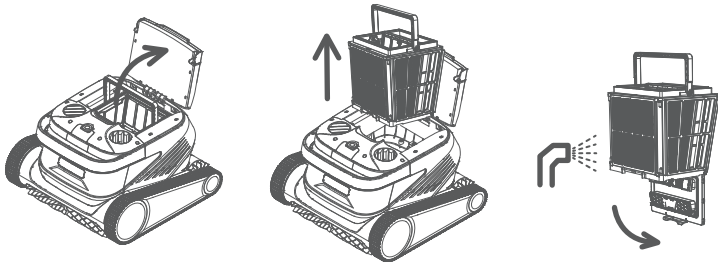

1.2. Cleaning the filter basket with a water pipe.

1.3. Place the filter basket back to the cleaner upon cleaning.

⚠ Note: Before cleaning, the cleaner shall be disconnected from the power supply first, and the filter basket shall be cleaned timely every time after use, so as to avoid impact on the cleaning performance.

② Disassemble and Replace the Filter Board

2.1. Disassembly: Press the filter basket with hands, and then pull out the filter boards surrounding the filter basket in the sequence of 5M→1F→2B→3L→4R upward.

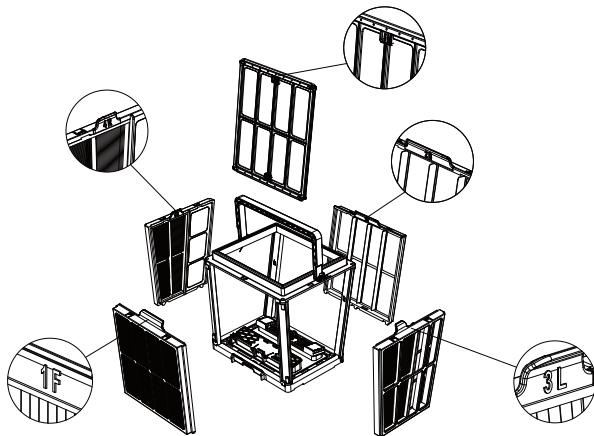

2.2. Installation: Install the new filter board in the filter basket in the sequence of 4R→3L→2B→1F→5M, and then the replacement is completed.

EN

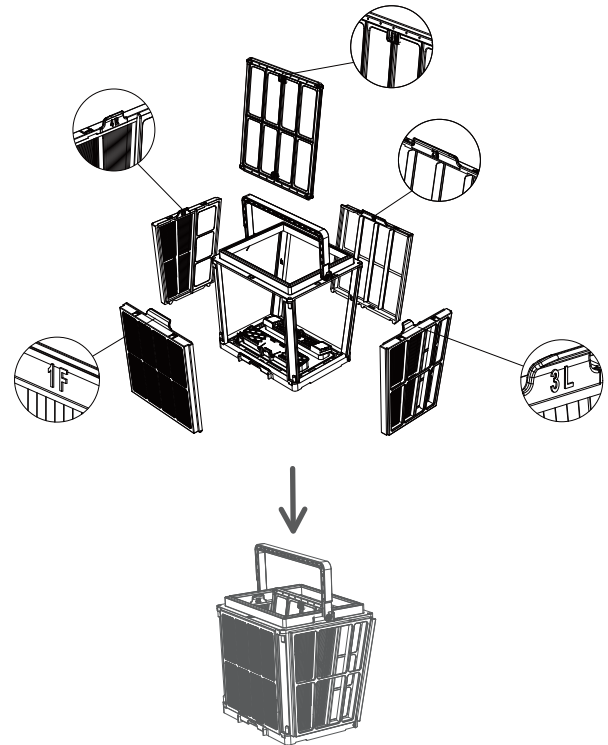

⚠ Note: Superfine paper-element filter board is a fragile product, and can filter smaller particular contaminants, therefore, in order to guarantee cleaning performance of robots, it is suggested replacing the superfine paper-element filter board at least once every three months if using the cleaner.

③ Storage

If the cleaner is not used for a long time, please operate according to the following steps:

1. Clean the filter basket and the filter board thoroughly, and then place them in the cleaner.
2. Ensure no water left inside the cleaner.
3. Roll up the buoyancy cable without knots.
4. Store in interior shade and dry place at 5-45°C.

Fault Information

Fault phenomena	Possible causes	Exclusion method
The buoyancy cable is knotted	The buoyancy cable fails to be fully stretched	Unplug power line of the power supply, and re-arrange the buoyancy cable
	There are obstacles in the swimming pool	Remove the obstacles
	The cleaner runs for a long time	Arrange the buoyancy cable manually
The cleaner is not started up	There is no voltage output from the wall socket	Inspect whether there is voltage with the socket on the wall
	The power line fails to be properly inserted	Insert the power line firmly
	The buoyancy cable fails to be properly connected	Inspect whether both ends of the buoyancy cable are normally connected
	The track is stuck by foreign matters	Check whether the track is stuck and remove the foreign matters
	The track falls off	Re-install the track on the drive wheels
	The cleaner is not placed in water	Put the cleaner into water
The cleaner moves but fails to clean the swimming pool effectively	The cleaner or the power supply is of electrical damage	Check the error code and contact the after-sales distributor
	The filter basket is blocked	Clean the filter basket
The cleaner can't climb the wall	The impellers are blocked by foreign matters	Inspect whether the impellers are stuck and remove the foreign matters
	The filter basket is blocked	Clean the filter basket
	The temperature or pH value is improper	Use in swimming pool conforming to required temperature and PH
	There are algae on the wall	Inspect chemical substance content in water and scrub the wall
The cleaner only cleans a part of the swimming pool	The power supply is unreasonably positioned	Place the power supply in appropriate position, enabling it to reach various regions of the swimming pool
	The buoyancy cable is not long enough	Unplug power line of the power supply and re-arrange the buoyancy cable
	The filter basket is blocked	Clean the filter basket
	There are obstacles in the swimming pool	Remove the obstacles

Product Parameters

Dimension of cleaner	485 x 475 x 342 mm
Weight of cleaner	12.5 kg (without cable)
Dimension of power supply	352 x 82 x 211 mm
Weight of power supply	2.3 kg (without cable)
Filter precision	Hyper-fine
Cable length	18/25m
Rated input voltage	AC 100-240V;50-60Hz
Rated working voltage	DC 24 V
Power	Avg. input power: 250W
	Max. input power: 320W
Operating depth	0.8~5 m
Pool Size (L*W)	Up to 15m
Cleaning area	Pool bottom, pool wall and waterline
UV lamp	Support

Movement speed	15 m/min
Protection grade of cleaner	IP68
Protection grade of power supply	IP54
Anti-tangle cable	Support
Active brushes	2
Pump motors	2
Drive motors	2
APP	Support
Appointment enabled	Support
Manual mode	Support
Water temperature display	Support
Working temperature	5-35°C
Storage temperature	5-45°C
Cloud Service	Support

After-sales

1. In case of any doubt or technical problem, please send e-mail to CHASING after-sales personnel or contact E-chat customer service personnel on the official website.

After-sales e-mail address:

support01@poolmatebot.com -- Europe

support02@poolmatebot.com -- Asia & Oceania

support03@poolmatebot.com -- North and South Americas & Africa

2. You can view video teaching in App menu, official website support and official WeChat account, to obtain a better use experience.

CHASING

This guide may be updated without notice.

Visit the official CHASING website for the latest version: <https://www.poolmatebot.com>