

## CORKJOINT® N.E.C RESIN BONDED (TYPE II) CORK FILLERBOARD



### PRODUCT DESCRIPTION

CORKJOINT® N.E.C Cork Fillerboard is manufactured to ASTM Type II from high grade granulated cork and resin binders making it highly suitable as a fillerboard support for joint sealants for use in movement joints.

The high density of CORKJOINT® N.E.C Cork Fillerboard ensures long life compression/recovery and allows it to be drilled for dowel joints to pass through. CORKJOINT® N.E.C Cork Fillerboard is supplied in sheets of 915mm X 610mm in a variety of thicknesses.

CORKJOINT® N.E.C Cork Fillerboard contains only natural clean cork and bound together with a resin and can be supplied on site with a Tear Off Cap which allows for removal and a sealant placed over if required.



### AREAS OF APPLICATION

- Heavy trafficable areas
- Water tanks
- Ideal for wet areas
- Pedestrian malls
- Water treatment plants
- Dams
- Sewage treatment plants
- Reservoirs
- Footpaths
- Highways and bridges
- Airport runways
- Swimming pools
- Brick or block walls
- Driveways

Note: The product's design and performance, its intended use, installation and final confirmation and approval for use, must be provided by the project's Design Engineer and Project Manager.



### PHYSICAL PROPERTIES

PROPERTY	SPECIFICATION	METHOD	UNIT	RESULT
Compressibility (Original, 100 psi)	40 - 60	ISO 7322	%	48
Density (Thickness Method)	120 - 180	ISO 7322	Kg/m <sup>3</sup>	160
Recovery (Original, 100 psi)	> 75	ISO 7322	%	76
Tensile Strength (Original, with grain)	> 200	ISO 7322	KPa	211

Note: The above physical properties are from Certificate of Analysis dated 07/06/2018. Material properties can vary between batches of ± 10%.



## INSTALLATION PROCEDURES

**CORKJOINT® N.E.C Cork Fillerboard** is supplied to site packaged and ready for use and is simply glued to the existing concrete and the concrete poured against it, a Tear Off Cap can be then removed for any sealant required over the joint.



## TYPICAL APPLICATIONS

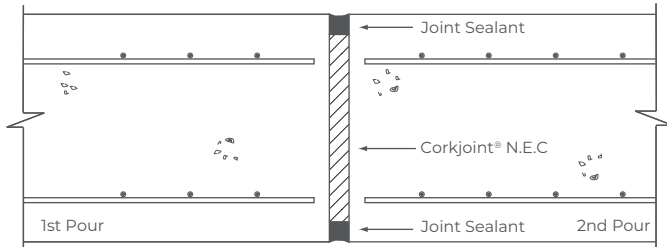

EXPANSION JOINT IN SLAB OR IN WALL JOINT

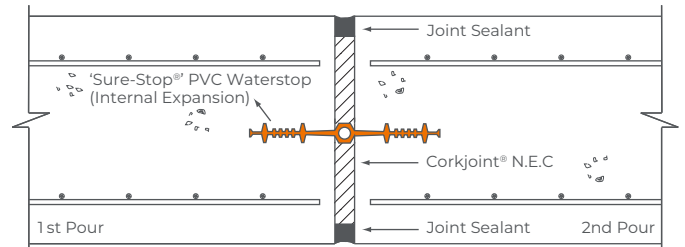

EXPANSION JOINT IN SLAB OR IN WALL JOINT OF WATER RETAINING / EXCLUDING STRUCTURE



## WRITTEN SPECIFICATION

Where shown in the drawings, the expansion joint fillerboard shall be **CORKJOINT® N.E.C Cork Fillerboard** manufactured to ASTM D1752 Type II from high grade granulated cork and resin binders, with a minimum density of 120-180kg/m<sup>3</sup>. The application / installation of the product must be in accordance with the manufacturer's recommendations.



## HEALTH AND SAFETY INFORMATION

In confined spaces or in still air conditions, the use of a ventilation fan or suitable respirator should be used, and the advice and approval of the Site Safety Supervisor is essential. For further information or advice on health and safety precautions, safe handling, storage and correct disposal of products, please refer to the most recent product Safety Data Sheet (SDS), which is available upon request.



## DISCLAIMER

The information and the recommendations relating to the application and end use of this product are given in good faith and are based on the information provided by the manufacturer of the product and/or the Company's current knowledge and experience in connection with the product when properly stored, handled and applied under normal conditions and no liability of final function at the job site is assumed. In practice, the differences in materials, substrates and actual site conditions are such that no warranty in respect of merchantability of, or fitness for, particular purpose, nor any liability arising out of any legal relationship whatsoever, can be inferred either from this information, or from any written and/or oral recommendations, or from any other advice offered by the Company. The Company also has no express or implied knowledge of any particular purpose for which the product is required and any such information given will not be taken into account in the supply of this product. No responsibility or liability by the Company will be accepted for misuse, misreading or derivation from recommended guidelines in respect of this product and the user shall determine the suitability of the product for his intended use and assume all risks and liability in connection therewith. The information contained in our brochure may change at any time without notice. Any use of this product, **CORKJOINT® N.E.C Cork Fillerboard**, in any application should be approved as suitable for use/application by the Design Engineer and Project Manager.

Effective Date: 14 NOVEMBER 2019

### CORKJOINT (MALAYSIA) SDN BHD

383102-H

No. 51, Jalan BRP 8/2,  
Bukit Rahman Putra Industrial Park,  
47000 Sungai Buloh, Selangor, MALAYSIA

+603 6148 8010/ +603 2711 0117

+603 6148 8020

### CORKJOINT (MALAYSIA) SDN BHD

0100562101046

THAILAND REGIONAL FOREIGN OFFICE  
P.O. Box 133 Bangna Post Office,  
Bangkok 10260, THAILAND

+66 949 023 133

info@corkjoint.com

### CORKJOINT (SINGAPORE) PTE LTD

200716724-K

No. 10 Buroh Street #02-26 & 27,  
West Connect Building,  
SINGAPORE 627564

+65 6455 9331

+65 6455 8535

### CORK JOINTING SYSTEMS AUSTRALIA

Unit 2, 18 Farrow Circuit Seaford Rise,  
South Australia 5169, AUSTRALIA

+61 432 423 103

info@cj-systems.com / vanessa@cjsaustralia.com



info@corkjoint.com | corkjoint.com

© Corkjoint 2018. All Rights Reserved.



Page 2