

ECO CHLORINATOR



CHLORINATOR MAINTENANCE ELECTROLYSER MAINTENANCE

It is recommended to turn on and check the electrolyser every three months or after cleaning the filter in order to ensure that the chlorinator is in the best working condition. The steps are as follows:

A. Chlorinatr power must be turned off for 5-10 minutes. Then close the valve that lets the water in and out.

B. After removing the electrolyser, check the inner wall for sediment, debris and other dirt, and clean it with clean water.

C. If you see white calcifications on titanium plates, you must soak them in 4:1 water and hydrochloric acid solution and remove them. You must wear rubber gloves and pay attention to protect your eyes and other body parts.

D. If there is serious dirt that cannot be removed by itself, consult the vendor for a professional cleaning solution. Or replace salt chlorinator directly.

◆ ECO2

◆ ECO4

◆ ECO6

◆ ECO8

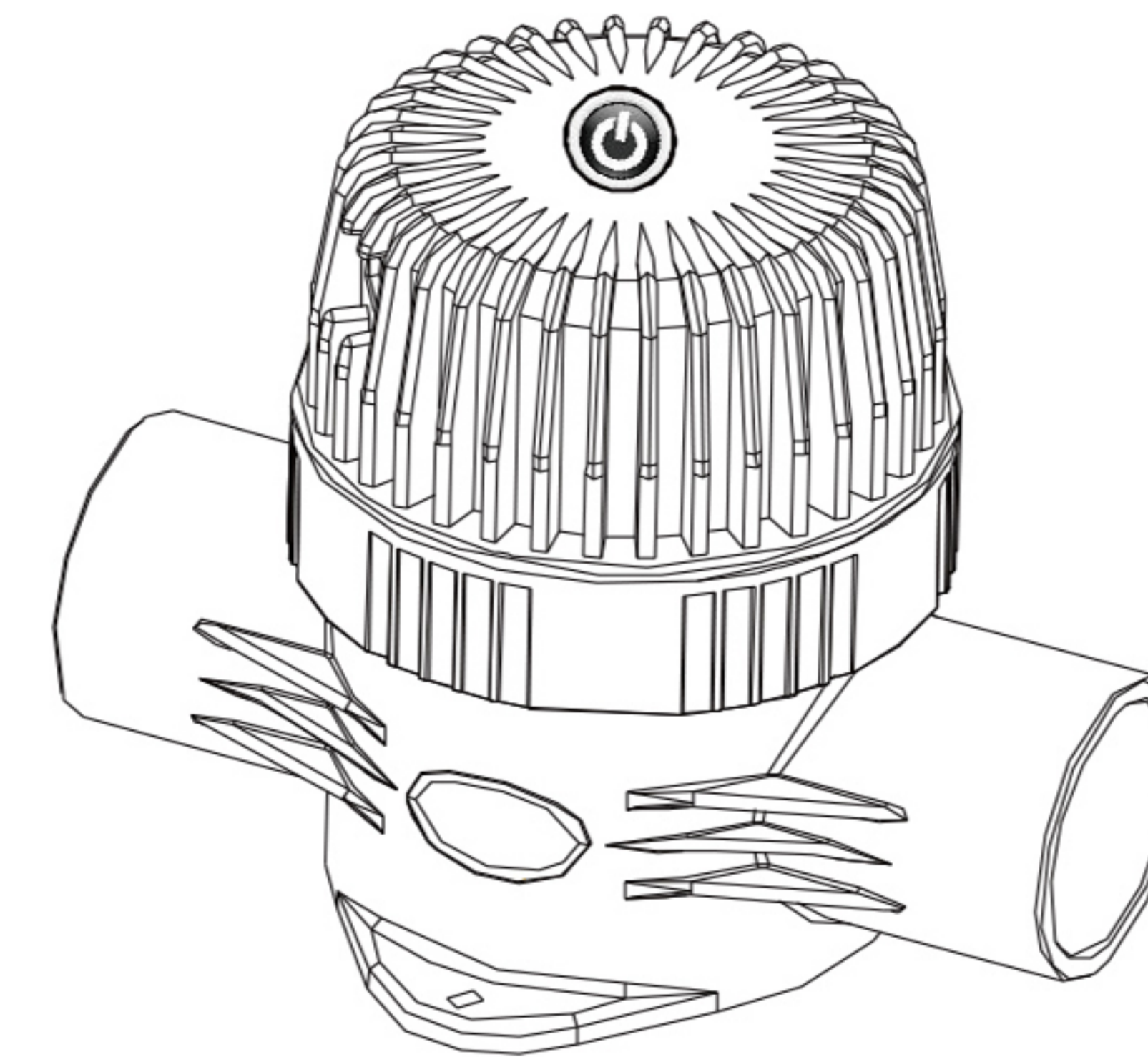



Thanks for choosing ECO Chlorinator. In order to give you the best use effect, safe and healthy disinfection method, to prevent possible accidental injury, before installation and use, be sure to read the instructions carefully. And strictly comply with the requirements of the manual.

Ignoring safety warnings and notes may result in serious injury, property loss, or life-threatening consequences.

IMPORTANT NOTES

1. Only professional electricians can perform installation and maintenance. Otherwise, electric shock death, personal injury, or material loss may occur.
2. Before performing any maintenance operation, ensure that the switchgear is turned off and the power supply is disconnected and the power plug is unplugged.
3. The power controller of the salt chlorinator must be installed on the power supply with leakage switch protection.
4. Chlorinator device should be installed as far as possible in a ventilated position, conducive to the heat dissipation of electrical controls. Do not install in a place susceptible to moisture or rain. Keep the water out of the appliance.
5. A professional electrician must read this installation manual carefully before installing the equipment. If an error occurs, contact the nearest dealer or technical service department.
6. When parts are damaged, it is best to purchase them from the manufacturer or authorized dealer.



NOTE

- A. Do not use rock salt, which contains impurities that may shorten the service life of the salt chlorinator.
- B. Calcium chloride(CaCl_2) should not be used as salt, only sodium chloride(NaCl).
- C. Avoid salt with anti-caking agents (NaCN cyanides, also known as YPS, which are toxic and corrosive). This salt may cause discoloration of pool surfaces and equipment.
- D. Salt pellets can be adjusted with water, but it may take longer to dissolve in water.

1.3 How many salt should be put into the pool?

Most pool water contains some amount of salt. The concentration of salt in pool water varies depending on the source and disinfectant. The existing salt concentration of the pool can be measured by a NaCl tester or a salinity pen.



TIPS

The best working salt concentration of ECO CHLORINATOR is 2000 PPM. (1m³ of water contains 2 kg of salt)

The first time you use a chlorinator, you need to add salt to the pool. Steps: First, use salinity meter to detect the existing concentration of pool water. Second, add a moderate amount of salt. Make the amount of salt per cubic meter of water 2kg. As long as the chlorinator can sense the salt concentration, it works. Guests can add salt to the water as they like. For example, a 4m³ hot tub with 3-8kg of salt will work.

1.4 How to salt the pool?

1. Turn on the circulating pump in the swimming pool to circulate the water.
2. Turn off the power supply of the salt and chlorine device.
3. Measure the existing salt concentration of the pool water. Figure out how many you need to add.
4. Slowly pour the salt along the perimeter of the pool so that it dissolves evenly. Don't let salt build up at the bottom of the pool. If necessary, stir the pool water to allow the salt to dissolve completely.
5. Let the circulating water pump work for 24 hours, then measure the salt depth again.
6. When the salt concentration is appropriate, open the ECO salt chlorine device and you can make chlorine.

1.5 Low Salt Concentration

Drain some of the pool water and refill it with fresh water.

1.6 Reduce Chlorine Losses

In outdoor swimming pools, in order to reduce the consumption of chlorine in the water caused by ultraviolet radiation, it is necessary to add cyanide-urea stabilizer 20-100mg/L to the pool water.

ERROR & SOLUTION

Light Flashing	Error	Solution
Quick flash twice, stop once	1. The electrode wire is not connected properly 2. Low salt. 3. No flow through.	<ul style="list-style-type: none"> ◆ Open the controller and reinsert the VH plug. ◆ Use a salinometer to test the salt concentration of the swimming pool. If less than 500 ppm, please add appropriate amount of salt. ◆ Check for water flow through the salt chlorinator.
Quick flash four times, stop once	The controller temperature is too high.	Maintain air convection around the salt chlorinator. The machine will return to normal automatically when the ambient temperature is lowered.
Quick flash five times, stop once	Salt on the high side	If the salt concentration is greater than 2000ppm, drain part of the pool water, and then add fresh water. When salt concentration is between 500 ppm and 2000ppm, the salt and chlorinator will resume work automatically.
Quick flash six times, stop once	Overload or short circuit	Check whether the electrodes and wiring are short-circuited due to breakage.

WORKING ENVIRONMENT & MAINTENANCE

1. Allocation and maintenance of salt concentration in swimming pool.

1.1 CALCULATION OF POOL WATER QUANTITY

Knowing your pool water capacity is the first step to adding salt to your pool.

Unit: m³

Rectangle Pool: Length x Width x Depth

Round Pool: Diameter x Diameter x Depth x 0.785

Oval Pool: Length x Width x Depth x 0.893

Hypotenuse Pool: Total m³ x 0.85

1.2 Types of Salt

The higher the purity of salt, the better the performance of ECO salt chlorinator, and longer service life. Salt is required to contain at least 99.6% NaCl.

PRODUCT FEATURES

Eco chlorinator adopts intelligent control technology, one button start and stop. Colorful indicator light. Easy to install, the electrode has a circulating cleaning function. Two-speed adjust the chlorine. It also features anhydrous, overload, high temperature and electrode short circuit protection systems.

1. Integrated design, easy installation, less space occupation.
2. Water inlet and outlet should be at the same level to reduce pipeline layout.
3. Disassembled and cleaned titanium metal plate, convenient installation and maintenance.
4. Metal controller shell, durable, good heat dissipation effect.
5. Two stalls adjust the chlorine production.
6. There is a hint of salt content. There is also a error notification function.
7. Power off memory function. Automatically starts the last running mode.



Automatic power-on means that the system automatically starts when a power failure occurs during operation and the system recovers again. Memory of the last working state, refers to the current before the power failure, or before the system stopped working.

Model	Chlorine	Input	Power	Suitable Pools
ECO 2	2g/h	AC110~240V 50/60Hz	12W	≤10m ³ , pools, spaswim, endless pools, hot tub
ECO 4	4g/h		24W	≤20m ³ , pools, spaswim, endless pools
ECO 6	6g/h		36W	≤30m ³ , pools, spaswim, endless pools
ECO 8	8g/h		48W	≤40m ³ , pools, spaswim, endless pools

SIZES & CONSTRUCTION

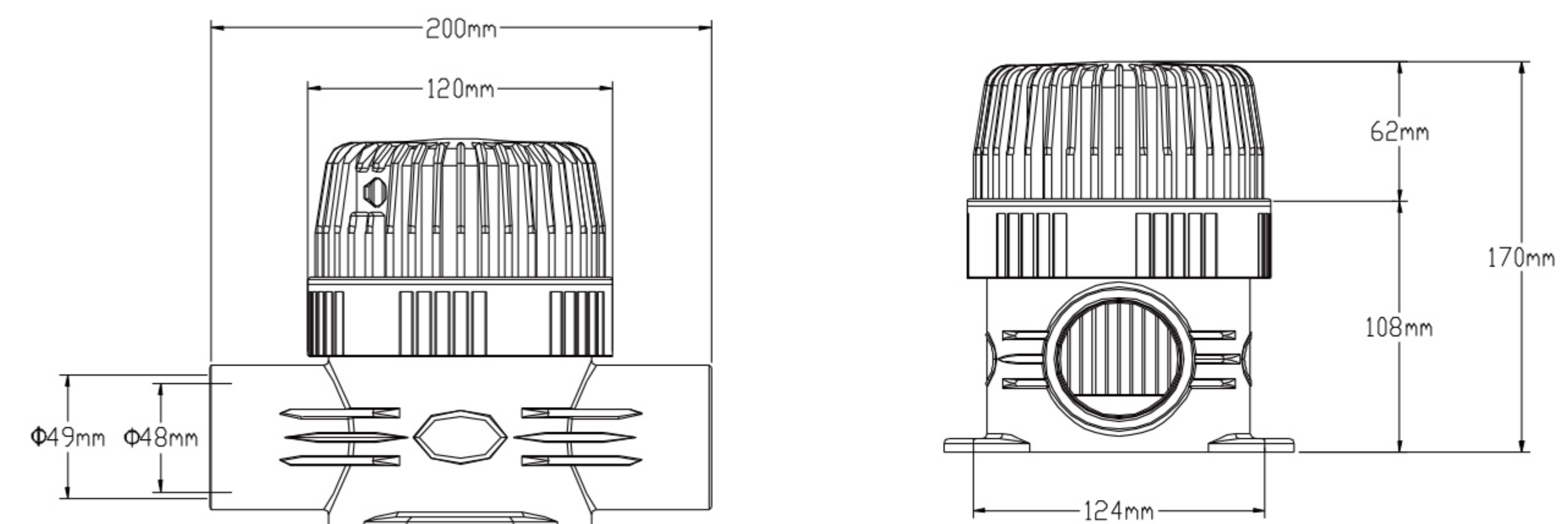

INSTALIATION

1. Pipe connection is 1.5", 50mm.
2. Before installing the Chlorinator, close the valve on both ends of the pipe.
3. Before installation, clean oil and sundries in the installation pipe mouth.
4. The Chlorinator should be mounted on the water branch, at the end of the filter circulation line, connecting to the pool inlet. Intall two valves to separate from main pipe.
5. When installing water pipe connectors, use PVC glue.
6. Input: AC110V-220V/50-60Hz. Output: DC24V/2A.
7. The power controller of chlorinator must be installed on the power supply with leakage switch.
8. Chlorinator should be installed in a ventilated position, which is conducive to heat dissipation of electric control parts. Do not install in wet and rainy places.
9. Avoid direct sunlight during use. Otherwise shorten the life of the product shell.

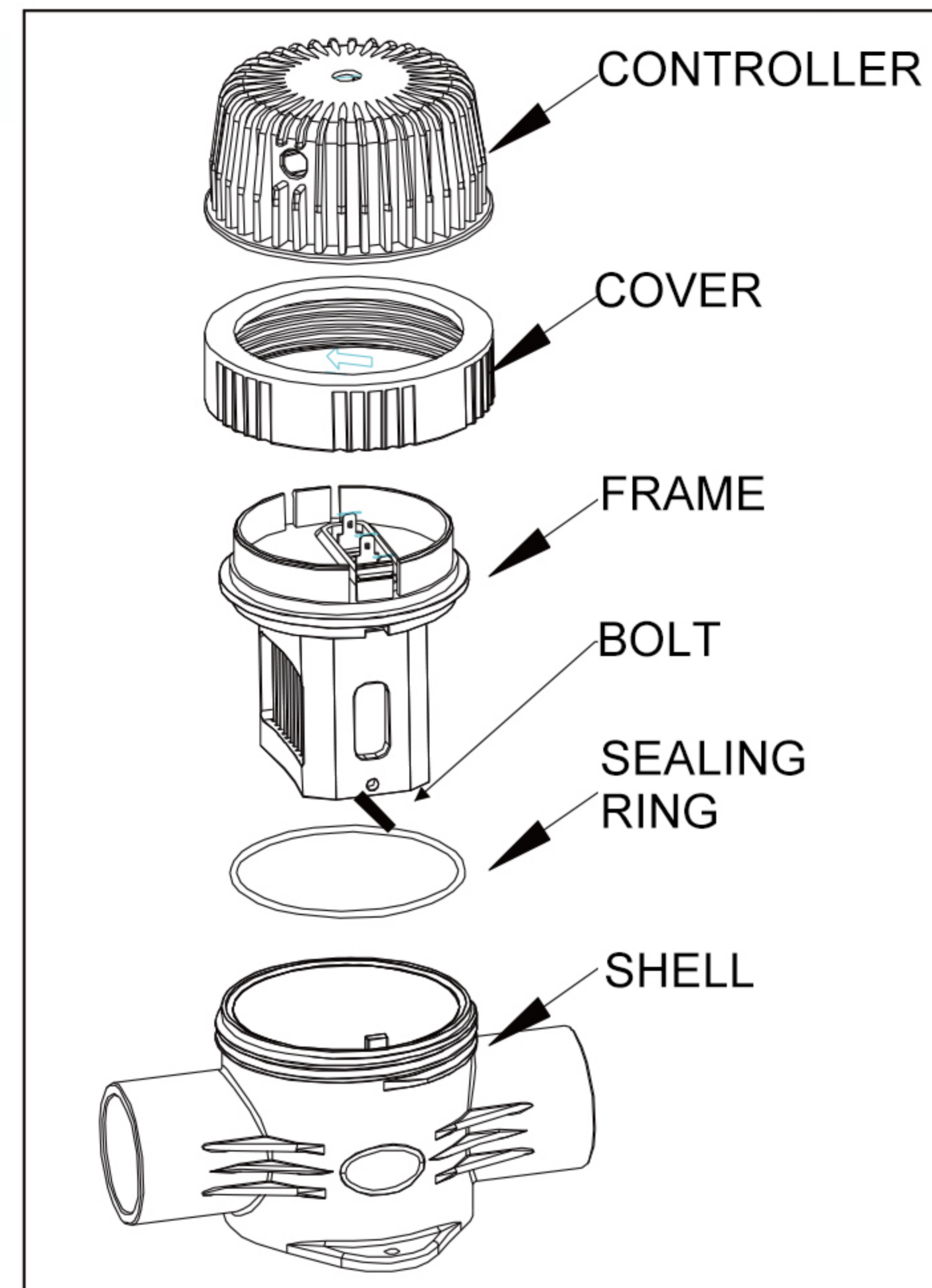

STRUCTURE

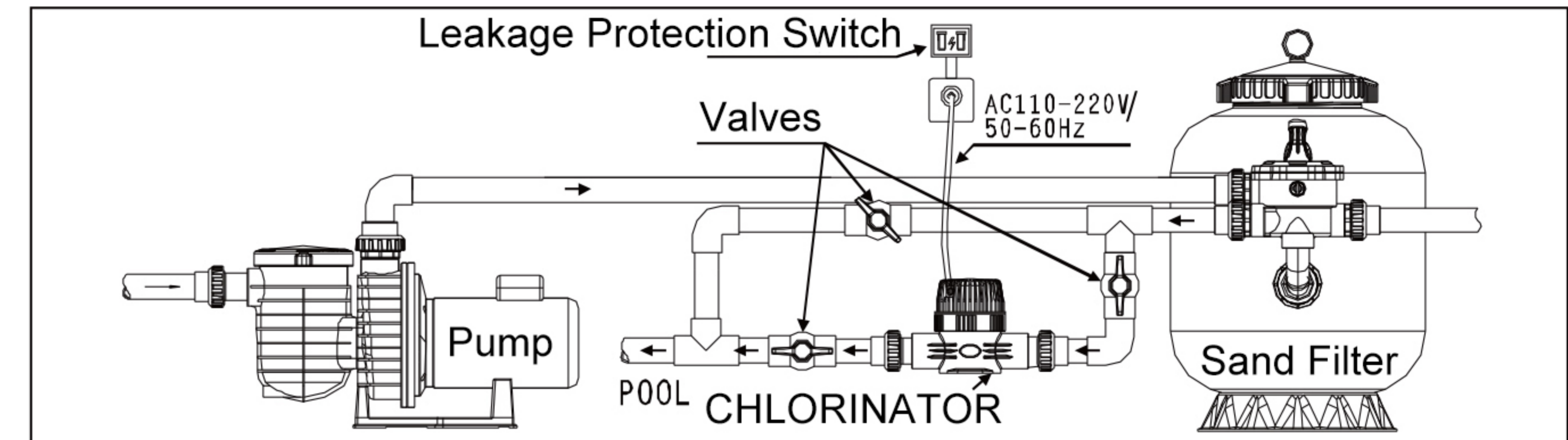
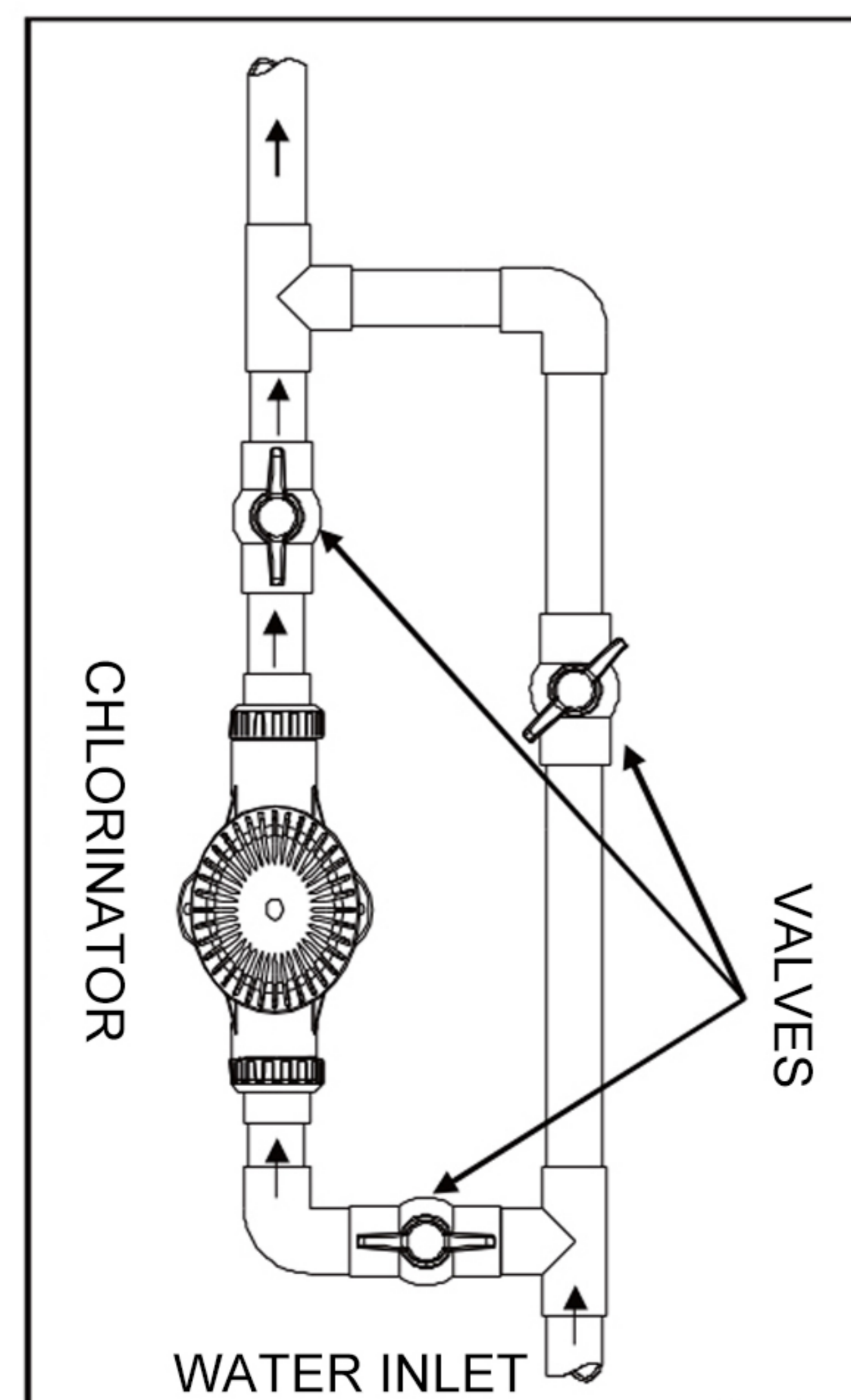

OPERATING

1. When the equipment is installed and connected, open the inlet and outlet valves of the chlorinator, and adjust the size of the main pipe valves appropriately according to the actual water flow to ensure sufficient water flow through the chlorinator.
2. Connect the electrode wire, open the controller vertically upward, and plug the electrode VH plug wire with the controller VH socket. Then cover the controller in the original direction.
3. Make sure the salt concentration in the pool is within the normal working range before chlorinator starts work. Otherwise, the working life of titanium electrode will be shortened.
4. Power adjust. When generator is on, press power button 3 seconds to adjust the working power. (Note: Gear one is 100% power, gear two is 50% power.) Power light flashing can tell the gear. Light normally on, it is gear one. Light flash slowly, it is gear two.

