

## INSTRUCTION SHEET POL-21005-D POINT OBSTRUCTION LIGHT DOUBLE

The POL PointSpec series of red LED aviation obstruction lights presents the highest grade technical features and the most options available in the industry. POL steady-burning obstruction lights are used to mark tall structures that present hazards to air navigation. At night, these lights warn pilots when installed in accordance with FAA AC 70/7460-1 and applicable FCC and ICAO rules. The POL-21005-D is a double-headed, steady-burning obstruction light. Both heads operate simultaneously. The two heads are mounted on a powder-coated junction box. The cover of the junction box has a tether and captive screws.

### CATALOG NUMBERING SYSTEM

Point Type -	Power	Photometric Specification -	Color -	Mounting & Entries -	Style
POL-21005	1: 120v <sup>1</sup> 2: 220v <sup>2</sup> 6: 277v <sup>3</sup>	F: FAA & ICAO A B: ICAO B & Transport Canada	R: Red	34B: 3/4-inch NPT Bottom 10B: 1-inch NPT Bottom	D: Double NC: NVG Compatible MT: Marine Treatment

Note 1: 120 VAC 50/60 Hz (+/- 20%)

Note 2: 220 VAC 50/60 Hz (176-250V)

Note 3: 277 VAC 50/60 Hz (+/-5%)

PICTURE



OUTLINE DRAWING

DIMENSIONS: INCHES (MM)  
DEPTH = 5 (127)

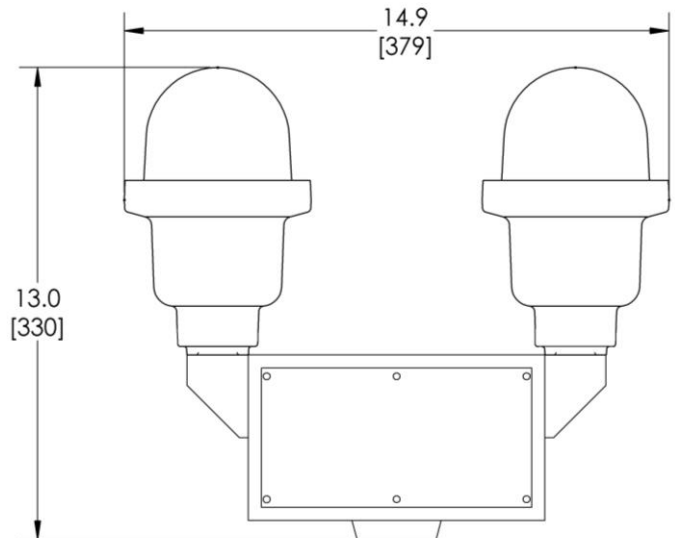

#### IMPORTANT NOTICE

The installer assumes full responsibility for the proper application and safe installation of this unit in accordance with these instructions, the National Electric Code, and all other state and local codes and practices. POINT LIGHTING CORPORATION accepts no responsibility for damages to property or injury to personnel for the improper use of this product or its failure under any circumstances. POINT LIGHTING CORPORATION's warranty is limited to the replacement of the defective unit only if the failure is the result of a manufacturing defect. Contact Point Lighting for warranty information.



**WARNING: TURN OFF THE ELECTRICITY AT THE SOURCE BEFORE INSTALLATION.**

**IMPORTANT: THE POL FIXTURE IS FACTORY SEALED. REMOVING THE LENS OR IN ANY WAY ENTERING THE SPACE CONTAINING THE POWER SUPPLY AND LED ARRAY WITHOUT INSTRUCTIONS FROM THE FACTORY, VOIDS THE WARRANTY AND MAY RESULT IN PREMATURE FAILURE OF THE LIGHT. THE WIRE LEADS ARE SEALED AT THE ENTRY POINT TO THE LED HEAD SUBASSEMBLY. BREAKING THE SEAL OF THE WIRES VOIDS THE WARRANTY.**

**ALL POL LED UNITS ARE INDIVIDUALLY TESTED AT THE FACTORY BEFORE SHIPMENT. ANY ATTEMPT TO DISASSEMBLE OR TO FIELD TEST THE FUNCTIONS OF THE LIGHT ASSEMBLY VOIDS THE WARRANTY.**

**WARNING: CHANGES OR MODIFICATIONS TO THIS UNIT NOT EXPRESSLY APPROVED BY THE PARTY RESPONSIBLE FOR COMPLIANCE COULD VOID THE USER'S AUTHORITY TO OPERATE THE EQUIPMENT.**

**WARNING: DO NOT INSTALL AIR TERMINALS (LIGHTNING RODS) NEAR OR ON ANY POINT LIGHTING FIXTURES. AIR TERMINALS WILL INCREASE THE POSSIBILITY OF FAILURES AND WILL VOID THE FACTORY WARRANTY. FIXTURE GROUND WIRES MUST NOT BE CONNECTED TO BUILDING/TOWER LIGHTNING PROTECTION SYSTEM DOWN CONNECTORS.**

## POINT LIGHTING CORPORATION

Mail: P.O. Box 686, Simsbury, CT 06070      Plant: West Dudley Town Rd, Bloomfield, CT  
Tel 01 860.243.0600      USA      Fax 01 860.243.0665  
email: [Info@PointLighting.com](mailto:Info@PointLighting.com)      website: [www.PointLighting.com](http://www.PointLighting.com)

## INSTALLATION INSTRUCTIONS

### Mechanical Installation

Each POL-21005-D consists of two (2) Point Obstruction Lights mounted on top a PL10461 cast aluminum junction box. The fixture is shipped assembled. Thread the POL's hub to the properly sized conduit. Metal conduit with a minimum wall thickness of 0.020-inch (0.505mm) is required.

### Electrical Installation

Electrical connections are to be performed in the PL10461 junction box. Remove box cover. Splice the black wires to the black system line. Splice the neutral wires to the system neutral (zero). The green/yellow wires are the fixture's ground; splice it to the system ground. Make splices using proper electrical practices in suitable splice box per NEC and local codes. The POL's must be leveled in a vertical position base-down perpendicular to the mounting surface. If necessary, loosen the three screws that secure the upper head subassembly to the junction box, adjust the position as required and retighten the screws.

## REPLACEMENT PARTS

PART NUMBER	DESCRIPTION	QTY
PL10461-34	Double POL Body with ¾" hub	1
PL10461-10	Double POL Body with 1" hub	1
PL10462	Double POL Cover with Tether and Gasket	1
PL10461-34-MT	Double POL Body with ¾" hub -MT	1
PL10461-10-MT	Double POL Body with 1" hub -MT	1
PL10462-MT	Double POL Cover with Tether and Gasket -MT	1

## POL-21005 REPLACEMENT HEADS

Point Type	—Power	Specification	—Color	—Style	—Options
POL-21005	1: 120V 2: 220V 6: 277V	F: FAA L-810 F: ICAO Type A B: Trans. Canada B: ICAO Type B B: UK CAP 168 Group A	R: Red	H00: Standard - Steady Burning Head	NC: NVG Compatible MT: Marine Treatment

## POINT LIGHTING CORPORATION

Mail: P.O. Box 686, Simsbury, CT 06070      Plant: West Dudley Town Rd, Bloomfield, CT  
Tel 01 860.243.0600      USA      Fax 01 860.243.0665  
email: Info@PointLighting.com      website: www.PointLighting.com

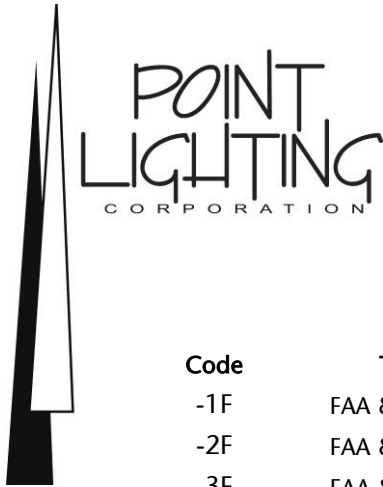

### POWER CONSUMPTION PER POL LED LIGHT HEAD

Code	Type	Voltage	Frequency	Watts*	mA	VA*
-1F	FAA & ICAO A	120 AC	50/60 Hz	1.5	25	2.9
-2F	FAA & ICAO A	220 AC	50/60 Hz	2.1	25	5.5
-3F	FAA & ICAO A	12 DC	---	1.2	96	1.2
-4F	FAA & ICAO A	24 DC	---	1.5	62	1.5
-5F	FAA & ICAO A	48 DC	---	1.2	25	1.2
-6F	FAA & ICAO A	277 AC	50/60 Hz	1.9	24	5.9
-1B	ICAO B & TRAN CAN	120 AC	50/60 Hz	6.9	63	7.6
-2B	ICAO B & TRAN CAN	220 AC	50/60 Hz	6.9	34	7.4
-3B	ICAO B & TRAN CAN	12 DC	---	4.3	470	4.3
-4B	ICAO B & TRAN CAN	24 DC	---	4.3	230	4.3
-5B	ICAO B & TRAN CAN	48 DC	---	5.0	104	5.0
-6B	ICAO B & TRAN CAN	277 AC	50/60 Hz	6.9	28	7.9

Note: For option -NC, add 1.0 watts (1.1 VA)

## POINT LIGHTING CORPORATION

Mail: P.O. Box 686, Simsbury, CT 06070      Plant: West Dudley Town Rd, Bloomfield, CT  
Tel 01 860.243.0600      USA      Fax 01 860.243.0665  
email: [Info@PointLighting.com](mailto:Info@PointLighting.com)      website: [www.PointLighting.com](http://www.PointLighting.com)