

Specifications

			GT10Q	
			GT10Q-SR (RS-232C Type)	GT10Q-SU (USB Type)
Scanner	Readable codes	2-dimensional codes	QR Codes, Micro QR Codes, DataMatrix (ECC200), PDF417, MaxiCode, RSS variants, Micro PDF EAN, UCC Composite	
		Bar codes	EAN-13/8, UPC-A/E, UPC/EAN (with add-on), Interleaved 2 of 5 (ITF), Code 39, CODABAR (NW-7), Code 128 (EAN-128), RSS	
	Resolution	2-dimensional codes	0.25 mm	
		Bar codes	0.15 mm	
	Image capture function		Yes	
	Focusing point		100 mm	
	Marker		Area marker	
	PCS value		0.45 Min.	
	Skew angle		360 degrees	
	Elevation and inclination		±35 degrees	
Reading confirmation		Blue-green-red LED, buzzer (with volume control), vibrator		
Interface	System	RS-232C		USB 1.1 Compliant
	Connector	Dsub-9S		USB Type A
Power source	Power supply	AC Adapter		Supply from connected device*
Environment requirements	Dust Resistance and Splash Resistance		IP 54	
	Drop resistance strength		2 m (Concrete floor)	
	Operating temperature range		0 - 50°C	
	Operating humidity range		10 - 99% RH (No condensation or frost)	
	Operating ambient illumination		20 - 10,000 lux (Daylight fluorescent lighting)	
Weight (Unit only)		Approx. 210 g		

*: Connection may not be possible depending on the type of PC or USB-HUB being used. Prior confirmation of connection compatibility is required.

Scan Range

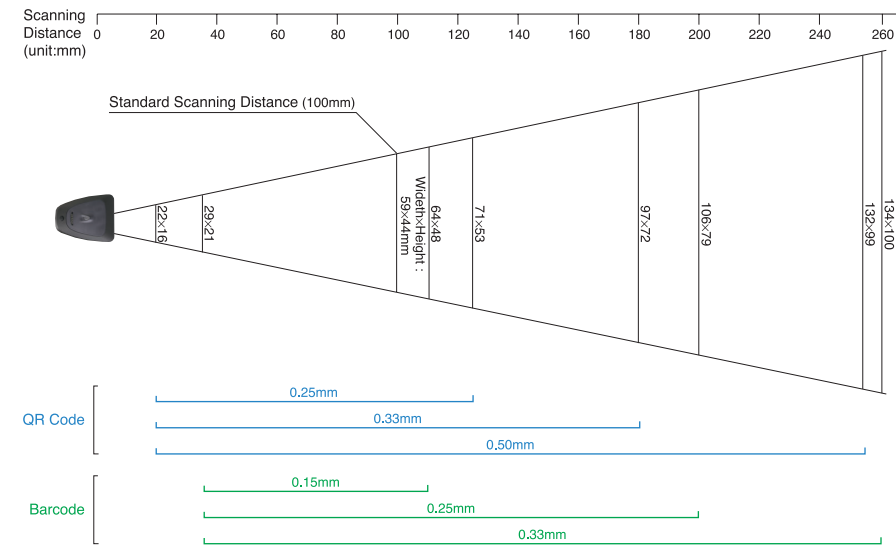

Application Examples

Logistics



Manufacturing

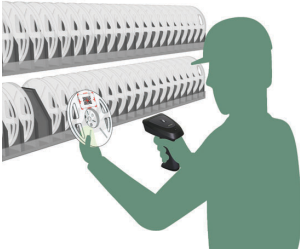

•The shape of the projected area marker differs according to the original target market.
This hand-held scanner with built-in area marker should not be used in the United States and Canada as it does not meet the specifications required for use there.
•Appearance and specifications are subject to change without notice.
•Information in this catalog is current as of Dec. 2003.

Dimensions

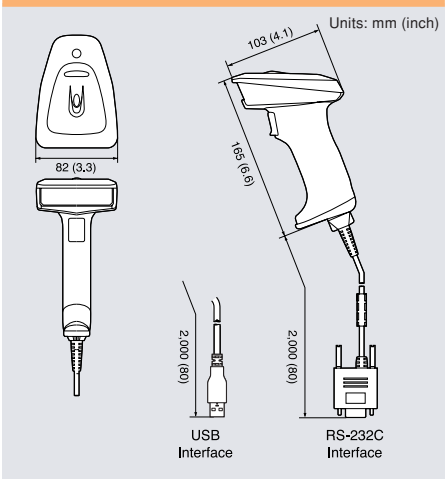

Accessories

- Interface cable
 - AC Adapter for RS-232C type
 - Driver CD-ROM for USB type
 - Operator's Manual
- (Operator's Manual can be downloaded from Denso Wave's web-site free of charge)

Software

- Setup Software
- (Setup Software can be downloaded from Denso Wave's web-site free of charge)

Options

Cradle

Desktop or wall mounted cradle securely stores scanner



Hands free Stand

Multi-position stand holds GT10 for efficient hands free barcode reading

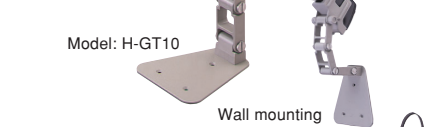

Hang Strap

Hang strap conveniently suspends GT10 from fork lifts, assembly lines, etc.



For Safe Operation
• Please read operation manual before use.

The next generation in two-dimensional scanning

Taking full advantage of its High Performance, Durability, Versatility and Ease-of-use

Outstanding Readability

- Superior Reading Speed of 2D Codes and Bar Codes (Twice Conventional Model* Speeds) *: When reading up to 150 characters of QR code.



- Easily Reads Inferior 2D Code Labels

Versatile Reading Functions

- Target Pointer Mode

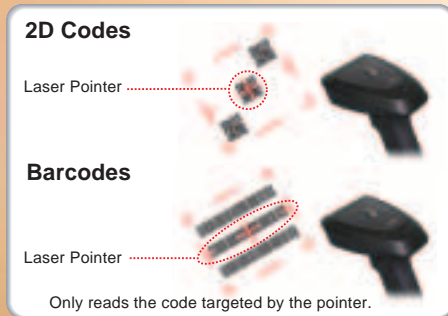

- Read Multiple Codes Simultaneously
The GT10Q can read multiple codes within the reading area, such as continuous QR codes and multiple bar codes, in a single reading.



- Barcode Reader
The GT10Q achieves high-speed reading equal to traditional linear readers

Durability

Drop Test Standard

- High standard of impact resistance due to a new stronger body and a design which incorporates impact rubber for added protection.

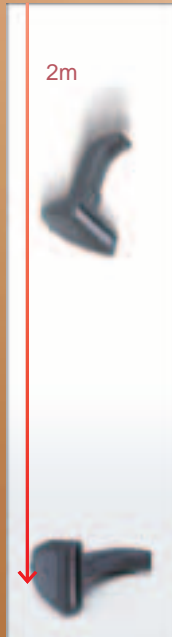

Splash and Dust Proof to Meet IP54 Standards

- Passes IEC International Standards Protection Class IP54 (equivalent to JIS splash resistance). High level of protection for use in rugged environments.



Excellent User Friendly Operation

- Area Marker

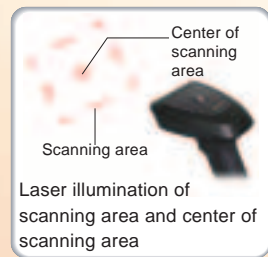

- Vibrator Function

Scan completion confirmed with vibration

- Adjustable Buzzer Volume

3 levels of buzzer volume to suit the surrounding environment

- 3 color Extra-bright LED

Easy to see scanner information



Blue: Scanning completed
Green: Processing completed
Red: Scan failure

Simple Setup with Easy to Use Software

- Simple installation setup software included

Setting parameters from a PC is easy with the setup software

Start Program
For immediate start – print and one step setup bar code using the special setup software and then use the GT10 to scan it.



One-touch Key Functions

- Choice of scanning method for user use

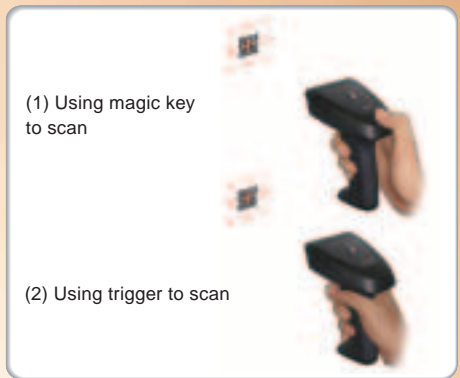

- Code Discrimination

By registering two types of readable symbologies in the GT10, the magic key can toggle to avoid reading the incorrect codes, while in multiple reading code mode

- Power ON/OFF Control

Scanner is on stand by when magic key is OFF. Scanning begins when magic key is (switched) ON.

- Transmitting Designated Characters

Data to be transmitted (i.e operation start codes) can be setup beforehand when the magic key is ON.

- Retransmit Scanned Data

Scanned data can be retransmitted when the magic key is ON – so the bar code does not need to be repeatedly scanned.

Wide Range of Functions

- Code Verification

Determine if a bar code being read matches a master bar code registered in the GT10.

Picking Verification

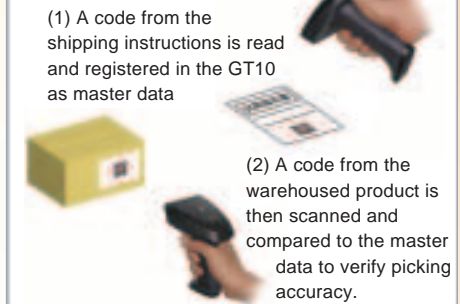

- Programmed Data Formatting

Easily configure the GT10 to automatically format scanner output to meet legacy system requirements

Data formatting example:

- Decoded data : 0123456789
- GT10 data output : 789

- Auto-sensing Function

The auto-sensing function automatically begins scanning when a label is detected.



- Remote ON/OFF Function

Scanning can be turned ON/OFF via commands from a host computer.

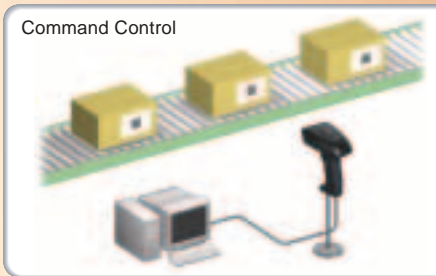

* Not compatible with scanning moving objects.

User Friendly