



T4000

COMPACT THERMAL/RFID PRINTER

PRODUCTIVITY

ADAPTABILITY

DEPENDABILITY





T4000



T4000

Small, Fast and Ready to Boost Productivity

The T4000 is our most compact and affordable industrial printer with the ability to print 5,000 labels a day at speeds of up to 10ips. If you're looking to improve productivity...look no further. The T4000 includes RFID capability, Printronix System Architecture (PSA), with multiple connectivity options, remote printer management tools and automated alerts to keep your enterprise, operating at optimum efficiency and productivity.



ENTERPRISE-LEVEL PRODUCTIVITY

- Industry-leading print speed of 10 ips
- Easily prints 5,000 labels a day in demanding environments
- Compatible with PrintNet Enterprise, printer management tool
- Fast ARM Cortex A-7 processor
- Automated alerts keep your enterprise efficient and productive
- Uptime is maximized with 450m ribbons and 8" label roll capacity



ADAPTABLE FEATURES

- Extensive standard connectivity: Ethernet, USB Host, USB device, serial
- Optional RFID system encodes both standard RFID labels and on-metal RFID tags
- Optional connectivity: Enterprise level WiFi: 802.11 a/b/g/n/ac, Bluetooth 4.2
- Enterprise-level WiFi encryption and security protocols
- Nine printer emulations for seamless integrations
- Compact size makes it a good fit for multiple industries



DEPENDABLE DESIGN

- Rugged metal enclosure with bifold side panel
- Built on Printronix System Architecture (PSA) Platform for proven dependability
- Proprietary printhead algorithms deliver high-quality barcodes
- Large LCD color screen and easy-to-use control panel
- High MTBF of up to 12,000hrs
- Wide operating temperature range from 0°C to 40°C

KEY FEATURES

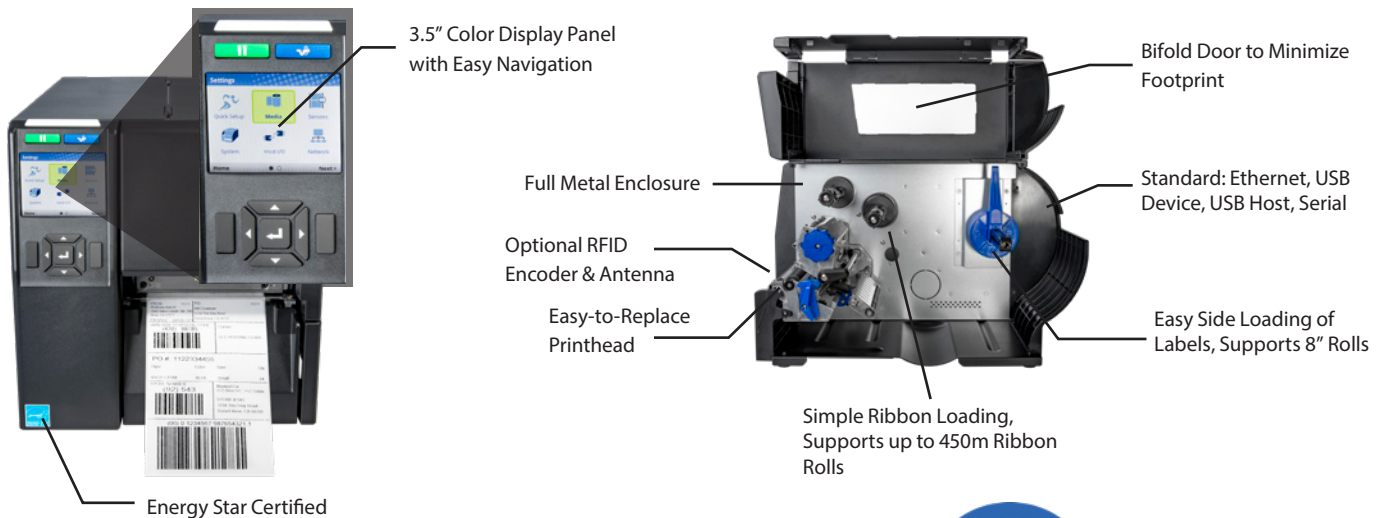

WHAT DOES ENTERPRISE-LEVEL PRODUCTIVITY MEAN?

- The printer includes the tools to install, configure and troubleshoot multiple printers at once
- Printers are fast and reliable for maximum productivity
- The time required to perform day-to-day tasks has been minimized
- Includes multiple connectivity options and advanced security protocols
- Encodes and prints on standard RFID paper labels most commonly used in carton or pallet supply chain applications.
- Encodes and prints on-metal (or anti-metal) RFID tags most commonly used in asset tracking applications where the tagged item has a metal surface, such as IT servers, safety deposit boxes, or gas canisters.
- Validates encoding process, and automatically overstrikes and reprints any RFID label (or tag) that fails to encode properly.
- Records all RFID labels for encoding process, tracks success/failure rates.



The T4000, UHF RFID ISO 18000-6C system offers several advanced features.

ENTERPRISE PRODUCTIVITY

EASE OF INSTALLATION



Drop-in installation with minimal setup & multiple emulations



Easy to configure control panel or with interactive webpage



Full suite of connectivity options & security protocols

EASE OF MAINTENANCE



Remotely troubleshoot & monitor printer status



Push firmware & re-configure printers in batches



Easy printer swap with quick change memory card (QCMC)



Commonality of operation between all Printronix printers

RELIABLE LABEL PRODUCTION



Easy to use large color LCD display with intuitive icon-driven menu

Fast print speed and time-to-first-print

More uptime with easy load media and large ribbon rolls

Dependable production up to 5,000 labels per day

T4000 Industrial Thermal Printer



PRODUCT BENEFITS

- * High performance ARM Cortex-A7
- * 128MB RAM/ 128MB Flash Memory
- * Printronix System Architecture (PSA)
- * Color 3.5in LCD nine-key control panel
- * Four-inch print width
- * 203 DPI or 300 DPI
- * Transfer and Direct Printing
- * Ethernet 10/100 BaseT
- * Steel Frame Enclosure
- * Bifold Media Door
- * WiFi 802.11 a/b/g/n/ac (Option)
- * Bluetooth 4.2 (Option)
- * 4-32 GB SD memory card capability
- * Andale & Premium Asian Fonts (Option)
- * ENERGY STAR Certified
- * Option RFID Encoder/Antenna System

PRINTER SPECIFICATIONS

Max. Print Speed	10 IPS @ 203 DPI, 7IPS @ 300 DPI
Print Method	Transfer and Direct
Resolution	203 DPI / 300 DPI
Max. Print Width	4.1" (104mm)

MEDIA SPECIFICATIONS

Media Type	Roll or Fan-Fold Labels, Tags, Paper, Film, Tickets
Min. Media Width	1.0" (25.4mm)
Max. Media Width	4.72" (120mm)
Min. Media Length	Continuous 0.25", Tear-Off / Peel-Off 1.0"
Max. Media Length	Up to 50"
Media Thickness	0.00236" (0.06mm) to 0.011" (0.279mm)
Media Roll Core Diameter	3.0" (76.2mm)
Max. Media Roll Diameter	8.0" (203mm)
Media Sensing	Gap, Mark

RIBBON SPECIFICATIONS

Ribbon Type	Wax, Wax/Resin, Resin
Min. Ribbon Width	1.6" (40mm)
Max. Ribbon Width	4.33" (110mm)
Max. Ribbon Length	450 Meters
Ribbon Core Diameter	1.0in

PHYSICAL CHARACTERISTICS

Width	10.40" (264mm)
Height	10.9" (276mm)
Depth	17.9" (455mm)
Printer Weight	22 lbs (10Kg)
Shipping Weight	28 lbs (13Kg)

PRINTER LANGUAGE

Printer Languages (Native / Competitor)	PGL/ZGL/TGL/IGL/STGL/DGL/IEGL/MGL/EGL
API's	XML
Legacy Line Printer Emulations	VGL (Code V), P-Series / XQ, Epson FX, Serial Matrix, Proprinter
Job Control Languages	PJL, PTX-SETUP

COMMUNICATION AND CONNECTIVITY/INTERFACE

Standard Interface I/O	Serial RS232, USB Device (Type B), USB Host (Type A) and Ethernet 10/100Base T
Optional Interface I/O	WiFi (802.11a/b/g/n/ac), (WiFi Alliance Certified) Bluetooth 4.2
WiFi Security Encryption	WEP 40/128bit, WPA/WPA2 PSK, TKIP, AES CCMP
WiFi Security Authentication	EAP-TTLS, EAP-PEAP, LEAP, PEAPv1/PEAP-TLS, PEAPv0/MS-CHAPv2

RFID

Radio	UHF Gen2/ ISO18000-6C Encoder
Antenna	Fixed Position antenna
Inlays/Tags	Standard RFID Labels, On-Metal RFID Tags
On-Metal Tag Thickness	Minimum Label/Tag Pitch 0.625in up to 1.2mm thick
Printer Languages	PGL, ZGL, STGL, MGL
Counters	Tracks good/overstruck labels/tags

OPERATING ENVIRONMENT

Operating Temperature	32 to 104°F (0 to 40°C)
Operating Humidity	25-85% Non-Condensing
Storage Temperature	-40 to 140°F (-40 to +60°C)
Storage Humidity	10 - 90% Non-Condensing

MEDIA HANDLING MODES

Standard	Continuous, Tear-Off
Optional	Peel/Rewind (paper labels, 6ips, rewinds liner from 8in roll) Cutter (thickness as per media spec, life 500,000 cuts) (Does not support on-metal RFID labels/tags)

POWER REQUIREMENT

Line Input	Auto Range 100 - 240 VAC (48 - 62 Hz)
------------	---------------------------------------

REGULATORY COMPLIANCES

Emissions	FCC, CE, IC, CCC, KC
Safety	cTUVus, CE, IC, EAC, SMARK, NOM, CCC, KC, BIS, BSMI
Environmental	RoHS, WEEE, Energy Star
WiFi/BT	US, Canada, European Union, China
Energy Savings	Energy Star
RFID	USA, Canada, EU, China, Brazil, Taiwan, India, Korea

BAR CODE SYMBOLOGIES

1D Barcodes	BC-412, Code 11, Code 39, Code35, Code 93, Codabar, Code 128 Subsets A/B/C, Industrial 2 of 5, Interleave 2 of 5, German 1-2/5, EAN-8, EAN-13, UCC/EAN-128, UPC-A, UPC-E, UPCSHIP, UPS 11, MSI, Matrix 2 of 5, PLESSEY, POSTNET, 4-state PostBar, Australian 4-state, FIM, ITF14, TELEPEN, PLANET, USPS Intelligent Mail, LOGMARS
2D Barcodes	PDF-417, MicroPDF-417, Maxicode, DataMatrix, QR Codes, Aztec, GS1 Databar (RSS-14)

FONT, GRAPHIC SUPPORT

Graphic Formats	PCX, TIFF, BMP, PNG
Font Technologies	Intellifont, TrueType, Unicode
Standard Fonts	OCRA, OCRB, Courier, Letter Gothic, CG Times, CG Triumvirate/Bold/Condensed
Optional Premium Asian Fonts (SD card)	Simplified Chinese, Japanese, Korean, Thai
Optional Andale Asian Fonts (SD card)	Simplified Chinese, Traditional Chinese, Korean, Japanese

REMOTE MANAGEMENT SOFTWARE

PrintNet Enterprise	Enterprise Grade Remote Management Solution
---------------------	---

OPTIONS AND ACCESSORIES

- * WiFi 802.11 a/b/g/n/ac
- * Bluetooth 4.2
- * Cutter
- * Peel/Rewind
- * Andale Asian Font Cards
- * Premium Asian Font Cards
- * QCMC (Quick Change Memory Card)
- * RFID Encoder/Antenna System

