



High Resolution Professional Advertisement Series

IP65

MALIBU
OUTDOOR FIXED INSTALLATION

Ultra-light and ultra-thin, to save the cost of steel structure and installation



High-end module



Aluminum sealed panel

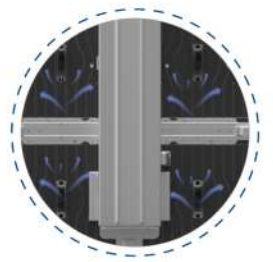

Natural heat dissipation hole

The cabinet thickness is 67mm, the weight is only 15 kg/pcs, and 30kg/m², leading level in industry.

Multiple installation type is supported, like wall-mounted, hanging etc

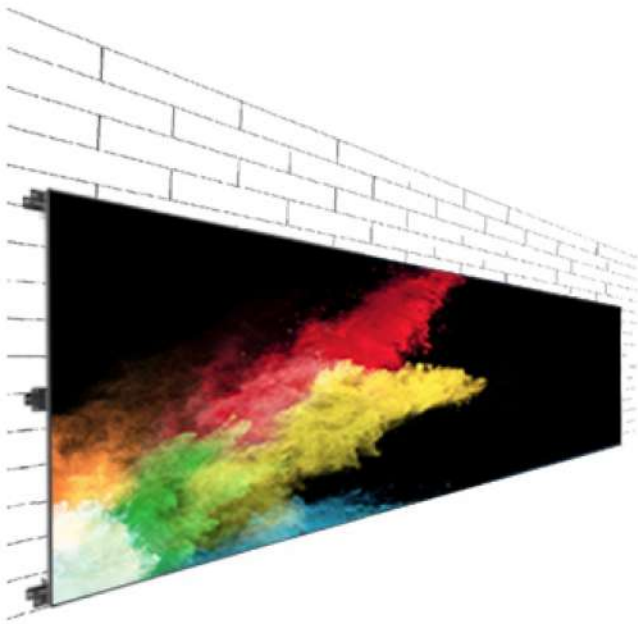

Super stable, high protection, it can work outdoor for all-weather

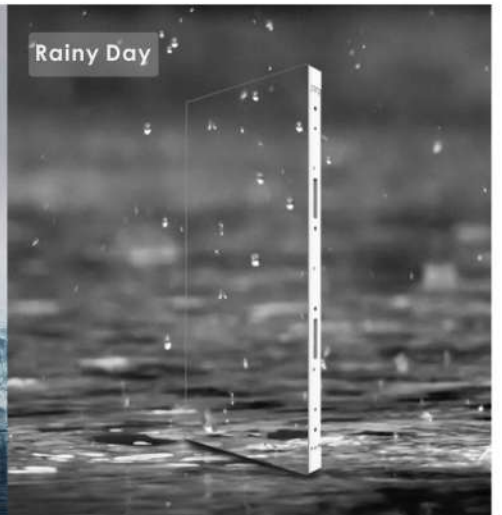

Different cabinet sizes, convenient to have more screen size choices

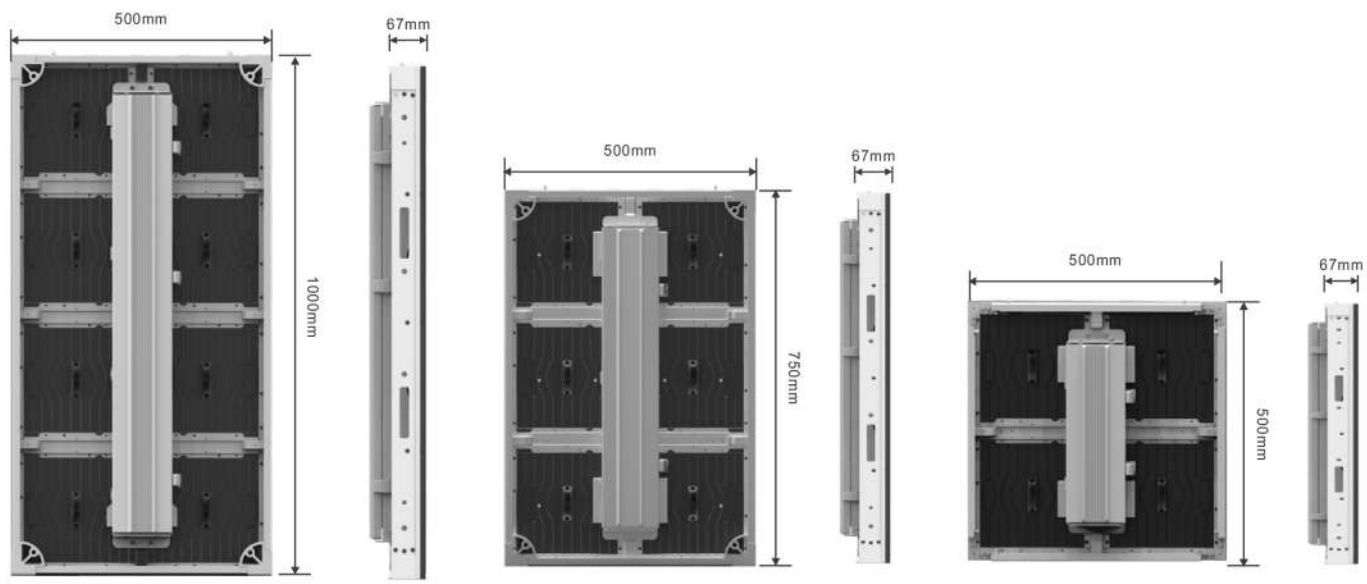

Total front / back service available, fast maintenance

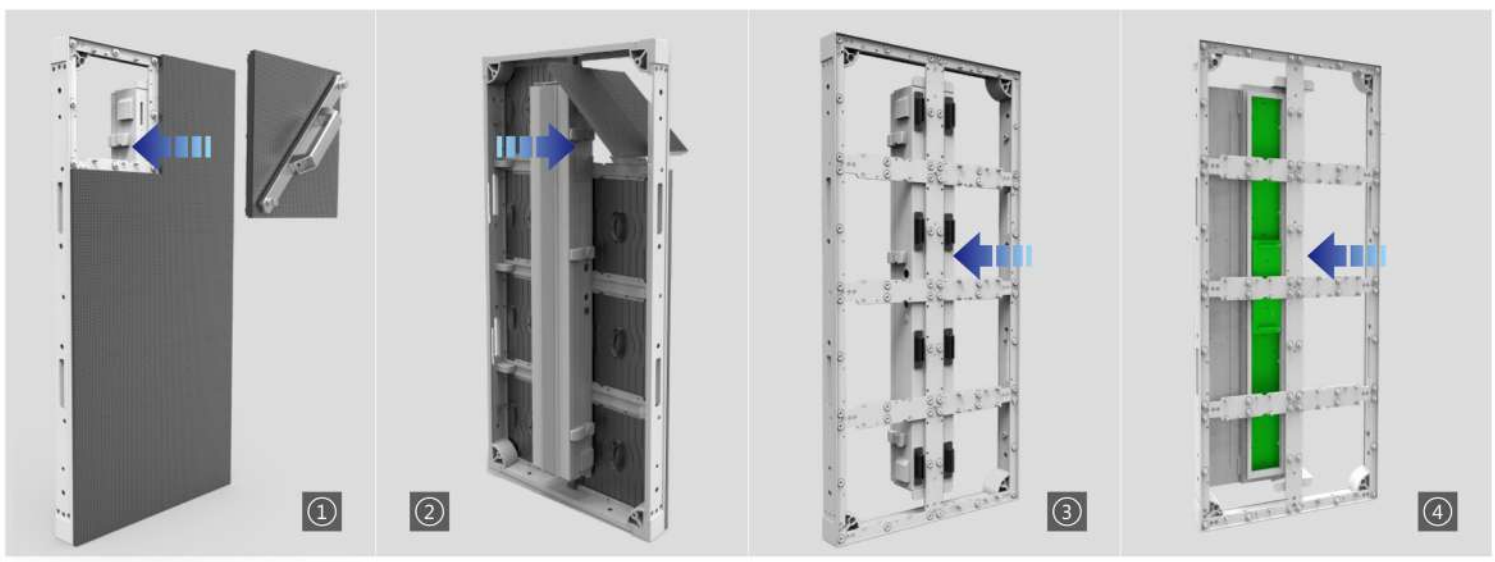

① Special tools to dismantle the module from front

② Module can be installed and dismantled from backside

③ Separate the power box and cabinet frame form front side

④ Move the power box backward and rotate 180° along the center axis to maintain the power box from front

Ultra high refresh rate, smooth and natural to play the content



It support mixed splicing with different cabinet sizes

500*500mm splice with 500*1000mm easily

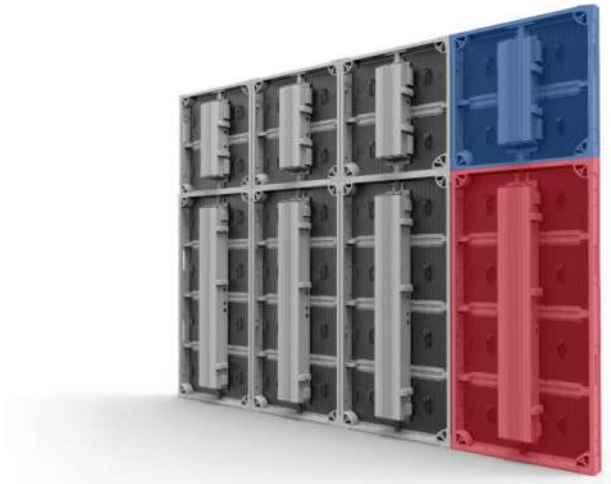

Data sheet						
Model	Malibu 500*500		Malibu 500*750		Malibu 500*1000	
Pixel Pitch(mm)	3.91	4.81	3.91	4.81	3.91	4.81
Physical Density(dot/m ²)	65536	43264	65536	43264	65536	43264
LED type	SMD1921	SMD1921	SMD1921	SMD1921	SMD1921	SMD1921
Module Size(mm*mm)	250*250	250*250	250*250	250*250	250*250	250*250
Cabinet Size(mm*mm)	500*500*67	500*500*67	500*750*67	500*750*67	500*1000*67	500*1000*67
Cabinet Weight(Kg/pcs)	7.8	7.8	10.7	10.7	15	15
Cabinet Resolution	128*128	104*104	128*192	104*156	128*256	104*208
Module Resolution	64*64	52*52	64*64	52*52	64*64	52*52
Viewing Angle(Deg)	160/120	160/120	160/120	160/120	160/120	160/120
Brightness(CD/m ²)	4500	5000	4500	5000	4500	5000
Gray Scale(Bit)	16	16	16	16	16	16
Refresh Rate(Hz)	3840	3840	3840	3840	3840	3840
Max. Cabinet Power Consumption(W)	152	160	228	240	304	320
Average Cabinet Power Consumption(W)	60	64	92	96	121	128
Input Voltage(V)	110-240V	110-240V	110-240V	110-240V	110-240V	110-240V
Working Temperature Range (°C)	-20~ +60	-20~ +60	-20~ +60	-20~ +60	-20~ +60	-20~ +60
Working Humidity Range(RH)	10%~85%	10%~85%	10%~85%	10%~85%	10%~85%	10%~85%
Ingress Protection*	IP65	IP65	IP65	IP65	IP65	IP65
Lifespan(H)	≥50000	≥50000	≥50000	≥50000	≥50000	≥50000
Certificates	CE.FCC.EMC	CE.FCC.EMC	CE.FCC.EMC	CE.FCC.EMC	CE.FCC.EMC	CE.FCC.EMC

* Ingress Protection (Option) Front IP66



McDonald



Mall Gate



Boston Commercial Building

