

UNOMACH

NEW

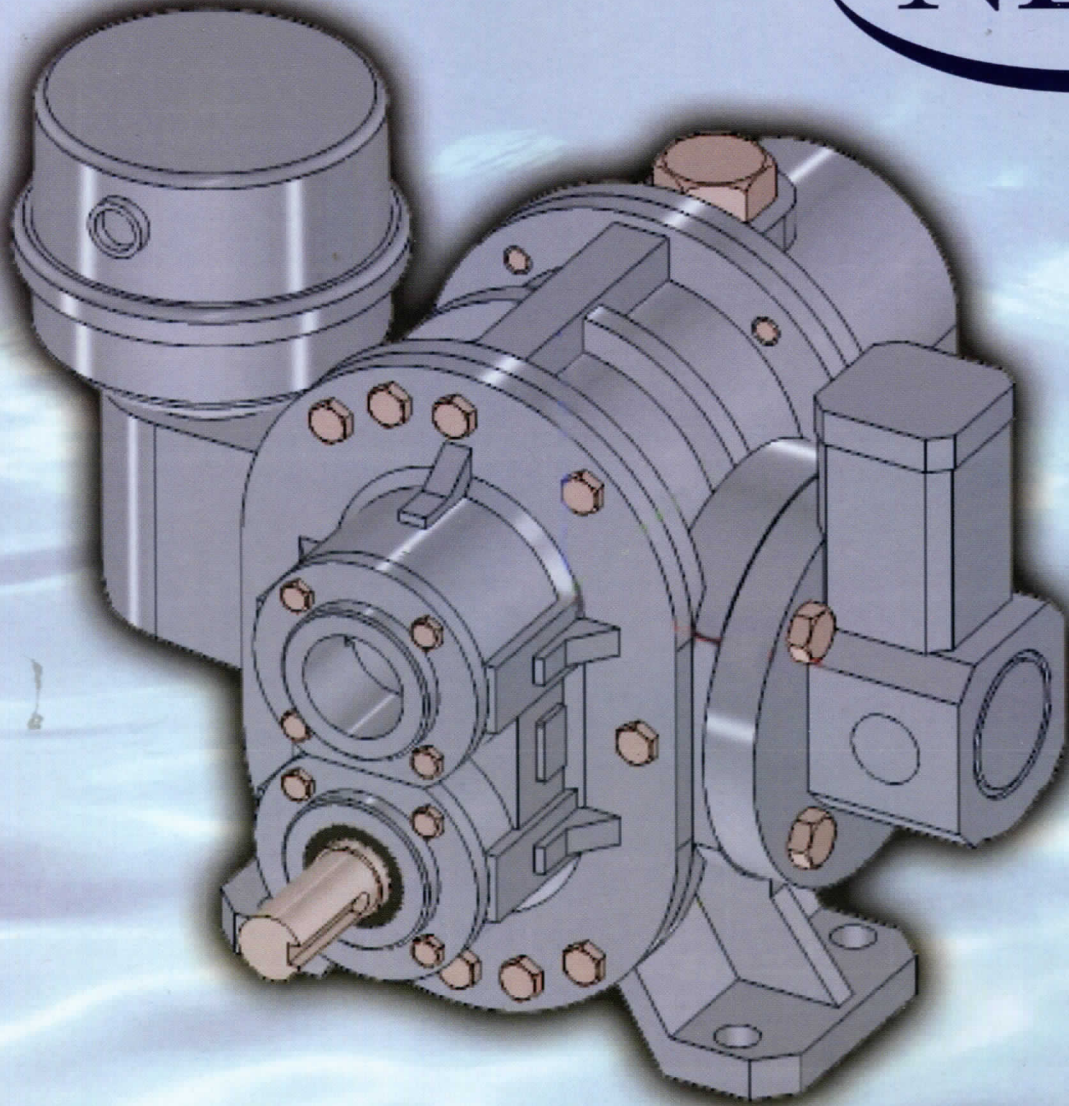

ARS-series

Rotary Roots Blower

UNOMACH

ARS-series Rotary Roots Blower

NEW

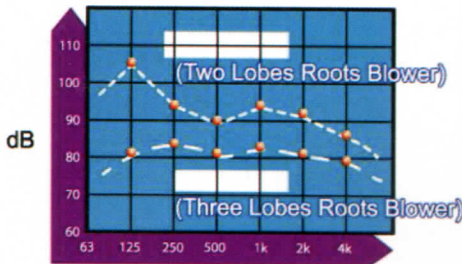
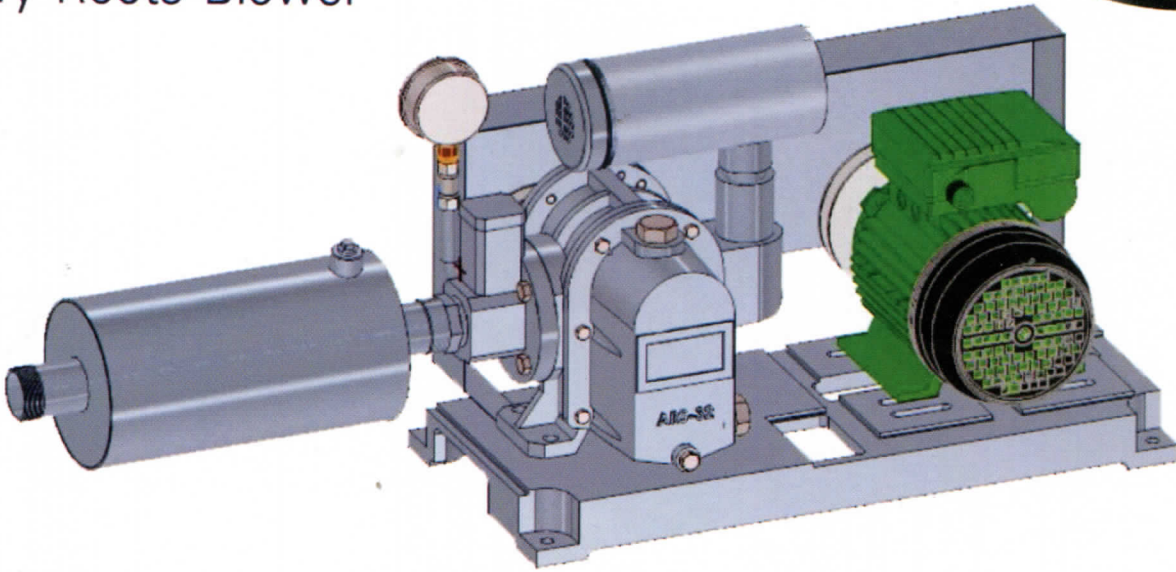

Conventional blowers generate pressure pulses and vibrations which will diminish power and shorten the life of every bearing, gear and other drive train components.

FEATURES:

- Three-lobe rotary roots blower
- Lower noise design due to 3-lobe system and compact body
- Long durability
- Ease of maintenance

APPLICATIONS:

- Aquarium
- Fish farming
- Septic tank
- Wastewater treatment
- Air brush painting
- Spraying via nozzle

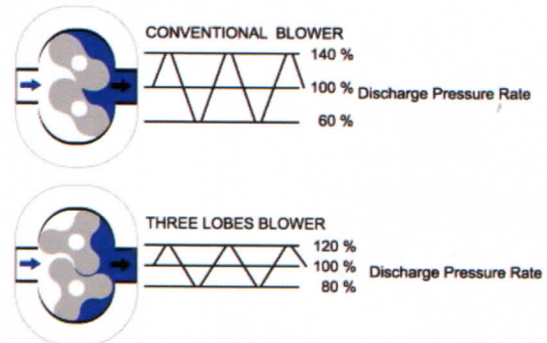

PERFORMANCE TABLE

Model	Speed (min-1)	Capacity Qs (m3/min) & shaft Power						L (kW) at each discharge pressure					
		1000mmAq		2000mmAq		3000mmAq		4000mmAq		5000mmAq		6000mmAq	
		Qs	L	Qs	L	Qs	L	Qs	L	Qs	L	Qs	L
ARS-32	1800	0.48	0.25	0.39	0.37	0.31	0.49	0.25	0.60				
	2550	0.82	0.37	0.72	0.54	0.64	0.72	0.58	0.88				
ARS-40	1650	0.70	0.27	0.62	0.41	0.56	0.56	0.51	0.70	0.47	0.85	0.43	0.99
	1800	0.78	0.29	0.70	0.45	0.64	0.61	0.59	0.77	0.55	0.93	0.51	1.08
	1950	0.86	0.31	0.78	0.49	0.72	0.66	0.67	0.83	0.63	1.00	0.59	1.17
	2100	0.94	0.34	0.87	0.52	0.81	0.71	0.75	0.89	0.71	1.08	0.67	1.27
	2250	1.03	0.36	0.95	0.56	0.89	0.76	0.84	0.96	0.79	1.16	0.75	1.36
	2400	1.11	0.39	1.03	0.60	0.97	0.81	0.92	1.02	0.87	1.23	0.83	1.45

Due to technological development, we reserve the right to change the specifications without prior notice.

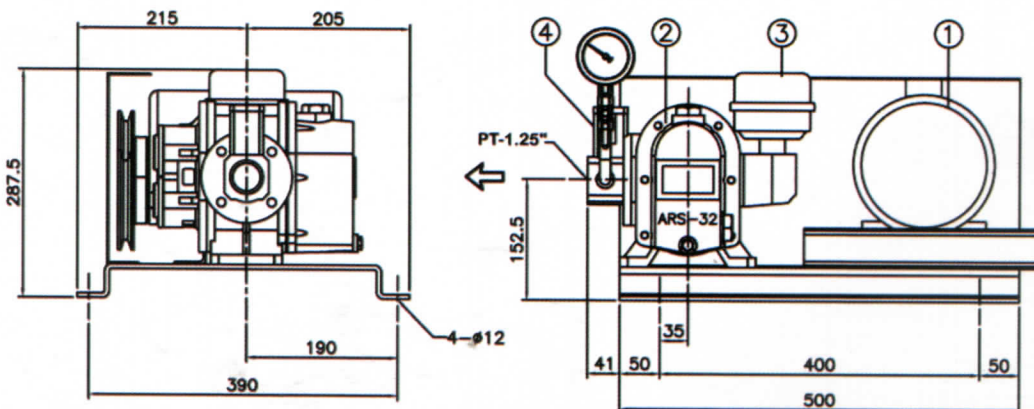

ARS-32

NO.	NAME
1	MOTOR
2	ROOTS BLOWER
3	SUCTION SILENCER
4	SAFETY VALVE & PRESSURE GAUGE & CHECK VALVE
5	DISCHARGE SILENCER

Performance Curve

ARS 32

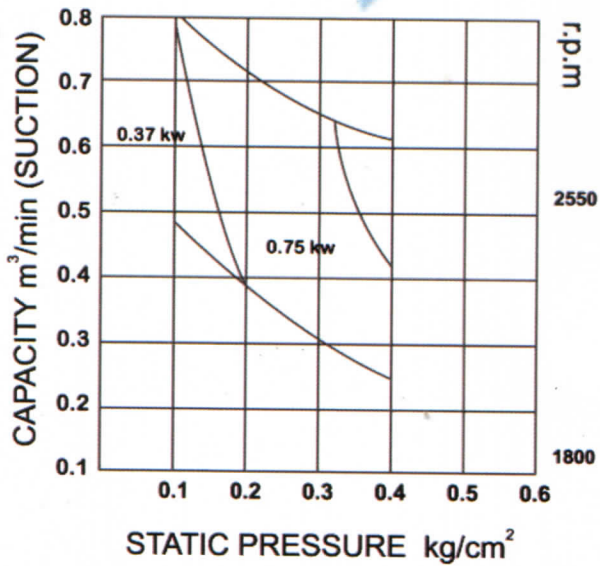

ARS 40

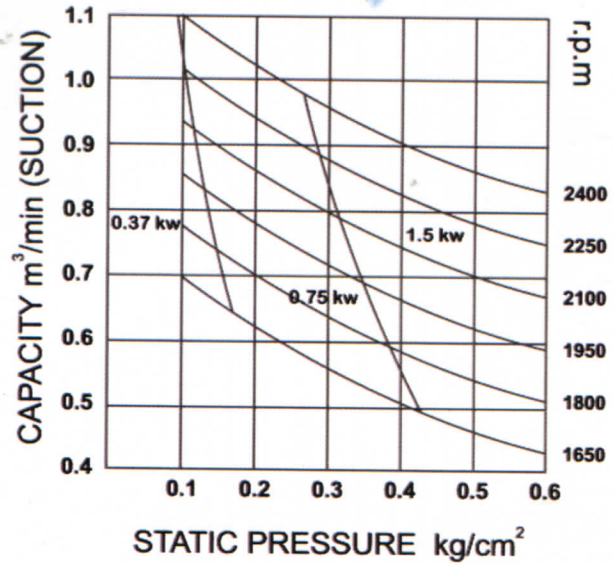

Noise Data

ARS 32

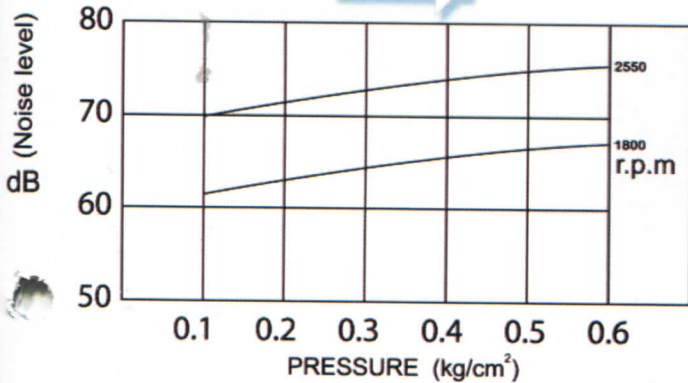

ARS 40

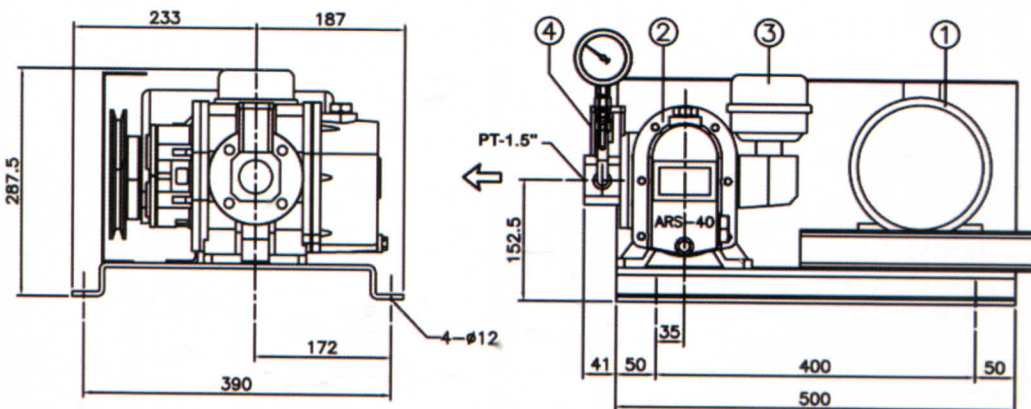
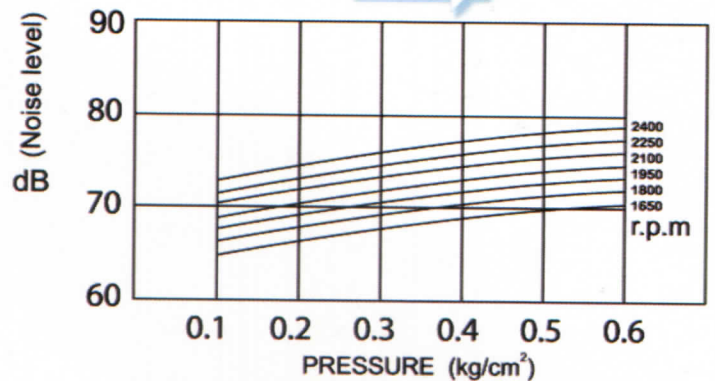

ARS-40

NO.	NAME
1	MOTOR
2	ROOTS BLOWER
3	SUCTION SILENCER
4	SAFETY VALVE & PRESSURE GAUGE & CHECK VALVE
5	DISCHARGE SILENCER

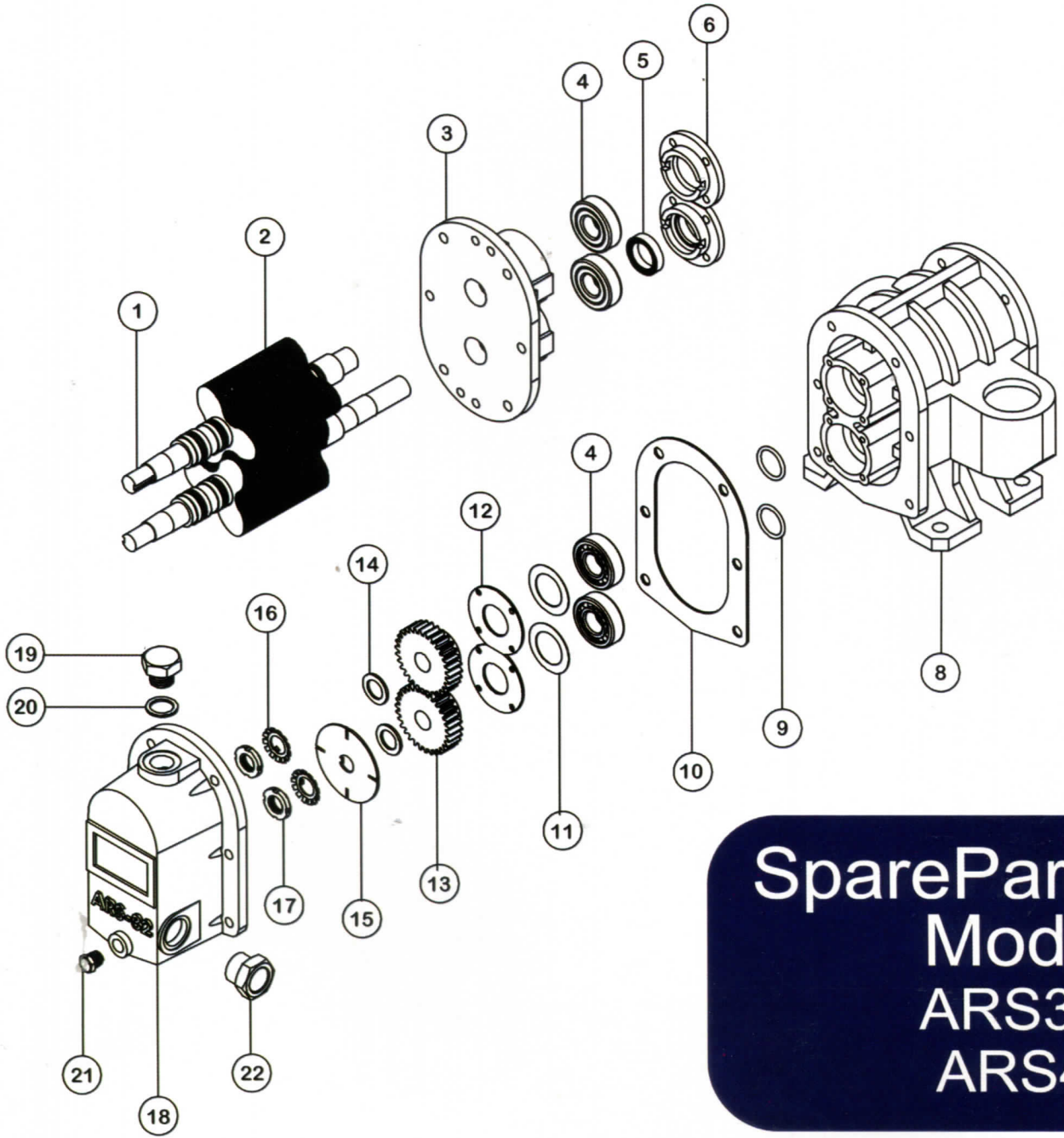

SpareParts Model ARS32, ARS40

Item	Name	Material	Quantity	Item	Name	Material	Quantity
1	Shaft	SCM440	2	13	Timing Gear	SCM415	2
2	Rotor	FC250	2	14	Washer	SS400	2
3	Side Cover	FC250	1	15	Oil Splasher	SS400	1
4	Bearing	SUJ2	4	16	Washer	SS400	2
5	Oil Seal	NBR	1	17	Nut	SS400	2
6	Bearing Cover	SS400	2	18	Oil cover	FC250	1
8	Main casing	FC250	1	19	Oil plug	S45C	1
9	O-ring	NBR	2	20	Washer	Cu	1
10	Packing	Asbestos	1	21	Drain Plug	S45C	1
11	Disc spring	SS400	2	22	Oil Gauge	S45C	1
12	Bearings Planer	SS400	2				