

AI Fever Screening and Access Control System **LPS**

Face Recognition Terminal with Temperature Measurement



Accurate Temperature Detection

- Non-contact temperature measurement by thermal infrared thermopile sensor
- Quick temperature measurement within 300ms with a precision of $\pm 0.3^{\circ}\text{C}$ at 30cm distance
- Set your own acceptable temperature thresholds

Face Recognition

- Accurate and fast recognition speed under 0.5 seconds
- Face recognition distance: 0.3m to 1.5m
- Facial recognition with and without mask
- 24,000 face library capacity and 160,000 face records
- Auto infrared and white fill light compensation, support face recognition under weak light

High Performance Hardware Configuration

- 7-inches IPS HD display and dual-core processor
- On screen messages displays face recognition data and temperature measurement results
- Built-in speaker provide voice prompts including face mask wearing alert, forced mask wearing alert, normal temperature and high temperature detecting.
- Supports English and Thai languages
- Support various expansion interfaces; Wiegand 26/34 input and output, RS-485, USB, RJ45, switch output
- Support time attendance access control solution
- Integrate with gates, turnstiles and door access
- Communicates with the turnstile via Wiegand and switch output
- Configurable open door status when detecting normal temperature and face mask wearing
- Configuration via web browser
- Export logs to excel file via web browser
- Supports TF card storage to keep picture history and temperature data
- Support H.265 video compression coding for recording and storing on NVR or other storage devices
- Provide a variety of installation methods, such as wall mounted, floor standing or turnstile gates (option)
- Suitable for schools, campus, offices, stores, factories, airport, financial industries, etc.



AI Fever Screening and Access Control System

Face Recognition Terminal with Temperature Measurement

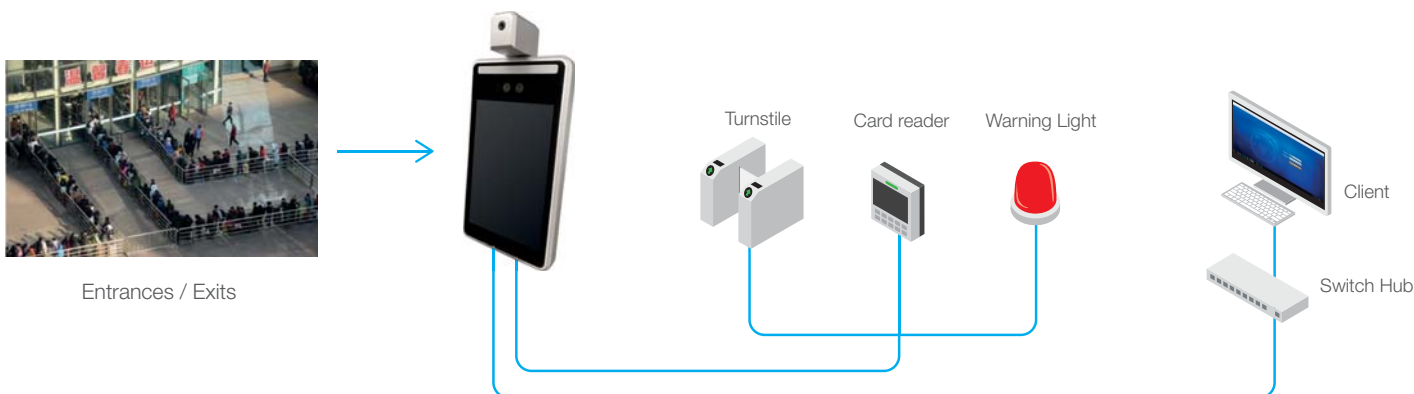

Dual Lens Camera	Image sensor	1/28" Progressive Scan CMOS
	Image resolution	2 MP, 1920 x 1080 pixels
	Minimum illumination	Color 0.01 Lux @F1.2 (ICR), B/W 0.001 Lux @F1.2 (ICR)
	WDR	120 dB, ISP algorithm face partial exposure
	SNR	≥50dB (AGC off)
	Lens	6mm.
Temperature Measurement	Sensor type	Thermal infrared thermopile sensor (medical-grade)
	Measurement range	16 - 40°C (indoor and windless)
	Measurement accuracy	± 0.3°C
	Temperature resolution	0.1°C
	Measurement distance	≤ 30 cm
	Measurement response time	300 ms
Face Recognition	Recognition distance	0.3 - 1.5 m
	Recognition height	1.2 - 2.2 m, adjustable angle
	Recognition time	< 0.5 sec.
	Face capacity	24,000 faces
	Face recognition records	160,000 face records
	Hardware	Power
Processor		Dual-core processor (Hi3516D V300)
Memory		1GB RAM +16GB Flash
Operating system		Linux
Display		7-inch IPS HD screen
Light compensation		White LED and Infrared
Angle range		Horizontal: ±30°, Vertical: ±30°
Storage		Support TF card
Voice prompt		Customize
Installation method		Wall mounted and floor standing, stand for turnstile is optional
Interface		Network
	USB	1 x USB 2.0
	Switch	1 x Switch output
	Wiegand	1 x WG26/34 input, 1 x WG26/34 output
	RS-485	1 x RS-485
	Power	DC 12V, 2A
	Environment	Application
Operating temperature		10 - 45°C
Relative humidity		0 - 90% (non-condensing)
Dimension	W x H x D in mm.	128 x 240 x 28mm (without bracket)
Weight		1.7 kg

LEO POWER SUPPLY CO.,LTD.

27, 4th Floor, Soi Bangna-Trad Rd 34, Bangna Tai, Bangna, Bangkok 10260 THAILAND
Tel. 0-2746-9500 Fax. 0-2746-8712 e-mail : marketing@lpsups.com www.lpsups.com