

LPS

Face Recognition Terminal with Temperature Measurement



FRT-1

Accurate Temperature Detection

- Non-contact temperature measurement by thermal infrared thermopile sensor
- Quick temperature measurement within 300ms with a precision of $\pm 0.3^{\circ}\text{C}$ at 30cm distance
- Set your own acceptable temperature thresholds

Face Recognition

- Accurate and fast recognition speed under 0.5 seconds
- Face recognition distance: 0.3m to 1.5m
- Facial recognition with and without mask
- 24,000 face library capacity and 160,000 face records
- Auto infrared and white fill light compensation, support face recognition under weak light
- Anti-spoofing from a photograph or 3D printed masks

High Performance Hardware Configuration

- 7-inches IPS HD display and dual-core processor
- On screen messages displays face recognition data and temperature measurement results
- Built-in speaker provide voice prompts including face mask wearing alert, forced mask wearing alert, normal temperature and high temperature detecting.
- Supports English and Thai languages
- Support various expansion interfaces; Wiegand 26/34 input and output, RS-485, USB, RJ45, and switch output
- Communicates with the turnstile via Wiegand and switch output
- Support H.265 video compression coding for recording and storing on NVR or other storage devices
- Provide a variety of installation methods, such as wall mounted, floor standing or turnstile gates (option)
- Configuration via web browser and able to export logs to excel file via optional monitoring software
- Face record data monitoring on cloud server (option)

Wide Applications

- Integrate with gates, turnstiles, door access control or time attendance system
- Configurable open door status when detecting normal temperature and face mask wearing
- Suitable for schools, campus, offices, stores, factories, airport, financial industries, government etc.



Leontica Facipage							Verify Record
Time	Name	Study Temp (°C)	Stability %	Verify status	Temp alarm	Temp trend	Image link
2020-07-01 13:19:19	Polystyrene Warhead	20.6	79.9	aligned	no	yes	http://www.biorxiv.com/content/2020/07/01/20200701/figure-asset/20200701_131919.jpg
2020-07-01 14:26:58	WfH	20.6	67.5	aligned	no	yes	http://www.biorxiv.com/content/2020/07/01/20200701/figure-asset/20200701_142658.jpg
2020-07-01 15:04:55	WfH Warhead	20.6	63.3	aligned	no	yes	http://www.biorxiv.com/content/2020/07/01/20200701/figure-asset/20200701_150455.jpg
2020-07-01 15:05:07	Silicone Warhead	20.6	63.3	aligned	no	yes	http://www.biorxiv.com/content/2020/07/01/20200701/figure-asset/20200701_150507.jpg
2020-07-01 15:16:44	Silicone Warhead	20.6	63.3	aligned	no	yes	http://www.biorxiv.com/content/2020/07/01/20200701/figure-asset/20200701_151644.jpg
2020-07-01 15:27:26	Phosphoric Na-phthalate	20.6	60.0	aligned	no	yes	http://www.biorxiv.com/content/2020/07/01/20200701/figure-asset/20200701_152726.jpg
2020-07-01 15:27:26	Phosphoric Na-phthalate	20.6	60.0	aligned	no	yes	http://www.biorxiv.com/content/2020/07/01/20200701/figure-asset/20200701_152726.jpg
2020-07-01 16:06:57	Phosphoric Warhead	20.6	60.0	aligned	no	yes	http://www.biorxiv.com/content/2020/07/01/20200701/figure-asset/20200701_160657.jpg
2020-07-01 17:11:14	Amesbury Warhead	20.6	60.0	aligned	no	yes	http://www.biorxiv.com/content/2020/07/01/20200701/figure-asset/20200701_171114.jpg
2020-07-01 17:37:07	Phosphoric Warhead	20.6	74.0	aligned	no	yes	http://www.biorxiv.com/content/2020/07/01/20200701/figure-asset/20200701_173707.jpg
2020-07-01 17:53:46	Temperatures Warhead	20.6	66.0	aligned	no	yes	http://www.biorxiv.com/content/2020/07/01/20200701/figure-asset/20200701_175346.jpg
2020-07-01 17:53:49	Temp Warhead	20.6	66.0	aligned	no	yes	http://www.biorxiv.com/content/2020/07/01/20200701/figure-asset/20200701_175349.jpg
2020-07-01 18:03:19	Neutron Warhead	20.6	67.5	aligned	no	yes	http://www.biorxiv.com/content/2020/07/01/20200701/figure-asset/20200701_180319.jpg
2020-07-01 18:20:21	Temperatures Warhead	20.6	66.0	aligned	no	yes	http://www.biorxiv.com/content/2020/07/01/20200701/figure-asset/20200701_182021.jpg
2020-07-01 18:36:36	Neutron Warhead	20.6	66.0	aligned	no	yes	http://www.biorxiv.com/content/2020/07/01/20200701/figure-asset/20200701_183636.jpg
2020-07-01 18:44:54	WfH	20.6	67.5	aligned	no	yes	http://www.biorxiv.com/content/2020/07/01/20200701/figure-asset/20200701_184454.jpg
2020-07-01 18:44:54	WfH	20.6	67.5	aligned	no	yes	http://www.biorxiv.com/content/2020/07/01/20200701/figure-asset/20200701_184454.jpg
2020-07-01 19:03:36	Temp Warhead	20.6	66.0	aligned	no	yes	http://www.biorxiv.com/content/2020/07/01/20200701/figure-asset/20200701_190336.jpg
2020-07-01 19:03:36	Temp Warhead	20.6	66.0	aligned	no	yes	http://www.biorxiv.com/content/2020/07/01/20200701/figure-asset/20200701_190336.jpg

Face record data monitoring on cloud server (option)

AI Fever Screening and Access Control System

LPS

Face Recognition Terminal with Temperature Measurement (FRT-1)

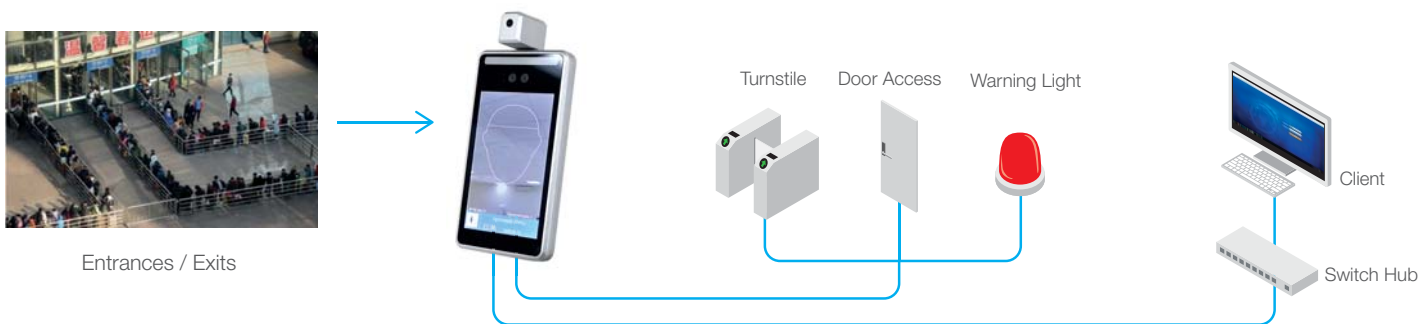

Dual Lens Camera	Image sensor	1/28" Progressive Scan CMOS
	Image resolution	2 MP, 1920 x 1080 pixels
	Minimum illumination	Color 0.01 Lux @F1.2 (ICR), B/W 0.001 Lux @F1.2 (ICR)
	WDR	120 dB, ISP algorithm face partial exposure
	SNR	≥50dB (AGC off)
	Lens	6mm.
Temperature Measurement	Sensor type	Thermal infrared thermopile sensor (medical-grade)
	Measurement range	16 - 40°C (indoor and windless)
	Measurement accuracy	± 0.3°C
	Temperature resolution	0.1°C
	Measurement distance	≤ 30 cm
	Measurement response time	300 ms
Face Recognition	Recognition distance	0.3 - 1.5 m
	Recognition height	1.2 - 2.2 m, adjustable angle
	Recognition time	< 0.5 sec.
	Face capacity	24,000 faces
	Face recognition records	160,000 face records
Hardware	Power	12 Vdc / 2A (14.1W max.)
	Processor	Dual-core processor (Hi3516D V300)
	Memory	1GB RAM +16GB Flash
	Operating system	Linux
	Display	7-inch IPS HD screen
	Light compensation	White LED and Infrared
	Angle range	Horizontal: ±30°, Vertical: ±30°
	Installation method	Wall mounted and floor standing, stand for turnstile is optional
Interface	Network	RJ45 10/100Mbps Ethernet
	USB	1 x USB 2.0
	Switch	1 x Switch output
	Wiegand	1 x WG26/34 input, 1 x WG26/34 output
	RS-485	1 x RS-485
	Power	DC 12V, 2A
Environment	Application	Indoor and windless
	Operating temperature	10 - 45°C
	Relative humidity	0 - 90% (non-condensing)
Dimension	W x H x D in mm.	128 x 240 x 28mm (without bracket)
Weight		1.7 kg

Note: This product is designed to be use as a screening device, not a medical devices. FRT is not intended for medical purposes.
Continuous product development is our commitment. In that manner, the above specifications may be changed without prior notice.

LEO POWER SUPPLY CO.,LTD.

27, 4th Floor, Soi Bangna-Trad Rd 34, Bangna Tai, Bangna, Bangkok 10260 THAILAND
Tel. 0-2746-9500 Fax. 0-2746-8712 e-mail : marketing@lpsups.com www.lpsups.com

LPS.BRO.FRT.245 Rev.3.00/2020