

# KF700-FA Series... Flange Type Electromagnetic Flowmeter

## Specifications

**Accuracy :** With the range  $\pm 0.5\%$

**Flow Velocity Range :** 0.1m/s - 10 m/s

**Medium Conductivity :**  $> 5\mu\text{S/cm}$

**Pipe Size :** DN10 to DN1200

**Body & Flange Material :** Carbon Steel, 304SS, 316SS

**Electrode Material :** 316L SS, Hastelloy Hc, Hastelloy Hb, Titanium, Tantalum

**Liner Material :** Hard Rubber, PTFE, PFA, Polyurethane, Ceramics, F-46

**Temperature Rating :** 80°C to 120°C (Varies by Liner material and installation type of converter)

**Pressure Rating :** PN6, PN10, PN16, PN40 (Varies by size)

**Enclosure Rating :** IP65, IP67, IP68 (Remote type only)

**Compact Type Converter :** MF710 or MF720

**Remote Type Converter :** MF730

**Power Supply :** 85-265V AC, 50Hz, 85-265V AC, 60Hz, 18-36V DC

**Output Signal :** 4-20mA, Pulse

**Communication :** RS485. Option : HART (MF720, MF730)

**Electrical Connection :** 2 x M20x1.5 Cable Gland

**Process Connection :** Flange (DIN2501, ANSI, JIS)



MF730 Converter



MF710 Converter



MF720 Converter

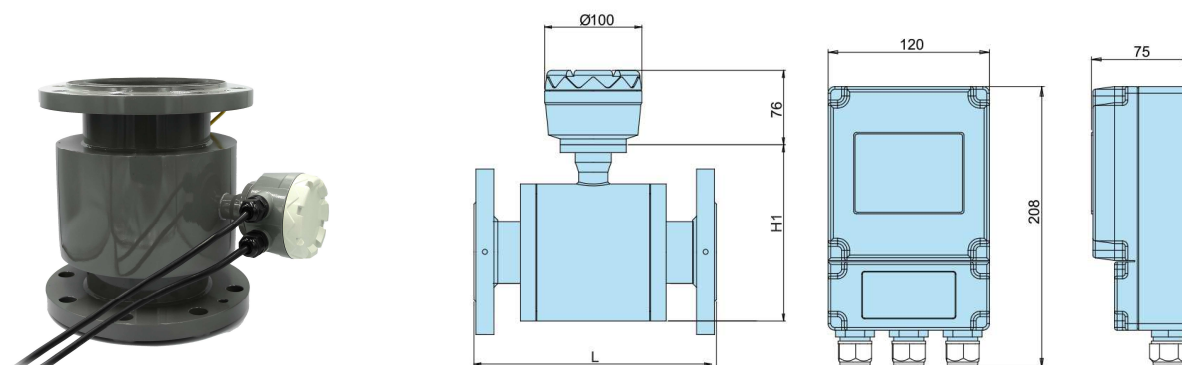

FA Series with MF730 Converter (Remote Type) Dimension (mm)

### KF700-FA Series External Dimensions For Compact and Remote Type (Base on DIN Standard)

DN (mm)	Working Pressure (Bar)	L	D	C	N - ØA	H1	Compact Type Weight (KG)	Remote Type Weight (KG)
10	40 Bar	150	90	60	4- Ø14	130	6	4
15		150	95	65	4- Ø14	132.5	6	4
20		150	105	75	4- Ø14	137.5	8	6
25		150	115	85	4- Ø14	145	9	7
32		150	140	100	4- Ø18	162.5	11	12
40		150	150	110	4- Ø18	172.5	13	14
50		200	165	125	4- Ø18	187.5	15	15
65		200	185	145	4- Ø18	202.5	16	18
80		200	200	160	4- Ø18	220	19	20
100		16 Bar	250	220	180	8- Ø18	230	23
125	250		250	210	8- Ø18	270	27	29
150	250		285	240	8- Ø22	302.5	33	36
200	10 Bar	350	340	295	8- Ø22	352.5	51	49
250		400	395	350	12- Ø22	407.5	70	70
300		500	445	400	12- Ø22	460	102	100
350		500	505	460	16- Ø22	517.5	123	121
400		600	565	515	16- Ø26	572.5	147	145
450		600	615	565	20- Ø26	622.5	212	207
500		600	670	620	20- Ø26	675	229	210
600		600	780	725	20- Ø30	745	252	250
700		700	895	840	24- Ø30	892	352	350
800		800	1015	950	24- Ø33	1002.5	462	460
900	6 Bar	900	1115	1050	28- Ø33	1102.5	558	550
1000		1000	1175	1120	28- Ø30	1182.5	690	680
1200		1200	1405	1340	32- Ø33	1397.5	785	780
1400		1400	1630	1560	36- Ø36	1610	1258	1250
1600		1600	1830	1760	40- Ø36	1810	1565	1550

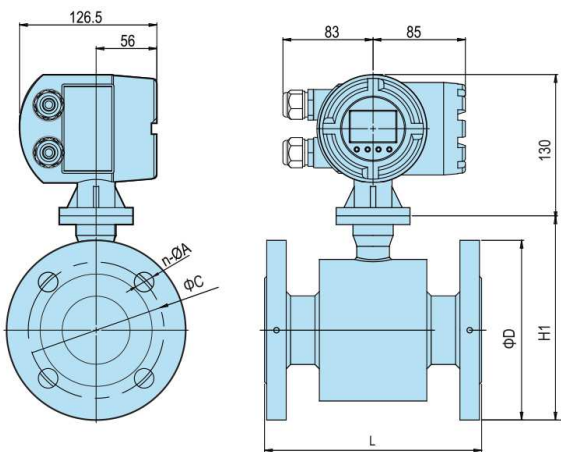

FA Series with MF710 Converter Dimension (mm)

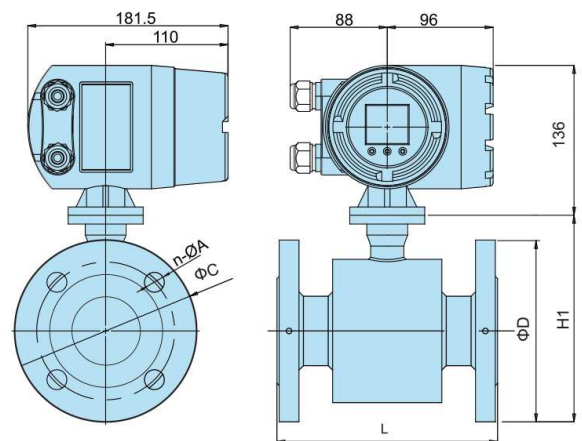

FA Series with MF720 Converter Dimension (mm)

KF700-FA SERIES ORDERING INFORMATION												
Example	KF700-FA	-A1	-2	-A	-A	-25	-L	-3	-2	-1	-A	-1
Series	KF700-FA											Flange Type Electromagnetic Flowmeter
Converter Type		A1										Compact Type with MF710 Converter
		A2										Compact Type with MF720 Converter
		B3										Remote Type with MF730 Converter
Flange Standard			1									DN Standard PN6
			2									DN Standard PN10
			3									DN Standard PN16
			4									DN Standard PN25
			5									DN Standard PN40
			6									ANSI 150 #RF
			7									JIS10K #RF
Flange Material				A								Carbon Steel with epoxy paint coated
				B								304 Stainless Steel
				C								316L Stainless Steel
Body Material					A							Carbon Steel with epoxy paint coated
					B							304 Stainless Steel
					C							316L Stainless Steel
Pipe Size						10						DN10, 0.05m³/h - 1.6m³/h, PN40
						15						DN15, 0.2m³/h - 4m³/h, PN40
						20						DN20, 0.3m³/h - 6m³/h, PN40
						25						DN25, 0.5m³/h - 10m³/h, PN40
						32						DN32, 0.8m³/h - 16m³/h, PN40
						40						DN40, 1.2m³/h - 25m³/h, PN40
						50						DN50, 2m³/h - 40m³/h, PN40
						65						DN65, 3.5m³/h - 60m³/h, PN40
						80						DN80, 5m³/h - 100m³/h, PN40
						100						DN100, 8m³/h - 160m³/h, PN16
						125						DN125, 12m³/h - 250m³/h, PN16
						150						DN150, 18m³/h - 400m³/h, PN16
						200						DN200, 30m³/h - 600m³/h, PN10
						250						DN250, 50m³/h - 800m³/h, PN10
						300						DN300, 70m³/h - 1200m³/h, PN10
						350						DN350, 100m³/h - 1,600m³/h, PN10
						400						DN400, 120m³/h - 2,000m³/h, PN10
						450						DN450, 120m³/h - 2,000m³/h, PN10
					500						DN500, 200m³/h - 3,000m³/h, PN10	
					600						DN600, 300m³/h - 4,000m³/h, PN10	
					700						DN700, 400m³/h - 5,000m³/h, PN10	
					800						DN800, 500m³/h - 6,000m³/h, PN10	
					900						DN900, 650m³/h - 8,000m³/h, PN10	
					1000						DN1000, 800m³/h - 10,000m³/h, PN6	
					1200						DN1200, 1,200m³/h - 10,000m³/h, PN6	
					1400						DN1400, 1,500m³/h - 20,000m³/h, PN6	
					1600						DN1600, 2,000m³/h - 30,000m³/h, PN6	
Electrode Material							L					316L Stainless Steel
							C					Hastelloy Hc
							B					Hastelloy Hb
							T					Titanium (Ti)
							P					Platinum (Pt)
							A					Tantalum (Ta)
Liner Material								1				Neoprene Rubber (DN50-DN1600)
								2				PTFE (DN25-DN1600)
								3				Polyurethane (DN25-DN300)
								4				F46 (DN10-DN300)
								5				PFA (DN10-DN300)
								6				Ceramic
								7				Hard Rubber (DN50-DN1600)
Enclosure Rating									1			IP65
									2			IP67
									3			IP68 (Remote Type)
Output Signal										2		4-20mA + Pulse + RS485
										3		4-20mA + Pulse + HART (MF720, MF730)
Power Supply											A1	85-265V AC 50Hz
											A2	85-265V AC 60Hz
											B	18-36V DC
Grounding Type												1 None (Suitable for metal pipe)
												2 3 Electrodes (Suitable for Plastic pipe)
												3 Grounding Ring (Suitable for occasions with stick requirements on accuracy and stability)