

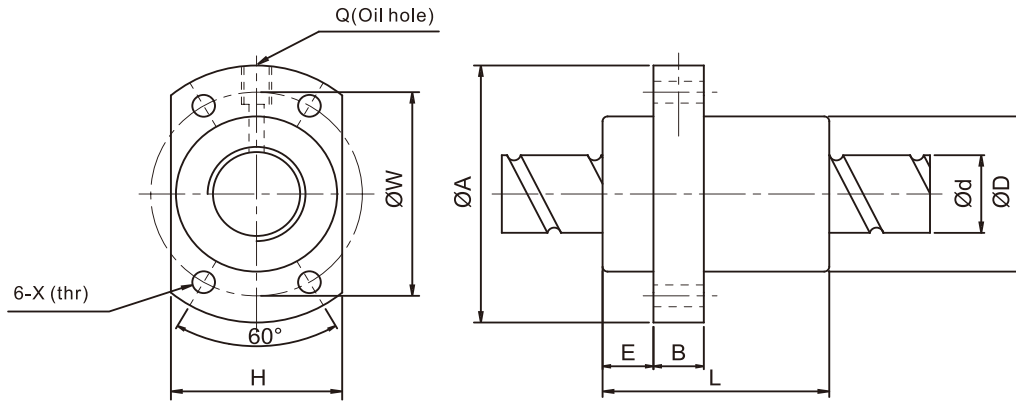

Ball Screw - SFY Series

2-7 Size Table of SFY Ball Screws



I:Lead Da:Ball Diameter n:Number of Circuits K:Stiffness(Kgf/μm)

Ca:Basic Dynamic Rating Load(Kgf) Coa: Basic Static Rating Load(Kgf)

Unit:mm

Model no.	d	I	Da	Dimension										Load Rating Ca(kgf)	Load Rating Coa(kgf)
				D	A	E	B	L	W	H	X	Q	n		
SFY1616-3.6	16	16	2.778	32	53	10.1	10	45	42	34	4.5	M6x1	1.8×2	1073	2551
SFY2020-3.6	20	20	3.175	39	62	13	10	52	50	41	5.5	M6x1	1.8×2	1387	3515
SFY2040-1.6	20	20	3.175	39	62	13	10	48	50	41	5.5	M6x1	0.8×2	653	1597
SFY2550-1.6	25	25	3.969	47	74	15	12	58	60	49	6.6	M6X1	0.8×2	976	2495
SFY2525-3.6	25	25	3.969	47	74	15	12	64	60	49	6.6	M6x1	1.8×2	2074	5494
SFY3232-3.6	32	32	4.762	58	92	17	12	78	74	60	9	M6x1	1.8×2	3021	8690
SFY4040-3.6	40	40	6.35	73	114	19.5	15	99	93	75	11	M6x1	1.8×2	4831	14062
SFY5050-3.6	50	50	7.938	90	135	21.5	20	117	112	92	14	M6x1	1.8×2	7220	21974