

# USER'S MANUAL

# KC-70A



**KUKDONG**  
MATERIAL HANDLING

## ● DIRECTIONS FOR USE

1. CHOOSE CORRECT CAPACITY AFTER CONSIDERING LOADING WEIGHT.
2. CHECK THE DISTANCE BETWEEN LOADING AND HEIGHT OF TRIPOD.
3. HANG TOP HOOK ON THE STABLE HOOK OR TRIPOD.
4. CHECK OPERATING STATE OF HAND CHAIN.
5. CHECK IF LOAD CHAIN IS TWISTED OR NOT.
6. EQUIP BOTTOM HOOK ON TRIPOD.
7. MAKE LOAD CHAIN IN THE TIGHT WAY GO UPWARD AND DOWNWARD AROUND 4inch.
8. AFTER No.7 MOVE LOADING INTO REQUIRED POSITION.
9. REMOVE BOTTOM HOOK AFTER LOADING IS WELL POSITIONED.

## ● AFTER USE

1. DO IT AFTER PUTTING BOTTOM HOOK DOWN COMPLETELY.
2. APPLY OIL TO REVOLVING PARTS OF LOAD CHAIN & HOOK AFTER REMOVING DUST & MOISTURE.
3. KEEP THEM WHERE IS WELL VENTILATED OR DRIED.

## ● ASS'Y & DISASS'Y (MAINTENANCE & CHECKING)

### - SEE 'PART LIST'

CHANGE SPARE PART IN CASE OF DEFORMITY  
(EXTENSION, GROOVE, WEAR, DAMAGE etc.)

1. [DISASS'Y 1] REMOVE LOAD CHAIN
2. [DISASS'Y 2] REMOVE WHEEL COVER
3. [DISASS'Y 3] REMOVE HAND CHAIN
4. [DISASS'Y 4] REMOVE COTTER PIN AND RELEASE HUB
5. [DISASS'Y 5] REMOVE GEAR COVER
6. [ASSEMBLY] OPPOSITE OF DISASSEMBLY

## ● SPECIAL MENTION

1. MARKS OF TWO 2nd GEARS MUST BE ON A STRAIGHT LINE AS PIC.1
2. OIL & DIRT MUST BE REMOVED ON CONTACT SURFACE OF BRAKE DISC & HUB , RATCHET GEAR, HAND WHEEL.
3. HOW TO ADJUST BRAKE : RELEASE PINION NUT'S GROOVE A BIT AT PINION NUT'S COMPLETE FASTENING [PIC.2 A] AND THEN, INSERT COTTER PIN [PIC.2 B] AND COMBINE REVOLVING AS [PIC.3]

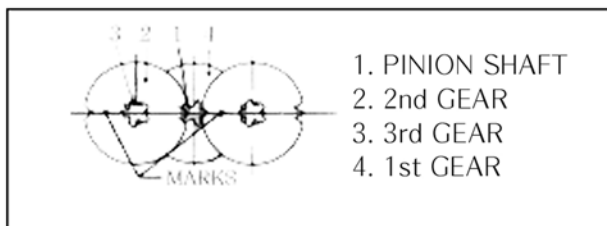

[PIC.1] GEAR (HOE TO JOIN)

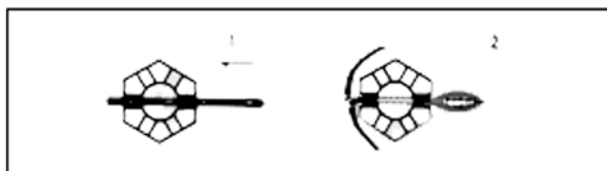

[PIC.3] COTTER PIN (HOW TO JOIN)

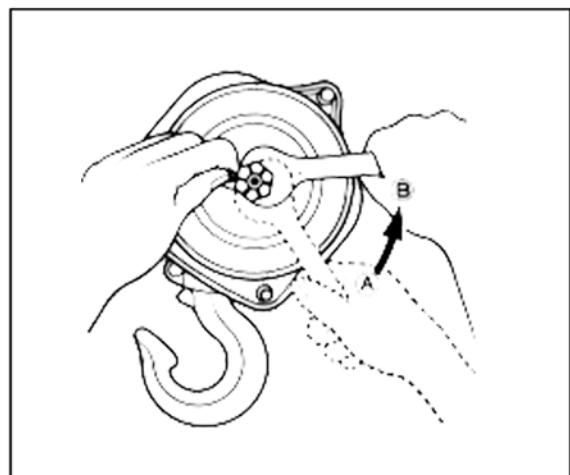

[PIC.2] PINION NUT (HOW TO ADJUST)

## PART LIST

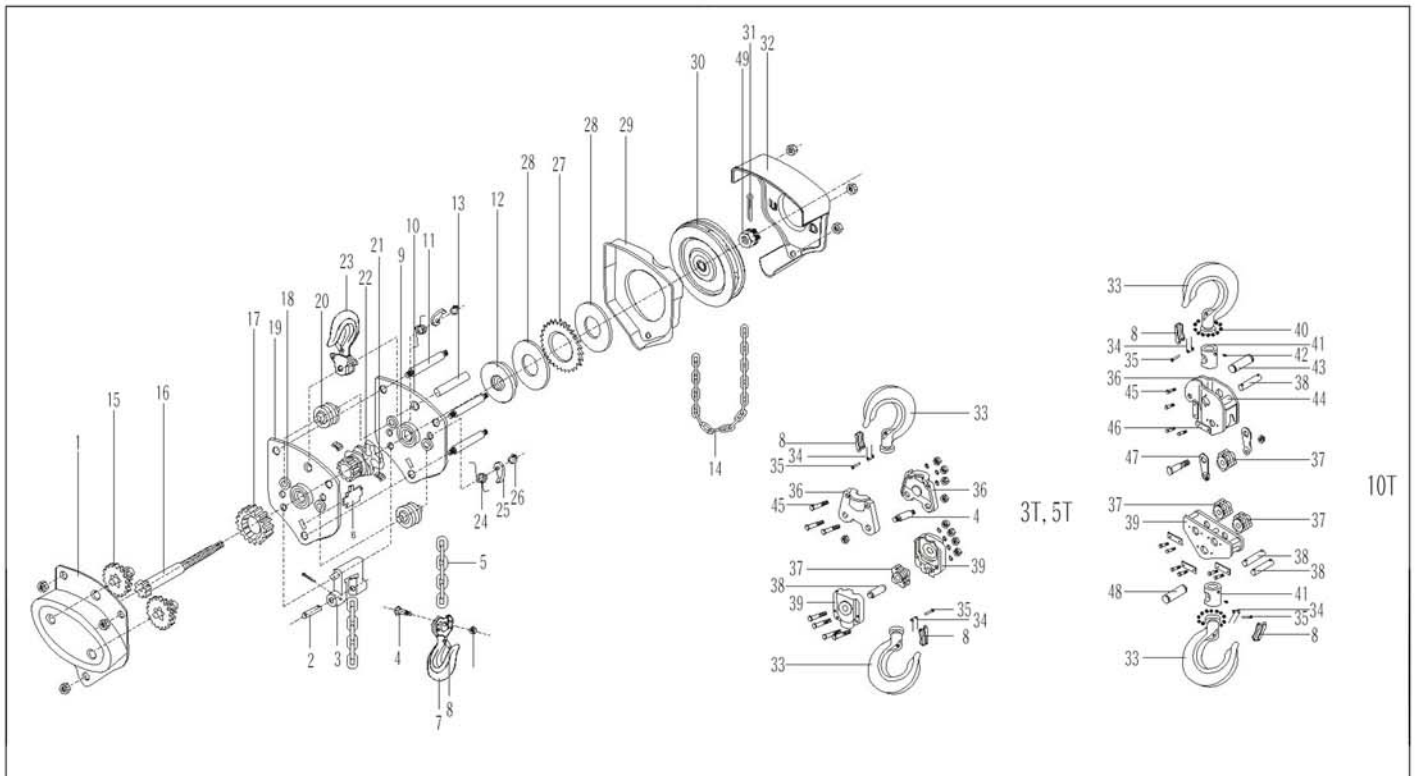

1. BENT PLATE	10. LEFT SIDE PLATE	19. RIGHT SIDE PLATE	28. FRICTION PLATE	37. MOVE WHEEL	46. STRIPPER
2. END ANCHOR PIN	11. STAY BOLT	20. GUIDE ROLLER	29. BRAKE COVER	38. MOVE WHEEL PIN	47. SLING PLATE
3. END ANCHOR	12. BRAKE SEAT	21. ROLLER	30. HAND WHEEL	39. BOTTOM HOOK FRAME	48. BOTTOM HOOK PIN
4. CHAIN PIN	13. HOOK PIN	22. LOAD SHEAVE	31. COTTER PIN	40. ROW	49. CASTLE NUT
5. LOAD CHAIN	14. HAND CHAIN	23. TOP HOOK ASS'Y	32. HAND WHEEL COVER	41. HOOK FRAME BAR	
6. STRIPPER	15. DISK GEAR	24. DOUBLE SPRING	33. HOOK	42. LOCK SCREW	
7. BOTTOM HOOK ASS'Y	16. DRIVING SHAFT	25. PAWL	34. SPRING	43. TOP HOOK PIN	
8. SAFE CLIP	17. SPLINED GEAR	26. SPRING RING	35. RIVET	44. BUNTON	
9. BEARING RACE	18. STEEL BUSHING	27. RATCHET DISK	36. TOP HOOK FRAME	45. SCREW	

## STANDARD SPECIFICATION

MODEL	0.5ton	1.0ton	1.5ton	2.0ton	3.0ton	5.0ton
CAPACITY	0.5	1.0	1.5	2.0	3.0	5.0
RUNNING HIGHT (ft/m)	8.2/2.5	8.2/2.5	8.2/2.5	9.8/3.0	9.8/3.0	9.8/3.0
TEST LOAD (ton)	0.7	1.5	2.2	3.0	4.6	7.5
HANDLE PULL (kg)	23	30	32	36	34	41
NO OF COLUMNS OF LOAD CHAIN	1	1	1	1	2	2
LOAD CHAIN DIA (inch/mm)	0.24/6.0	0.24/6.0	0.32/8.0	0.32/8.0	0.32/8.0	0.39/10.0
NET WEIGHT (kg)	10.0	12.0	19.0	20.0	27.0	45.5
DIMENSIONS (inch/mm)	A	5.0/127	6.2/158	6.9/174	7.4/187	7.8/199
	B	5.2/131	5.5/140	6.3/161	6.3/161	7.3/186
	C	10.6/270	12.5/317	15.7/399	16.3/414	18.3/465

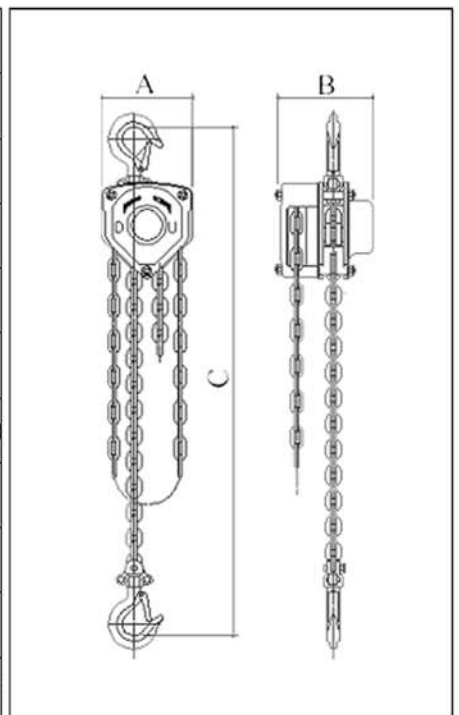

# EIGHT DONT'S THAT SHOULD BE OBSERVED.

SINCE THE CHAIN BLOCK HANDLES HEAVY OBJECTS, NEGLECT OF SAFETY PRECAUTIONS CAN LEAD TO DAMAGES TO ARTICLES OR LOSS OF LIFE. YOU CANNOT BE TOO CAREFUL ABOUT HANDLING.



1. DO NOT APPLY OVER SPECIFIED LOAD.

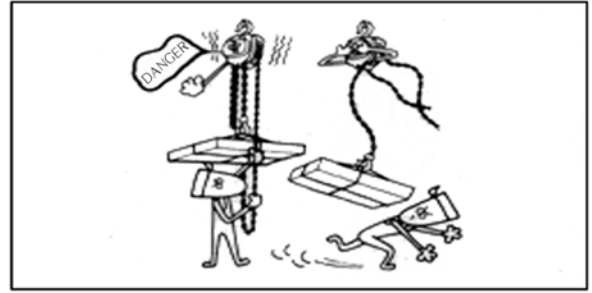

2. DO NOT USE DEFORMED PARTS.

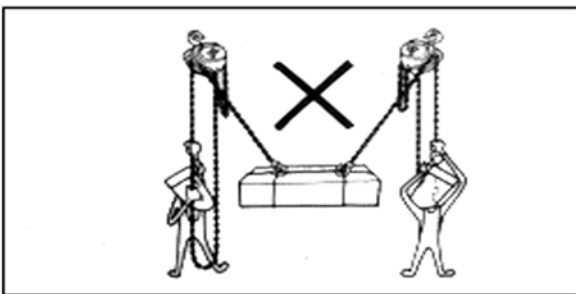

3. DO NOT TRY TO SUSPEND A LOADING WITH TWO BLOCKS.

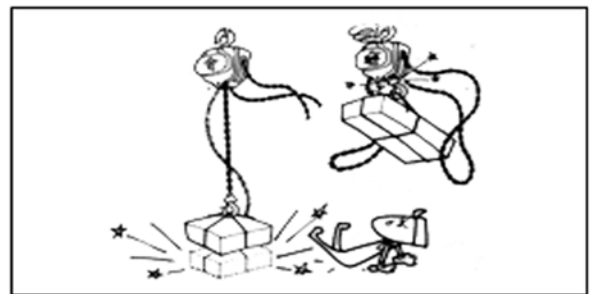

4. DO NOT USE TO THE MAX. AND MIN.

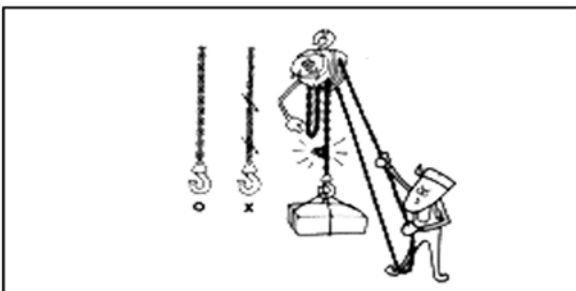

5. DO NOT USE TWISTED OR KINKED CHAIN.

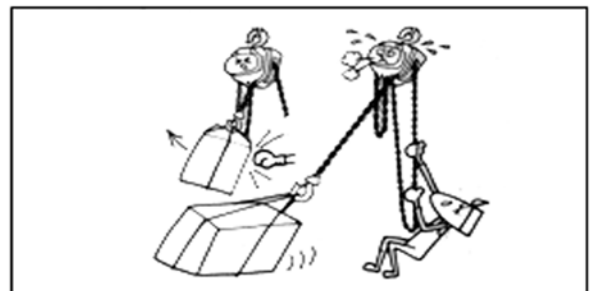

6. DO NOT GIVE IMPACT LOAD TO TOP & BOTTOM HOOK AND CHAIN.

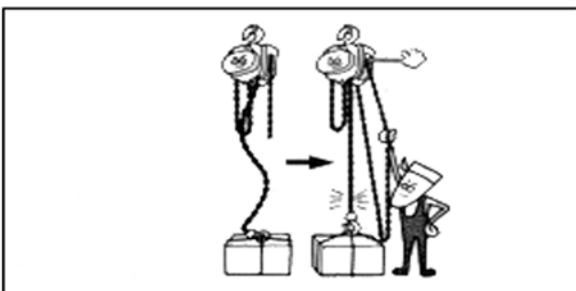

7. CHECK BRAKE OPERATING STATE MAKING LOAD CHAIN IN THE TIGHT WAY GO UPWARD AND DOWNWARD AROUND 10cm.

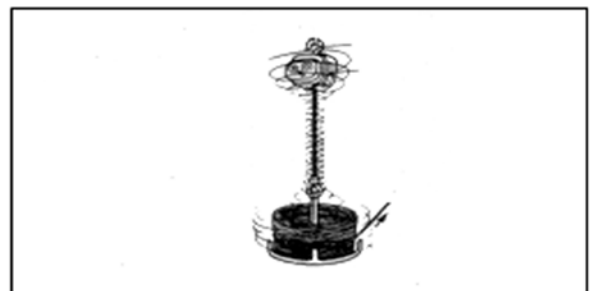

8. DO NOT MAKE A LOADING REVOLVED IN THE CONDITION OF HANGING.

**KUKDONG CO., LTD.**

[www.kdhoist.com](http://www.kdhoist.com) [kukdong@kotis.net](mailto:kukdong@kotis.net)

607B-14L  
630-2, SungKok-Dong,  
Ansan-City,  
KyungGi-Do,  
Korea  
Tel. 82-2-783-4203  
Fax. 82-2-784-6340