

Hinge systems



- ▶ CLIP top BLUMOTION | CLIP top – hinges
- ▶▶ Aluminium frame application

Hinge systems

95° aluminium frame door hinge

Webcode

DQDMBY

CLIP top for 973A



- Hinge for **narrow alu frame doors**
- **CLIP top** for 973A with closing mechanism (spring)
- **CLIP top** with or without closing mechanism (spring)
- 95° opening angle
- 3-dimensional front adjustment
- Convenient spiral-tech depth adjustment
- Tool-free door to cabinet assembly and removal
- Boss fixing screws are included

CLIP top



Order information

Overlay application

Boss		Screw-on		
Hinge	Spring	Colour	Part no.	
CLIP top for 973A	●	NI	71T950AB	
CLIP top	●	NI ONS	71T950A	
CLIP top	○	NI	70T950A.TL	
● With spring		NI	Nickel plated	
○ Unsprung		ONS	Onyx black	

Dual application

Boss		Screw-on		
Hinge	Spring	Colour	Part no.	
CLIP top for 973A	●	NI	71T960AB	
CLIP top	●	NI	71T960A	
● With spring		NI	Nickel plated	

Inset application

Boss		Screw-on		
Hinge	Spring	Colour	Part no.	
CLIP top	●	NI	71T970A	
● With spring		NI	Nickel plated	

Accessories

	<input type="checkbox"/>	BLUMOTION 973A		
Version		Part no.		
Clip on		973A0500.01		
	<input type="checkbox"/>	Hinge arm cover cap		
Print Stamp	Logo	Colour	Part no.	
Plain	–	NI ONS	70.1553	
Stamped	Blum	NI	70.1553.BP	

Accessories

	<input type="checkbox"/>	BLUMOTION 973A		
Version		Part no.		
Clip on		973A0600		
	<input type="checkbox"/>	Hinge arm cover cap		
Print Stamp	Logo	Colour	Part no.	
Plain	–	NI ONS	70.1663	
Stamped	Blum	NI	70.1663.BP	

Accessories

	<input type="checkbox"/>	Hinge arm cover cap		
Print Stamp	Logo	Colour	Part no.	
Plain	–	NI ONS	70.1663	
Stamped	Blum	NI	70.1663.BP	

Accessories – general

	<input type="checkbox"/>	TIP-ON for doors		
Version		Spring	Part no.	
Short version		○	956.1004	
Extended version		○	956A1004	
Extended version		●	956A1006	
● With spring		○	Unsprung	

95° aluminium frame door hinge

Webcode
DQDMBY

Planning

Hinge dimensions and gap calculation based on factory setting (mounting plate spacing = 0 mm)

Hinge and front protrusion at full opening angle

Overlay application

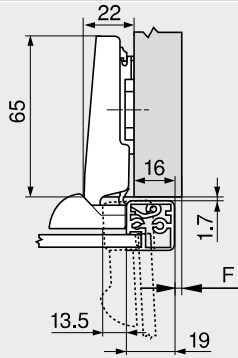
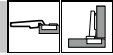

F Gap

Dual application

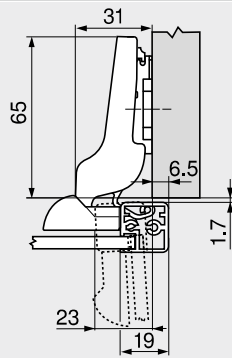
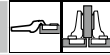

Inset application

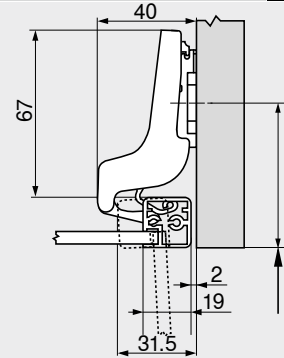
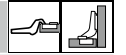

Set mounting plate back by frame width +1.7 mm

Minimum gap F for aluminium frame fronts (R = 1 mm) based on the factory setting

Side frame width RB (mm)	Frame thickness RS (mm)											
	18	19	20	21	22	24	25	26	27	28	30	32
19	0.2	0.3	0.4	0.6	0.7	1.2	Δ	Δ	Δ	Δ	Δ	Δ
20	0.2	0.3	0.4	0.5	0.7	1.1	Δ	Δ	Δ	Δ	Δ	Δ
21	0.2	0.3	0.4	0.5	0.7	1.0	Δ	Δ	Δ	Δ	Δ	Δ
22	0.2	0.3	0.4	0.5	0.7	1.1	Δ	Δ	Δ	Δ	Δ	Δ
Additional for +2 mm side adjustment												
	+0.1	+0.2	+0.3	+0.3	+0.3	+0.4						

Δ In these cases a trial is recommended

Adjustment

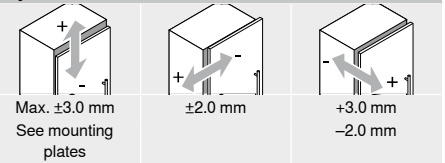

Screw-on

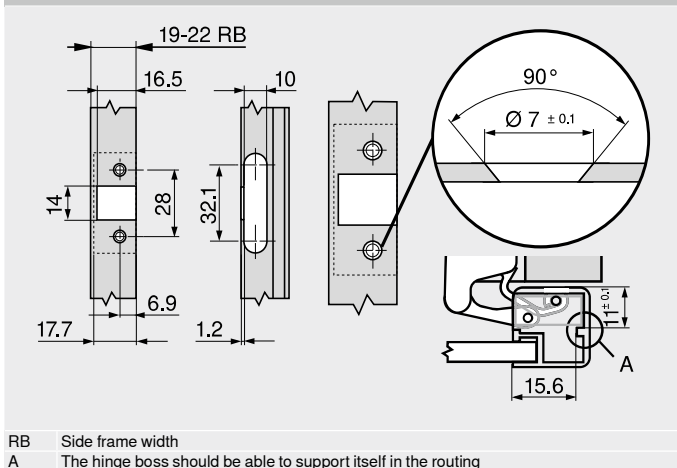

RB Side frame width

A The hinge boss should be able to support itself in the routing

Page instructions

Overview – CLIP top BLUMOTION CLIP top – hinges	75
Mounting plates	156
Accessories – hinge arm cover cap	164
Accessories – general	166
Overview – BLUMOTION for doors	171

Overview – TIP-ON for doors	185
Overview – assembly devices	561
More technical details	662

Assembly, removal and adjustment

Short-URL
www.blum.com/a210

