

# UM series

## High Speed Cutter (HSC)

- For roughing and finishing of steel up to 55 HRC, stainless steel and cast iron with high metal removal rate.
- Optimised geometry with unequal helix angle (38°/41°) and unequal pitch.
- End mills and torus mills
- Diameter range 4.0–20.0 mm



**A**

**End mill** HSC/HPC machining

**UM-4E**

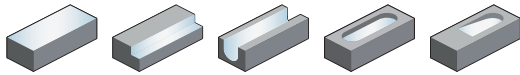

- Factory standard
- Centre cutting
- Helix angle 38°/41°

Turning

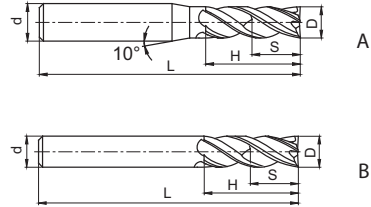

**B**

Milling

Article	*	Dimensions [mm]					Teeth	Geometry	Grade
		D	d (h6)	H	L	S			KMG405
UM-4E-D4.0S		4	4	11	50	6	4	B	●
UM-4E-D4.0		4	6	11	50	6	4	A	●
UM-4E-D4.5		4.5	6	11	50	6.75	4	A	●
UM-4E-D5.0		5	6	13	50	7.5	4	A	●
UM-4E-D5.5		5.5	6	16	50	8.25	4	A	●
UM-4E-D6.0		6	6	16	50	9	4	B	●
UM-4E-D7.0		7	8	20	60	10.5	4	A	●
UM-4E-D8.0		8	8	20	60	12	4	B	●
UM-4E-D9.0		9	10	22	75	13.5	4	A	●
UM-4E-D10.0		10	10	25	75	15	4	B	●
UM-4E-D11.0		11	12	26	75	16.5	4	A	●
UM-4E-D12.0		12	12	30	75	18	4	B	●
UM-4E-D14.0		14	14	32	75	21	4	B	●
UM-4E-D16.0		16	16	45	100	24	4	B	●
UM-4E-D18.0		18	18	45	100	27	4	B	●
UM-4E-D20.0		20	20	45	100	30	4	B	●

● Ex stock ○ On demand

\* With internal cooling

**C**

Drilling

**D**

Technical Information

**Application field**

P	M	K	N	S	H
✓	✓	✓			✓

- ✓ Very suitable
- ✓ Suitable

**E**

Index

System code > B268

Cutting data > B436

Nonstandard order > B477

End mill **HSC/HPC machining**

**UM-4E-W**

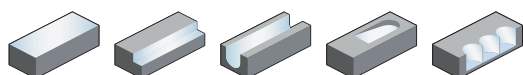

- Factory standard with weldon clamping surface
- Centre cutting
- Helix angle 38°/41°

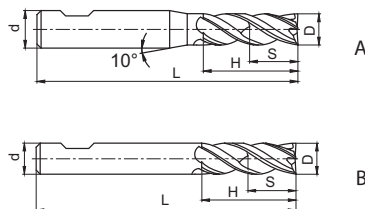

Article	*	Dimensions [mm]					Teeth	Geometry	Grade KMG405
		D	d (h6)	H	L	S			
UM-4E-D4.0-W		4	6	11	50	6	4	A	●
UM-4E-D4.5-W		4.5	6	11	50	6.75	4	A	●
UM-4E-D5.0-W		5	6	13	50	7.5	4	A	●
UM-4E-D5.5-W		5.5	6	16	50	8.25	4	A	●
UM-4E-D6.0-W		6	6	16	50	9	4	B	●
UM-4E-D7.0-W		7	8	20	60	10.5	4	A	●
UM-4E-D8.0-W		8	8	20	60	12	4	B	●
UM-4E-D9.0-W		9	10	22	75	13.5	4	A	●
UM-4E-D10.0-W		10	10	25	75	15	4	B	●
UM-4E-D11.0-W		11	12	26	75	16.5	4	A	●
UM-4E-D12.0-W		12	12	30	75	18	4	B	●
UM-4E-D14.0-W		14	14	32	75	21	4	B	●
UM-4E-D16.0-W		16	16	45	100	24	4	B	●
UM-4E-D18.0-W		18	18	45	100	27	4	B	●
UM-4E-D20.0-W		20	20	45	100	30	4	B	●

● Ex stock ○ On demand

\* With internal cooling

Application field					
P	M	K	N	S	H
✓	✓	✓			✓

- ✓ Very suitable
- ✓ Suitable

System code > B268

Cutting data > B436

Nonstandard order > B477



**A**

## End mill long cutting edge HSC/HPC machining

### UM-4EL

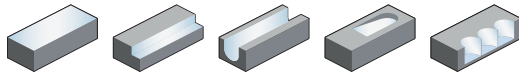

- Factory standard
- Centre cutting
- Helix angle 38°/41°

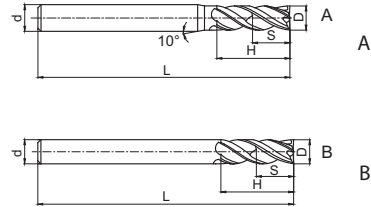

Turning

**B**

Milling

**C**

Drilling

Article	*	Dimensions [mm]					Teeth	Geometry	Grade
		D	d (h6)	H	L	S			KMG405
UM-4EL-D4.0		4	6	15	75	6	4	A	●
UM-4EL-D5.0		5	6	20	75	7.5	4	A	●
UM-4EL-D6.0		6	6	20	75	9	4	B	●
UM-4EL-D8.0		8	8	25	100	12	4	B	●
UM-4EL-D10.0		10	10	30	100	15	4	B	●
UM-4EL-D12.0		12	12	35	100	18	4	B	●
UM-4EL-D14.0		14	14	40	100	21	4	B	●
UM-4EL-D16.0		16	16	50	150	24	4	B	●
UM-4EL-D20.0		20	20	55	150	30	4	B	●

● Ex stock ○ On demand

\* With internal cooling

**D**

Technical Information

**E**

Index

### Application field

P	M	K	N	S	H
✓	✓	✓			✓

✓ Very suitable

✓ Suitable

System code > B268

Cutting data > B436

Nonstandard order > B477

**End mill long cutting edge** **HSC/HPC machining**

**UM-4EL-W**

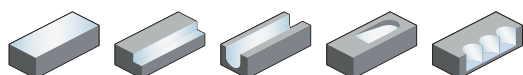

- Factory standard with weldon clamping surface
- Centre cutting
- Helix angle 38°/41°

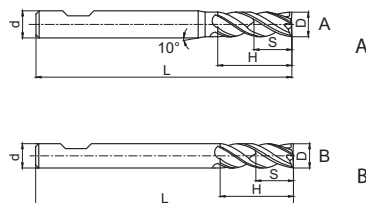

Article	*	Dimensions [mm]					Teeth	Geometry	Grade
		D	d (h6)	H	L	S			KMG405
UM-4EL-D4.0-W		4	6	15	75	6	4	A	●
UM-4EL-D5.0-W		5	6	20	75	7.5	4	A	●
UM-4EL-D6.0-W		6	6	20	75	9	4	B	●
UM-4EL-D8.0-W		8	8	25	100	12	4	B	●
UM-4EL-D10.0-W		10	10	30	100	15	4	B	●
UM-4EL-D12.0-W		12	12	35	100	18	4	B	●
UM-4EL-D14.0-W		14	14	40	100	21	4	B	●
UM-4EL-D16.0-W		16	16	50	150	24	4	B	●
UM-4EL-D20.0-W		20	20	55	150	30	4	B	●

● Ex stock ○ On demand

\* With internal cooling

Application field					
P	M	K	N	S	H
✓	✓	✓			✓

- ✓ Very suitable
- ✓ Suitable

**A**

Turning

**B**

Milling

**C**

Drilling

**D**

Technical Information

**E**

Index

System code > B268

Cutting data > B436

Nonstandard order > B477



**A**

## End mill reduced neck HSC/HPC machining

### UM-4ELP-W

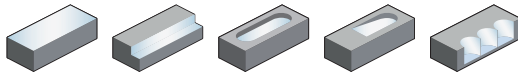

- Factory standard with weldon clamping surface
- Centre cutting
- Helix angle 38°/41°

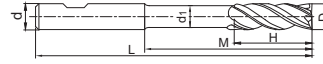

Turning

**B**

Article	*	Dimensions [mm]						Teeth	Grade
		D	d (h6)	d <sub>1</sub>	H	M	L		KMG405
UM-4ELP-D4.0-W		4	6	3.8	15	36	75	4	●
UM-4ELP-D5.0-W		5	6	4.8	20	36	75	4	●
UM-4ELP-D6.0-W		6	6	5.7	20	36	75	4	●
UM-4ELP-D8.0-W		8	8	7.7	25	60	100	4	●
UM-4ELP-D10.0-W		10	10	9.5	30	55	100	4	●
UM-4ELP-D12.0-W		12	12	11.5	35	50	100	4	●
UM-4ELP-D14.0-W		14	14	13.5	40	50	100	4	●
UM-4ELP-D16.0-W		16	16	15.5	50	100	150	4	●
UM-4ELP-D20.0-W		20	20	19.5	55	98	150	4	●

Milling

● Ex stock   ○ On demand

\* With internal cooling

**C**

#### Application field

P	M	K	N	S	H
✓	✓	✓			✓

- ✓ Very suitable
- ✓ Suitable

Drilling

**D**

Technical Information

**E**

Index

System code > B268

Cutting data > B436

Nonstandard order > B477

End mill short cutting edge **HSC/HPC machining**

**UM-4EFP**

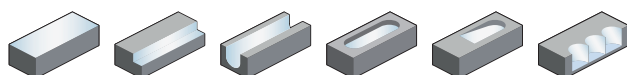

- Factory standard
- Centre cutting
- Helix angle 38°/41°



Article	*	Dimensions [mm]						Teeth	Grade
		D	d (h6)	d <sub>1</sub>	H	M	L		KMG405
UM-4EFP-D6.0		6	6	5.8	9	30	75	4	●
UM-4EFP-D8.0		8	8	7.8	12	40	100	4	●
UM-4EFP-D10.0		10	10	9.6	15	50	100	4	●
UM-4EFP-D12.0		12	12	11.5	18	50	100	4	●
UM-4EFP-D16.0		16	16	15.5	24	50	150	4	●
UM-4EFP-D20.0		20	20	19.5	30	60	150	4	●

● Ex stock ○ On demand

\* With internal cooling

Application field					
P	M	K	N	S	H
✓	✓	✓			✓

✓ Very suitable

✓ Suitable

A

Turning

B

Milling

C

Drilling

D

Technical Information

E

Index

System code > B268

Cutting data > B436

Nonstandard order > B477



**A**

**Torus mill HSC/HPC machining**

**UM-4R**

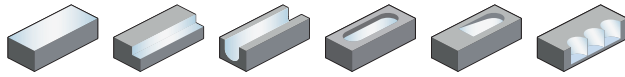

- Factory standard
- Centre cutting
- Helix angle 38°/41°

Turning

**B**

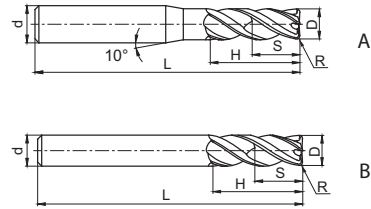

Milling

Article	*	Dimensions [mm]						Teeth	Geometry	Grade
		R	D	d (h6)	H	L	S			
UM-4R-D4.0R0.3		0.3	4	6	10	50	6	4	A	●
UM-4R-D4.0R0.5		0.5	4	6	10	50	6	4	A	●
UM-4R-D5.0R0.5		0.5	5	6	13	50	7.5	4	A	●
UM-4R-D5.0R1.0		1	5	6	13	50	7.5	4	A	●
UM-4R-D6.0R0.5		0.5	6	6	16	50	9	4	B	●
UM-4R-D6.0R1.0		1	6	6	16	50	9	4	B	●
UM-4R-D8.0R0.5		0.5	8	8	20	60	12	4	B	●
UM-4R-D8.0R1.0		1	8	8	20	60	12	4	B	●
UM-4R-D10.0R0.5		0.5	10	10	25	75	15	4	B	●
UM-4R-D10.0R1.0		1	10	10	25	75	15	4	B	●
UM-4R-D10.0R2.0		2	10	10	25	75	15	4	B	●
UM-4R-D10.0R3.0		3	10	10	25	75	15	4	B	●
UM-4R-D12.0R0.5		0.5	12	12	30	75	18	4	B	●
UM-4R-D12.0R1.0		1	12	12	30	75	18	4	B	●
UM-4R-D12.0R2.0		2	12	12	30	75	18	4	B	●
UM-4R-D12.0R3.0		3	12	12	30	75	18	4	B	●
UM-4R-D16.0R1.0		1	16	16	45	100	24	4	B	●
UM-4R-D16.0R2.0		2	16	16	45	100	24	4	B	●
UM-4R-D16.0R3.0		3	16	16	45	100	24	4	B	●
UM-4R-D20.0R1.0		1	20	20	45	100	30	4	B	●
UM-4R-D20.0R2.0		2	20	20	45	100	30	4	B	●
UM-4R-D20.0R3.0		3	20	20	45	100	30	4	B	●

- Ex stock ○ On demand
- \* With internal cooling

**C**

Drilling

**D**

Technical Information

**E**

Index

Application field					
P	M	K	N	S	H
✓	✓	✓			✓

✓ Very suitable  
 ✓ Suitable

System code > B268      Cutting data > B436      Nonstandard order > B477





**Torus mill long shank** **HSC/HPC machining**

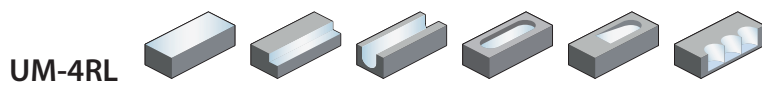

- Factory standard
- Centre cutting
- Helix angle 38°/41°

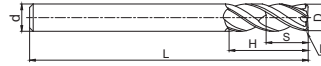

Article	*	Dimensions [mm]						Teeth	Grade
		R	D	d (h6)	H	L	S		KMG405
UM-4RL-D6.0R0.5		0.5	6	6	16	75	9	4	●
UM-4RL-D6.0R1.0		1	6	6	16	75	9	4	●
UM-4RL-D8.0R0.5		0.5	8	8	20	100	12	4	●
UM-4RL-D8.0R1.0		1	8	8	20	100	12	4	●
UM-4RL-D10.0R0.5		0.5	10	10	25	100	15	4	●
UM-4RL-D10.0R1.0		1	10	10	25	100	15	4	●
UM-4RL-D10.0R2.0		2	10	10	25	100	15	4	●
UM-4RL-D12.0R0.5		0.5	12	12	30	100	18	4	●
UM-4RL-D12.0R1.0		1	12	12	30	100	18	4	●
UM-4RL-D12.0R2.0		2	12	12	30	100	18	4	●
UM-4RL-D16.0R1.0		1	16	16	45	150	24	4	●
UM-4RL-D16.0R2.0		2	16	16	45	150	24	4	●

● Ex stock ○ On demand

\* With internal cooling

Application field					
P	M	K	N	S	H
✓	✓	✓			✓

✓ Very suitable

✓ Suitable

System code > B268

Cutting data > B436

Nonstandard order > B477



**A**

## Torus mill short cutting edge HSC/HPC machining

### UM-4RFP

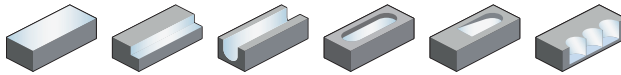

- Factory standard
- Centre cutting
- Helix angle 38°/41°

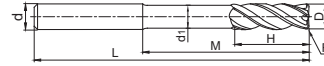

Turning

**B**

Article	*	Dimensions [mm]							Teeth	Grade
		R	D	d (h6)	d <sub>1</sub>	H	M	L		
UM-4RFP-D6.0R0.5	*	0.5	6	6	5.8	6	18	75	4	●
UM-4RFP-D6.0R1.0		1	6	6	5.8	6	18	75	4	●
UM-4RFP-D8.0R0.5		0.5	8	8	7.7	8	24	100	4	●
UM-4RFP-D8.0R1.0		1	8	8	7.7	8	24	100	4	●
UM-4RFP-D10.0R0.5		0.5	10	10	9.6	10	30	100	4	●
UM-4RFP-D10.0R1.0		1	10	10	9.6	10	30	100	4	●
UM-4RFP-D10.0R2.0		2	10	10	9.6	10	30	100	4	●
UM-4RFP-D12.0R0.5		0.5	12	12	11.5	12	36	100	4	●
UM-4RFP-D12.0R1.0		1	12	12	11.5	12	36	100	4	●
UM-4RFP-D12.0R2.0		2	12	12	11.5	12	36	100	4	●
UM-4RFP-D16.0R1.0		1	16	16	15.5	16	40	150	4	●
UM-4RFP-D16.0R2.0		2	16	16	15.5	16	40	150	4	●

- Ex stock   ○ On demand
- \* With internal cooling

Milling

**C**

### Application field

P	M	K	N	S	H
✓	✓	✓			✓

- ✓ Very suitable
- ✓ Suitable

Drilling

**D**

Technical Information

**E**

Index

System code > B268

Cutting data > B436

Nonstandard order > B477