

CLASS 150

Y-PATTERN STRAINER

Y-Pattern body, Screwed cap, 304 stainless steel screen
Threaded ends to BS21 (JIS B0203) or NPT,
or solder joint ends.

W.O.G. non-shock 2.07 MPa (300 psi), Saturated steam pressure 1.03 MPa (150 psi) up to size 2*

*Contact KITZ for larger sizes



Fig. Y

- Threaded end to BS21 (JIS B0203)

Fig. AKY

- Threaded end to ASME B1.20.1



Fig. CY

- Solder joint ends to JIS B2011 / ASME B16.18 (2½ & 3)

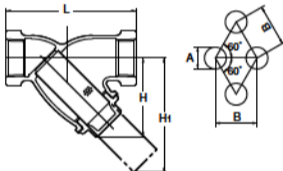

Materials

Parts	Material	
Body	Bronze	
Body cap	Brass	
Screen	Type304 Stainless Steel	
	A	B
¾ to 2	1.4	2.4
2½ to 3	1.5	2.5

⚠ Solder joint end valves should not be used in service where the temperature of line fluid is higher than the softening point of solder.

⚠ Don't use for Flammable gas or Toxic gas.

Dimensions

Nominal Size	mm									
	inch	¾	½	¾	1	1¼	1½	2	2½	3
L		70	80	100	115	135	160	195	230	240
L1 Solder			80	105	125	145	170	210	250	280
H		44	49	57	70	82	98	121	148	180
H1		61	68	83	105	124	149	188	216	267