

**Climate  
Control**

**IMI TA**

## TA-Lite 120



### **Actuators**

Motorized push actuator modulating control - 120 N

## TA-Lite 120

Motorized actuator available for modulating control compatible with TA-Nano/TA-Nano Plus valves. It will be mainly used for small hydronic applications such as fan coil, chilled beams and zone valves.



### Technical description

#### Functions:

0-10 VDC version:  
Proportional control  
LED position indicator

0-10 VDC I/O version:  
Proportional control  
LED position indicator  
Output signal

0-10 VDC I/O Fail-safe version:  
Proportional control  
LED position indicator  
Fail-safe function (actuator's stem extended on power failure, valve close fully)  
Output signal

**Supply voltage:**  
24 VAC/VDC  $\pm 15\%$

**Power consumption:**  
Operation: 2 W  
Standby: 0.5 W  
Charging: 2 W

**Input signal:**  
0-10 VDC, I/O, I/O Fail-safe: 0-10 VDC

**Output signal:**  
I/O, I/O Fail-safe: 0-10 VDC

**Characteristics:**  
Linear or EQM 0.25

**Control speed:**  
10 s/mm

**Adjusting force:**  
120 N

**Temperature:**  
Media temperature: max. 120°C  
Operating environment: 0°C – +50°C  
(5-95%RH, non-condensing)  
Storage environment: -20°C – +70°C  
(5-95%RH, non-condensing)

**Ingress protection:**  
IP54/40 depending on position  
(according to EN 60529)

**Protection class:**  
Class II (according to EN 61140)

**Cable:**  
2 or 5 m. 0.5 m on request.  
0-10 VDC: 3x0,5 mm<sup>2</sup>  
0-10 VDC I/O, I/O Fail-safe: 4x0,5 mm<sup>2</sup>  
Halogen free as option, fire class  
B2<sub>ca</sub> – s1a, d1, a1 according to EN 50575.

**Stroke:**  
6 mm

**Noise level:**  
Max. 30 dBA

**Weight:**  
0.17 kg, 0,5 m cable (on request)  
0.22 kg, 2 m cable  
0.30 kg, 5 m cable

**Connection to valve:**  
Swivelling nut M30x1,5.

**Material:**  
Cover: PC + ABS  
Housing: PC + 20GF  
Swivelling nut: Nickel-plated brass  
CW614N.  
Cable: PVC or Halogen free

**Colour:**  
Purple RAL 310 2023, grey RAL 7047.

**Marking:**  
IMI, CE, product name, article No. and technical specification.

**Certification CE:**  
LV-D. 2014/35/EU: EN 60730-1.  
EMC-D. 2014/30/EU: EN 60730-1.  
RoHS-D. 2011/65/EU: IEC 62321.

**Product standard:**  
EN 60730

## Installation

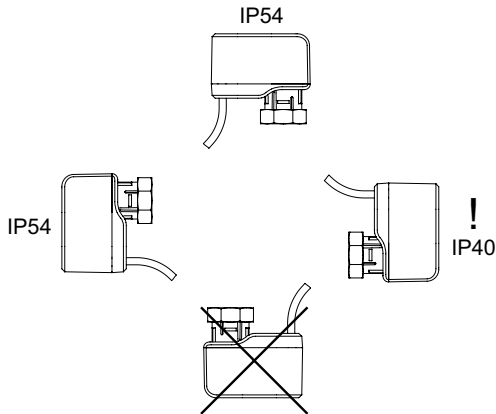

### Note!

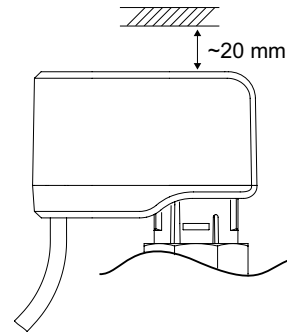

## Connection diagram

### 24 VAC/VDC

#### 0-10 VDC

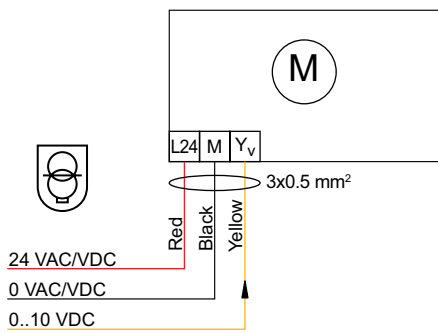

#### 0-10 VDC I/O / I/O Fail-safe

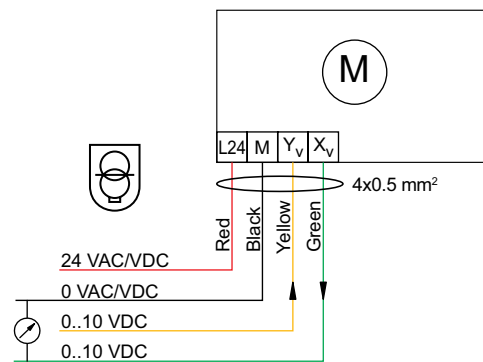

| Terminal       | Description   |
|----------------|---|
| L24            | Power supply 24 VAC/VDC   |
| M              | Neutral for power supply 24 VAC/VDC and signals                               |
| Y <sub>v</sub> | Input signal for proportional control 0-10 VDC, 47 kΩ                         |
| X <sub>v</sub> | Output signal 0-10 VDC, max. output current ≥10 mA, min. load resistance 1 kΩ |



24 VAC/VDC operating only with safety transformer according to EN 61558-2-6.

## Articles – TA-Lite 120, 0-10 VDC

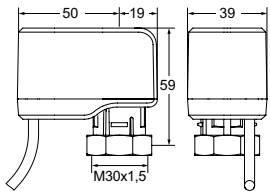

### 24 VAC/VDC

Input signal: 0-10 VDC

| Cable length [m]               | Characteristics | EAN           | Article No   |
|--------------------------------|-----------------|---------------|--------------|
| <b>PVC</b>                     |                 |               |              |
| 0,5                            | LIN             |               | on request   |
| 2                              | LIN             | 5902276826771 | 322233-11012 |
| 5                              | LIN             | 5902276826788 | 322233-11013 |
| 0,5                            | EQM             |               | on request   |
| 2                              | EQM             | 5902276826832 | 322233-13012 |
| 5                              | EQM             | 5902276826849 | 322233-13013 |
| <b>With halogen free cable</b> |                 |               |              |
| 0,5                            | LIN             |               | on request   |
| 2                              | LIN             |               | on request   |
| 5                              | LIN             |               | on request   |
| 0,5                            | EQM             |               | on request   |
| 2                              | EQM             |               | on request   |
| 5                              | EQM             |               | on request   |

## Articles – TA-Lite 120 I/O, 0-10 VDC

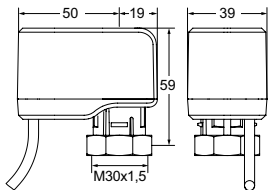

### 24 VAC/VDC

Input signal: 0-10 VDC with output signal

| Cable length [m]               | Characteristics | EAN           | Article No   |
|--------------------------------|-----------------|---------------|--------------|
| <b>PVC</b>                     |                 |               |              |
| 0,5                            | LIN             |               | on request   |
| 2                              | LIN             | 5902276826801 | 322233-12012 |
| 5                              | LIN             | 5902276826818 | 322233-12013 |
| 0,5                            | EQM             |               | on request   |
| 2                              | EQM             | 5902276826863 | 322233-14012 |
| 5                              | EQM             | 5902276826870 | 322233-14013 |
| <b>With halogen free cable</b> |                 |               |              |
| 0,5                            | LIN             |               | on request   |
| 2                              | LIN             |               | on request   |
| 5                              | LIN             |               | on request   |
| 0,5                            | EQM             |               | on request   |
| 2                              | EQM             |               | on request   |
| 5                              | EQM             |               | on request   |

## Articles – TA-Lite 120 I/O Fail-safe, 0-10 VDC

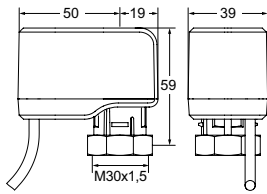

### 24 VAC/VDC

Actuator's stem extended on power failure, valve close fully.  
Input signal: 0-10 VDC with output signal

| Cable length [m]               | Characteristics | EAN           | Article No   |
|--------------------------------|-----------------|---------------|--------------|
| <b>PVC</b>                     |                 |               |              |
| 0,5                            | LIN             |               | on request   |
| 2                              | LIN             | 5902276827150 | 322233-12112 |
| 5                              | LIN             | 5902276827167 | 322233-12113 |
| 0,5                            | EQM             |               | on request   |
| 2                              | EQM             | 5902276827181 | 322233-14112 |
| 5                              | EQM             | 5902276827198 | 322233-14113 |
| <b>With halogen free cable</b> |                 |               |              |
| 0,5                            | LIN             |               | on request   |
| 2                              | LIN             |               | on request   |
| 5                              | LIN             |               | on request   |



The products, texts, photographs, graphics and diagrams in this document may be subject to alteration by IMI without prior notice or reasons being given. For the most up to date information about our products and specifications, please visit [climatecontrol.imiplc.com](http://climatecontrol.imiplc.com).