

1、UPVC/CPVC 国标管件 (DIN) UPVC/CPVC FITTINGS

执行标准: GB/T 4219.2-2015 GB/T18998.3-2022

Conform to: GB/T 4219.2-2015 GB/T18998.3-2022

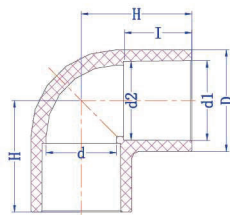

90° 弯头 90° ELBOW (S×S) DIN

Nominal SIZE	Socket Type			Structural Diameter		
	d1	d2	I	D	d	H
20	20.3	20.1	16.0	27.0	17.0	28.5
25	25.3	25.1	19.0	33.0	23.0	34.0
32	32.3	32.1	22.0	40.5	29.0	40.5
40	40.3	40.1	26.0	49.1	37.0	48.5
50	50.3	50.1	32.0	61.0	47.0	57.0
63	63.3	63.1	38.0	75.0	60.0	71.0
75	75.3	75.1	44.0	89.4	72.0	83.0
90	90.3	90.1	51.0	107.3	87.1	98.0
110	110.4	110.1	62.0	131.0	106.1	118.0
140	140.5	140.2	77.0	166.7	133.0	147.0
160	160.5	160.2	88.0	186.0	154.0	166.0
200	200.8	199.9	106.5	230.6	194.0	209.0
225	225.8	225.0	117.5	261.0	218.0	240.0
250	251.0	249.9	131.6	288.0	242.0	260.0
280	281.0	280.0	145.0	323.0	271.0	285.0
315	316.0	315.0	162.5	363.0	306.0	320.5
355	356.8	355.0	184.3	391.0	326.0	368.3
400	402.0	400.0	204.2	442.0	369.8	413.0

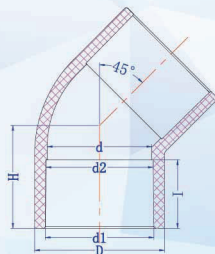

45° 弯头 45° ELBOW (S×S) DIN

Nominal SIZE	Socket Type			Structural Diameter		
	d1	d2	I	D	d	H
20	20.3	20.1	16.0	29.0	17.0	24.0
25	25.3	25.1	19.0	34.9	23.0	28.5
32	32.3	32.1	22.0	43.0	29.0	33.0
40	40.3	40.1	26.0	52.3	37.0	39.0
50	50.3	50.1	32.0	59.0	47.0	48.0
63	63.3	63.1	38.0	72.0	60.0	57.0
75	75.3	75.1	44.0	89.4	72.0	66.0
90	90.3	90.1	51.0	107.3	87.1	71.5
110	110.4	110.1	61.0	132.0	106.1	82.5
140	140.5	140.2	77.0	166.7	133.0	108.0
160	160.5	160.2	86.0	186.0	154.0	120.5
200	200.8	199.9	106.5	230.6	194.0	157.4
225	225.8	225.0	117.5	261.0	218.0	165.0
250	251.0	249.9	131.6	288.0	242.0	193.0
280	281.0	280.0	145.0	323.0	271.0	203.0
315	316.0	315.0	162.5	363.0	306.0	228.0
355	356.8	355.0	184.3	391.0	326.0	272.8
400	402.0	400.0	204.2	442.0	369.8	298.5