

OPTICAL MEASURING MACHINES

SYLVAC SCAN

Dedicated to fast, precise, non-contact measurement of cylindrical parts. Our new SCAN machines reproduce high resolution images of the components profile in just a few seconds. Thanks to the easy to use REFLEX-SCAN software, parts can be measured with just a click of a button, offering over 150 different types of measurement features.

SYLVAC VISIO

Our 2.5D video measuring systems equipped with manual XY stage and manual/motorized optical zoom allow to quickly measure most of the industrial components based on the live image of the workpiece displayed on the software.

Our SCAN and VISIO machines are designed for use in the workshop or laboratory. Discover them without further delay !

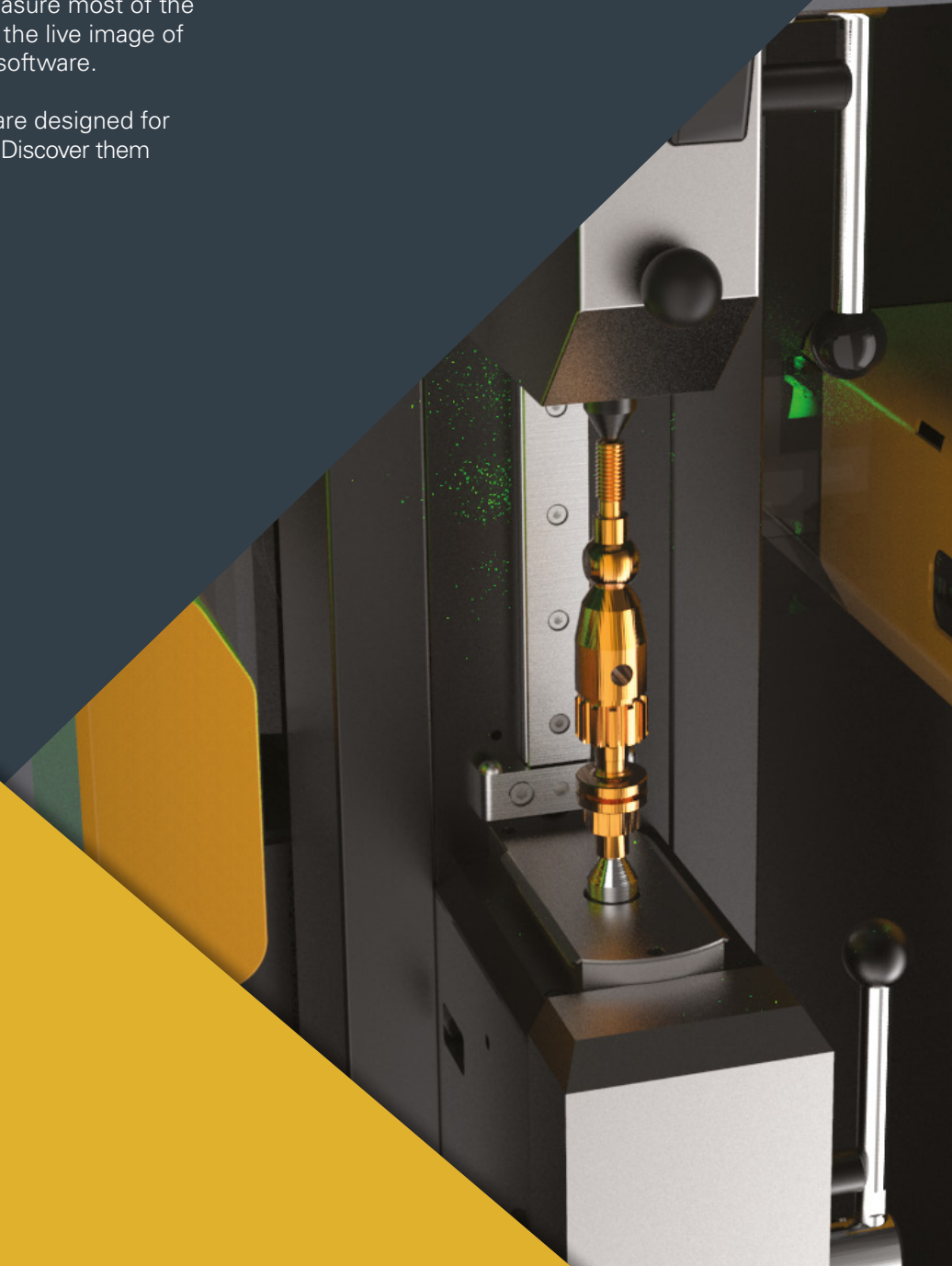

- Vertical optical measuring machine for static and dynamic measurement of various elements on small cylindrical parts.
- The parts can be mounted between two centres or held in place using various accessories. Attractive design and robust construction with many new features: New touch screen control panel for easy operation directly at the workplace, bi-telecentric optical system, high resolution CMOS camera, precision sliding headstock with integrated and protected daily standard, quick and easy accessory changing system, integrated temperature sensors, dynamic LED indicator of the general status of the measured part (GO/NG) and operator messages. Equipped with an exclusive optics tilting system.
- Machines specially designed to measure threads such as, parallel, trapezoidal, conical, round, square, conical, worms, ball screws, bone screws, dental implants, etc.
- Reflex SCAN+ concept for measuring parts without prior programming at the touch of a button
- Delivered complete with a PC and the Reflex SCAN+ software, which allows a multitude of elements to be measured easily and intuitively.
- The machine is delivered fully equipped «Automation Ready» as standard.

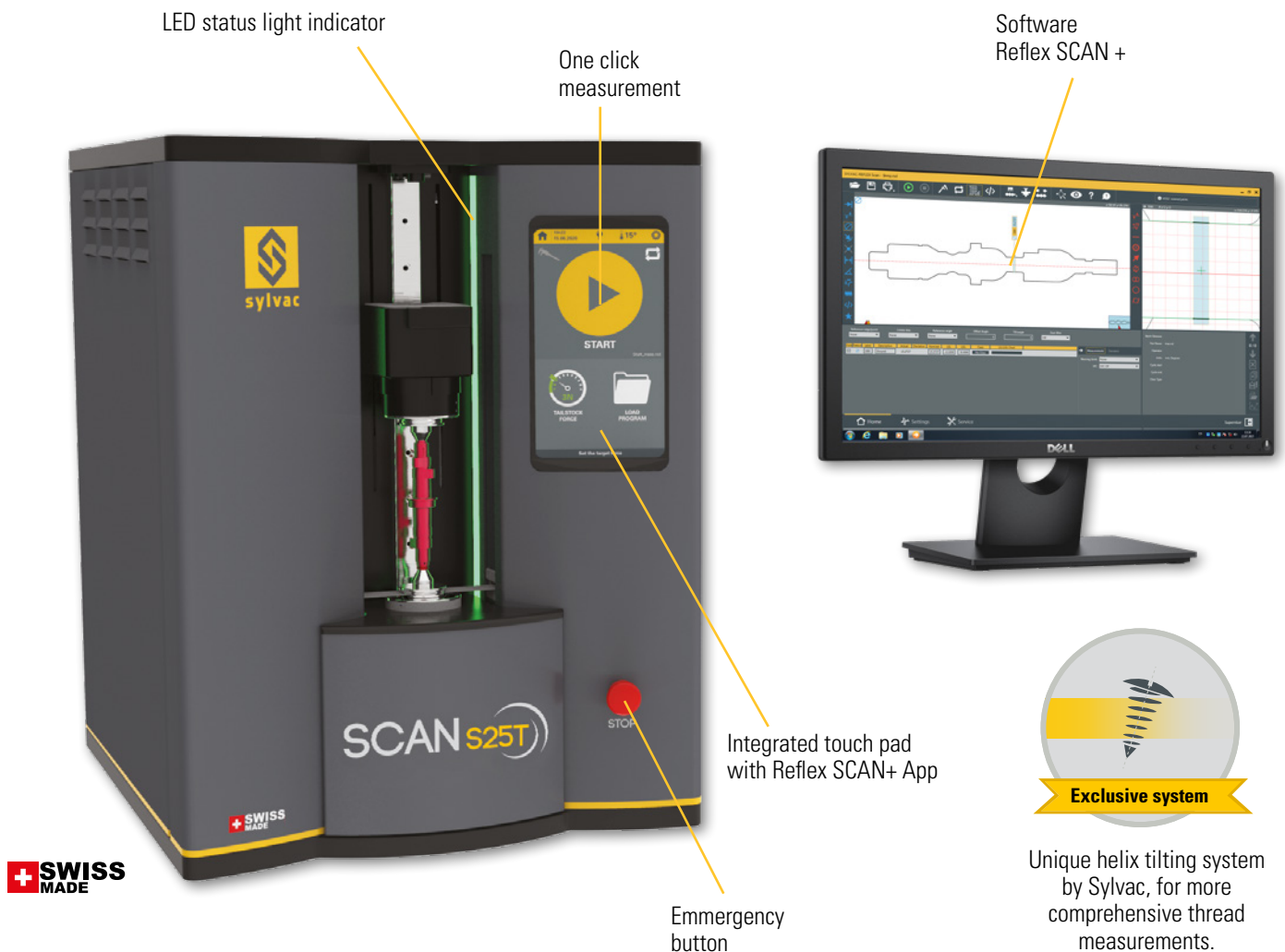

J

Optical measurement

SYLVAC-SCAN

DIMENSIONAL DRAWINGS

S25 & S25T

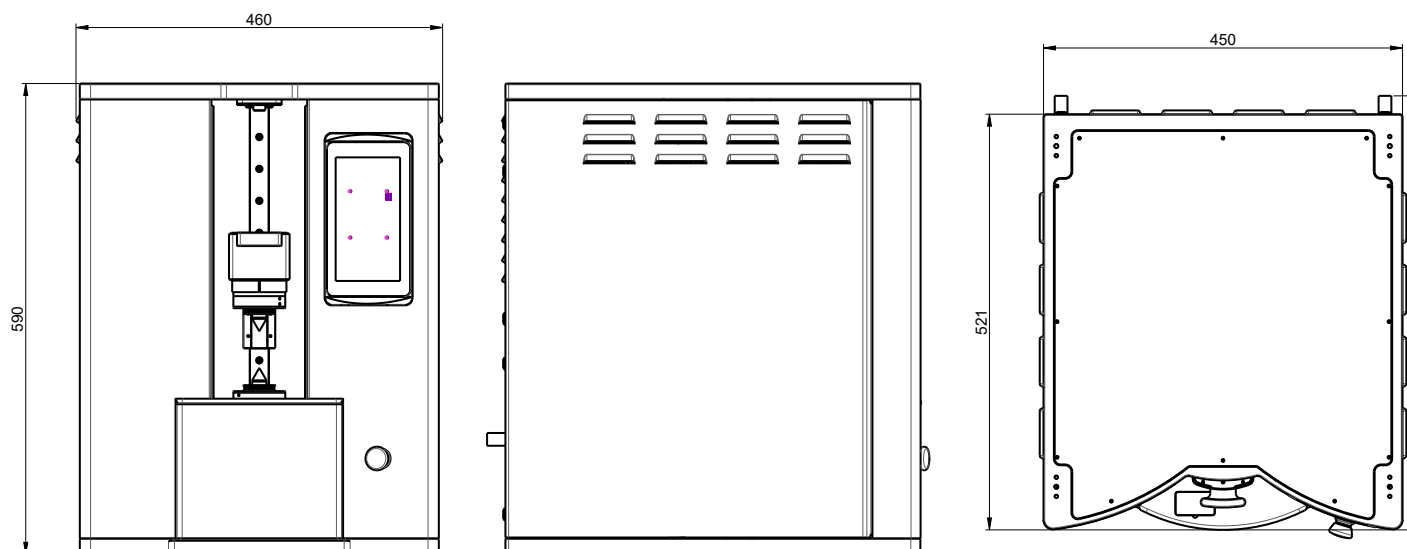

TECHNICAL SPECIFICATIONS

		902-4020		902-4025	
		Sylvac SCAN S25		Sylvac SCAN S25T	
		Diameter	Length	Diameter	Length
Measuring range	mm	26	200	26	200
Resolution up to	mm	0.0001	0.0001	0.0001	0.0001
Max. error	µm	0.9 +D[mm]/100) µm	(2.5 +D[mm]/200) µm	0.9 +D[mm]/100) µm	(2.5 +D[mm]/200) µm
Repeatability 2σ	µm	0.4	0.8	0.4	0.8
Holding capacity diameter	mm	51	200	51	200
Headstock		High precision rotary			
Tilting for thread measurement		-		• 30°	
Max. weight of part	kg	2			
Machine's weight	kg	60			

STANDARD DELIVERY

- Instrument according to technical specifications
- Computer with screen, keyboard and mouse
- Windows multilingual operating system
- Sylvac Reflex SCAN Software +
- Accessories : 2x 902-6259 ISO / MK2 adapter, 2x 902-6202, 902-6161 & 902-6212
- Manual

Optical measurement

SYLVAC-SCAN

DESCRIPTION

52 REFLEX-CLICK

- Horizontal SCAN machine, measuring in landscape format, the same as the parts are produced
- Robust construction with granite column for use in workshop or control laboratory
- Concept Reflex SCAN patented for measuring cylindrical workpieces without preprogramming
- Measurements performed in seconds by a single click
- Load the part, click the button and you get all the main values directly!
- Automatic recognition of recorded parts already measured
- Easy daily calibration thanks to the integrated master
- Quick return of investment

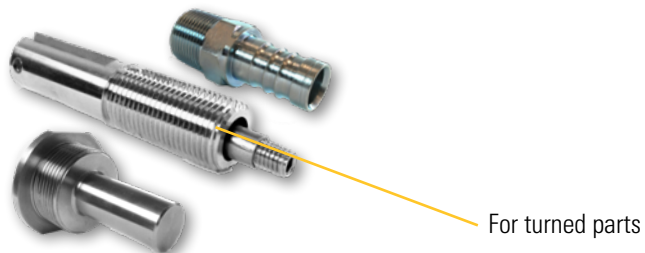

Optical measurement

SYLVAC-SCAN

DIMENSIONAL DRAWINGS

52 REFLEX-CLICK

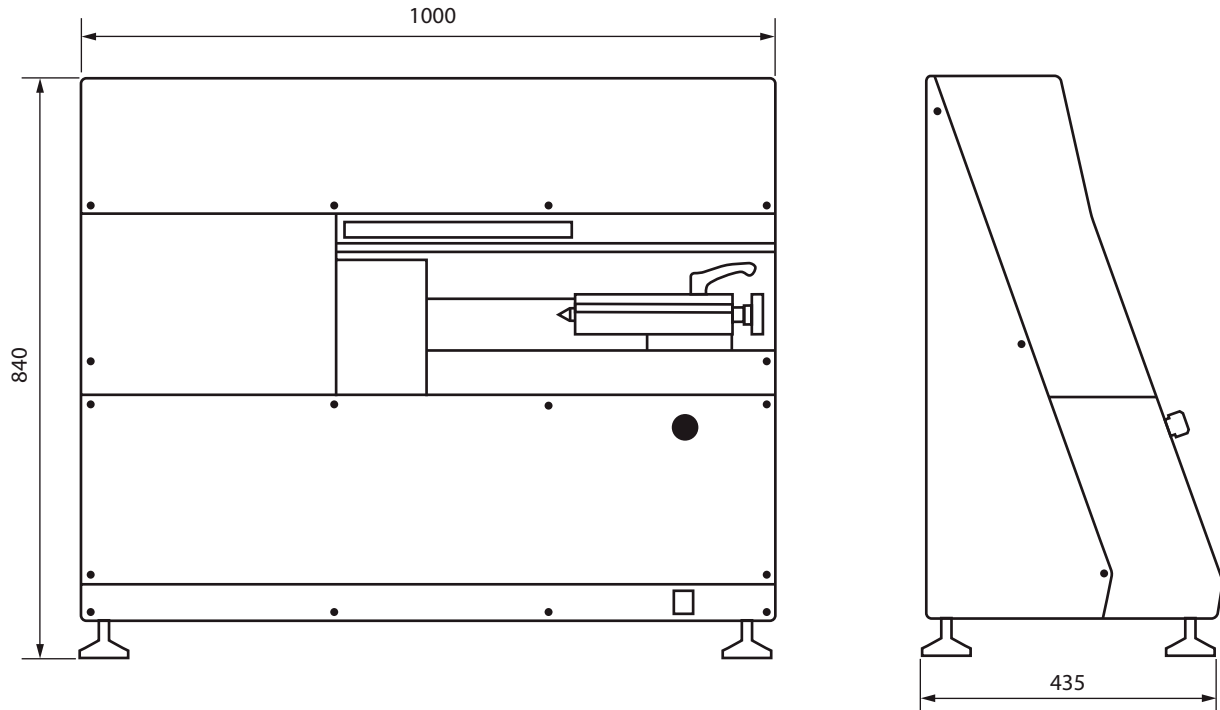

TECHNICAL SPECIFICATIONS

		902.5520		902.5521	
		Diameter	Length	Diameter	Length
Measuring range	mm	0.5 ÷ 52	300	0.5 ÷ 52	300
Resolution up to	mm	0.0001	0.0005	0.0001	0.0005
Max. error	µm	1.5 + D/100	4 + L/100	1.5 + D/100	4 + L/100
Repeatability	µm	0.6	2.5	0.6	2.5
Headstock		Non-Rotating headstock for static measurements		Rotary headstock for static and dynamic measurements	
Max. weight of part	kg	4			
Machine's weight	kg	103			

BASIC INSTRUMENT

- Instrument according to technical specifications
- Accessories : 2x 902.6202, 902.6161, 902.6212
- Computer with screen, keyboard and mouse
- Windows multilingual operating system
- Sylvac Reflex SCAN Software
- Manual

Optical measurement

SYLVAC-SCAN

DESCRIPTION

F60 & F60T

- Concept Reflex SCAN patented for measuring cylindrical workpieces without preprogramming
- Part measurement from **0.2 to 64mm diameter and up to 300mm** length
- Complete 2D part scan in <3 seconds !
- Reduce inspection time, scrap and increase productivity
- Exclusive helix tilting system for thread measurements (only on T models)
- Quick return of investment, typically < 6 months
- New software Reflex SCAN + : advanced programming and functions
- Quick release tooling

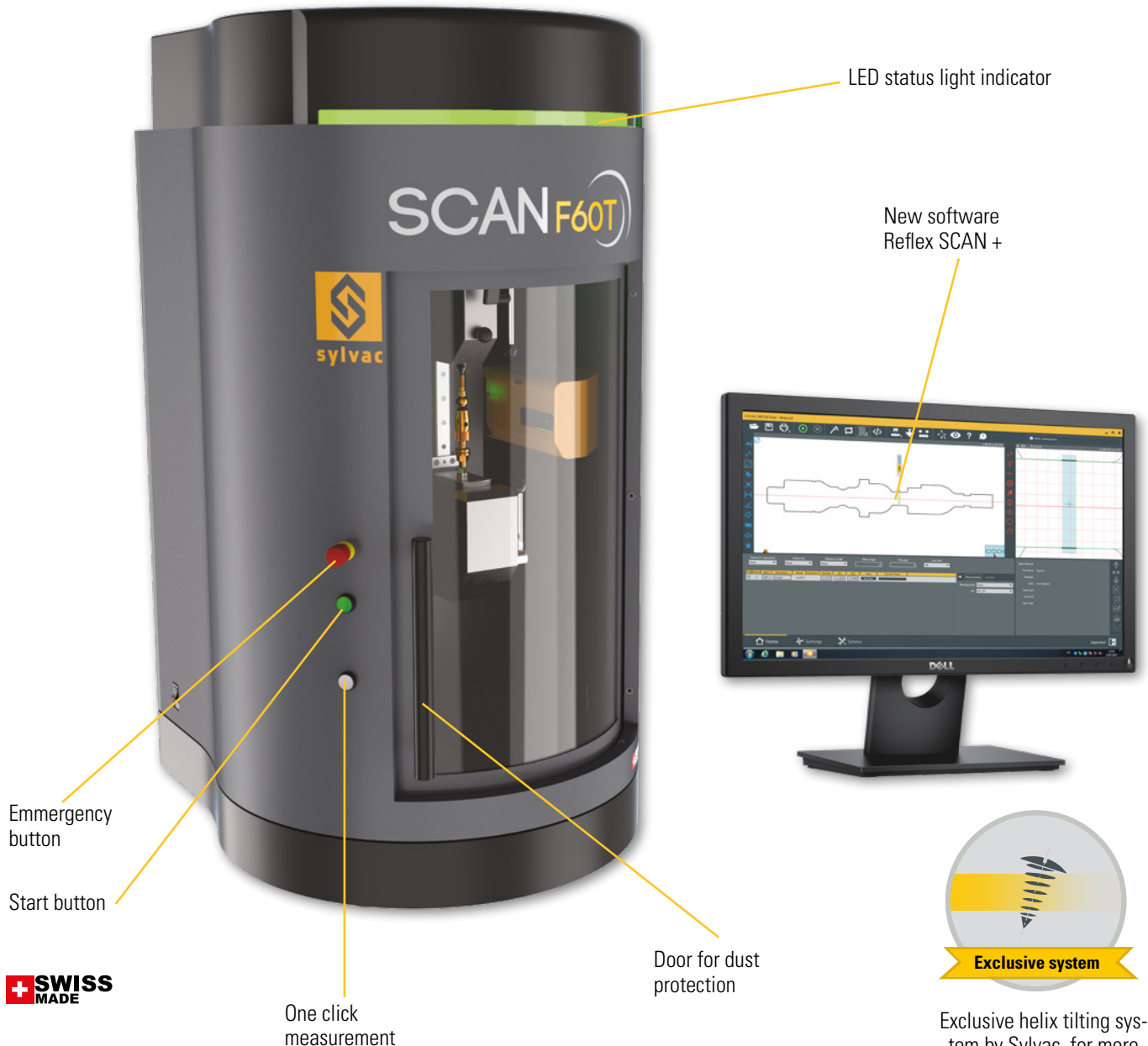

Exclusive system

Exclusive helix tilting system by Sylvac, for more comprehensive thread measurements.

Optical measurement

SYLVAC-SCAN

DIMENSIONAL DRAWINGS

F60 & F60T

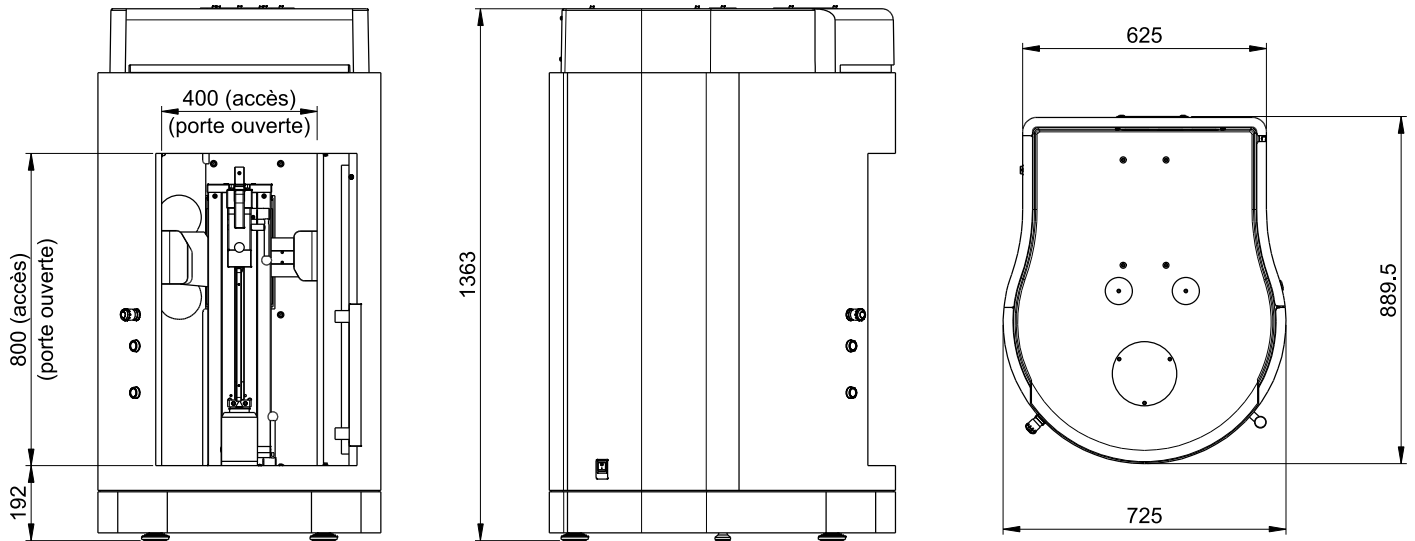

TECHNICAL SPECIFICATIONS

		902.4060		902.4065	
		Sylvac SCAN F60		Sylvac SCAN F60T	
		Diameter	Length	Diameter	Length
Measuring range	mm	64	300	64	300
Resolution up to	mm	0.0001	0.0001	0.0001	0.0001
Max. error	µm	$(1 + D[\text{mm}]/100) \mu\text{m}$	$(3 + L[\text{mm}]/200) \mu\text{m}$	$(1 + D[\text{mm}]/100) \mu\text{m}$	$(3 + L[\text{mm}]/200) \mu\text{m}$
Repeatability	µm	0.5	1.0	0.5	1.0
Holding capacity diameter	mm	120	315	120	315
Headstock		Rotary headstock for static and dynamic measurements			
Tilting for thread measurement		-		• 30°	
Max. weight of part	kg	10			
Machine's weight	kg	265			

BASIC INSTRUMENT

- Instrument according to technical specifications
- Accessories : 2x 902.6202, 902.6161, 902.6212
- Computer with screen, keyboard and mouse
- Windows multilingual operating system
- Sylvac Reflex SCAN Software +
- Manual

Optical measurement

SYLVAC-SCAN

DESCRIPTION

F60L & F60LT

- Concept Reflex SCAN patented for measuring cylindrical workpieces without preprogramming
- Part measurement from **0.2 to 64mm diameter and up to 500mm** length
- Complete 2D part scan (500mm) in <5 seconds !
- Reduce inspection time, scrap and increase productivity
- Exclusive helix tilting system for thread measurements (only on T models)
- Quick return of investment, typically < 6 months
- New software Reflex SCAN + : advanced programming and functions
- Quick release tooling

LED status light indicator



Exclusive helix tilting system by Sylvac, for more comprehensive thread measurements.

New software Reflex SCAN +



One click measurement



Door for dust protection

Optical measurement

SYLVAC-SCAN

DIMENSIONAL DRAWINGS

F60L & F60LT

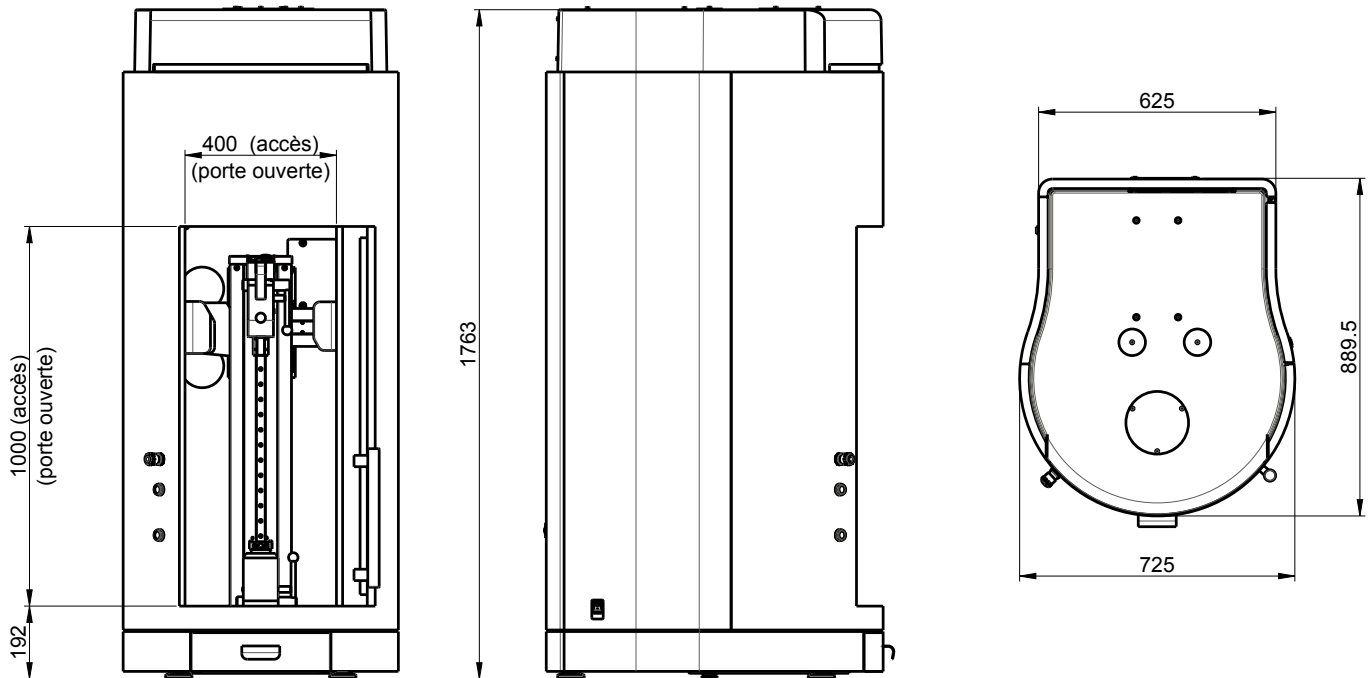

TECHNICAL SPECIFICATIONS

		902.4062		902.4067	
		Sylvac SCAN F60L		Sylvac SCAN F60LT	
		Diameter	Length	Diameter	Length
Measuring range	mm	64	500	64	500
Resolution up to	mm	0.0001	0.0001	0.0001	0.0001
Max. error	μm	$(1 + D[\text{mm}]/100) \mu\text{m}$	$(3 + L[\text{mm}]/200) \mu\text{m}$	$(1 + D[\text{mm}]/100) \mu\text{m}$	$(3 + L[\text{mm}]/200) \mu\text{m}$
Repeatability	μm	0.5	1.0	0.5	1.0
Holding capacity diameter	mm	120	500	120	500
Headstock	Rotary headstock for static and dynamic measurements				
Tilting for thread measurement		-		• 30°	
Max. weight of part	kg	10			
Machine's weight	kg	330			

BASIC INSTRUMENT

- Instrument according to technical specifications
- Accessories : 2x 902.6202, 902.6161, 902.6212
- Computer with screen, keyboard and mouse

- Windows multilingual operating system
- Sylvac Reflex SCAN Software +
- Manual

	FUNCTIONS	
	SYLVAC REFLEX SCAN	SYLVAC REFLEX SCAN+
Automatic measurement of the main features (diameters, lengths, angles, radius)	●	●
Automatic parts / program recognition	●	●
Off-line programming		option
Advanced dust filtering		●
Statistic view		●
CAD import		●
Reports editor	●	●
Data export	●	●
SPC basic calculations	●	●
Script function		option
SPC software	On request	On request
Access management - security level	1	multiple

	GEOMETRICAL TOLERANCING - FEATURES SUMMARY	
	SYLVAC REFLEX SCAN	SYLVAC REFLEX SCAN+
Diameters	●	●
Lengths, heights, distances	●	●
Angles, chamfers	●	●
Radii	●	●
Threads (parallel)	●	●
Threads (root detail, taper, multi-starts, ball screws, worm screws, special threads)		●
Perpendicularity		●
Form deviation		●
2 and 3D alignment of the parts (axis correction)	●	●
Rotational diameters	●	● advanced
Run out	●	● advanced
Concentricity	●	●
Roundness	●	●
Cylindricity	●	●
Across flats	●	●
Straightness	●	●
Interrupted parts (splines, turbines)		●

Optical measurement

SYLVAC-SCAN

ACCESSORIES

Morse 2
SCAN 52 / F60

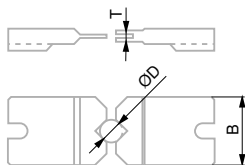
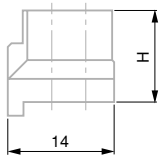
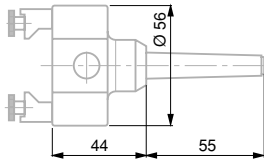

<p>902.6220</p>	<p>Two-jaw gripper External clamping for manual use</p>	<p>• Requires 902.6360</p>
<p>902.6231 H=22</p>	<p>Raising blocks for external jaws, in pairs</p>	<p>• (Morse 1 requires 902.6220)</p>
<p>902.6141 0-6mm T=1.5</p>		
<p>902.6142 0-6mm T=3</p>		
<p>902.6143 6-12mm T=3</p>		
<p>902.6144 12-18mm T=6</p>	<p>External jaws, in pairs</p>	<p>• For</p>
<p>902.6145 18-24mm T=9</p>		<p>902.6220</p>
<p>902.6152 0-6mm T=6</p>		<p>(also for Morse 1)</p>
<p>902.6153 0-6mm T=15</p>		
<p>902.6140 6-12mm T=15</p>		

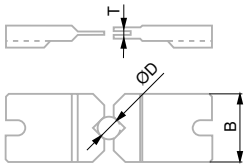

902.6154

Set with:
902.6141
902.6142
902.6143
902.6144
902.6145

External jaws,
in pairs

902.6141 : Jaws dia 0-6mm, T1=1.5mm
902.6142 : Jaws dia 0-6mm, T1=1.3mm
902.6143 : Jaws dia 6-12mm, T1=3mm
902.6144 : Jaws dia 12-18mm, T1=6mm
902.6145 : Jaws dia 18-24mm, T1=9mm

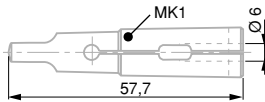

902.6250

Center
adapter with
a 6 mm dia.
coupling bore

Only for Morse 1

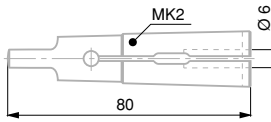

902.6251

Center adapter
with a 6 mm dia.
coupling bore

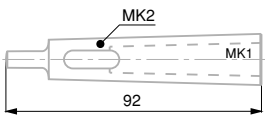

902.6360

Reduction
sleeve,
Morse 2 to 1

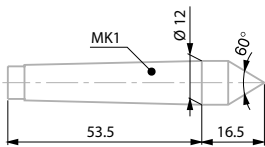

902.6000

Extra male center, 10 mm
(2 items provided with
SYLVAC-SCAN 25)

Only for Morse 1

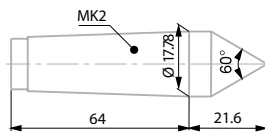

902.6202

Extra male center, 17.78 mm
(2 items provided with SYLVAC-SCAN F60 and
SYLVAC-SCAN 52 Reflex-Click)

Standard

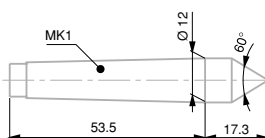

902.6203

Drive centre
(Diamond coated 10 mm)

Only for Morse 1

Optical measurement

SYLVAC-SCAN

ACCESSORIES

Morse 2
SCAN 52 / F60

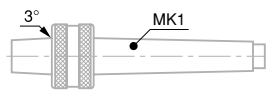

902.6160

Rotation center with a B12 male taper plus a Morse 1 taper shank
(For added sleeves 902.6206/902.6207)

Only for Morse 1

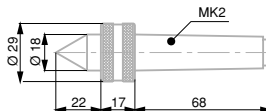

902.6161

Rotation center, Morse 2
(1 item provided with SYLVAC-SCAN F60 and SYLVAC-SCAN 52 Reflex-Click)

Standard

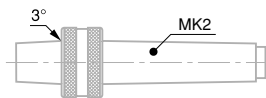

902.6162

Rotation center with a B18 male taper plus a Morse 2 shank

•

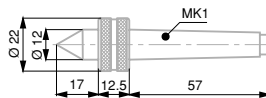

902.6163

Rotation center, Morse 1

Only for Morse 1

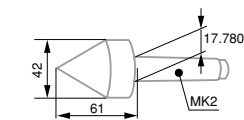

902.6380

Rotation center, Morse 2

•

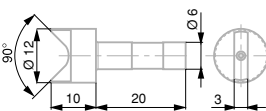

902.6204

Female center, 10 mm dia.

Requires 902.6251
(also for Morse 1, with 902.6250)

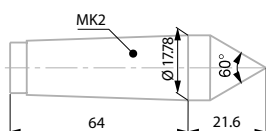

902.6212

Extra male center, 17.78 mm, diamond coated
(1 item provided with SYLVAC-SCAN F60 and SYLVAC-SCAN 52 Reflex-Click)

Standard

Morse 2
SCAN 52 / F60

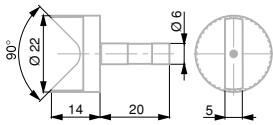

902.6205

Female center,
20 mm dia.

•
Requires
902.6251

(Morse 1 requires 902.6250)

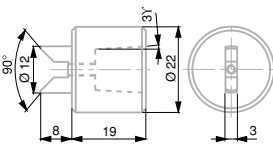

902.6206

Female center,
10 mm dia.
Also with internal
B12 taper

*Only for Morse 1
(requires 902.6160)*

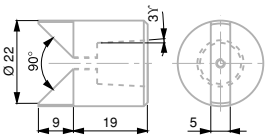

902.6207

Female center,
12 mm dia.
Also with internal
B12 taper

*Only for Morse 1
(requires 902.6160)*

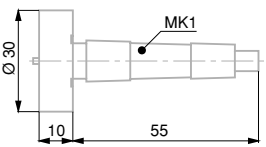

902.6208

Platten,
30 mm dia.

Only for Morse 1

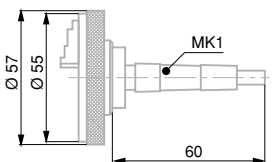

902.6300

3-jaw chuck, clamping range 1÷15 mm
(Clamping capacity: outside 1÷15 mm
inside 11÷26 mm)

•
Requires
902.6360
(also for Morse 1)

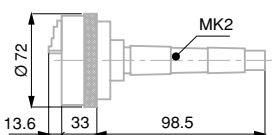

902.6301

3-jaw chuck with Morse 2
taper shank, clamping range 2÷50 mm
(Clamping capacity: outside 2÷50 mm
inside 23÷50 mm)

•

Optical measurement

SYLVAC-SCAN

ACCESSORIES

Morse 2
SCAN 52 / F60

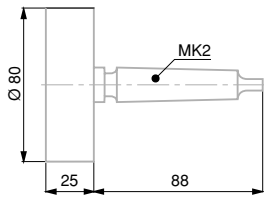

902.6209

Platten,
80 mm dia. with a
Morse 2
taper shank

•

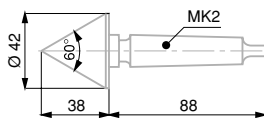

902.6210

Drive centre, Ø 40 mm.
Diamond coated
with a Morse 2 taper shank

•

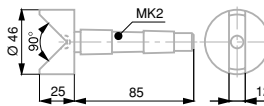

902.6340

Female centre, 40 mm dia.
with a Morse 2 taper shank

•

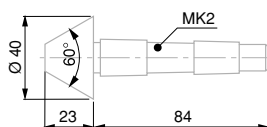

902.6341

Male centre, 15-40 mm dia.
with a Morse 2 taper shank

•

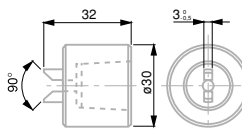

902.6310

Female center, 10 mm dia.,
with a B18 internal taper

•
Requires
902.6162

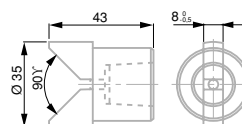

902.6311

Female center, 30 mm dia.,
with a B18
internal taper

•
Requires
902.6162

Morse 2
SCAN 52 / F60

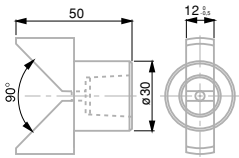

902.6312

Female center, 45 mm dia.,
with a B18
internal taper

•
Requires
902.6162

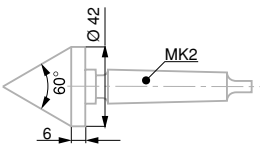

902.6410

Drive centre - diamond coated,
42 mm dia. max.

•

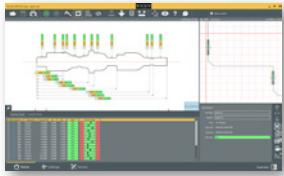

902.7015

Reflex SCAN+ Offline Software

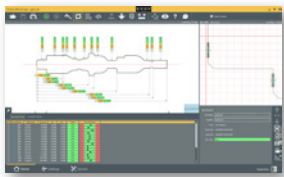

902.7016

Reflex SCAN+ Script programming



902.7017

REFLEX-SCAN+ Automation software module

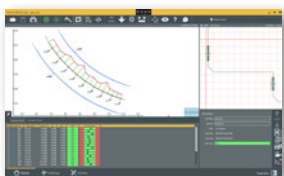







902.7018

REFLEX-SCAN+ CAD compare software

Optical measurement

SYLVAC-SCAN

ACCESSORIES

			SCAN 52	SCAN F60
	902.6012	Gold demo part	•	•
	902.6013	Gold demo part for threads	•	•
	902.6600	Table for Sylvac SCAN F60 (85x85x70mm)		•
	902.6601	Furniture for Sylvac SCAN F60 storage for PC, drawer with lock and arm for keyboard and screen.		•
	902.6605	Height-adjustable table (71-1140mm) for keyboard, screen and mouse (80x60)		•
	902.6607	Accessories tidy insert for drawer (combined with 902.6601)		•
	902.6608	Pneumatic tailstock		•



Our Sylvac Scan range can be fully automated with a robot that can load all your workpieces for you directly on the machine for measurement. Available on request.

Optical measurement

APPLICATIONS

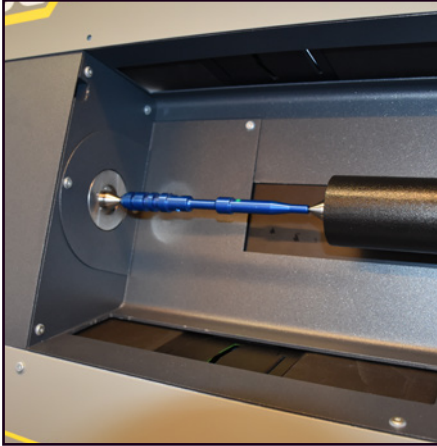

Measurement of a turned part with SCAN 52

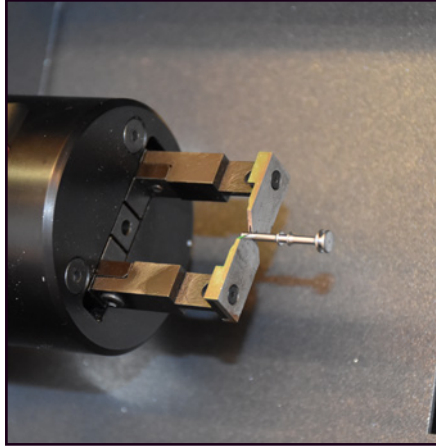

Small turning part held with 2-jaws gripper accessory on SCAN 52

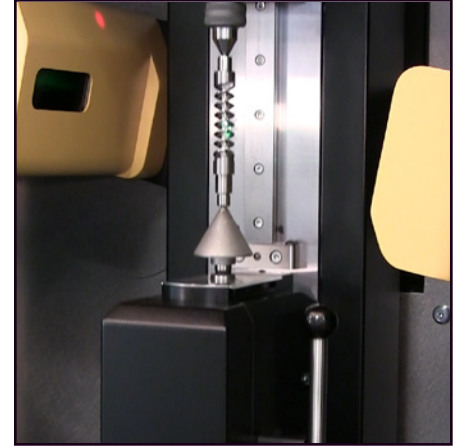

Thread measurement with SCAN F60T



Part measurement with SCAN F60

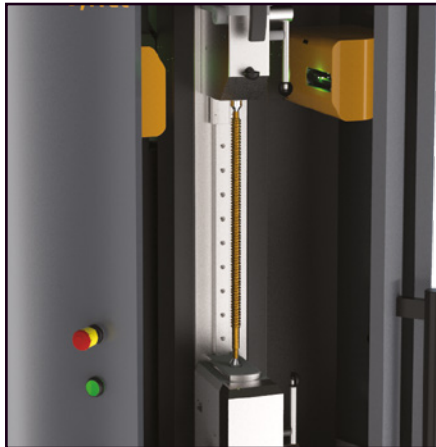

Part measurement with SCAN F60L



SCAN 52 and robot : closed loop with automatic correction of the part

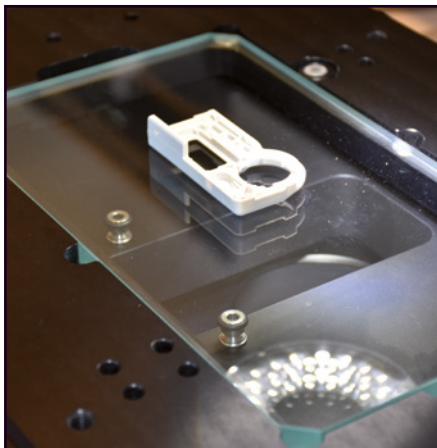

Part lit by ring light on VISIO



Part lit by diasopic light on VISIO

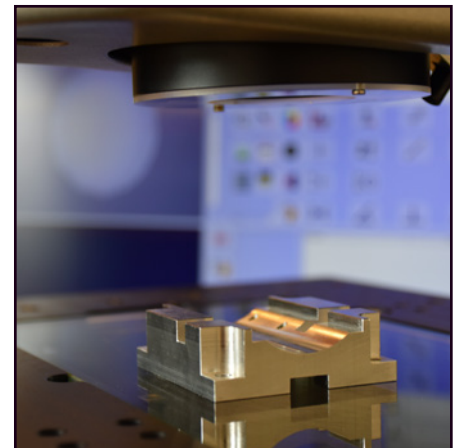

Part lit by coaxial light on VISIO