

Description

Horizontal multistage monobloc design with stainless steel stamping welding impeller and diffuser.

Single phase motor up to 2.2kw. Aluminum casing motor Class F and IP55 are standard supply.

Standard supply for liquid temperature up to 90°C, higher temperature pumps are available on request.



CMX

Performance Range

Capacity:	Q	up to 28 m ³ /h up to 120 gpm
Head:	H	up to 60 m up to 190 feet
Temperature:	T	up to 110 °C up to 230 °F
Speed:	n	2900rpm
Power:	P	up to 4 kw up to 5.5HP

Standard material

CMX : All the parts contact with liquid made of 304 stainless steel, 316 stainless steel on request.

Application:

- Cooling water system
- Aquiculture
- Domestic water supply
- Pesticide dosing system
- General industrial services
- Washing
- Environment protection

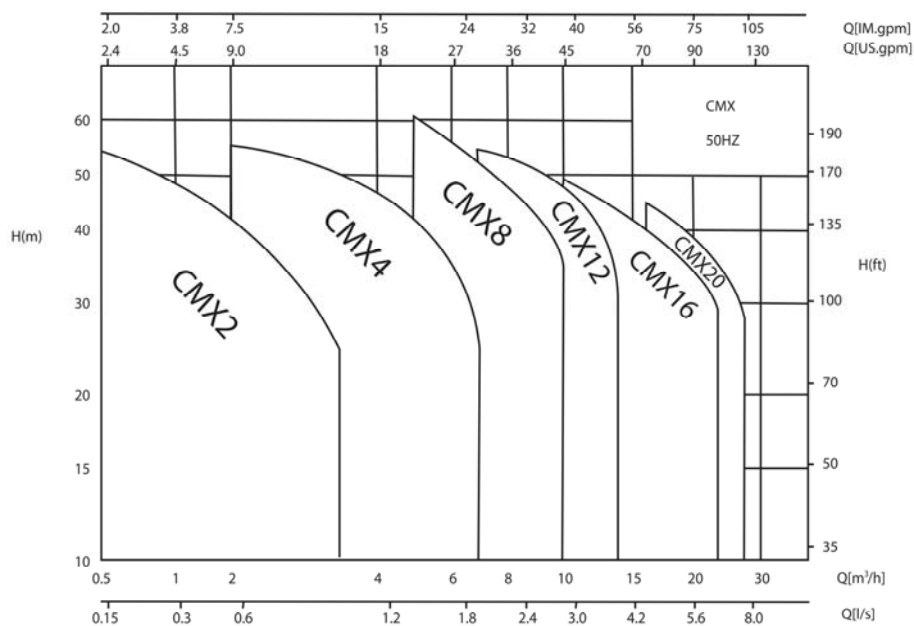

Performance curve

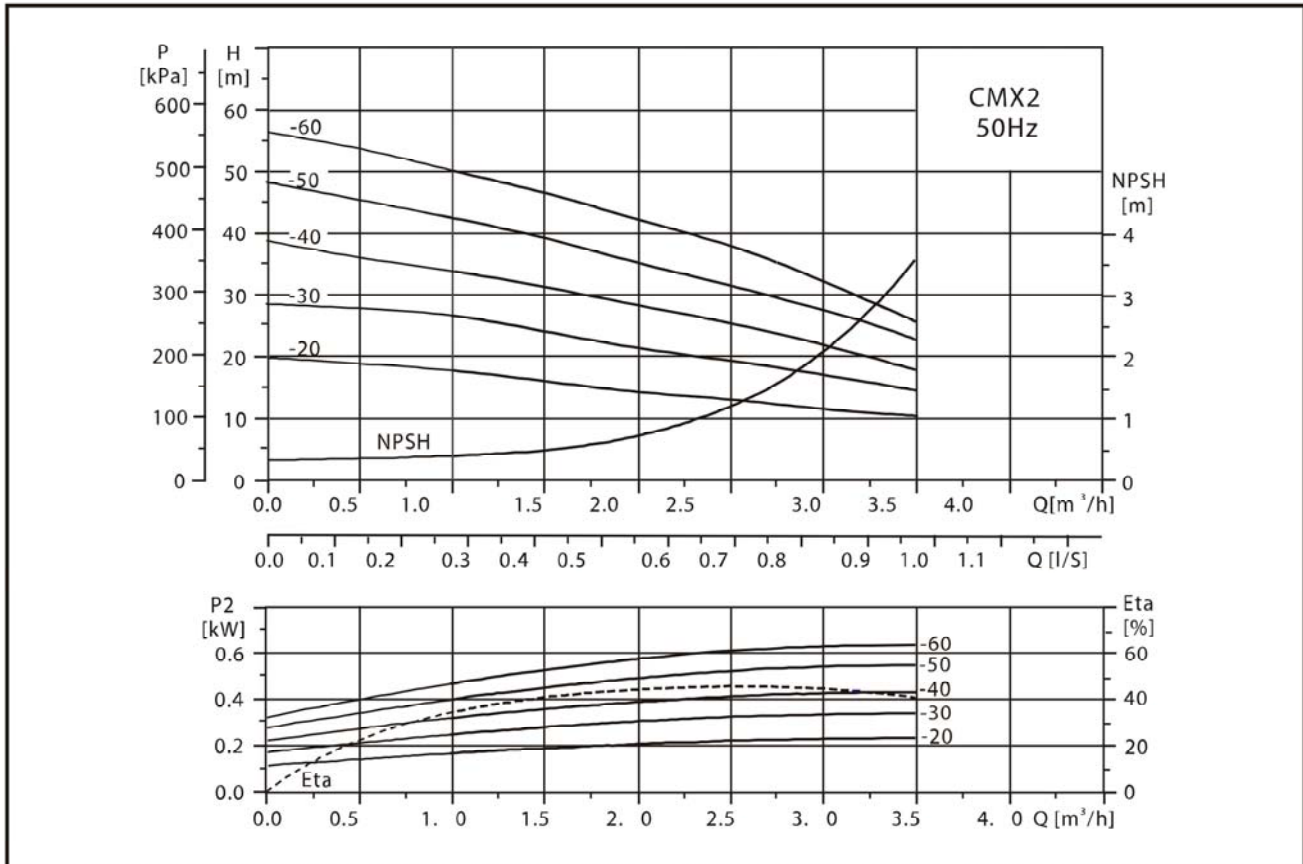

Performance table

Model		Driving motor P ₂ (kW)	Q (m ³ /h)	1.0	1.5	2.0	2.5	3.0	3.5	
Single Phase	Three Phase									
CMX2-20	CMX2-20T	0.37	H (m)	18	16	14	13	11	10	
CMX2-30	CMX2-30T			27	24	21	20	17	14	
CMX2-40	CMX2-40T			0.55	35	32	28	26	23	17
CMX2-50	CMX2-50T			0.55	43	40	35	33	28	22
CMX2-60	CMX2-60T			0.75	50	48	42	38	32	25

Installation sketch

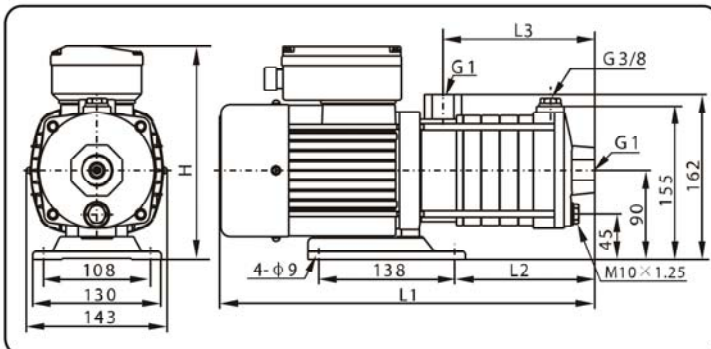

Model	Dimensions (mm)								Weight (kg)
	Single Phase				Three Phase				
	L1	L2	L3	H	L1	L2	L3	H	
CMX2-20(T)	326	90	100	216	326	90	100	194	8.5
CMX2-30(T)	344	108	118	216	344	108	118	194	9
CMX2-40(T)	362	126	136	216	362	126	136	194	9.5
CMX2-50(T)	380	144	154	216	380	144	154	194	9.5
CMX2-60(T)	398	162	172	216	398	162	172	194	10.5

Performance curve

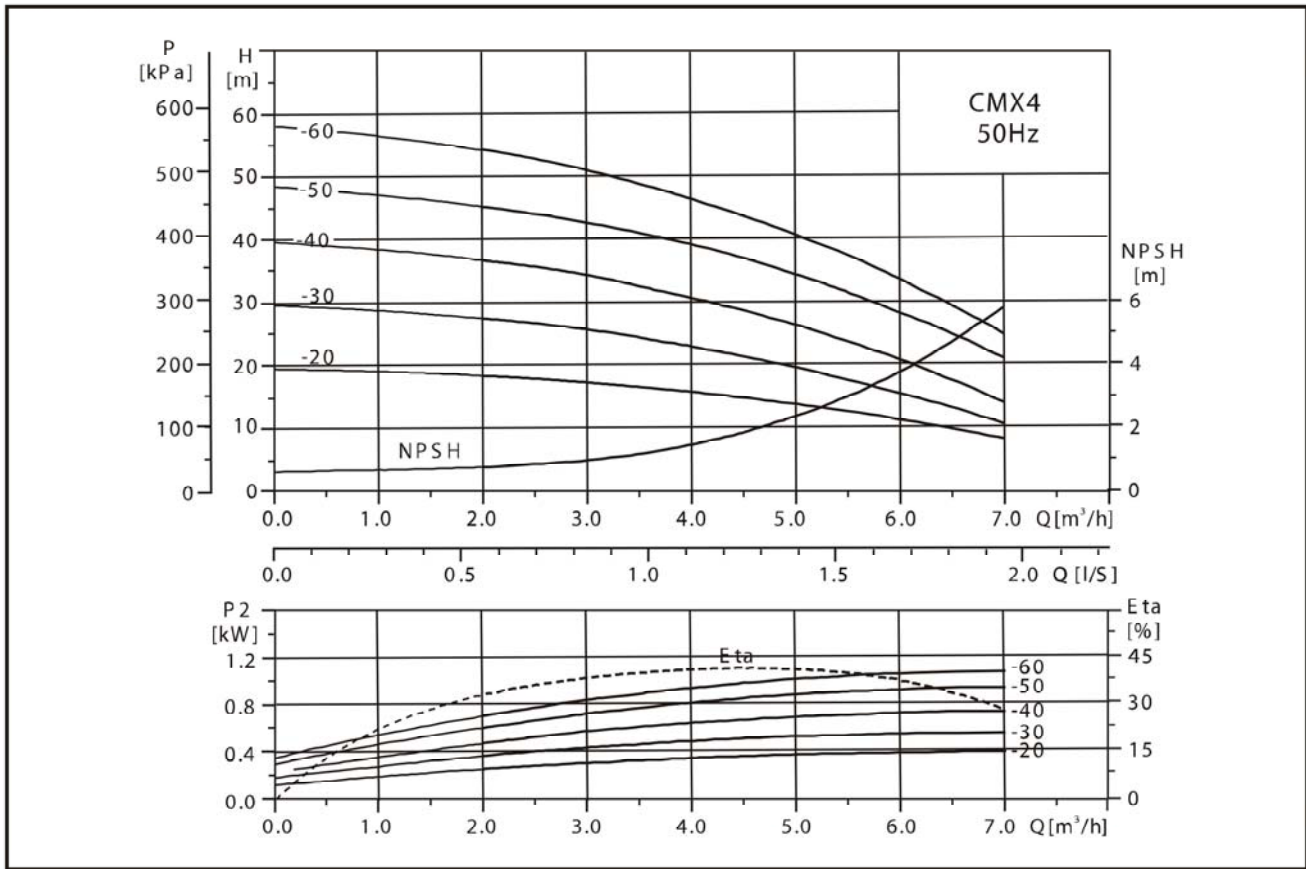

Performance table

Model		Driving motor P ₂ (kW)	Q (m ³ /h)	2.0	3.0	4.0	5.0	6.0	7.0
Single Phase	Three Phase			H (m)					
CMX4-20	CMX4-20T	0.55		18	16	15	13	10	7
CMX4-30	CMX4-30T	0.75		27	25	22	19	15	10
CMX4-40	CMX4-40T	0.75		36	33	30	26	20	13
CMX4-50	CMX4-50T	1.0		44	41	38	32	26	20
CMX4-60	CMX4-60T	1.1		53	50	45	40	33	24

Installation sketch

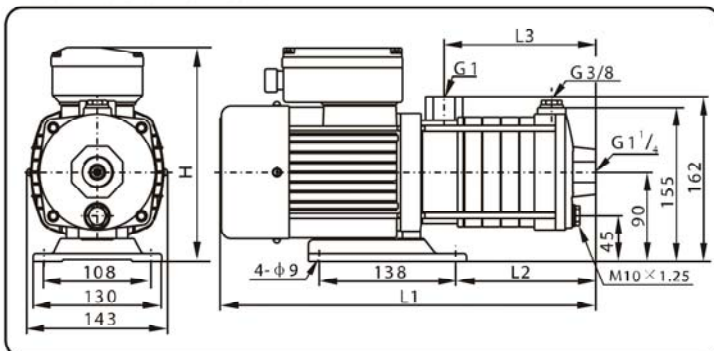

Model	Dimensions(mm)								Weight (kg)
	Single Phase				Three Phase				
	L1	L2	L3	H	L1	L2	L3	H	
CMX4-20(T)	335	99	109	216	335	99	109	194	9
CMX4-30(T)	362	126	136	216	362	126	136	194	10
CMX4-40(T)	389	153	163	216	389	153	163	194	10.5
CMX4-50(T)	416	180	190	216	415	180	190	194	11
CMX4-60(T)	443	207	217	216	443	207	217	194	12

Performance curve

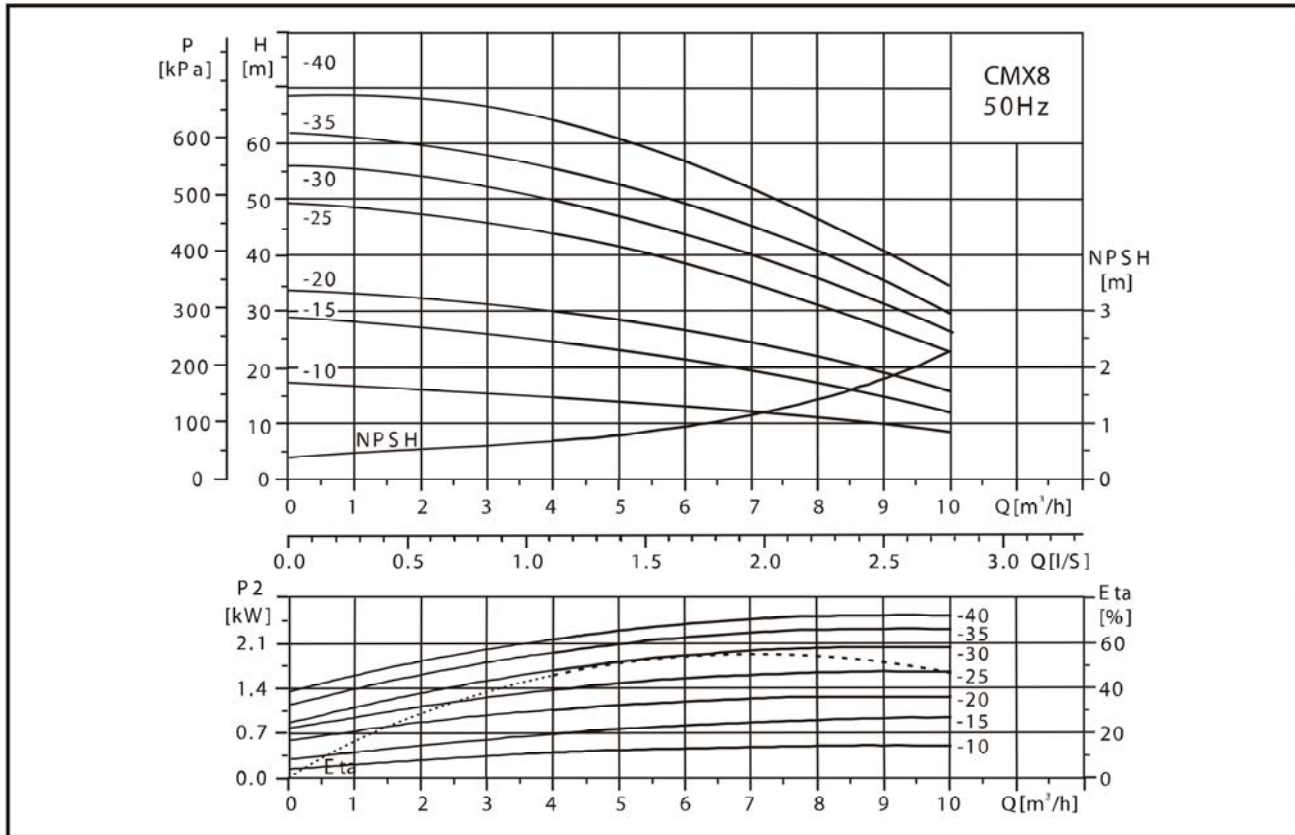

Performance table

Model		Driving motor P ₂ (kW)	Q (m ³ /h)	H (m)						
Single Phase	Three Phase			4.0	5.0	6.0	7.0	8.0	9.0	10
CMX8-10	CMX8-10T	0.55	H (m)	15	14	13	12.5	12	9	8
CMX8-15	CMX8-15T	0.75		25	23	22	21	20	14	12
CMX8-20	CMX8-20T	1.0		32	29	27	25	24	21	17
CMX8-25	CMX8-25T	1.5		43	40	38	34	27	25	20
CMX8-30	CMX8-30T	1.85		50	46	44	40	36	30	26
CMX8-35	CMX8-35T	2.2		56	51	48	44	43	35	28
CMX8-40	CMX8-40T	2.2		65	57.5	57	50	48	42	34

Installation sketch

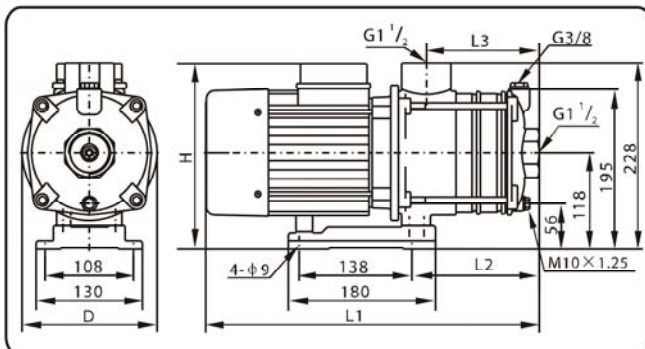

Model	Dimensions (mm)										Weight (kg)
	Single Phase					Three Phase					
	L1	L2	L3	H	D	L1	L2	L3	H	D	
CMX8-10(T)	316	90	78	244	165	316	90	78	222	165	12
CMX8-15(T)	346	120	108	244	165	346	120	108	222	165	14
CMX8-20(T)	346	120	108	244	165	346	120	108	222	165	17
CMX8-25(T)	412	150	138	254	165	412	150	138	232	165	19
CMX8-30(T)	455	150	138	239	170	412	150	138	232	165	24
CMX8-35(T)	485	180	168	239	170	442	180	168	232	165	25
CMX8-40(T)	485	180	168	239	170	442	180	168	232	165	26

Pump cover with G2 inlet/outlet is available

Performance curve

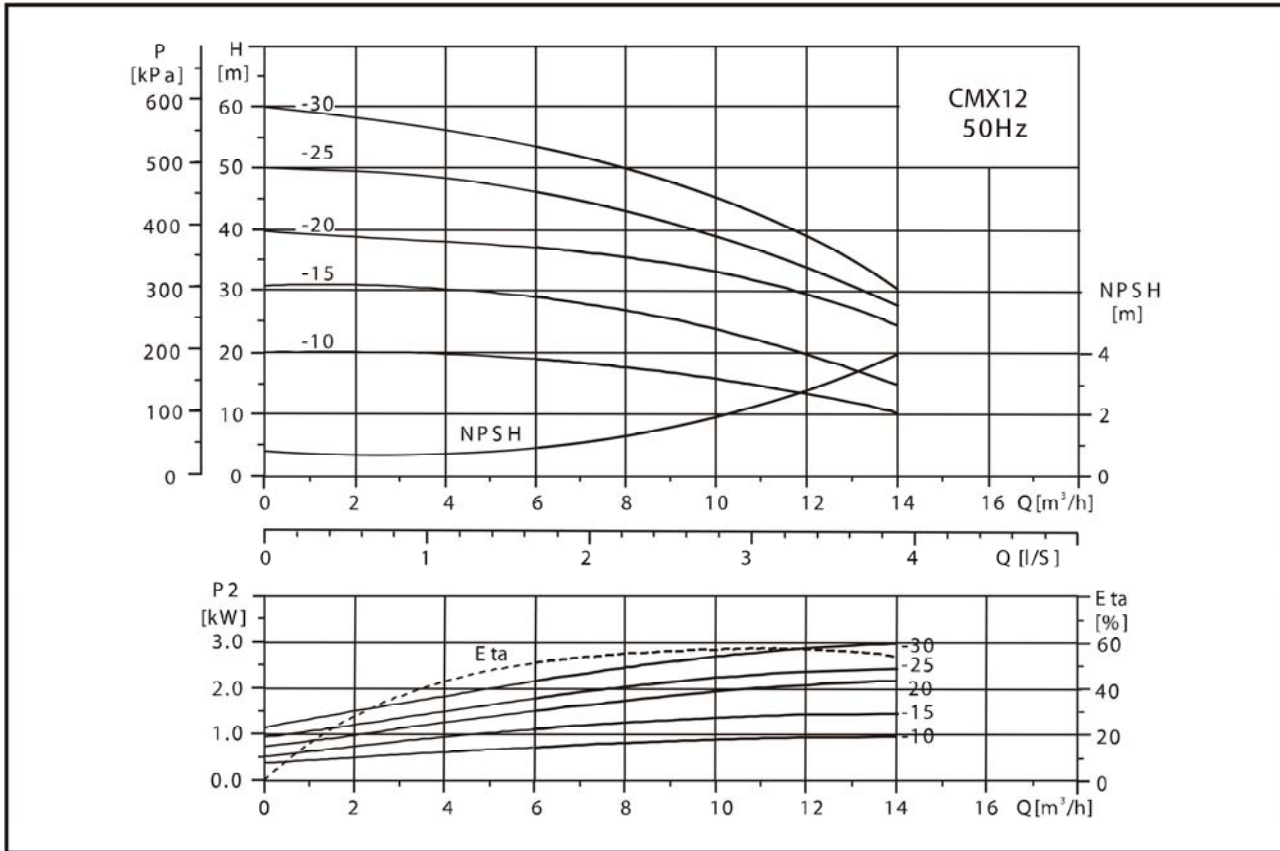

Performance table

Model		Driving motor P ₂ (kW)	Q (m ³ /h)	H (m)									
Single Phase	Three Phase			6.0	7.0	8.0	9.0	10	11	12	13	14	
CMX12-10	CMX12-10T	1.0	H (m)	19	18	17.5	16	15.5	14	13.5	12	10.5	
CMX12-15	CMX12-15T	1.5		28	27	26	25	24	22	20	18	15	
CMX12-20	CMX12-20T	1.85		38	36	35	32	31	29	28	24	20	
CMX12-25	CMX12-25T	2.2		47	45	43	41.5	39	36	33.5	30.5	27	
	CMX12-30T	3.0		53.5	52	50	47.5	45	42	39	35	30	

Installation sketch

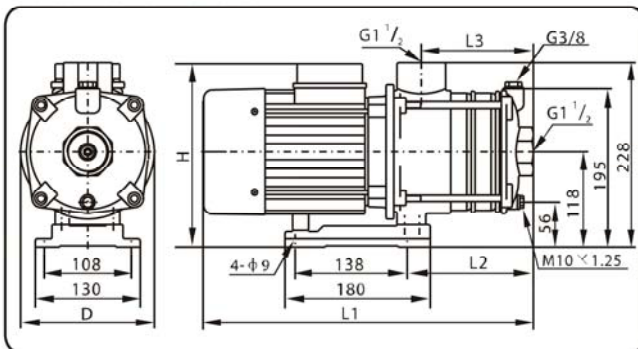

Model	Dimensions(mm)										Weight (kg)
	Single Phase					Three Phase					
	L1	L2	L3	H	D	L1	L2	L3	H	D	
CMX12-10(T)	316	90	78	244	165	316	90	78	222	165	13
CMX12-15(T)	382	120	108	254	165	382	120	108	232	165	15
CMX12-20(T)	423	120	108	239	170	382	120	108	232	165	23
CMX12-25(T)	454	150	138	239	170	412	150	138	232	165	25
CMX12-30T	-	-	-	-	-	472	150	138	239	170	27

Pump cover with G2 inlet/outlet is available

Performance curve

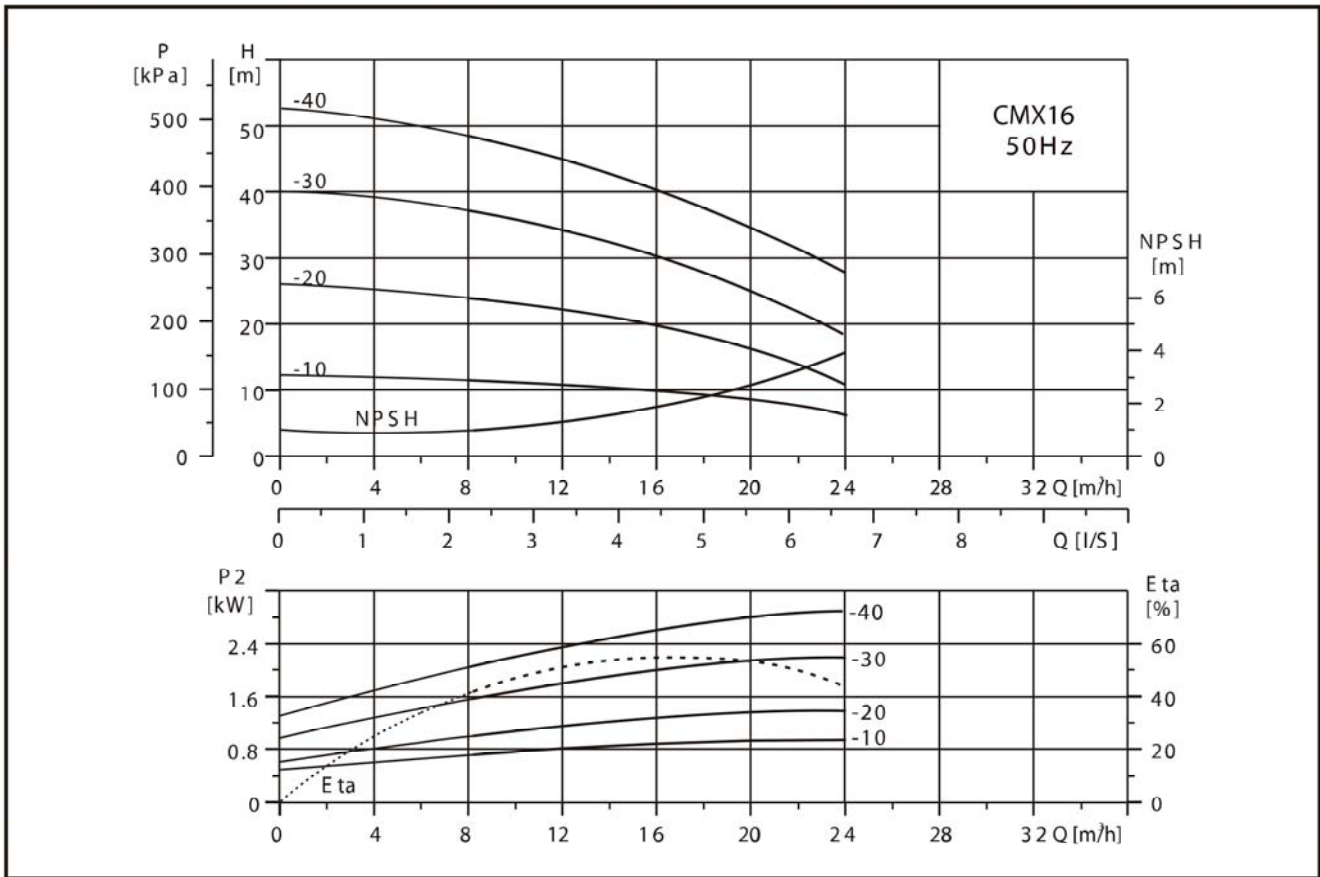

Performance table

Model		Driving motor P ₂ (kW)	Q (m³/h)	H (m)															
Single Phase	Three Phase			8	10	12	14	16	18	20	22	24	24	22	20	18	16	14	12
CMX16-10	CMX16-10T	1.0		12	11.5	11	10.5	10	9	8	7	6							
CMX16-20	CMX16-20T	1.5		24	23	22	21	20	19	16	14	12							
CMX16-30	CMX16-30T	2.2		38	36	34	33	30	28	26	23	20							
	CMX16-40T	3.0		50	48	46	44	40	38	36	32	28							

Installation sketch

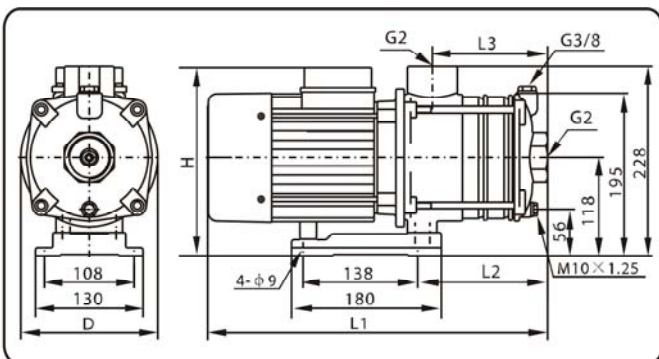

Model	Dimensions (mm)										Weight (kg)
	Single Phase					Three Phase					
	L1	L2	L3	H	D	L1	L2	L3	H	D	
CMX16-10(T)	326	96	81	244	165	326	96	81	222	165	12
CMX16-20(T)	406	141	126	254	165	406	141	126	232	165	18
CMX16-30(T)	495	186	171	239	170	451	186	171	232	165	25
CMX16-40T	-	-	-	-	-	556	231	216	239	170	28

Performance curve

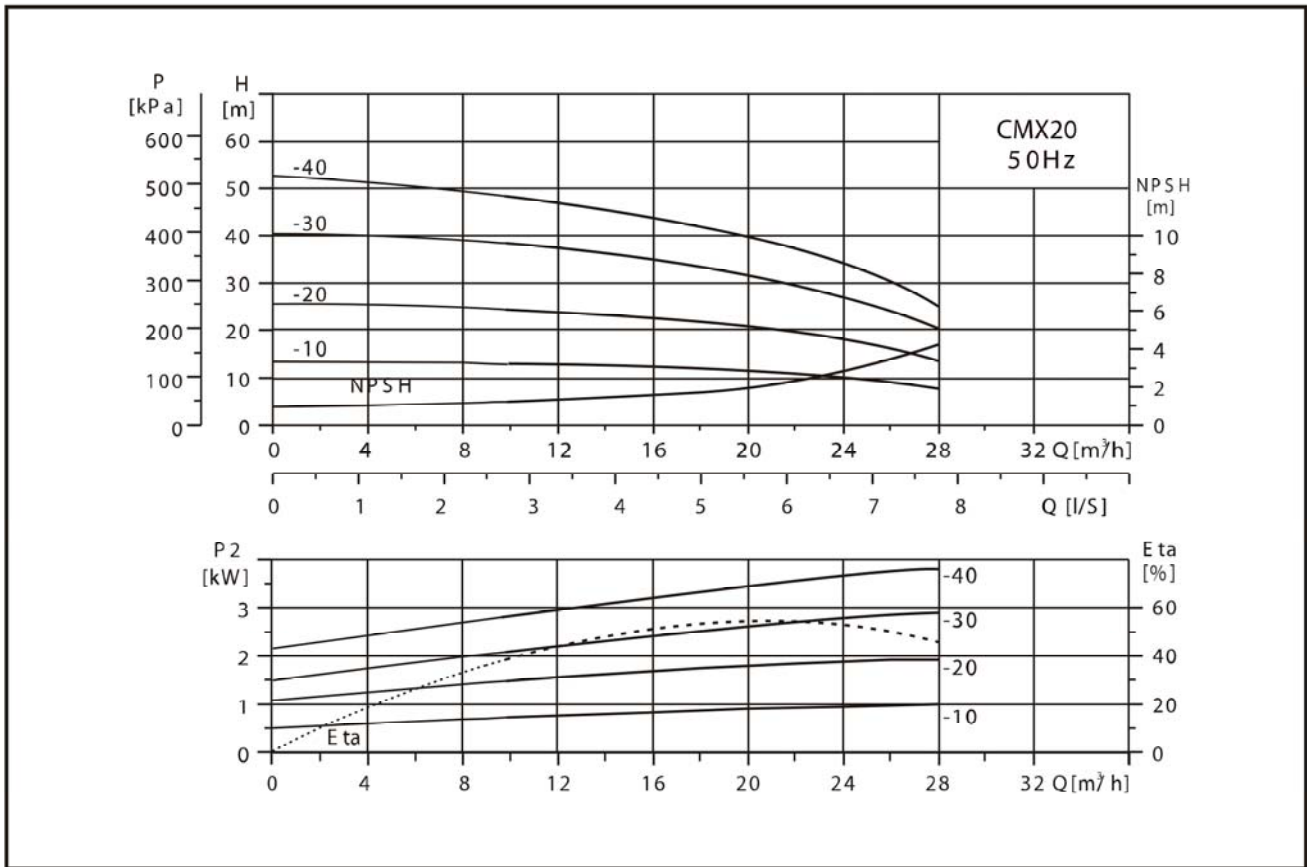

Performance table

Model		Driving motor P ₂ (kW)	Q (m ³ /h)	H (m)											
Single Phase	Three Phase			10	12	14	16	18	20	22	24	26	28		
CMX20-10	CMX20-10T	1.0	H (m)	13	12.5	12	11.5	11	10.5	10	9	8.5	7.5		
CMX20-20	CMX20-20T	1.85		25	24	23	22	21	20	18	16	14	12		
	CMX20-30T	3.0		39	38	36	35	33	31.5	30	27	24	21		
	CMX20-40T	4.0		50	48	46	44	42	40	36	32	28	24		

Installation sketch

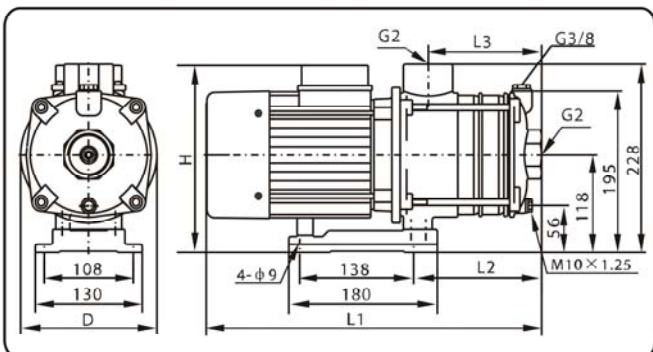

Model	Dimensions (mm)										Weight (kg)
	Single Phase					Three Phase					
	L1	L2	L3	H	D	L1	L2	L3	H	D	
CMX20-10(T)	326	96	81	244	165	326	96	81	222	165	14
CMX20-20(T)	448	141	126	239	170	406	141	126	232	165	24
CMX20-30T	-	-	-	-	-	511	186	171	239	170	28
CMX20-40T	-	-	-	-	-	575	316	216	248	195	33