

Series
Expansion

MICRO-MINI TWIN

Ideal for small-diameter boring of general and stainless steels.



- Economical, solid shank type with two cutting edges.
- Boring, copying, grooving and threading bars available.
- Minimum bore diameter 2.2mm. (CB type)



MICRO-MINI TWIN

● Boring

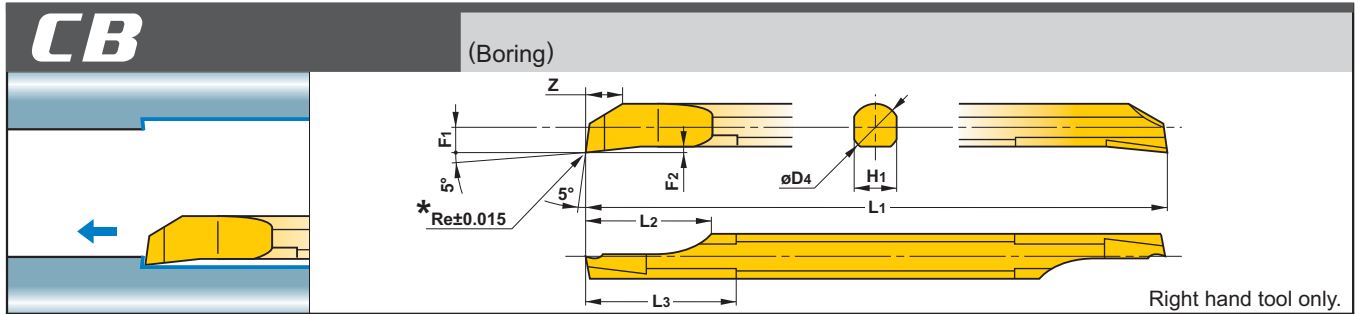

Order Number	Stock		Breaker	Minimum Cutting Diameter (mm)		Dimensions (mm)								
	Micrograin Carbide	Coated Carbide		l/d ≤ 3	l/d > 3	Re	D4	L1	L2	L3	F1	F2	H1	Z
	TF15	VP15TF												
CB02RS	●	●	Without	2.2	3.6	0.05	2	50	5	6	1	0.25	1.8	1.4
02RS-B	●	●	With	2.2	3.9	0.05	2	50	5	6	1	0.25	1.8	1.4
02RS-01	●	●	Without	2.2	3.6	0.1	2	50	5	6	1	0.25	1.8	1.4
02RS-01B	●	●	With	2.2	4.2	0.1	2	50	5	6	1	0.25	1.8	1.4
02RS-02	●	●	Without	2.2	3.6	0.2	2	50	5	6	1	0.25	1.8	1.4
02RS-02B	●	●	With	2.2	4.9	0.2	2	50	5	6	1	0.25	1.8	1.4
03RS	●	●	Without	3.2	4.2	0.05	3	50	7.5	9	1.5	0.35	2.7	2.3
03RS-B	●	●	With	3.2	4.4	0.05	3	50	7.5	9	1.5	0.35	2.7	2.3
03RS-01	●	●	Without	3.2	4.2	0.1	3	50	7.5	9	1.5	0.35	2.7	2.3
03RS-01B	●	●	With	3.2	4.5	0.1	3	50	7.5	9	1.5	0.35	2.7	2.3
03RS-02	●	●	Without	3.2	4.2	0.2	3	50	7.5	9	1.5	0.35	2.7	2.3
03RS-02B	●	●	With	3.2	4.8	0.2	3	50	7.5	9	1.5	0.35	2.7	2.3
04RS	●	●	Without	4.2	5.1	0.05	4	60	10	12	2	0.45	3.6	3.1
04RS-B	●	●	With	4.2	5.2	0.05	4	60	10	12	2	0.45	3.6	3.1
04RS-01	●	●	Without	4.2	5.1	0.1	4	60	10	12	2	0.45	3.6	3.1
04RS-01B	●	●	With	4.2	5.3	0.1	4	60	10	12	2	0.45	3.6	3.1
04RS-02	●	●	Without	4.2	5.1	0.2	4	60	10	12	2	0.45	3.6	3.1
04RS-02B	●	●	With	4.2	5.5	0.2	4	60	10	12	2	0.45	3.6	3.1
05RS	●	●	Without	5.2	6.0	0.05	5	70	12.5	15	2.5	0.55	4.5	3.9
05RS-B	●	●	With	5.2	6.1	0.05	5	70	12.5	15	2.5	0.55	4.5	3.9
05RS-02	●	●	Without	5.2	6.0	0.2	5	70	12.5	15	2.5	0.55	4.5	3.9
05RS-02B	●	●	With	5.2	6.4	0.2	5	70	12.5	15	2.5	0.55	4.5	3.9
NEW CB06RS	●	●	Without	6.2	7.2	0.05	6	75	12.5	18	3	0.65	5.4	4.7
NEW 06RS-B	●	●	With	6.2	7.3	0.05	6	75	12.5	18	3	0.65	5.4	4.7
NEW 06RS-02	●	●	Without	6.2	7.2	0.2	6	75	12.5	18	3	0.65	5.4	4.7
NEW 06RS-02B	●	●	With	6.2	7.8	0.2	6	75	12.5	18	3	0.65	5.4	4.7
NEW CB07RS	●	●	Without	7.2	8.6	0.05	7	85	12.5	21	3.5	0.75	6.3	5.5
NEW 07RS-B	●	●	With	7.2	8.8	0.05	7	85	12.5	21	3.5	0.75	6.3	5.5
NEW 07RS-02	●	●	Without	7.2	8.6	0.2	7	85	12.5	21	3.5	0.75	6.3	5.5
NEW 07RS-02B	●	●	With	7.2	9.2	0.2	7	85	12.5	21	3.5	0.75	6.3	5.5
NEW CB08RS	●	●	Without	8.2	9.5	0.05	8	95	15	24	4	0.85	7.2	6.3
NEW 08RS-B	●	●	With	8.2	9.6	0.05	8	95	15	24	4	0.85	7.2	6.3
NEW 08RS-02	●	●	Without	8.2	9.5	0.2	8	95	15	24	4	0.85	7.2	6.3
NEW 08RS-02B	●	●	With	8.2	9.8	0.2	8	95	15	24	4	0.85	7.2	6.3

* The Re dimension represents the size before grinding a chip breaker.

Note) For the recommended cutting conditions, refer to the general catalogue or B042G Tools News.

● : Inventory maintained. (Note: One piece included per case)

● Internal grooving

CG

(Internal grooving)

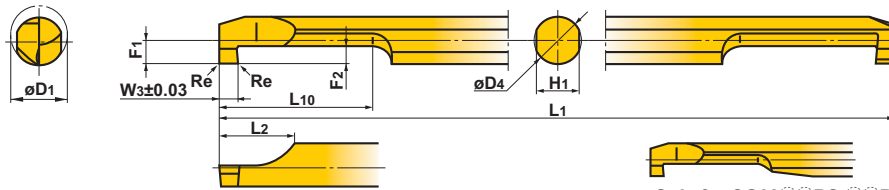

Order Number	Stock		Breaker	Minimum Cutting Diameter D1 (mm)	Groove Width W3 (mm)	Max Groove Depth F2 (mm)	Dimensions (mm)						
	Micrograin Carbide	Coated Carbide					Re	D4	L1	L10	L2	F1	H1
	TF15	VP15TF											
NEW CG0305RS-10	●	●	Without	3	1	1	0.05	3	50	5	6	1.3	2.7
NEW 0305RS-10B	●	●	With	3	1	1	0.05	3	50	5	6	1.3	2.7
NEW 0306RS-20	●	●	Without	3	2	1	0.1	3	50	6	6	1.3	2.7
NEW 0306RS-20B	●	●	With	3	2	1	0.1	3	50	6	6	1.3	2.7
03RS-10	●	●	Without	3	1	1	0.05	3	50	10	6	1.3	2.7
03RS-10B	●	●	With	3	1	1	0.05	3	50	10	6	1.3	2.7
03RS-20	●	●	Without	3	2	1	0.1	3	50	11	6	1.3	2.7
03RS-20B	●	●	With	3	2	1	0.1	3	50	11	6	1.3	2.7
NEW 0407RS-10	●	●	Without	4	1	1.5	0.05	4	60	7	7	1.8	3.6
NEW 0407RS-10B	●	●	With	4	1	1.5	0.05	4	60	7	7	1.8	3.6
NEW 0408RS-20	●	●	Without	4	2	1.5	0.1	4	60	8	7	1.8	3.6
NEW 0408RS-20B	●	●	With	4	2	1.5	0.1	4	60	8	7	1.8	3.6
04RS-10	●	●	Without	4	1	1.5	0.05	4	60	15	7	1.8	3.6
04RS-10B	●	●	With	4	1	1.5	0.05	4	60	15	7	1.8	3.6
04RS-20	●	●	Without	4	2	1.5	0.1	4	60	16	7	1.8	3.6
04RS-20B	●	●	With	4	2	1.5	0.1	4	60	16	7	1.8	3.6
NEW 0510RS-10	●	●	Without	5	1	2	0.05	5	70	10	8	2.3	4.5
NEW 0510RS-10B	●	●	With	5	1	2	0.05	5	70	10	8	2.3	4.5
NEW 0511RS-20	●	●	Without	5	2	2	0.1	5	70	11	8	2.3	4.5
NEW 0511RS-20B	●	●	With	5	2	2	0.1	5	70	11	8	2.3	4.5
05RS-10	●	●	Without	5	1	2	0.05	5	70	20	8	2.3	4.5
05RS-10B	●	●	With	5	1	2	0.05	5	70	20	8	2.3	4.5
05RS-20	●	●	Without	5	2	2	0.1	5	70	21	8	2.3	4.5
05RS-20B	●	●	With	5	2	2	0.1	5	70	21	8	2.3	4.5
NEW 0610RS-10	●	●	Without	6	1	2	0.05	6	75	10	8	2.8	5.4
NEW 0610RS-10B	●	●	With	6	1	2	0.05	6	75	10	8	2.8	5.4
NEW 0611RS-20	●	●	Without	6	2	2	0.1	6	75	11	8	2.8	5.4
NEW 0611RS-20B	●	●	With	6	2	2	0.1	6	75	11	8	2.8	5.4
06RS-10	●	●	Without	6	1	2	0.05	6	75	20	8	2.8	5.4
06RS-10B	●	●	With	6	1	2	0.05	6	75	20	8	2.8	5.4
06RS-20	●	●	Without	6	2	2	0.1	6	75	21	8	2.8	5.4
06RS-20B	●	●	With	6	2	2	0.1	6	75	21	8	2.8	5.4
NEW 0712RS-10	●	●	Without	7	1	2	0.05	7	85	12	8	3.3	6.4
NEW 0712RS-10B	●	●	With	7	1	2	0.05	7	85	12	8	3.3	6.4
NEW 0713RS-20	●	●	Without	7	2	2	0.1	7	85	13	8	3.3	6.4
NEW 0713RS-20B	●	●	With	7	2	2	0.1	7	85	13	8	3.3	6.4
07RS-10	●	●	Without	7	1	2	0.05	7	85	25	8	3.3	6.4
07RS-10B	●	●	With	7	1	2	0.05	7	85	25	8	3.3	6.4
07RS-20	●	●	Without	7	2	2	0.1	7	85	26	8	3.3	6.4
07RS-20B	●	●	With	7	2	2	0.1	7	85	26	8	3.3	6.4

Note) For the recommended cutting conditions, refer to the general catalogue or B042G Tools News.

MICRO-MINI TWIN

● Internal copying

Order Number	Stock		Breaker	Minimum Cutting Diameter D1 (mm)	Dimensions (mm)							
	Micrograin Carbide	Coated Carbide			Re	D4	L1	L10	L2	F1	H1	
	TF15	VP15TF										
CR03RS-01	●	●	Without	3.5	0.1	3	50	8	6	0.15	2.7	
03RS-01B	●	●	With	3.5	0.1	3	50	8	6	0.15	2.7	
04RS-01	●	●	Without	4.5	0.1	4	60	10	7	0.15	3.6	
04RS-01B	●	●	With	4.5	0.1	4	60	10	7	0.15	3.6	
05RS-01	●	●	Without	5.5	0.1	5	70	12	8	0.15	4.5	
05RS-01B	●	●	With	5.5	0.1	5	70	12	8	0.15	4.5	

Note) For the recommended cutting conditions, refer to the general catalogue or B042G Tools News.

● Internal threading

Order Number	Stock		Breaker	Threads				Minimum Cutting Diameter D1 (mm)	Dimensions (mm)								
	Micrograin Carbide	Coated Carbide		Metric		Unified			Re	D4	L1	L10	L2	F1	Z2	F2	H1
	TF15	VP15TF		Thread	Pitch (mm)	Thread	Pitch (thread/inch)										
NEW CT0305RS-M4	●	●	Without	≥M4	0.5–1.0	≥NO.8-32UNC	36–24	3	0.03	3	50	5.2	6	1.3	0.6	1.2	2.7
03RS-M4	●	●	Without	≥M4	0.5–1.0	≥NO.8-36UNC	36–24	3	0.03	3	50	10.2	6	1.3	0.6	1.2	2.7
03RS-M4B	●	●	With	≥M4	0.5–1.0	≥NO.8-36UNF	36–24	3	0.03	3	50	10.2	6	1.3	0.6	1.2	2.7
NEW 0407RS-M6	●	●	Without	≥M6	0.75–1.25	≥1/4-20UNC	28–20	4.5	0.05	4	60	7.6	7	1.8	0.8	1.7	3.6
04RS-M6	●	●	Without	≥M6	0.75–1.25	≥1/4-28UNC	28–20	4.5	0.05	4	60	15.6	7	1.8	0.8	1.7	3.6
04RS-M6B	●	●	With	≥M6	0.75–1.25	≥1/4-28UNF	28–20	4.5	0.05	4	60	15.6	7	1.8	0.8	1.7	3.6
NEW 0511RS-M8	●	●	Without	≥M8	0.75–1.5	≥5/16-18UNC	24–18	6	0.05	5	70	11	8	2.3	1	2.2	4.5
05RS-M8	●	●	Without	≥M8	0.75–1.5	≥5/16-18UNC	24–18	6	0.05	5	70	21	8	2.3	1	2.2	4.5
05RS-M8B	●	●	With	≥M8	0.75–1.5	≥5/16-24UNF	24–18	6	0.05	5	70	21	8	2.3	1	2.2	4.5
NEW 0611RS-M10	●	●	Without	≥M10	0.75–1.75	≥3/8-16UNC	24–16	7	0.05	6	75	11	8	2.8	1	2.2	5.4
06RS-M10	●	●	Without	≥M10	0.75–1.75	≥3/8-16UNC	24–16	7	0.05	6	75	21	8	2.8	1	2.2	5.4
06RS-M10B	●	●	With	≥M10	0.75–1.75	≥3/8-24UNF	24–16	7	0.05	6	75	21	8	2.8	1	2.2	5.4

Note) For the recommended cutting conditions, refer to the general catalogue or B042G Tools News.

● : Inventory maintained. (Note: One piece included per case)

Round Holder

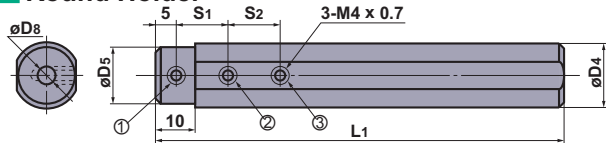

RBH158 \odot N, RBH16 \odot N, RBH190 \odot N

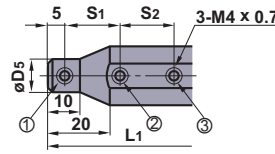

RBH200 \odot N, RBH25 \odot N, RBH254 \odot N

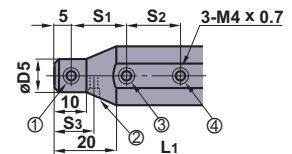

RBH22 \odot N

Order Number	Stock	Dimensions (mm)							*1 Clamp Screw				Wrench	Torque (N/m)
		D4	D8	D5	L1	S1	S2	S3	①	②	③	④		
RBH15820N	●	15.875	2	15	100	10	—	—	B	B	—	—	HKY20F	2.0
15830N	●	15.875	3	15	100	10	10	—	A	A	A	—	HKY20F	2.0
15840N	●	15.875	4	15	100	15	15	—	A	A	A	—	HKY20F	2.0
15850N	●	15.875	5	15	100	15	15	—	A	A	A	—	HKY20F	2.0
15860N	●	15.875	6	15	100	15	15	—	A	A	A	—	HKY20F	2.0
15870N	●	15.875	7	15	100	20	20	—	A	A	A	—	HKY20F	2.0
NEW 15880N	●	15.875	8	15	100	20	20	—	D	D	D	—	HKY20F	2.0
RBH1620N	●	16	2	15	100	10	—	—	B	B	—	—	HKY20F	2.0
1630N	●	16	3	15	100	10	10	—	A	A	A	—	HKY20F	2.0
1640N	●	16	4	15	100	15	15	—	A	A	A	—	HKY20F	2.0
1650N	●	16	5	15	100	15	15	—	A	A	A	—	HKY20F	2.0
1660N	●	16	6	15	100	15	15	—	A	A	A	—	HKY20F	2.0
1670N	●	16	7	15	100	20	20	—	A	A	A	—	HKY20F	2.0
NEW 1680N	●	16	8	15	100	20	20	—	D	D	D	—	HKY20F	2.0
*2 RBH19020N	●	19.05	2	18	125	10	—	—	C	C	—	—	HKY20F	2.0
*2 19030N	●	19.05	3	18	125	10	10	—	B	B	B	—	HKY20F	2.0
*2 19040N	●	19.05	4	18	125	15	15	—	B	B	B	—	HKY20F	2.0
*2 19050N	●	19.05	5	18	125	15	15	—	B	B	B	—	HKY20F	2.0
*2 19060N	●	19.05	6	18	125	15	15	—	B	B	B	—	HKY20F	2.0
*2 19070N	●	19.05	7	18	125	20	20	—	B	B	B	—	HKY20F	2.0
NEW 19080N	●	19.05	8	18	125	20	20	—	A	A	A	—	HKY20F	2.0
RBH2020N	●	20	2	11	125	10	—	—	A	A	—	—	HKY20F	2.0
2030N	●	20	3	12	125	10	10	—	A	A	B	—	HKY20F	2.0
2040N	●	20	4	13	125	15	15	—	A	B	B	—	HKY20F	2.0
2050N	●	20	5	14	125	15	15	—	A	B	B	—	HKY20F	2.0
2060N	●	20	6	15	125	15	15	—	A	B	B	—	HKY20F	2.0
2070N	●	20	7	16	125	20	20	—	A	B	B	—	HKY20F	2.0
NEW 2080N	●	20	8	17	125	20	20	—	A	A	A	—	HKY20F	2.0
RBH2220N	●	22	2	11	125	10	—	10	A	B	—	A	HKY20F	2.0
2230N	●	22	3	12	125	10	10	10	A	B	C	A	HKY20F	2.0
2240N	●	22	4	13	125	15	15	12.5	A	B	B	A	HKY20F	2.0
2250N	●	22	5	14	125	15	15	12.5	A	B	B	A	HKY20F	2.0
2260N	●	22	6	15	125	15	15	15	A	B	B	A	HKY20F	2.0
2270N	●	22	7	16	125	20	20	15	A	B	B	A	HKY20F	2.0
NEW 2280N	●	22	8	17	125	20	20	15	A	B	B	A	HKY20F	2.0
RBH2520N	●	25	2	11	150	10	—	—	A	B	—	—	HKY20F	2.0
2530N	●	25	3	12	150	10	10	—	A	B	C	—	HKY20F	2.0
2540N	●	25	4	13	150	15	15	—	A	C	C	—	HKY20F	2.0
2550N	●	25	5	14	150	15	15	—	A	C	C	—	HKY20F	2.0
2560N	●	25	6	15	150	15	15	—	A	C	C	—	HKY20F	2.0
2570N	●	25	7	16	150	20	20	—	A	C	C	—	HKY20F	2.0
NEW 2580N	●	25	8	17	150	20	20	—	A	B	B	—	HKY20F	2.0
RBH25420N	●	25.4	2	11	150	10	—	—	A	B	—	—	HKY20F	2.0
25430N	●	25.4	3	12	150	10	10	—	A	B	C	—	HKY20F	2.0
25440N	●	25.4	4	13	150	15	15	—	A	C	C	—	HKY20F	2.0
25450N	●	25.4	5	14	150	15	15	—	A	C	C	—	HKY20F	2.0
25460N	●	25.4	6	15	150	15	15	—	A	C	C	—	HKY20F	2.0
25470N	●	25.4	7	16	150	20	20	—	A	C	C	—	HKY20F	2.0
NEW 25480N	●	25.4	8	17	150	20	20	—	A	B	B	—	HKY20F	2.0

*1 Order number of clamp screw A=HSS04004, B=HSS04006, C=HSS04008, D=HSS04003 *2 Revised order number

Conventional order number	Revised order number	Conventional order number	Revised order number	Conventional order number	Revised order number
RBH1920N	RBH19020N	RBH1940N	RBH19040N	RBH1960N	RBH19060N
1930N	19030N	1950N	19050N	1970N	19070N

MICRO-MINI TWIN

Square Holder

CB type (Boring bar with holder)

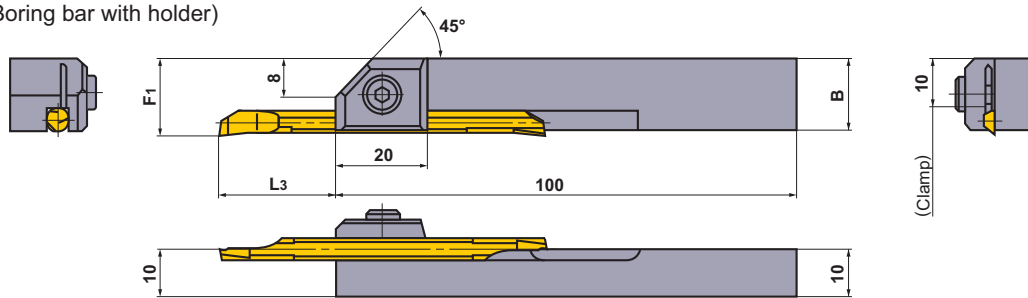

CG type (Boring bar with holder)

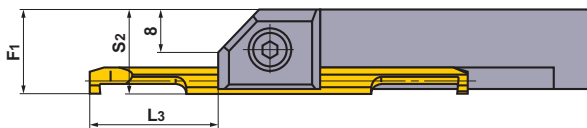

CT type (Boring bar with holder)

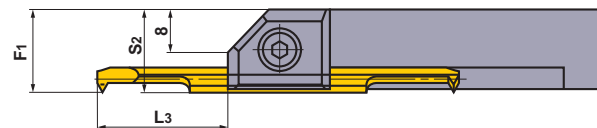

CR type (Boring bar with holder)

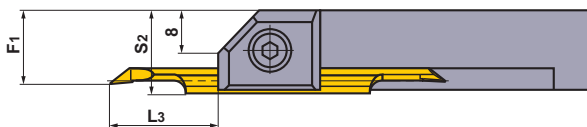

Order Number	Stock	Dimensions (mm)														Clamp Screw	Wrench	Torque (N/m)	
		F1				Maximum Tool Overhang L3 (Recommended tool overhang when machining general steels)					S2	B	Micro-Mini Twin						
		CB	CG	CT	CR	CB	CG..RS-10 CG..RS-10B	CG..RS-20 CG..RS-20B	CT	CR			CG CT CR	CB CG CT CR	CB				CG
SBH1020R	●	13	—	—	—	6—24 (6—10)	—	—	—	—	—	12.9	02RS 02RS-B	—	—	—	HSC 04010	HKY 30R	4.8
1030R	●	14	13.8	13.8	12.65	8.5—22 (9—15)	13—17.5 (14)	14—16.5 (15)	13—17.5 (14)	11—19.5 (12)	14	13.8	03RS 03RS-B	03RS-00 03RS-00B	03RS-M4 03RS-M4B	03RS-01 03RS-01B	HSC 05012	HKY 40R	9.5
1040R	●	15	14.8	14.8	13.15	11—29.5 (12—20)	18—22.5 (19)	19—21.5 (20)	18.5—22 (19.5)	13—27.5 (14)	15	14.7	04RS 04RS-B	04RS-00 04RS-00B	04RS-M6 04RS-M6B	04RS-01 04RS-01B	HSC 05012	HKY 40R	9.5
1050R	●	16	15.8	15.8	13.65	13.5—37 (15—25)	23—27.5 (24)	24—26.5 (25)	24—26.5 (25)	15—35.5 (16)	16	15.6	05RS 05RS-B	05RS-00 05RS-00B	05RS-M8 05RS-M8B	05RS-01 05RS-01B	HSC 05012	HKY 40R	9.5
1060R	●	—	16.8	16.8	—	—	23—32.5 (24)	24—31.5 (25)	24—31.5 (25)	—	17	16.5	—	06RS-00 06RS-00B	06RS-M10 06RS-M10B	—	HSC 05012	HKY 40R	9.5
1070R	●	—	17.8	—	—	—	28—38 (29)	29—37 (30)	—	—	18	17.4	—	07RS-00 07RS-00B	—	—	HSC 05012	HKY 40R	9.5

* The MICRO-DEX and MICRO-MINI cannot be fitted to square holders.

● : Inventory maintained.

For Your Safety

- Don't handle inserts and chips without gloves.
- Please machine within the recommended application range and exchange expired tools with new ones in advance of breakage.
- Please use safety covers and wear safety glasses.
- When using compounded cutting oils, please take fire precautions.
- When attaching inserts or spare parts, please use only the correct wrench or spanner.
- Grinding or heating of cutting tools produces dust and mist. Inhaling large amount of dust or contacting with eyes and skins may harm your body.

MITSUBISHI MATERIALS CORPORATION



The Scope of the Registration:
Design, Development, and
Production of Cemented
Carbide Tools and Carbide
Blanks



The Scope of the Registration:
Design, Development and
Production of Cutting Tools,
Wear-resistant Tools, Rock
Drilling Tools, Cemented
Carbide Blanks and Coated
Products



JAB
EMC Approval
REC

MITSUBISHI MATERIALS CORPORATION

Area Marketing & Operations Dept.

KFC bldg., 8F, 1-6-1, Yokoami, Sumida-ku, Tokyo 130-0015, Japan
TEL +81-3-5819-8772 FAX +81-3-5819-8774

MMC HARTMETALL GmbH

Comeniusstr.2, 40670, Meerbusch GERMANY
TEL +49-2159-9189-0 FAX +49-2159-918966

MITSUBISHI MATERIALS U.S.A. CORPORATION

Headquarters

17401, Eastman Street, Irvine, California, 92614, USA
TEL +1-949-862-5100 FAX +1-949-862-5180

MMC METAL SINGAPORE PTE LTD.

10, Arumugam Road, #04-00 Lion Industrial Bldg., 409957, SINGAPORE
TEL +65-6743-9370 FAX +65-6749-1469

Mitsubishi Carbide Home page : <http://www.mitsubishicarbide.com>

(Tools specifications subject to change without notice.)