



Web Slings & Round Slings



DISTRIBUTED BY : TEMTON CO.,LTD.

www.temton.co.th

TEMTON
TEMTON CO., LTD.



Technotex is a manufacture company of a complete range of polyester webbing slings for all lifting and lashing applications, which includes our Techlon, Heavy Duty and Multicode round and flat webbing slings, and associated products. Our high quality products are manufactured in accordance with the latest European and International standards.



Technotex Industrial Supply is a member of an international organisation "Unitex group of Companies" with manufacturing operations throughout Europe and Far East, and it provides business-to-business services to industries worldwide. We welcome the opportunity of being of service to you and we confirm our Q.A. approved accreditation with A.I.B. Vincotte Belgium. All Technotex products fully comply with current European and International standards, as specified by the latest EN 1492-1 for flat webbing, EN 1492-2 for all round slings and EN 12195-2 for the lashingsystems. We also conform to Machinery Directives 98/37/EG (last amendment 98/79/EG). Meanwhile, we aspire to become a preferred supplier to your organisation. Should you require any further information, please do not hesitate to contact our company or our distribution network, where our skilled technical and sales staff will be only too pleased to help fulfil your requirements.

1. EN-Standards and Machinery Directives

For all European manufacturers are the technical demands and the references how to produce textile lifting equipment like roundslings and webslings summarized in the EN 1492-1 (Webslings) and the EN 1492-2 (Roundslings). Additionally the textile lifting equipment is encoded with the CE mark according to the Machinery Directive 2006/42/EG



2. Testing and Maintenance

To guarantee a safe way of using the textile lifting equipment they must be tested at least one time per year or according to the latest publications of the standard or local guidelines. The operator of the equipment has to arrange independently of predetermining operation conditions several test intervals.

These tests may only be done by competent persons. Possible damaged Roundslings/Webslings may only be repaired by the manufacturer or by people who have become the power of attorney to repair from the manufacturer.

To guarantee the quality of our products the standard Webslings and Roundslings are being certified by the AIB Vinçotte (VGS), Berufsgenossenschaft (GS) or Lloyds.



3. Lifting of loads (WLL Capacity table and lifting angle)

If a load with a certain weight has to be lifted, the person who has to coordinate this job has to make sure the correct lifting materials are chosen.

Also the number of slings, the capacity and the length has to be defined. It is also to plan the lifting procedure and to make sure that the angle of inclination is not more than 60 degrees (an angle of more than 60 degrees is forbidden!)

The bigger the angle of inclination, the smaller the practical capacity of the lifting equipment.

As a simple rule you can say:

By an angle of inclination up to 45 degrees the chosen lifting equipment can be calculated with only 70% of the original capacity. For example:

$$70\% \text{ of } 2T = 0,7 \times 2T = 1,4T$$

By an angle of inclination up to 60 degrees the chosen lifting equipment can be calculated with only 50% of the original capacity. For example:

$$50\% \text{ of } 2T = 0,5 \times 2T = 1,0T$$

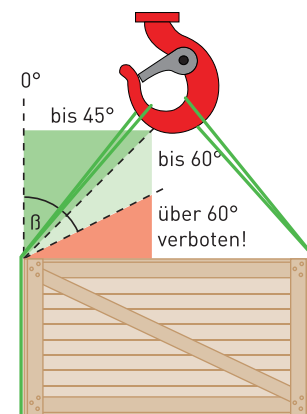

Overview of the lifting band shapes and -versions according to DIN EN 1492-1

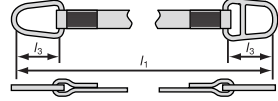
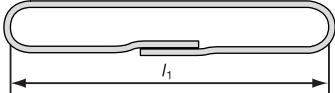
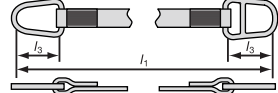
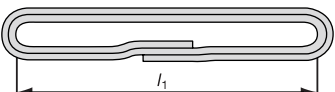
| FORM | A continuous MDEE , MCDD | C + CR - Flat websling with fittings MCDD, MCDDS |
|---------------------------------|---|---|
| Load bearing fittings | |  |
| Load-bearing parts (simple) | | Single ply websling with fittings MCDD, C1 / Cr1  |
| Load-bearing parts (two times) | Single ply websling MCEE A2  | Two-ply websling with fittings MCDDS, C2 / Cr2  |
| Load-bearing parts (four times) | Two-ply websling sling MCED A4  | |

4. Way of use and handling

The European Norm has given each capacity in the EN 1492/1-2 a specific colour. This to identify the capacity of webslings and roundslings easily and clearly

- WLL 1,0 t
- WLL 2,0 t
- WLL 3,0 t
- WLL 4,0 t
- WLL 5,0 t
- WLL 6,0 t
- WLL 8,0 t
- WLL 10,0 t and >10 t



To make sure the stitching of the eye of a websling wont break open, the angle of opened eye of the websling shouldn't be more than 20 degrees when it is put into a cranehook

The following rule has to be followed:

You are on the safe side as the eye of the websling at least 3,5 x as long is as the thickness of the cranehook

$$L2 \geq b \times 3,5$$

Be careful: sharp edges will not only damage lifting equipment, but can also lead to accidents

For this reason:

The corner radius ,r' must always be bigger than the strength ,d' of the lifting equipment If loads with sharp edges have to be lifted corner protection definitely has to be used. For example Purtecta or Ultra Protect corner protection solutions from Unitex.

Warnung : Due to slipping of the load, both corner protection systems, Purtecta and Ultra Protect, can be damaged

Lifting equipment made of polyester fibres with their marked capacity can be used in temperatures between -40 degrees and +100 degrees C.

If they are being used in connection with chemicals it is absolutely necessary to contact the manufacturer beforehand for permission.

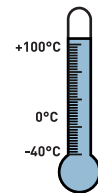
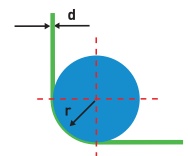
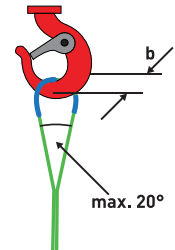

WARNING: Lifting straps and slings



Nodes are prohibited.



When the influence of chemicals is, consultation with the supplier.



Weight lifting of good control on overload! Consider gravity of the load.



Damaged slings and lifting slings store and replace.

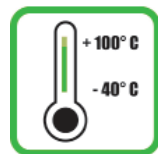

Respect to temperature range (- 40 ° to + 100 ° C)



Protect slings and lifting slings from sharp edges.



Rebate and consider inclination angle.



Round slings never put on the top of the crane hook!

LIFTING BELTS AND ROUND SLINGS BEFORE USE ALWAYS ON DAMAGE KONTROLIEREN!

Differences and characteristics of different types of hoses

| TYPE | ULTRALIFT | TLX | DT | TE |
|---------------------|---------------------------------------|---------------|---------------|----------------|
| Material | Dyneema® | Polyester | Polyester | Polyester |
| Tissue | specialy strengthened mesh | Reinforced | double hose | easily |
| Abrasion resistance | ++++ | ++ | -/+ | -/+ |
| Cut resistance | ++++ | ++ | -/+ | -/+ |
| Temperature range | -60° to 70°C | -40° to 100°C | -40° to 100°C | -40° bis 100°C |
| Acids | ++ | ++ | ++ | ++ |
| Alkali | ++ | - | - | - |
| Micro organism | ++++ | ++ | ++ | ++ |
| UV resistance | ++++ | ++ | ++ | ++ |
| Assortment | "2 and 180 t only with core Dyneema®" | 1 and 150 t | 1 and 10 t | 1 and 10 t |

Webbing and Roundslings and Ultra Lift made with Dyneema® Polyester

Load carrying capacity for webbing slings and round slings and Ultra Lift made with Dyneema® Polyester

| Lifting slings and Round Slings | Ultra Lift Round slings Dyneema® fibers | Working Load Limits with 1 webbing sling or round sling | | | | | | Working Load Limits with 2 webbing slings or round slings | | | | | |
|--------------------------------------|---|---|-------------|-------|--------|---------|--------|---|--------|---------|--------|---------|-----|
| | | Straight lift | Choked lift | *β | | *β | | *β | | *β | | *β | |
| | | | | 0°-7° | 7°-45° | 45°-60° | 7°-45° | 45°-60° | 7°-45° | 45°-60° | 7°-45° | 45°-60° | |
| Colour code according to EN 1492-1/2 | Color loop Dynema uniformly white | Factor | 1 | 0,8 | 2 | 1,4 | 1 | 0,7 | 0,5 | 1,4 | 1 | 1,12 | 0,8 |
| WLL 1 t | ----- | | 1 | 0,8 | 2 | 1,4 | 1 | 0,7 | 0,5 | 1,4 | 1 | 1,12 | 0,8 |
| WLL 2 t | WLL 2 t | | 2 | 1,6 | 4 | 2,8 | 2 | 1,4 | 1 | 2,8 | 2 | 2,24 | 1,6 |
| WLL 3 t | WLL 3 t | | 3 | 2,4 | 6 | 4,2 | 3 | 2,1 | 1,5 | 4,2 | 3 | 3,36 | 2,4 |
| WLL 4 t | WLL 4 t | | 4 | 3,2 | 8 | 5,6 | 4 | 2,8 | 2 | 5,6 | 4 | 4,48 | 3,2 |
| WLL 5 t | WLL 5 t | | 5 | 4 | 10 | 7 | 5 | 3,5 | 2,5 | 7 | 5 | 5,6 | 4 |
| WLL 6 t | WLL 6 t | | 6 | 4,8 | 12 | 8,4 | 6 | 4,2 | 3 | 8,4 | 6 | 6,72 | 4,8 |
| WLL 8 t | WLL 8 t | | 8 | 6,4 | 16 | 11,2 | 8 | 5,6 | 4 | 11,2 | 8 | 8,96 | 6,4 |
| WLL 10 t | WLL 10 t | | 10 | 8 | 20 | 14 | 10 | 7 | 5 | 14 | 10 | 11,2 | 8 |
| WLL 12 t | WLL 12 t | | 12 | 9,6 | 24 | 16,8 | 12 | 8,4 | 6 | 16,8 | 12 | 13,44 | 9,6 |
| WLL 15 t | WLL 15 t | | 15 | 12 | 30 | 21 | 15 | 10,5 | 7,5 | 21 | 15 | 16,8 | 12 |
| WLL 20 t | WLL 20 t | | 20 | 16 | 40 | 28 | 20 | 14 | 10 | 28 | 20 | 22,4 | 16 |
| WLL 25 t | WLL 25 t | | 25 | 20 | 50 | 35 | 25 | 17,5 | 12,5 | 35 | 25 | 28 | 20 |
| WLL 30 t | WLL 30 t | | 30 | 24 | 60 | 42 | 30 | 21 | 15 | 42 | 30 | 33,6 | 24 |
| WLL 40 t | WLL 40 t | | 40 | 32 | 80 | 56 | 40 | 28 | 20 | 56 | 40 | 44,8 | 32 |
| WLL 50 t | WLL 50 t | | 50 | 40 | 100 | 70 | 50 | 35 | 25 | 70 | 50 | 56 | 40 |
| WLL 60 t | WLL 60 t | | 60 | 48 | 120 | 84 | 60 | 42 | 30 | 84 | 60 | 67,2 | 48 |
| WLL 70 t | WLL 70 t | | 70 | 56 | 140 | 98 | 70 | 49 | 35 | 98 | 70 | 78,4 | 56 |
| WLL 80 t | WLL 80 t | | 80 | 64 | 160 | 112 | 80 | 56 | 40 | 112 | 80 | 89,6 | 64 |
| WLL 90 t | WLL 90 t | | 90 | 72 | 180 | 126 | 90 | 63 | 45 | 126 | 90 | 100,8 | 72 |
| WLL 100 t | WLL 100 t | | 100 | 80 | 200 | 140 | 100 | 70 | 50 | 140 | 100 | 112 | 80 |
| WLL 120 t | WLL 120 t | | 120 | 96 | 240 | 168 | 120 | 84 | 60 | 168 | 120 | 134,4 | 96 |
| ----- | WLL 140 t | | 140 | 112 | 280 | 196 | 140 | 98 | 70 | 196 | 140 | 156,8 | 112 |
| WLL 150 t | ----- | | 150 | 120 | 300 | 210 | 150 | 105 | 75 | 210 | 150 | 168 | 120 |
| ----- | WLL 160 t | | 160 | 128 | 320 | 224 | 160 | 112 | 80 | 224 | 160 | 179,2 | 128 |
| ----- | WLL 180 t | | 180 | 144 | 360 | 252 | 180 | 126 | 90 | 252 | 180 | 201,6 | 144 |
| ----- | WLL 200 t | | 200 | 160 | 400 | 280 | 200 | 140 | 100 | 280 | 200 | 224 | 160 |

**This table shows the carrying capacities of under normal conditions of use.

The advantage Eder Ultra Lift-round slings

- Low dead weight of the loops over polyester round slings (2.5x lighter than PES) and wire ropes (up to 8x easier).
- Extremely High abrasion resistance and significantly longer lifetime when properly used.
- Low Expansion of the loops (like steel).
- The low stretch very precise strokes are possible without Nachpendeln the load.
- Bessere Review of loops on rope discard, wire ropes or chains than.
- Etc. No formation of wire breaks, Latches, Klanken
- Cost savings through quick handling.
- Low risk of injury.

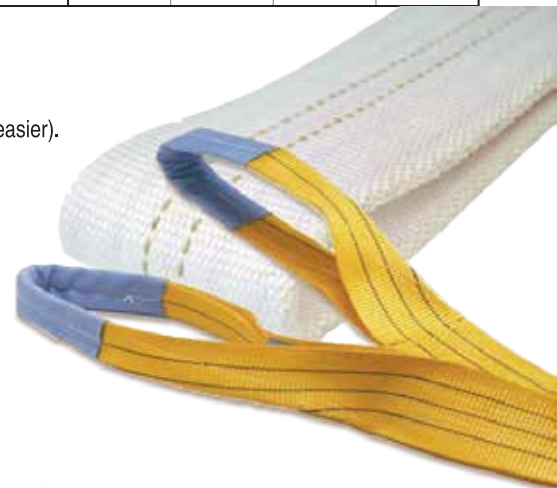

TYPE MC WEB SLINGS 2-LAYER • according to DIN EN 1492-1

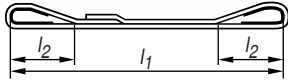

Fully Reinforced crane straps are available on request.

| Type | WLL | Webbing width (mm) | Thickness (mm) | Eye length effective length mm (L2) | | | Standard eye type | Weight kg L (1) | | | Weight each meter extra |
|-------|----------|--------------------|----------------|-------------------------------------|-----|------|-------------------|-----------------|------|------|-------------------------|
| | | | | 1 m | 2 m | 3 m | | 1 m | 2 m | 3 m | |
| MC30 | WLL 1 t | 30 | 7 | 250 | 400 | | type 1 | 0,25 | 0,45 | 0,65 | 0,20 |
| MC60 | WLL 2 t | 60 | 6 | 250 | 400 | | type 3 | 0,44 | 0,79 | 1,14 | 0,35 |
| MC90 | WLL 3 t | 90 | 7,5 | 250 | 400 | | type 3 | 0,71 | 1,25 | 1,80 | 0,55 |
| MC120 | WLL 4 t | 120 | 8 | | 450 | | type 4 | | 1,67 | 2,40 | 0,73 |
| MC150 | WLL 5 t | 150 | 7 | | 550 | | type 4 | | 2,12 | 3,06 | 0,94 |
| MC180 | WLL 6 t | 180 | 7 | | 600 | | type 4 | | 2,95 | 4,14 | 1,20 |
| MC240 | WLL 8 t | 240 | 8 | | | 750 | type 4 | | | 5,25 | 1,50 |
| MC300 | WLL 10 t | 300 | 7 | | | 1000 | type 4 | | | 6,85 | 1,97 |
| MC300 | WLL 12 t | 300 | 8 | | | 1000 | type 4 | | | 8,35 | 2,36 |

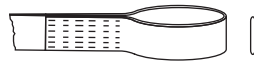

Type 1 : Flat eye

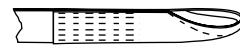

Type 3 : Folded eye 1/2 width from one side



Type 5 : Folded eye 1/3 width



Type 2 : Reversed eye

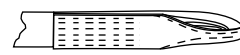

Type 4 : Folded eye 1/2 width from two sides

MCEE / MCED endless web slings

MCEE ENDLESS WEB SLINGS 1 LAYER • DIN EN 1492-1

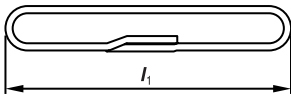

| Type | WLL | Webbing width (mm) | Thickness (mm) | Weight kg (L1) | | Weight 0,5 meter extra (kg) |
|---------|----------|--------------------|----------------|----------------|------|-----------------------------|
| | | | | 0,5 m | 1 m | |
| MCEE30 | WLL 1 t | 30 | 3,5 | 0,12 | 0,21 | 0,09 |
| MCEE60 | WLL 2 t | 60 | 3 | 0,21 | 0,38 | 0,17 |
| MCEE90 | WLL 3 t | 90 | 4 | 0,34 | 0,60 | 0,26 |
| MCEE120 | WLL 4 t | 120 | 4 | | 0,82 | 0,35 |
| MCEE150 | WLL 5 t | 150 | 3,5 | | 1,06 | 0,45 |
| MCEE180 | WLL 6 t | 180 | 3,5 | | 1,45 | 0,58 |
| MCEE240 | WLL 8 t | 240 | 4 | | 1,84 | 0,72 |
| MCEE300 | WLL 10 t | 300 | 3,5 | | 2,47 | 0,95 |
| MCEE300 | WLL 12 t | 300 | 4 | | 3,14 | 1,14 |

MCED ENDLESS WEB SLINGS 2-LAYER • DIN EN 1492-1

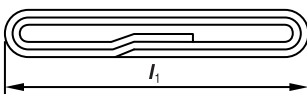

| Type | WLL | Webbing width (mm) | Thickness (mm) | Weight kg (L1) | | Weight 0,5 meter extra (kg) |
|---------|----------|--------------------|----------------|----------------|------|-----------------------------|
| | | | | 0,5 m | 1 m | |
| MCED30 | WLL 2 t | 30 | 7 | 0,22 | 0,41 | 0,19 |
| MCED60 | WLL 4 t | 60 | 6 | 0,39 | 0,73 | 0,34 |
| MCED90 | WLL 6 t | 90 | 7,5 | 0,62 | 1,16 | 0,54 |
| MCED120 | WLL 8 t | 120 | 8 | | 1,57 | 0,72 |
| MCED150 | WLL 10 t | 150 | 7 | | 2,02 | 0,93 |
| MCED180 | WLL 12 t | 180 | 7 | | 2,69 | 1,19 |
| MCED240 | WLL 16 t | 240 | 8 | | 3,37 | 1,48 |
| MCED300 | WLL 20 t | 300 | 7 | | 4,5 | 1,96 |
| MCED300 | WLL 24 t | 300 | 8 | | 5,58 | 2,35 |

MCDD / MCDDS web slings with triangles



MCDD 2-LAYER WEB SLINGS WITH TRIANGLES (MALE/MALE)

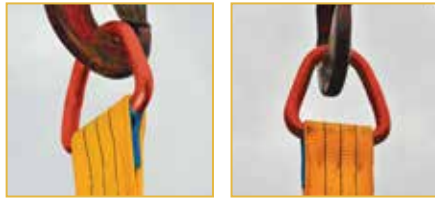

| Type | WLL | Webbing width (mm) | Thickness (mm) | Weight kg (L1) | | | Weight 1 meter extra (kg) |
|---------|----------|--------------------|----------------|----------------|------|-------|---------------------------|
| | | | | 1 m | 2 m | 3 m | |
| MCDD30 | WLL 1 t | 30 | 7 | 0,62 | 0,82 | 1,02 | 0,20 |
| MCDD60 | WLL 2 t | 60 | 6 | 1,39 | 1,74 | 2,09 | 0,35 |
| MCDD90 | WLL 3 t | 90 | 7,5 | 2,78 | 3,33 | 3,88 | 0,55 |
| MCDD120 | WLL 4 t | 120 | 8 | | 4,68 | 5,41 | 0,73 |
| MCDD150 | WLL 5 t | 150 | 7 | | 6,19 | 7,13 | 0,94 |
| MCDD180 | WLL 6 t | 180 | 7 | | 8,51 | 9,71 | 1,20 |
| MCDD240 | WLL 8 t | 240 | 8 | | | 16,24 | 1,50 |
| MCDD300 | WLL 10 t | 300 | 7 | | | 21,68 | 1,97 |
| MCDD300 | WLL 12 t | 300 | 8 | | | 22,97 | 2,36 |

MCDDS 2-LAYER WEB SLINGS WITH TRIANGLES (MALE/FEMALE)



| Type | WLL | Webbing width (mm) | Thickness (mm) | Weight kg (L1) | | | Weight 1 meter extra (kg) |
|----------|----------|--------------------|----------------|----------------|-------|-------|---------------------------|
| | | | | 1 m | 2 m | 3 m | |
| MCDDS30 | WLL 1 t | 30 | 7 | 0,82 | 1,02 | 1,22 | 0,20 |
| MCDDS60 | WLL 2 t | 60 | 6 | 1,86 | 2,21 | 2,56 | 0,35 |
| MCDDS90 | WLL 3 t | 90 | 7,5 | 3,63 | 4,21 | 4,76 | 0,55 |
| MCDDS120 | WLL 4 t | 120 | 8 | | 6,11 | 6,84 | 0,73 |
| MCDDS150 | WLL 5 t | 150 | 7 | | 8,90 | 9,84 | 0,94 |
| MCDDS180 | WLL 6 t | 180 | 7 | | 10,79 | 11,99 | 1,20 |
| MCDDS240 | WLL 8 t | 240 | 8 | | | 20,45 | 1,50 |
| MCDDS300 | WLL 10 t | 300 | 7 | | | 27,31 | 1,97 |

MCDD and MCDDS • TRIANGLES SPECIFICATIONS

Male Triangles

| Type | WLL | Width (mm) | Q (mm) | D (mm) | H (mm) | E (mm) | Weight per Piece (kg) |
|---------|----------|------------|--------|--------|--------|--------|-----------------------|
| DTR/010 | WLL 1 t | 30 | 12 | 45 | 60 | 70 | 0,2 |
| DTR/020 | WLL 2 t | 60 | 16 | 30 | 80 | 100 | 0,5 |
| DTR/030 | WLL 3 t | 90-100 | 20 | 60 | 120 | 146 | 1,1 |
| DTR/040 | WLL 4 t | 120 | 23 | 60 | 130 | 179 | 1,6 |
| DTR/050 | WLL 5 t | 150 | 26 | 90 | 180 | 222 | 2,2 |
| DTR/060 | WLL 6 t | 180 | 28 | 90 | 180 | 262 | 3 |
| DTR/080 | WLL 8 t | 240 | 32 | 100 | 200 | 344 | 5,8 |
| DTR/100 | WLL 10 t | 300 | 35 | 100 | 250 | 400 | 7,9 |

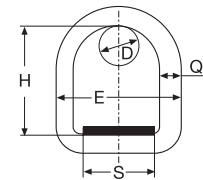

DTR/010

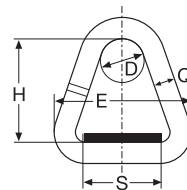

DTR/020 to DTR/100

FEMale Triangles

| Type | WLL | Width (mm) | Q (mm) | D (mm) | H (mm) | P (mm) | Weight per Piece (kg) |
|----------|----------|------------|--------|--------|--------|--------|-----------------------|
| DSTR/010 | WLL 1 t | 30 | 12 | 50 | 100 | 25 | 0,4 |
| DSTR/020 | WLL 2 t | 60 | 16 | 40 | 146 | 40 | 1 |
| DSTR/030 | WLL 3 t | 90-100 | 20 | 70 | 205 | 55 | 2 |
| DSTR/040 | WLL 4 t | 120 | 23 | 80 | 218 | 55 | 3,1 |
| DSTR/050 | WLL 5 t | 150 | 26 | 90 | 300 | 80 | 5 |
| DSTR/060 | WLL 6 t | 180 | 28 | 90 | 284 | 80 | 5,4 |
| DSTR/080 | WLL 8 t | 240 | 32 | 120 | 332 | 90 | 10,2 |
| DSTR/100 | WLL 10 t | 300 | 35 | 120 | 385 | 100 | 13,8 |

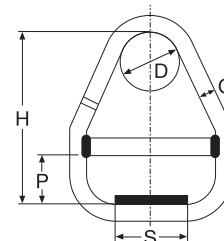

DSTR/010 to DSTR/100

TDQ • 4- LAYER WEB SLINGS



Material : TDQ web slings are built up out of 4-layers polyester (PES) and are available as three versions: TDQ web slings are made out 100% polyester. The TDQDD and TDQDDS are manufactured with steel triangles (grade 80).

Properties:

Fysical properties

| | | |
|-----------------------------|---|----------------|
| Specific Gravity (g/cm3) | : | 1,38 |
| Elongation at WLL (in %) | : | 3-4 |
| Usable at temperature | : | -40°C - +100°C |
| Moisture regain % | : | < 0,5 |
| Resistance to mineral Acid* | : | Good |
| Resistance to Alkalis* | : | Poor |

* Always consult the producer.

Application:

TDQ web slings are for general use for lifting loads from WLL 2 ton up to 40 ton. (straight lift). The width of the webbing sling contributes to a stable and safe lift. For special applications where the standard assortment does not fit, Technotex Industrial Supply can offer custom made solutions. For the standard assortment we refer to the enclosed product sheets.

Standards:

- TDQ web slings comply with the Machinery Directive 2006/42/EG
- TDQ web slings have a CE-mark, according to the Machinery Directive requirements. (Europe).
- Techlon web slings comply with NEN-EN 1492-2 (europe), BS 3481/part2-1983 safety factor 6:1 (Middle East, asia), as 4497.1-1997 (Australia), OSHA/ASME B30.9 (USA)

LIFTING STRAPS with LOOP TYPE TDQ • 4-LAYER WEB SLING • according to DIN EN 1492-1



Fully Reinforced crane straps are available on request.

| Type | WLL | Webbing width (mm) | min. L1 m | Standard Eye Type | Loop length approx. (mm) | loop width approx. (mm) |
|---------|----------|--------------------|-----------|-------------------|--------------------------|-------------------------|
| TDQ 030 | WLL 2 t | 30 | 1 | Type 1 | 350 | 30 |
| TDQ 060 | WLL 4 t | 60 | 1,30 | Type 3 | 400 | 50 |
| TDQ 090 | WLL 6 t | 90 | 1,60 | Type 3 | 500 | 60 |
| TDQ 120 | WLL 8 t | 120 | 2 | Type 3 | 600 | 70 |
| TDQ 150 | WLL 10 t | 150 | 2,20 | Type 4 | 700 | 85 |
| TDQ 180 | WLL 12 t | 180 | 2,50 | Type 4 | 800 | 100 |

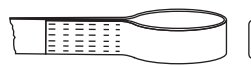

Type 1 : Flat loop

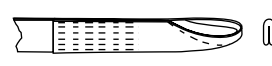

Type 3 : Folded eye 1/2 width from one side

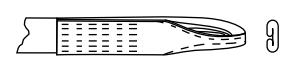

Type 4 : Folded eye 1/2 width from two sides

WEIGHT of TYPE TDQ • 4- LAYER WEB SLINGS

| Type | TDQ | | | | | | |
|----------------------|--------|---------|--------|---------|---------|---------|---------|
| | TDQ150 | TDQ180 | TDQ240 | TDQ300 | TDQH300 | TDQ500 | TDQ600 |
| WLL | 10 t | 12 t | 15 t | 20 t | 25 t | 30 t | 40 t |
| Eye width | 80 mm | 95/105 | 125 mm | 160 mm | 160 mm | 260 mm | 310 mm |
| Eye length | 650 mm | 700 mm | 850 mm | 1100 mm | 1200 mm | 1500 mm | 1500 mm |
| Webbing width | 150 mm | 180/200 | 240 mm | 300 mm | 300 mm | 500 mm | 600 mm |
| EWL in mtr | kg | | | | | | |
| 4 | 7,7 | 10,1 | 12,4 | 16,3 | 19,6 | 26,5 | 41,0 |
| 5 | 9,6 | 12,5 | 15,4 | 20,3 | 24,3 | 32,9 | 50,8 |
| 6 | 11,4 | 14,9 | 18,3 | 24,2 | 29,0 | 39,2 | 60,6 |
| 7 | 13,3 | 17,3 | 21,3 | 28,1 | 33,7 | 45,6 | 70,4 |
| 8 | 15,1 | 19,7 | 24,3 | 32,0 | 38,4 | 52,0 | 80,2 |
| 9 | 17,0 | 22,1 | 27,2 | 35,9 | 43,1 | 58,4 | 90,1 |
| 10 | 18,8 | 24,5 | 30,2 | 39,8 | 47,8 | 64,7 | 99,9 |
| 11 | 20,7 | 26,9 | 33,2 | 43,7 | 52,5 | 71,1 | 109,7 |
| 12 | 22,5 | 29,3 | 36,1 | 47,6 | 57,2 | 77,5 | 119,5 |
| More weight per m NL | 1,9 | 2,4 | 3,0 | 3,9 | 4,7 | 6,4 | 9,8 |

* Other lengths are available on request.

WEIGHT of TYPE TDQDD and TDQDDS • 4-LAYER WEB SLING with TRIANGLES

| Type | TDQDD | | | | |
|--------------------------------|----------|----------|----------|----------|-----------|
| | TDQDD150 | TDQDD180 | TDQDD240 | TDQDD300 | TDQHDD300 |
| WLL | 10 t | 12 t | 15 t | 20 t | 25 t |
| Webbing width (mm) | 150 | 180/200 | 240 | 300 | 300 |
| Weight Triangle | 12,6 | 15,6 | 28,8 | 47,8 | 47,8 |
| EWL in mtr | kg | | | | |
| 4 | 20,3 | 25,7 | 41,2 | 64,1 | 67,4 |
| 5 | 22,2 | 28,1 | 44,2 | 68,1 | 72,1 |
| 6 | 24,0 | 30,5 | 47,1 | 72,0 | 76,8 |
| 7 | 25,9 | 32,9 | 50,1 | 75,9 | 81,5 |
| 8 | 27,7 | 35,3 | 53,1 | 79,8 | 86,2 |
| 9 | 29,6 | 37,7 | 56,0 | 83,7 | 90,9 |
| 10 | 31,4 | 40,1 | 59,0 | 87,6 | 95,6 |
| 11 | 33,3 | 42,5 | 62,0 | 91,5 | 100,3 |
| 12 | 35,1 | 44,9 | 64,9 | 95,4 | 105 |
| 13 | 37 | 47,3 | 67,9 | 99,3 | 109,7 |
| 14 | 38,8 | 49,7 | 70,9 | 103,2 | 114,4 |
| 15 | 40,7 | 52,1 | 73,9 | 107,2 | 119,1 |
| 16 | 42,5 | 54,5 | 76,8 | 111,1 | 123,8 |
| 17 | 44,4 | 56,9 | 79,8 | 115 | 128,5 |
| 18 | 46,2 | 59,3 | 82,8 | 118,9 | 133,2 |
| 19 | 48,1 | 61,7 | 85,7 | 122,8 | 137,9 |
| 20 | 49,9 | 64,1 | 88,7 | 126,7 | 142,6 |
| Extra per mtr. working length* | 1,8 | 2,4 | 2,9 | 3,9 | 4,7 |

| TDQDDS | | | | |
|-----------|-----------|-----------|-----------|------------|
| TDQDDS150 | TDQDDS180 | TDQDDS240 | TDQDDS300 | TDQHDDS300 |
| 10 t | 12 t | 15 t | 20 t | 25 t |
| 150 | 180 | 240 | 300 | 300 |
| 19,3 | 30 | 41,6 | 71,4 | 71,4 |
| 27 | 33,4 | 54 | 87,7 | 91 |
| 28,9 | 35,8 | 57 | 91,7 | 95,7 |
| 30,7 | 38,2 | 59,9 | 95,6 | 100,4 |
| 32,6 | 40,6 | 62,9 | 99,5 | 105,1 |
| 34,4 | 43 | 65,9 | 103,4 | 109,8 |
| 36,3 | 45,4 | 68,8 | 107,3 | 114,5 |
| 38,1 | 47,8 | 71,8 | 111,2 | 119,2 |
| 40 | 50,2 | 74,8 | 115,1 | 123,9 |
| 41,8 | 52,6 | 77,7 | 119 | 128,6 |
| 43,7 | 55 | 80,7 | 122,9 | 133,3 |
| 45,5 | 57,4 | 83,7 | 126,8 | 138 |
| 47,4 | 59,8 | 86,7 | 130,8 | 142,7 |
| 49,2 | 62,2 | 89,6 | 134,7 | 147,4 |
| 51,1 | 64,6 | 92,6 | 138,6 | 152,1 |
| 52,9 | 67 | 95,6 | 142,5 | 156,8 |
| 54,8 | 69,4 | 98,5 | 146,4 | 161,5 |
| 56,6 | 71,8 | 101,5 | 150,3 | 166,2 |
| 1,9 | 2,4 | 3 | 3,9 | 4,7 |

*Other lengths are available on request.

TRIANGLE Type TDQDD SPECIFICATIONS

| Type | WLL | S (mm) | Q (mm) | D (mm) | H (mm) | E (mm) | Weight (kg) |
|--------|----------|--------|--------|--------|--------|--------|-------------|
| DTR/10 | WLL 10 t | 180 | 35 | 100 | 200 | 320 | 6,3 |
| DTR/12 | WLL 12 t | 170 | 40 | 90 | 200 | 290 | 7,8 |
| DTR/15 | WLL 15 t | 300 | 45 | 150 | 250 | 440 | 14,4 |
| DTR/20 | WLL 20 t | 300 | 50 | 180 | 300 | 460 | 19 |
| DTR/25 | WLL 25 t | 300 | 55 | 180 | 300 | 492 | 23,9 |
| DTR/30 | WLL 30 t | 300 | 55 | 180 | 300 | 492 | 23,9 |

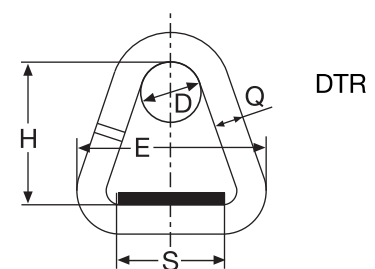

TRIANGLE Type TDQDDS SPECIFICATIONS

| Type | WLL | S (mm) | Q (mm) | D (mm) | H (mm) | P (mm) | Weight (kg) |
|---------|----------|--------|--------|--------|--------|--------|-------------|
| DSTR/10 | WLL 10 t | 180 | 35 | 100 | 340 | 100 | 13 |
| DSTR/12 | WLL 12 t | 170 | 40 | 100 | 340 | 100 | 15,5 |
| DSTR/15 | WLL 15 t | 250 | 45 | 150 | 466 | 120 | 27,2 |
| DSTR/20 | WLL 20 t | 300 | 50 | 180 | 540 | 150 | 26 |
| DSTR/25 | WLL 25 t | 300 | 55 | 180 | 540 | 150 | 47,5 |
| DSTR/30 | WLL 30 t | 300 | 55 | 180 | 540 | 150 | 47,5 |

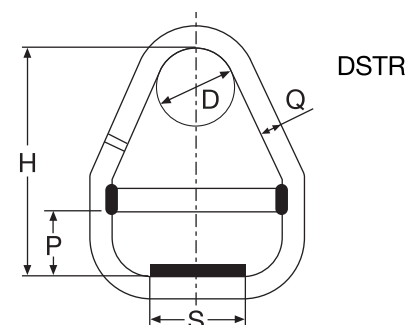

TE Round slings



TE ROUND SLINGS WITH SINGLE SLEEVE



| Type | WLL | Sleeve width (mm) | Round sling diameter | Weight of round sling 0,5 m effective length (kg) | Weight per 0,5 m extra (kg) |
|--------|----------|-------------------|----------------------|---|-----------------------------|
| TE 010 | WLL 1 t | 47 | 12 | 0,118 | 0,103 |
| TE 020 | WLL 2 t | 48 | 18 | 0,185 | 0,170 |
| TE 030 | WLL 3 t | 54 | 20 | 0,264 | 0,248 |
| TE 040 | WLL 4 t | 70 | 22 | 0,356 | 0,334 |
| TE 050 | WLL 5 t | 72 | 28 | 0,431 | 0,407 |
| TE 060 | WLL 6 t | 74 | 30 | 0,528 | 0,504 |
| TE 080 | WLL 8 t | 90 | 32 | 0,701 | 0,670 |
| TE 100 | WLL 10 t | 91 | 35 | 0,843 | 0,814 |

DT Round slings

DT ROUND SLINGS WITH DOUBLE SLEEVE



cross section of a DT roundsling sleeve



| Type | WLL | Sleeve width (mm) | Round sling diameter | Weight of round sling 0,5 m effective length (kg) | Weight per 0,5 m extra (kg) |
|--------|---------|-------------------|----------------------|---|-----------------------------|
| DT 010 | WLL 1 t | 42 | 12 | 0,143 | 0,121 |
| DT 020 | WLL 2 t | 47 | 18 | 0,213 | 0,190 |
| DT 030 | WLL 3 t | 58 | 20 | 0,314 | 0,284 |
| DT 040 | WLL 4 t | 66 | 22 | 0,392 | 0,360 |
| DT 050 | WLL 5 t | 72 | 28 | 0,478 | 0,441 |
| DT 060 | WLL 6 t | 77 | 30 | 0,586 | 0,546 |
| DT 080 | WLL 7 t | 82 | 32 | 0,737 | 0,696 |
| DT 100 | WLL 8 t | 94 | 35 | 0,907 | 0,860 |

TLX Round Slings with Techlon® Protective Sleeve Made of Polyester



Material: The construction of a sling is divided into the core and a protection sleeve. The core is made out of polyester (PES) fibres. The protection sleeve is made out of Techlon (PES). Due to the special rip and weave structure, Techlon is significantly more resistance to abrasion than standard polyester sleeve.

Physical properties

| | | |
|---------------------------------------|---|----------------|
| Specific Gravity (g/cm ³) | : | 1,38 |
| Elongation at WLL (in %) | : | 3 - 4 |
| Usable at temperature | : | -40°C - +100°C |
| Moisture regain % | : | < 0,5 |
| Resistance to mineral Acid* | : | Good |
| Resistance to Alkalis* | : | Poor |

* Always consult the producer.

Application: Techlon (TLX) round slings are for general use for lifting loads from WLL 1 ton up to 150 ton. (straight lift).

For the standard assortment we refer to the enclosed product sheets.

Standards:

- Techlon round slings comply with the Machinery Directive 2006/42/EG
- Techlon round slings have a CE-mark, according to the Machinery Directive requirements. (Europe).
- Techlon round slings comply with NEN-EN 1492-2 (Europe), BS 3481/part2-1983 safety factor 6:1 (middle east, Asia), AS 4497.1-1997 (Australia), OSHA /AS ME B30.9 (USA)

Type TLX Capacity of Premium Round Slings

| Type | TLX | | | | | | | | | | | | | | | | | | | |
|-------------------------------|--------|--------|--------|--------|--------|--------|--------|--------|--------|--------|--------|--------|--------|--------|--------|--------|--------|--------|--------|--------|
| | 120 | 150 | 200 | 250 | 300 | 350 | 400 | 450 | 500 | 550 | 600 | 650 | 700 | 750 | 800 | 850 | 900 | 950 | 1000 | 1200 |
| WLL | 12 t | 15 t | 20 t | 25 t | 30 t | 35 t | 40 t | 45 t | 50 t | 55 t | 60 t | 65 t | 70 t | 75 t | 80 t | 85 t | 90 t | 95 t | 100 t | 120 t |
| Sleeve width | 110 mm | 110 mm | 132 mm | 132 mm | 160 mm | 160 mm | 160 mm | 180 mm | 180 mm | 180 mm | 220 mm | 220 mm | 220 mm | 320 mm | 320 mm | 320 mm | 320 mm | 320 mm | 320 mm | 320 mm |
| Core diameter | 39 mm | 46 mm | 52 mm | 60 mm | 65 mm | 67 mm | 73 mm | 78 mm | 86 mm | 90 mm | 95 mm | 98 mm | 101 mm | 105 mm | 108 mm | 112 mm | 116 mm | 120 mm | 123 mm | 140 mm |
| EWL in mtr | kg | | | | | | | | | | | | | | | | | | | |
| 1 | 2,7 | 3,6 | 4,6 | 6 | 6,5 | 7,8 | - | - | - | - | - | - | - | - | - | - | - | - | - | - |
| 2 | 5,3 | 7 | 9 | 11,7 | 12,9 | 15,4 | 17,1 | 20 | 22,6 | 25,1 | 27 | 29,5 | 31,2 | - | - | - | - | - | - | - |
| 3 | 7,9 | 10,4 | 13,5 | 17,5 | 19,2 | 23 | 25,5 | 29,9 | 33,7 | 37,5 | 40,3 | 44 | 46,6 | 55 | 57,7 | 61,8 | 64,5 | 68,6 | 71,3 | 97,1 |
| 4 | 10,5 | 13,8 | 17,9 | 23,3 | 25,5 | 30,5 | 33,9 | 39,8 | 44,8 | 49,8 | 53,6 | 58,6 | 62 | 73,2 | 76,8 | 82,2 | 85,8 | 91,2 | 106,7 | 129,3 |
| 5 | 13 | 17,2 | 22,3 | 29,1 | 31,8 | 38,1 | 42,3 | 49,6 | 55,9 | 62,2 | 66,9 | 73,2 | 77,4 | 91,3 | 95,9 | 102,6 | 107,2 | 113,9 | 118,4 | 161,5 |
| 6 | 15,6 | 20,6 | 26,7 | 34,9 | 38,1 | 45,7 | 50,7 | 59,5 | 67 | 74,6 | 80,2 | 87,7 | 92,8 | 109,5 | 114,9 | 112,9 | 128,5 | 136,6 | 142 | 193,6 |
| 7 | 18,2 | 24,1 | 31,2 | 40,6 | 44,5 | 53,3 | 59,1 | 69,4 | 78,2 | 87 | 93,5 | 102,3 | 108,2 | 127,7 | 134 | 143,5 | 149,8 | 159,3 | 165,6 | 225,8 |
| 8 | 20,8 | 27,5 | 35,6 | 46,4 | 50,8 | 60,9 | 67,6 | 79,2 | 89,3 | 99,4 | 106,8 | 116,9 | 123,6 | 145,8 | 153,1 | 163,9 | 171,1 | 182 | 189,2 | 258 |
| 9 | 23,3 | 30,9 | 40 | 52,2 | 57,1 | 68,4 | 76 | 89,1 | 100,4 | 111,7 | 120,1 | 131,4 | 139 | 164 | 172,1 | 184,3 | 192,5 | 204,7 | 212,8 | 290,2 |
| 10 | 25,9 | 34,3 | 44,4 | 58 | 63,4 | 76 | 84,4 | 99 | 111,5 | 124,1 | 133,4 | 146 | 154,4 | 182,2 | 191,2 | 204,8 | 213,8 | 227,4 | 236,4 | 322,3 |
| 11 | 28,5 | 37,7 | 48,9 | 63,8 | 69,7 | 83,6 | 92,8 | 108,8 | 122,7 | 136,5 | 146,7 | 160,5 | 169,8 | 200,4 | 210,3 | 225,2 | 235,1 | 250 | 260 | 354,5 |
| 12 | 31,1 | 41,1 | 53,3 | 69,5 | 76,1 | 91,2 | 101,2 | 118,7 | 133,8 | 148,9 | 160 | 175,1 | 185,2 | 218,5 | 229,4 | 245,6 | 256,5 | 272,7 | 283,6 | 386,7 |
| 13 | 33,6 | 44,5 | 57,7 | 75,3 | 82,4 | 98,7 | 109,6 | 128,5 | 144,9 | 161,3 | 173,3 | 189,7 | 200,6 | 236,7 | 248,4 | 266,1 | 277,8 | 295,4 | 307,2 | 418,9 |
| 14 | 36,2 | 47,9 | 62,1 | 81,1 | 88,7 | 106,3 | 118,1 | 138,4 | 156 | 173,6 | 186,6 | 204,2 | 216 | 254,9 | 267,5 | 286,5 | 299,1 | 318,1 | 330,7 | 451 |
| 15 | 38,8 | 51,4 | 66,6 | 86,9 | 95 | 113,9 | 126,5 | 148,3 | 167,1 | 186 | 199,9 | 218,8 | 231,4 | 273 | 286,6 | 306,9 | 320,5 | 340,8 | 354,3 | 483,2 |
| 16 | 41,3 | 54,8 | 71 | 92,7 | 101,3 | 121,5 | 134,9 | 158,1 | 178,3 | 198,4 | 213,2 | 233,3 | 246,8 | 291,2 | 305,7 | 327,3 | 341,8 | 363,5 | 377,9 | 515,4 |
| 17 | 43,9 | 58,2 | 75,4 | 98,4 | 107,7 | 129,1 | 143,3 | 168 | 189,4 | 210,8 | 226,5 | 247,9 | 262,2 | 309,4 | 324,7 | 347,8 | 363,1 | 386,2 | 401,5 | 547,6 |
| 18 | 46,5 | 61,6 | 79,8 | 104,2 | 114 | 136,6 | 151,7 | 177,9 | 200,5 | 223,2 | 239,8 | 262,5 | 277,6 | 327,5 | 343,8 | 368,2 | 384,4 | 408,8 | 425,1 | 579,8 |
| 19 | 49,1 | 65 | 84,3 | 110 | 120,3 | 144,2 | 160,2 | 187,7 | 211,6 | 235,5 | 253,1 | 277 | 293 | 345,7 | 362,9 | 388,6 | 405,8 | 431,5 | 448,7 | 611,9 |
| 20 | 51,6 | 68,4 | 88,7 | 115,8 | 126,6 | 151,8 | 168,6 | 197,6 | 222,8 | 247,9 | 266,4 | 291,6 | 308,4 | 363,9 | 381,9 | 409 | 427,1 | 454,2 | 472,3 | 644,1 |
| Extra per mtr. working length | 2,6 | 3,4 | 4,4 | 5,8 | 6,3 | 7,6 | 8,4 | 9,9 | 11,1 | 12,4 | 13,3 | 14,6 | 15,4 | 18,2 | 19,1 | 20,4 | 21,3 | 22,7 | 23,6 | 30 |

*TLX round slings up to 150 t on request.

Premium Round slings • Type TLX with Techlon® protective sleeve made of polyester

The high-tech polyester round sling

according DIN EN 1492-2

TLX is a high tech -PES- round sling from the Unitex Group. Due to the special rip and weave structure, the Techlon sleeve is significantly more resistant to abrasion than a standard polyester sleeve.

The TLX is fitted with an extremely strong reinforced label.

- Due to the special rip and weave structure, the Techlon sleeve is significantly more resistant to abrasion than a standard polyester sleeve.
- Highly compact and stable sleeve. Optimal use and reduced wear.
- WLL printed on the sleeve continuously and additional sewn in WLL stripes for easy identification.
- Extremely strong reinforced label.
- According to the Machinery Directive 2006/42/EG.
- Color coding according to EN 1492-2.
- Stripe coded, each stripe equals 1 ton of vertical lifting capacity (up to 10 ton).
- WLL printed on the sleeve continuously (up to 10 ton)
- Special warp. The new type of warp gives also an extra resistance against abrasion
- TLX round slings offers a substantial longer service life compared to standard round slings.
- The more compact sleeve results in a better fit around the crane hook.



TLX round slings are being produced up to **150 ton WLL** (Lloyds approval up to WLL 115 T.)



| Type | WLL | Sleeve width (mm) | Round sling diameter | Weight of round sling 0,5 m effective length (kg) | Weight per 0,5 m extra (kg) |
|---------|---------|-------------------|----------------------|---|-----------------------------|
| TLX 010 | WLL 1 t | 41 | 12 | 0,149 | 0,125 |
| TLX 020 | WLL 2 t | 52 | 18 | 0,236 | 0,206 |
| TLX 030 | WLL 3 t | 53 | 20 | 0,320 | 0,288 |
| TLX 040 | WLL 4 t | 69 | 22 | 0,423 | 0,382 |
| TLX 050 | WLL 5 t | 76 | 28 | 0,501 | 0,457 |
| TLX 060 | WLL 6 t | 80 | 30 | 0,612 | 0,564 |
| TLX 080 | WLL 7 t | 90 | 32 | 0,782 | 0,728 |
| TLX 100 | WLL 8 t | 96 | 35 | 0,941 | 0,884 |



Protection Sleeve

PVC PROTECTION SLEEVE Type BS - BL for round slings and lifting slings

| Type | Diameter (mm) | Width (mm) | For lifting belts (mm) | For round slings over | |
|---------|---------------|------------|------------------------|-----------------------|-------------|
| | | | | (1) strand | (2) strands |
| BS50BL | 38 | 60 | 30 - 50 | 1 - 4 t | 1 - 3 t |
| BS60BL | 50 | 80 | 60 | 5 - 8 t | 4 - 5 t |
| BS75BL | 63 | 100 | 75 - 100 | | 5 - 8 t |
| BS100BL | 76 | 120 | | 10 t | 10 t |
| BS150BL | 100 | 160 | 120 - 150 | 12 - 30 t | 12 - 20 t |
| BS180BL | 127 | 200 | 180 | 35 - 50 t | 25 - 30 t |
| BS200BL | 150 | 235 | 200 | 55 - 60 t | 35 - 45 t |
| BS300BL | 200 | 315 | 240 - 300 | 65 - 100 t | 50 - 70 t |

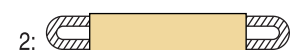

1: PU-impregnated conduits, type BS - BL, blue

ULTRALIFT ROUND SLING

Material: The construction of a round sling is divided into the load bearing core and the protection sleeve. The Ultralift Round slings is always made out of high performance fibres such as Dyneema® which makes the sling very light in weight even up to 2,5 times lighter in compare to Polyester en 8 times in compare to Steel based slings. The **Ultralift LD (ULLD)** has a protection sleeve made out off 100% Dyneema® This material is extremely abrasion resistant and therefore suitable for for heavy lift applications.

Properties:

Dyneema® is a High Modulus PolyEthylene Fibre (HMPE), that offers maximum strength combined with minimum weight.

Fysical properties

| | | |
|---------------------------------------|---|--|
| Specific Gravity (g/cm ³) | : | 0,97 |
| Elongation at WLL (in %) | : | 0,5 |
| Elongation in use | : | Similar to wire rope slings. |
| Weight reduction in % | : | Compared to wire rope slings; < 80% Compared to polyester based slings; < 59 % |
| Usable at temperature | : | -50°C-+60°C |
| Effects on Chemical exposure* | : | Excellent on water, moisture, very resistant against chemicals and micro organism. Good resistance to acid and alkali. |
| Effects on Chemical exposure* | : | 0,0 |

* Always consult the producer.



Dyneema® is a registered trademark of Royal DSM N.V.

Application:

The Ultralift LD Round Sling with the light duty (UPLD) Dyneema® based protection sleeve is developed for heavy lift applications were abrasion and flexibility is required.

The Ultralift LD Round Slings are exceptionally suitable for repetitive lifting jobs. Due to the maximum strength combined with the minimum weight, cost reductions will be achieved by spending less hours spend on rigging, less workers to rig, less back and hand injuries, a.o.

Standards:

- ULTRALIFT round slings comply with the Machinery Directive 2006/42/EG
- ULTRALIFT have a CE -mark, according the Machinery Directive requirements.
- Each ULTRALIFT round sling is preloaded 2 times the WLL , before delivery.
- A technical dossier is composed and validated by an independent authorized body (A.I.B. Vincotte and Lloyds).



ULTRALIFT-COISLING WITH AN ULTRAPROTECT "HEAVY DUTY" SLEEVE (ULNG)

Material: The Coil Sling NG consists of two parts: The ULTRALIFT round sling as a perfect round sling with a high abrasion resistant cover made of dyneema®. (upld). over both legs an ULTRAPROTECT heavy duty protection sleeve is placed. The ULTRAPROTECT (UPHD) protection sleeve is extremely cut- and abrasion resistant.

Application:

This patented ULTRALIFT coil sling is especially developed for lifting coils and loads which are heavy and sharp.

The benefits of this concept are:

- In case of severe damages the protection sleeve can be replaced easily, without replacing the ULTRALIFT round sling.
- easy handling, due to the size of the ULTRALIFT round sling that fits perfectly into the hook
- The total weight of the ULTRALIFT coil sling NG is extremely low.
- The lifetime of the ulld will be very long, because of the dyneema based cover.
- discharge indicator on the ULTRAPROTECT protection sleeve. (red marker yarns).



Dyneema®
is a registered
trademark of
Royal DSM N.V.

WEIGHT of Ultra Lift • ULCS round slings • UPHD with protective hose with Dyneema®

| Type | | ULCS | | | | |
|---|-------------------------------|-----------|-----------|-----------|------------|------------|
| | | ULCS100 | ULCS150 | ULCS200 | ULCS250 | ULCS300 |
| WLL | | 10 t | 15 t | 20 t | 25 t | 30 t |
| Sleeve width actual ULLD Roundsling | | 75 - 85mm | 90-100 mm | 90-100 mm | 115-125 mm | 115-125 mm |
| Sleeve width extra UPHD protection sleeve actual Roundsling | | 115-125mm | 145-155mm | 145-155mm | 175 -185mm | 175-185mm |
| L in mtr | Length UPHD protection Sleeve | kg | | | | |
| 2,5 | 1,9 | 4,9 | 6,2 | 6,4 | 8,6 | 9,2 |
| 3 | 2,4 | 5,9 | 7,4 | 7,7 | 10,3 | 11 |
| 3,5 | 2,9 | 6,9 | 8,7 | 9,1 | 12 | 12,9 |
| 4 | 3,4 | 7,9 | 9,9 | 10,5 | 13,7 | 14,7 |
| 4,5 | 3,9 | 8,8 | 11,2 | 11,8 | 15,5 | 16,5 |
| 5 | 4,4 | 9,8 | 12,4 | 13,2 | 17,2 | 18,4 |
| 5,5 | 4,9 | 10,8 | 13,7 | 14,6 | 18,9 | 20,2 |
| 6 | 5,4 | 11,8 | 14,9 | 15,9 | 20,6 | 22,1 |
| 6,5 | 5,9 | 12,7 | 16,1 | 17,3 | 22,4 | 23,9 |
| 7 | 6,4 | 13,7 | 17,4 | 18,7 | 24,1 | 25,8 |
| 7,5 | 6,9 | 14,7 | 18,6 | 20,0 | 25,8 | 27,6 |
| 8 | 7,4 | 15,7 | 19,9 | 21,4 | 27,5 | 29,5 |
| 8,5 | 7,9 | 16,7 | 21,1 | 22,7 | 29,3 | 31,3 |
| 9 | 8,4 | 17,6 | 22,4 | 24,1 | 31 | 33,1 |
| 9,5 | 8,9 | 18,6 | 23,6 | 25,5 | 32,7 | 35 |
| 10 | 9,4 | 19,6 | 24,8 | 26,8 | 34,4 | 36,8 |

ULLD Round slings



ULTRALIFT • ULLD round slings made of Dyneema® fibers

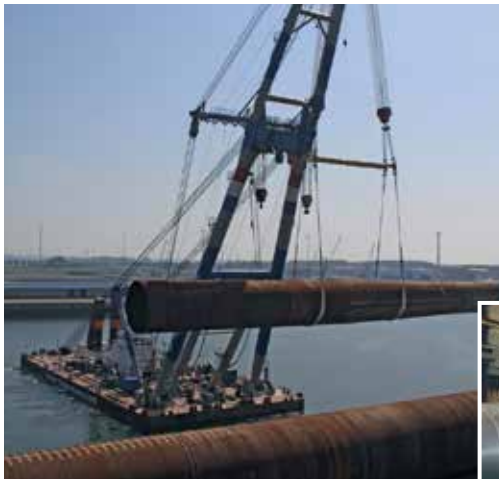

ULTRALIFT LD Round slings are produced out of a Dyneema® yarn and fully Comply to the machinery directive 2006/42/EG

- ULLD Round slings are suitable for precision lift due to the low elongation
- Low weight (2,5 times lighter than PES, and min 8 times lighter compared to steel wire ropes)
- extremely high abrasion resistance



Dyneema® is a registered trademark of Royal DSM N.V.

WEIGHT of Ultra Lift by Unitex® - ULLD round slings made of Dyneema® fibers

| Type | ULLD | | | | | | | | | | | | | | | | | | | | | |
|-------------------------------|-------------|-------|-------|-------|-------|-------|--------|-------|-------|--------|--------|--------|--------|--------|--------|--------|--------|--------|--------|--------|--------|--------|
| | 0020 | 0030 | 0040 | 0050 | 0060 | 0080 | 0100 | 0150 | 0200 | 0250 | 0300 | 0400 | 0500 | 0600 | 0700 | 0800 | 0900 | 1000 | 1200 | 1400 | 1600 | 1800 |
| WLL | 2 t | 3 t | 4 t | 5 t | 6 t | 8 t | 10 t | 15 t | 20 t | 25 t | 30 t | 40 t | 50 t | 60 t | 70 t | 80 t | 90 t | 100 t | 120 t | 140 t | 160 t | 180 t |
| Sleeve type 0,5 up to 2,0 Mtr | 73 mm | 73 mm | 83 mm | 83 mm | 98 mm | 98 mm | 123 mm | ----- | | | | | | | | | | | | | | |
| Sleeve type from 2 mtr and up | 63 mm | 63 mm | 73 mm | 73 mm | 73 mm | 83 mm | 98 mm | ----- | | | | | | | | | | | | | | |
| Sleeve width | ----- | | | | | | | 98 mm | 98 mm | 133 mm | 133 mm | 133 mm | 183 mm | 183 mm | 183 mm | 183 mm | 228 mm | 228 mm | 283 mm | 283 mm | 343 mm | 343 mm |
| Core diameter | ----- | | | | | | | 30 mm | 34 mm | 40 mm | 44 mm | 48 mm | 71 mm | 75 mm | 87 mm | 90 mm | 94 mm | 100 mm | 108 mm | 116 mm | 125 mm | 132 mm |
| EWL in mtr | Weight (kg) | | | | | | | | | | | | | | | | | | | | | |
| 0,5 | 0,38 | 0,40 | 0,56 | - | - | - | - | - | - | - | - | - | - | - | - | - | - | - | - | - | - | - |
| 1 | 0,66 | 0,71 | 0,98 | 1,04 | 1,09 | 1,31 | 1,56 | - | - | - | - | - | - | - | - | - | - | - | - | - | - | - |
| 1,5 | 0,95 | 1,01 | 1,41 | 1,48 | 1,56 | 1,88 | 2,24 | - | - | - | - | - | - | - | - | - | - | - | - | - | - | - |
| 2 | 1,23 | 1,31 | 1,83 | 1,93 | 2,04 | 2,45 | 2,92 | - | - | - | - | - | - | - | - | - | - | - | - | - | - | - |
| 2,5 | 1,40 | 1,51 | 1,81 | 1,94 | 2,07 | 2,81 | 3,28 | 4,2 | 4,8 | 6,2 | 6,8 | 8,2 | 13,1 | 14,1 | 17,2 | 18,9 | 20,4 | - | - | - | - | - |
| 3 | 1,66 | 1,79 | 2,15 | 2,30 | 2,46 | 3,34 | 3,90 | 4,9 | 5,7 | 7,3 | 8 | 9,6 | 15,4 | 16,6 | 20,4 | 22,3 | 24,2 | 32,6 | 33,6 | 41,2 | 46,9 | 51 |
| 3,5 | 1,93 | 2,07 | 2,49 | 2,67 | 2,85 | 3,87 | 4,52 | 5,7 | 6,5 | 8,4 | 9,3 | 11 | 17,7 | 19,2 | 23,5 | 25,8 | 27,9 | 37 | 38,7 | 47 | 53,7 | 58,5 |
| 4 | 2,19 | 2,35 | 2,82 | 3,03 | 3,24 | 4,41 | 5,14 | 6,4 | 7,3 | 9,5 | 10,5 | 12,5 | 20 | 21,7 | 26,7 | 29,2 | 31,7 | 41,4 | 43,9 | 52,9 | 60,5 | 66 |
| 4,5 | 2,45 | 2,64 | 3,16 | 3,40 | 3,63 | 4,94 | 5,76 | 7,1 | 8,2 | 10,7 | 11,7 | 13,9 | 22,4 | 24,2 | 29,8 | 32,7 | 35,4 | 45,9 | 49 | 58,8 | 67,3 | 73,4 |
| 5 | 2,71 | 2,92 | 3,50 | 3,76 | 4,03 | 5,47 | 6,39 | 7,8 | 9 | 11,8 | 13 | 15,4 | 24,7 | 26,7 | 33 | 36,1 | 39,2 | 50,3 | 54,2 | 64,6 | 74 | 80,9 |
| 5,5 | 2,97 | 3,20 | 3,84 | 4,13 | 4,42 | 6 | 7,01 | 8,6 | 9,9 | 12,9 | 14,2 | 16,8 | 27 | 29,3 | 36,1 | 39,6 | 42,9 | 54,8 | 59,4 | 70,5 | 80,8 | 88,4 |
| 6 | 3,24 | 3,49 | 4,18 | 4,50 | 4,81 | 6,53 | 7,63 | 9,3 | 10,7 | 14 | 15,4 | 18,3 | 29,3 | 31,8 | 39,2 | 43 | 46,7 | 59,2 | 64,5 | 76,4 | 87,6 | 95,9 |
| 6,5 | 3,50 | 3,77 | 4,52 | 4,86 | 5,20 | 7,06 | 8,25 | 10 | 11,6 | 15,1 | 16,6 | 19,7 | 31,6 | 34,3 | 42,4 | 46,5 | 50,4 | 63,7 | 69,7 | 82,2 | 94,4 | 103,3 |
| 7 | 3,76 | 4,05 | 4,86 | 5,23 | 5,59 | 7,59 | 8,87 | 10,7 | 12,4 | 16,2 | 17,9 | 21,1 | 33,9 | 36,8 | 45,5 | 49,9 | 54,2 | 68,1 | 74,8 | 88,1 | 101,2 | 110,8 |
| 7,5 | 4,02 | 4,33 | 5,20 | 5,59 | 5,98 | 8,12 | 9,49 | 11,4 | 13,2 | 17,3 | 19,1 | 22,6 | 36,3 | 39,4 | 48,7 | 53,4 | 57,9 | 72,6 | 80 | 94 | 108 | 118,3 |
| 8 | 4,28 | 4,62 | 5,54 | 5,96 | 6,38 | 8,66 | 10,11 | 12,2 | 14,1 | 18,4 | 20,3 | 24 | 38,6 | 41,9 | 51,8 | 56,9 | 61,6 | 77 | 85,1 | 99,8 | 114,8 | 125,8 |
| 8,5 | 4,55 | 4,90 | 5,88 | 6,32 | 6,77 | 9,19 | 10,74 | 12,9 | 14,9 | 19,5 | 21,5 | 25,5 | 40,9 | 44,4 | 55 | 60,3 | 65,4 | 81,5 | 90,3 | 105,7 | 121,6 | 133,2 |
| 9 | 4,81 | 5,18 | 6,22 | 6,69 | 7,16 | 9,72 | 11,36 | 13,6 | 15,8 | 20,6 | 22,8 | 26,9 | 43,2 | 46,9 | 58,1 | 63,8 | 69,1 | 85,9 | 95,4 | 111,6 | 128,3 | 140,7 |
| 9,5 | 5,07 | 5,47 | 6,56 | 7,06 | 7,55 | 10,25 | 11,98 | 14,3 | 16,6 | 21,7 | 24 | 28,3 | 45,5 | 49,5 | 61,3 | 67,2 | 72,9 | 90,3 | 100,6 | 117,5 | 135,1 | 148,2 |
| 10 | 5,33 | 5,75 | 6,90 | 7,42 | 7,94 | 10,78 | 12,60 | 15,1 | 17,5 | 22,8 | 25,2 | 29,8 | 47,9 | 52 | 64,4 | 70,7 | 76,6 | 94,8 | 105,7 | 123,3 | 141,9 | 155,6 |
| 11 | 5,86 | 6,31 | 7,58 | 8,15 | 8,73 | 11,84 | 13,84 | 16,5 | 19,1 | 25 | 27,7 | 32,7 | 52,5 | 57 | 70,7 | 77,6 | 84,1 | 103,7 | 116 | 135,1 | 155,5 | 170,6 |
| 12 | 6,38 | 6,88 | 8,26 | 8,88 | 9,51 | 12,91 | 15,09 | 18 | 20,8 | 27,3 | 30,1 | 35,5 | 57,1 | 62,1 | 77 | 84,5 | 91,6 | 112,6 | 126,3 | 146,8 | 169,1 | 185,5 |
| 13 | 6,90 | 7,44 | 8,94 | 9,62 | 10,29 | 13,97 | 16,33 | 19,4 | 22,5 | 29,5 | 32,6 | 38,4 | 61,8 | 67,1 | 83,3 | 91,4 | 99,1 | 121,5 | 136,6 | 158,5 | 182,6 | 200,5 |
| 14 | 7,43 | 8,01 | 9,62 | 10,35 | 11,08 | 15,03 | 17,57 | 20,8 | 24,2 | 31,7 | 35 | 41,3 | 66,4 | 72,2 | 89,6 | 98,3 | 106,6 | 130,3 | 147 | 170,3 | 196,2 | 215,4 |
| 15 | 7,95 | 8,58 | 10,30 | 11,08 | 11,86 | 16,09 | 18,81 | 22,3 | 25,9 | 33,9 | 37,5 | 44,2 | 71 | 77,2 | 95,9 | 105,2 | 114,1 | 139,2 | 157,3 | 182 | 209,8 | 230,4 |
| 16 | 8,48 | 9,14 | 10,98 | 11,81 | 12,65 | 17,16 | 20,06 | 23,7 | 27,6 | 36,1 | 40 | 47,1 | 75,7 | 82,3 | 102,2 | 112,1 | 121,6 | 148,1 | 167,6 | 193,8 | 223,3 | 245,3 |
| 17 | 9 | 9,71 | 11,65 | 12,54 | 13,43 | 18,22 | 21,30 | 25,2 | 29,3 | 38,3 | 42,4 | 50 | 80,3 | 87,3 | 108,5 | 119 | 129,1 | 157 | 177,9 | 205,5 | 236,9 | 260,3 |
| 18 | 9,52 | 10,27 | 12,33 | 13,27 | 14,21 | 19,28 | 22,54 | 26,6 | 31 | 40,5 | 44,9 | 52,8 | 84,9 | 92,4 | 114,7 | 125,9 | 136,6 | 165,9 | 188,2 | 217,2 | 250,5 | 275,2 |
| 19 | 10,05 | 10,84 | 13,01 | 14,01 | 15 | 20,34 | 23,79 | 28,1 | 32,6 | 42,8 | 47,3 | 55,7 | 89,6 | 97,4 | 121 | 132,8 | 144,1 | 174,8 | 198,5 | 229 | 264,1 | 290,2 |
| 20 | 10,57 | 11,40 | 13,69 | 14,74 | 15,78 | 21,41 | 25,03 | 29,5 | 34,3 | 45 | 49,8 | 58,6 | 94,2 | 102,5 | 127,3 | 139,8 | 151,6 | 183,7 | 208,8 | 240,7 | 277,6 | 305,1 |

Round sling connecting links



WEB SLING CONNECTING LINK, SERIE 191 (ACCORDING TO EN1677-1)

| Chain Size | WLL | A (mm) | B (mm) | C (mm) | D (mm) | LU (mm) | Weight (kg) |
|------------|--------|--------|--------|--------|--------|---------|-------------|
| 7/8-8 | 2 t | 10,5 | 24 | 40 | 20 | 62 | 0,32 |
| 10-8 | 3,15 t | 12 | 28 | 50 | 25 | 78 | 0,6 |
| 13-8 | 5,3 t | 17 | 33 | 60 | 30 | 97 | 1,1 |
| 16-8 | 8 t | 21 | 42 | 75 | 36 | 118 | 2,1 |

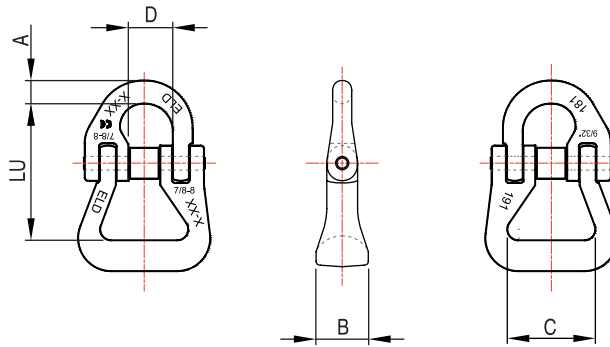

ROUND SLING HOOK Type CJ • GK 8

| Type | WLL | A (mm) | B (mm) | C (mm) | D (mm) | G (mm) | H (mm) | P (mm) | T (mm) | Weight (kg) |
|-------|------|--------|--------|--------|--------|--------|--------|--------|--------|-------------|
| CJ 01 | 1 t | 78 | 123 | 12 | 41 | 17 | 20 | 16 | 31 | 0,7 |
| CJ 02 | 2 t | 91 | 148 | 19 | 55 | 21 | 26 | 17 | 40 | 1,2 |
| CJ 03 | 3 t | 113 | 175 | 21 | 55 | 25 | 32 | 25 | 50 | 2,2 |
| CJ 04 | 4 t | 133 | 223 | 40 | 70 | 36 | 40 | 36 | 59,5 | 4,5 |
| CJ 05 | 5 t | 133 | 223 | 40 | 70 | 36 | 40 | 36 | 59,5 | 4,5 |
| CJ 06 | 6 t | 133 | 223 | 40 | 70 | 36 | 40 | 36 | 59,5 | 4,5 |
| CJ 08 | 8 t | 185 | 317 | 50 | 100 | 45 | 63 | 55 | 80 | 12,5 |
| CJ 10 | 10 t | 185 | 317 | 50 | 100 | 45 | 63 | 55 | 80 | 12,5 |

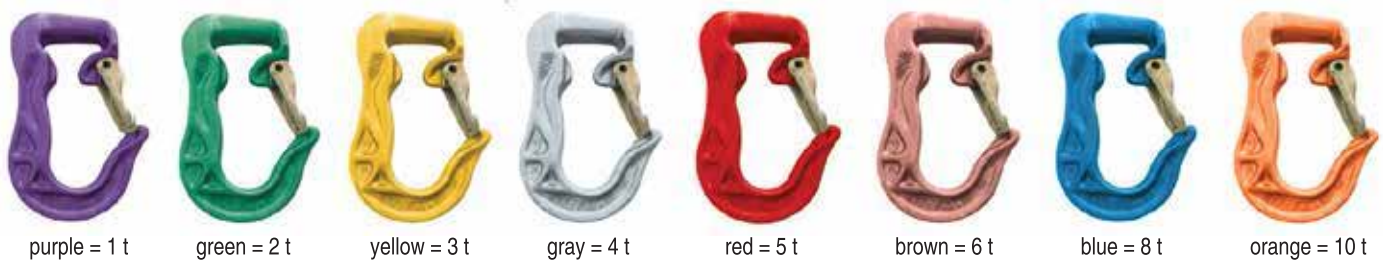
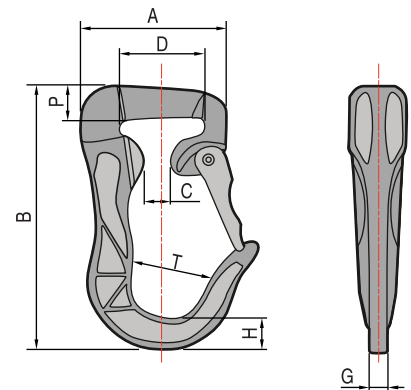

บริษัท เต็มตัน จำกัด
 1/19 หมู่ 1 ต.พิมพา อ.บางปะกง จ.ฉะเชิงเทรา 24180 (ประเทศไทย)
 โทรศัพท์. 097-248-2251, 52, 53 แฟกซ์. 038-571-665
 E-mail : temton.crane@gmail.com www.temton.co.th