

CORNERED AUDIO C3



FEATURES

4" woofer
1" silk dome tweeter
ABS cabinet
Low to Medium-SPL applications

COLOURS



Description

C3 is a very compact 2-way full-range speaker made in ABS plastic with a MDF baffle. The Danish designed 4" ultra long-throw woofer offers excellent bass and mid reproduction with good cooling of the motor, resulting in excellent clarity and low power compression.

With a wide and uniform dispersion, full coverage can be achieved by installing relatively few speakers. Two or three cabinets can be coupled together to extend coverage to 180 or 270 degree.

The Danish designed 1" tweeter is cooled by magnetic oil and features a silk dome with very extended frequency range and excellent dispersion.

The cabinet has integrated mounting points and mounts flush on walls or ceilings with only two screws going through the cabinet. It is well damped and the triangular shape minimises standing waves and reflections from inside the cabinet. The C3 features a discreet cable terminal, located behind the grille and accessed from the rear of the cabinet. C3 is the perfect choice for background sound in lounges and cafes or as an elegant high performance solution for upscale retail outlets.

DATA

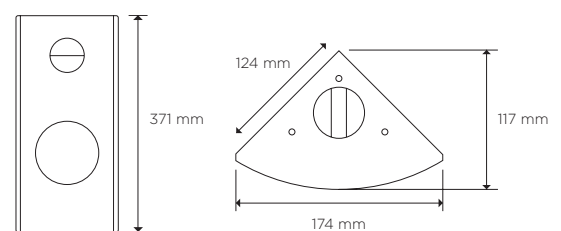

Power handling, IEC268:	80 watt
Power handling, peak:	320 watt
Sensitivity, 2.83V/1m:	86 dB
Maximum SPL, long term:	105 dB
Maximum SPL, peak:	111 dB
Frequency response:	70-25.000 Hz
Nominal impedance:	8 ohm
Dispersion:	120x120 degree
Weight:	2,7 kg
Measurements:	(HxWxD) 371x174x124mm

CORNERED AUDIO C3

Architectural Specifications

The loudspeaker system shall consist of a 4" long-throw woofer and a 1" tweeter with its voice coil dampened with magnetic oil for improved power handling. The second-order frequency dividing network shall utilize polypropylene capacitors to reduce hysteresis and air coils to reduce compression.

Performance specifications of a typical production shall be as follows: SPL at 1 m with 2.83 V input shall be at least 86 dB. Nominal impedance shall be 8 ohms, with minimum impedance being 5,2 ohm @ 250 Hz. Rated power handling according to IEC 268-5 shall be at least 80 watt. Frequency response shall be from 70-25kHz +/- 3 dB.

The enclosure shall be rectangular in shape with no visible cable terminals and with a 90 degree angle allowing the speaker to be mounted in corners. It shall be manufactured of molded ABS plastic with an MDF baffle and shall incorporate integrated mounting points which allow the speaker to be mounted without brackets. Cabinet finish shall be satin white with a metal grille covered with white cloth or black with a metal grille covered with black cloth. Outside dimensions shall be no greater than 371mm (height) x 174mm (width) x 127mm (side) and weight shall be 2,7 kg. The loudspeaker system shall be the Cornered Audio C3.

FREQUENCY RESPONSE

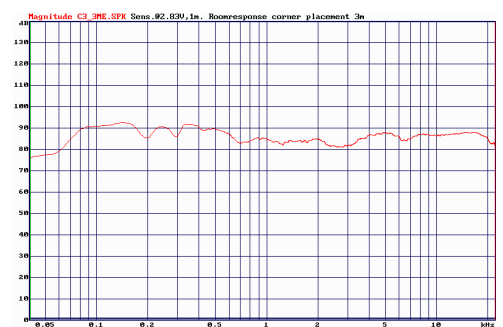

IMPEDANCE

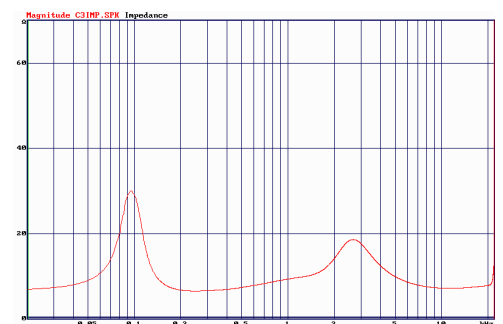

CORNERED Audio ApS
Roskildevej 16A
2620 Albertslund
Denmark

Mail info@cornered.dk
Tel +45 43 66 10 88
Web www.cornered.dk