

# Cable Fitting: Barrier Cable Gland for Non-Armoured Cable, DNAFB Series

Flameproof/ Increased Safety and Dust protection by enclosure

Zone 1 & 2 – 21 & 22



## Application

The DNAFB cable glands are suitable for used to insertion of normal non-armoured cable into Ex db equipment or enclosure. The gland nut is provided with female threads ended.

## Specification

Body, gland nut : Brass  
 Thread seal : Nylon (PA6)  
 (For metric threads only)  
 Seal : Epoxy barrier compound

## Technical Data

<b>Hazardous Area</b>	<b>Gas</b>	<b>Dust</b>
<b>Zones</b>	<b>1 &amp; 2</b>	<b>21 &amp; 22</b>
<b>Equipment Group/Category</b>	<b>II 2G</b>	<b>II 2D</b>
<b>Symbol of Protection</b>	<b>Ex db eb IIC Gb</b>	<b>Ex tb IIIC Db IP66</b>
<b>T Rating</b>	Temperature class of enclosure to which will be connected.	
<b>Conformity to Standards</b>	EN 60079-0:2012+A11:2013, EN 60079-1:2014, EN 60079-7:2015, EN 60079-31:2014	
<b>Ambeint Temperature</b>	-40°C to +75°C	
<b>Index of Protection</b>	IP66	

## Catalogue Number Logic

**DNAFB /** [Series] [Body] [Threads] [Option]

Series	Body	Threads	Option
S	Small	N NPT	NI Nickel-plated
M	Medium	M Metric	
L	Large		

Note: Cables for fixed installations shall have flame propagation characteristics which enable them to withstand the tests according to IEC 60332-1-2 or IEC 60332-3-22.

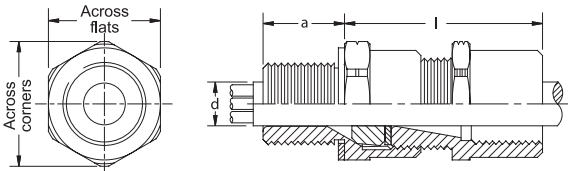

Brass



Nickel-plated brass

## Ordering Requirements

Cat. No.	Entries Threads (Male)		Cable Dia. Outer 'd'	Threads Ended (Female)	Dimension in mm.				Approx. Weight (kgs.)
	Metric	NPT			l	a	Across Corners	Across Flats	
DNAFB/S -M0N1	- □	M16x1.5	-	1/2"	38.5	15.0	26.5	24.0	0.08
DNAFB/S -M1N1	- □	M20x1.5	-						0.10
DNAFB/S -N1	- □	-	1/2"		41.5	19.8	26.5	24.0	0.11
DNAFB/M -M1N1	- □	M20x1.5	-	1/2"	38.5	15.0	26.5	24.0	0.10
DNAFB/M -N1	- □	-	1/2"						0.10
DNAFB/L -M1N1	- □	M20x1.5	-	1/2"	39.5	15.0	35.0	31.75	0.11
DNAFB/S -M2N2	- □	M25x1.5	-						0.16
DNAFB/L -N1	- □	-	1/2"	1/2"	42.5	19.8	35.0	31.75	0.12
DNAFB/S -N2	- □	-	3/4"						0.17
DNAFB/M -M2N2	- □	M25x1.5	-	3/4"	46.5	15.0	42.0	38.1	0.17
DNAFB/S -M3N3	- □	M32x1.5	-						0.23
DNAFB/M -N2	- □	-	3/4"	3/4"	49.5	20.1	42.0	38.1	0.25
DNAFB/S -N3	- □	-	1"						0.28
DNAFB/M -M3N3	- □	M32x1.5	-	1"	54.5	25.0	42.0	38.1	0.23
DNAFB/S -M4N4	- □	M40x1.5	-						0.31
DNAFB/M -N3	- □	-	1"	1-1/4"	55.5	25.0	49.0	44.4	0.25
DNAFB/S -N4	- □	-	1-1/4"						0.40
DNAFB/M -M4N4	- □	M40x1.5	-	1-1/4"	51.0	15.0	56.0	50.8	0.30
DNAFB/S -M5N5	- □	M50x1.5	-						0.45
DNAFB/M -N4	- □	-	1-1/4"	1-1/4"	59.0	25.6	56.0	50.8	0.37
DNAFB/S -N5	- □	-	1-1/2"						0.49
DNAFB/M -M5N5	- □	M50x1.5	-	1-1/2"	51.0	15.0	63.0	57.1	0.42
DNAFB/M -N5	- □	-	1-1/2"						0.46
DNAFB/L -M5N5	- □	M50x1.5	-	1-1/2"	51.0	15.0	70.0	63.5	0.48
DNAFB/S -M6N6	- □	M63x1.5	-						0.72
DNAFB/L -N5	- □	-	1-1/2"	1-1/2"	60.0	26.0	70.0	63.5	0.60
DNAFB/S -N6	- □	-	2"						0.80
DNAFB/M -M6N6S	- □	M63x1.5	-	2"	52.0	15.0	84.0	76.2	0.63
DNAFB/S -M7N7S	- □	M75x1.5	-						1.00
DNAFB/M -N6S	- □	-	2"	2"	60.0	26.9	84.0	76.2	0.84
DNAFB/S -N7S	- □	-	2-1/2"						1.56
DNAFB/M -M6N6L	- □	M63x1.5	-	2"	52.0	15.0	84.0	76.2	0.63
DNAFB/S -M7N7L	- □	M75x1.5	-						1.00
DNAFB/M -N6L	- □	-	2"	2"	60.0	26.9	84.0	76.2	0.84
DNAFB/S -N7L	- □	-	2-1/2"						1.56

