

# Cable Fitting: Barrier Cable Gland for Non-Armoured Cable, DNAB Series

Flameproof/ Increased Safety and Dust protection by enclosure

Zone 1 & 2 – 21 & 22

## Application

The DNAB cable glands are suitable for used to direct insertion of normal non-armoured cable into Ex db equipment or enclosure.

## Specification

- Body, gland nut : Brass
- Thread seal : Nylon (PA6)  
(For metric threads only)
- Seal : Epoxy barrier compound

## Technical Data

<b>Hazardous Area</b>	<b>Gas</b>	<b>Dust</b>
<b>Zones</b>	<b>1 &amp; 2</b>	<b>21 &amp; 22</b>
<b>Equipment Group/Category</b>	<b>II 2G</b>	<b>II 2D</b>
<b>Symbol of Protection</b>	<b>Ex db eb IIC Gb</b>	<b>Ex tb IIIC Db IP66</b>
<b>T Rating</b>	Temperature class of enclosure to which will be connected.	
<b>Conformity to Standards</b>	EN 60079-0:2012+A11:2013, EN 60079-1:2014, EN 60079-7:2015, EN 60079-31:2014	
<b>Ambeint Temperature</b>	-40°C to +75°C	
<b>Index of Protection</b>	IP66	

## Catalogue Number Logic

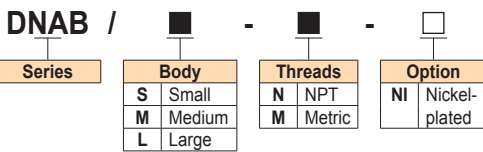

Note: Cables for fixed installations shall have flame propagation characteristics which enable them to withstand the tests according to IEC 60332-1-2 or IEC 60332-3-22.

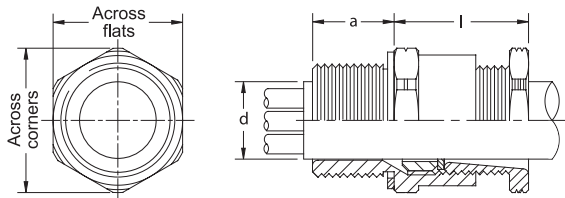

Brass



Nickel-plated brass

## Ordering Requirements

Cat. No.	Entries Threads (Male)		Cable Dia. Outer 'd'	Dimension in mm.				Approx. Weight (kgs.)
	Metric	NPT		l	a	Across Corners	Across Flats	
DNAB/S -M0	M16x1.5	-	3.0-8.6	25.0	15.0	26.5	24.0	0.06
DNAB/S -M1	M20x1.5	-						0.07
DNAB/S -N1	-	1/2"	6.1-11.9	25.0	19.8	26.5	24.0	0.07
DNAB/M -M1	M20x1.5	-						0.07
DNAB/M -N1	-	1/2"	6.5-14.3	25.0	19.8	35.0	31.75	0.07
DNAB/L -M1	M20x1.5	-						0.09
DNAB/S -M2	M25x1.5	-	11.1-20.2	33.0	15.0	42.0	38.1	0.11
DNAB/L -N1	-	1/2"						0.08
DNAB/S -N2	-	3/4"	17.0-26.5	33.0	20.1	42.0	38.1	0.12
DNAB/M -M2	M25x1.5	-						0.14
DNAB/S -M3	M32x1.5	-	22.0-32.5	33.0	25.0	49.0	44.4	0.18
DNAB/M -N2	-	3/4"						0.14
DNAB/S -N3	-	1"	29.5-38.1	33.0	25.0	49.0	44.4	0.21
DNAB/M -M3	M32x1.5	-						0.19
DNAB/S -M4	M40x1.5	-	35.6-44.0	34.0	15.0	56.0	50.8	0.25
DNAB/M -N3	-	1"						0.19
DNAB/S -N4	-	1-1/4"	39.0-44.0	34.0	25.6	63.0	57.1	0.31
DNAB/M -M4	M40x1.5	-						0.31
DNAB/S -M5	M50x1.5	-	44.1-54.0	38.0	15.0	70.0	63.5	0.26
DNAB/M -N4	-	1-1/4"						0.38
DNAB/S -N5	-	1-1/2"	39.0-44.0	38.0	26.0	56.0	50.8	0.30
DNAB/M -M5	M50x1.5	-						0.41
DNAB/S -N6	-	2"	44.1-54.0	38.0	15.0	84.0	76.2	0.36
DNAB/M -M5	M50x1.5	1-1/2"						0.37
DNAB/L -M5	M50x1.5	-	35.6-44.0	40.0	15.0	70.0	63.5	0.44
DNAB/S -M6	M63x1.5	-						0.65
DNAB/L -N5	-	1-1/2"	39.0-44.0	40.0	26.0	70.0	63.5	0.47
DNAB/S -N6	-	2"						0.67
DNAB/M -M6S	M63x1.5	-	39.0-44.0	40.0	26.9	70.0	63.5	0.49
DNAB/S -M7S	M75x1.5	-						0.49
DNAB/M -N6S	-	2"	44.1-54.0	40.0	15.0	84.0	76.2	0.76
DNAB/S -N7S	-	2-1/2"						0.52
DNAB/M -M6L	M63x1.5	-	44.1-54.0	40.0	26.9	84.0	76.2	0.95
DNAB/S -M7L	M75x1.5	-						0.49
DNAB/M -N6L	-	2"	44.1-54.0	40.0	26.9	84.0	76.2	0.76
DNAB/S -N7L	-	2-1/2"						0.52
DNAB/M -M6L	M63x1.5	-	44.1-54.0	40.0	39.9	84.0	76.2	0.52
DNAB/S -N7L	-	2-1/2"						0.95

